

B.M. ELEV. 867.93, PK IN 3" CB, SW COR. OF HOWARD & 11 TH - NR. PROP. COR.  
 B.M. ELEV. 882.38, P.K. IN CB. OF 12 TH ST. AT HOWARD AVE.  
 F. B. 602/11-26, 39-41, 77  
 SCALES: HOR. 1" = 50', VERT. 1" = 5'

HOWARD AVENUE

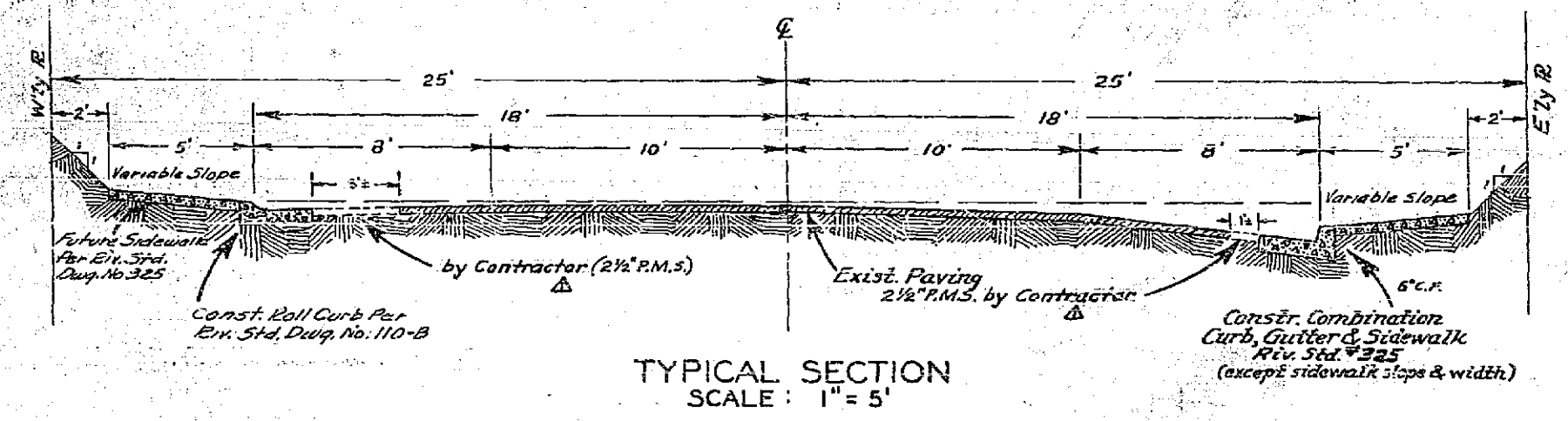

TYPICAL SECTION  
SCALE: 1" = 5'

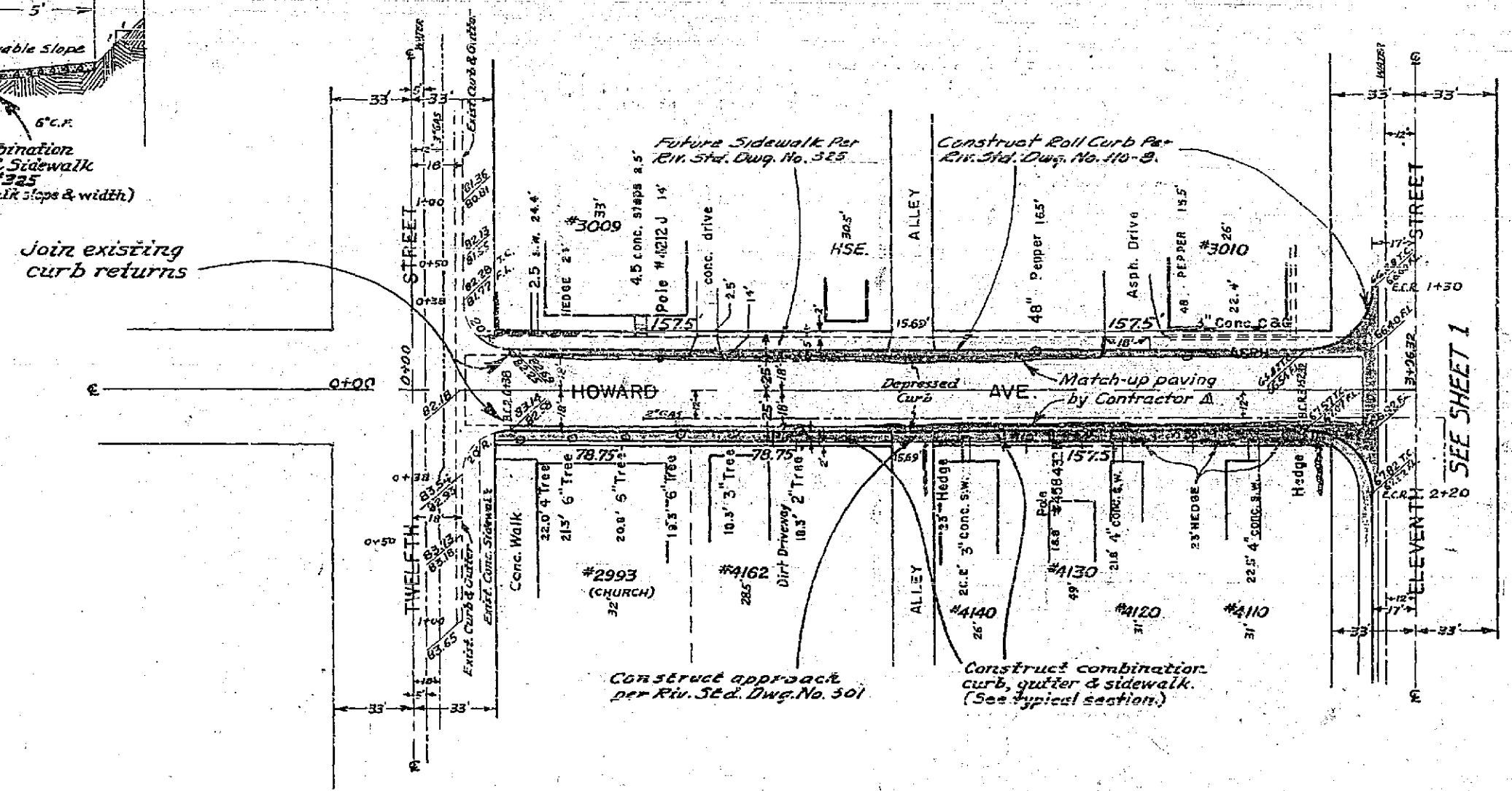

SCALE 1" = 50'

- NOTE:
- Contractor to remove trees and hedges interfering with construction.
  - Contractor to remove portions of private walls within public right-of-way where they interfere with construction.
  - Roads to be indicated by utility construction.
  - Driveways to be built per Riv. Std. Disp. No. 301 & only as far as back of sidewalk. Number of driveways, size & location to be determined by the field. Elevation to be based on one driveway per lot where curb, gutter, & sidewalk are to be constructed, each driveway estimated to be 18' wide outside. Grade driveway within 20' to provide access.
  - All applicable notes on Riv. Std. Disp. No. 200 covering concrete mix, spacing, expansion joints, etc., are to apply to construction of roll curb & gutter Riv. Std. Disp. No. 110-B.

BOTH CURB RETURNS:  
 R = 27.00'  
 Δ = 90°00'  
 L = 42.41'  
 T = 27.00'

REVISIONS			CITY OF RIVERSIDE CALIFORNIA DEPARTMENT OF PUBLIC WORKS
MARK	DATE	DESCRIPTION	
Δ	5-5-59	Revised Note 1 & match-up paving, etc.	REVISED HOWARD AVE & ELEVENTH ST. IMPROVEMENT DISTRICT
Δ	7/6/59	Change Riv. Std. Disp. No. 301 to Roll curb with no sidewalk.	
Δ	9/30/59	Change Gravel to Elev. L.P. 1/2 Bluff, N. 841	

DESIGNED BY W.S.G.	CHECKED BY J.L.B.	APPROVED BY <i>[Signature]</i> DIRECTOR OF PUBLIC WORKS	R-121
DRAWN BY B. Low	RECOMMENDED BY <i>[Signature]</i> ASSISTANT CITY ENGINEER	DATE 7-24-59	



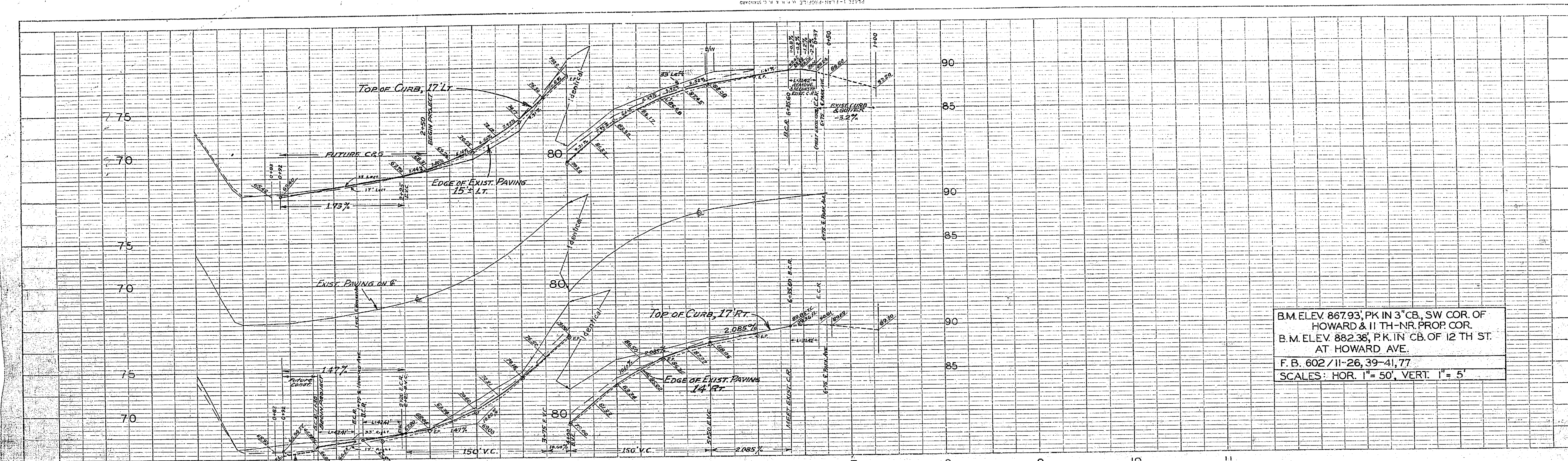

B.M. ELEV. 867.93, PK IN 3" CB, SW COR. OF HOWARD & 11 TH - NR PROP COR.  
 B.M. ELEV. 882.38, P.K. IN CB OF 12 TH ST. AT HOWARD AVE.  
 F. B. 602 / 11-26, 39-41, 77  
 SCALES: HOR. 1" = 50', VERT. 1" = 5'

**ELEVENTH STREET**

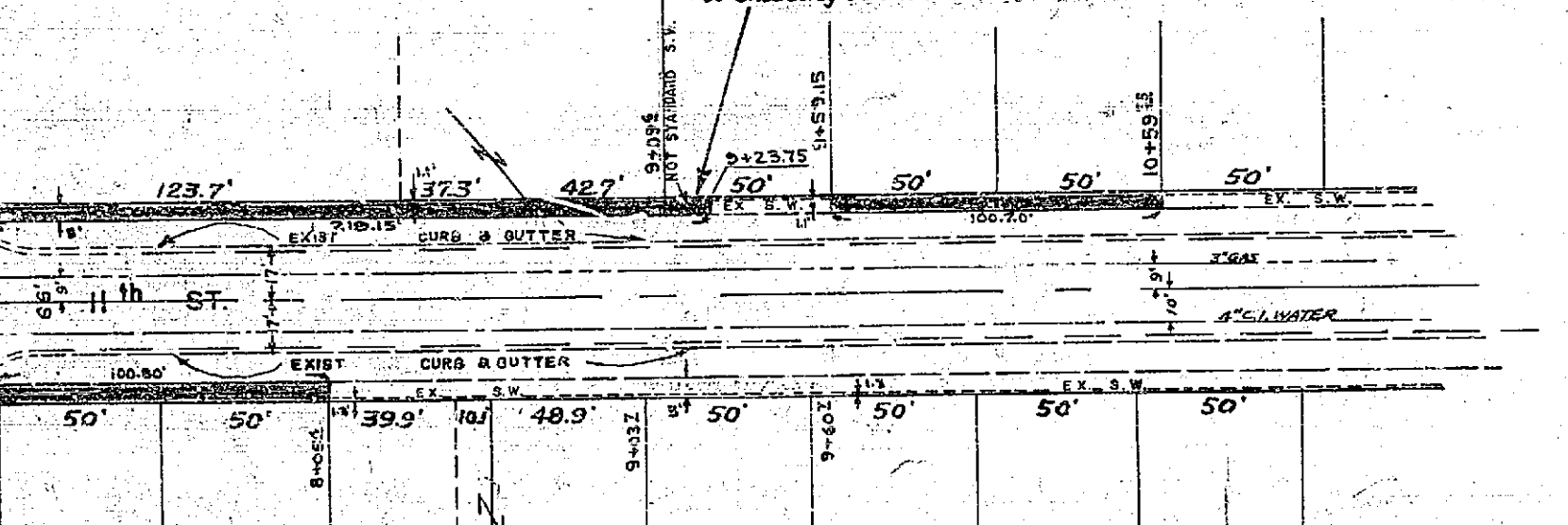
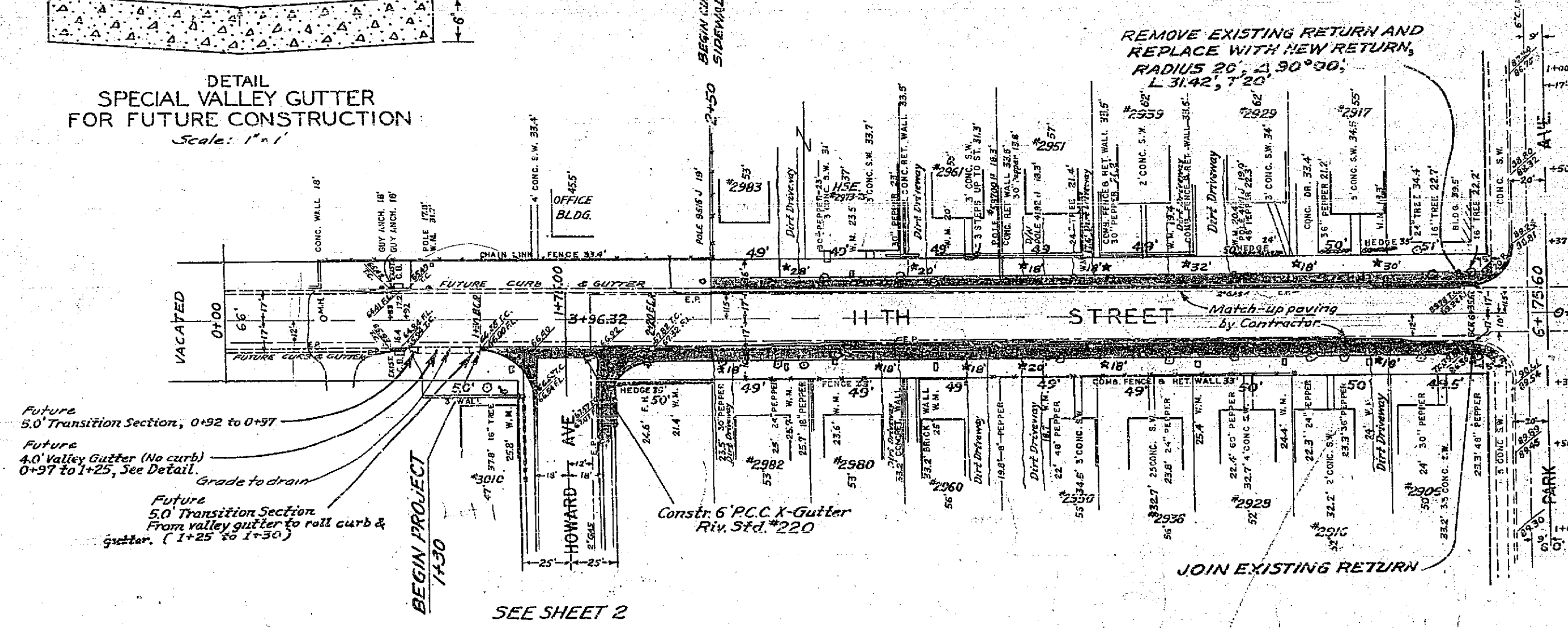
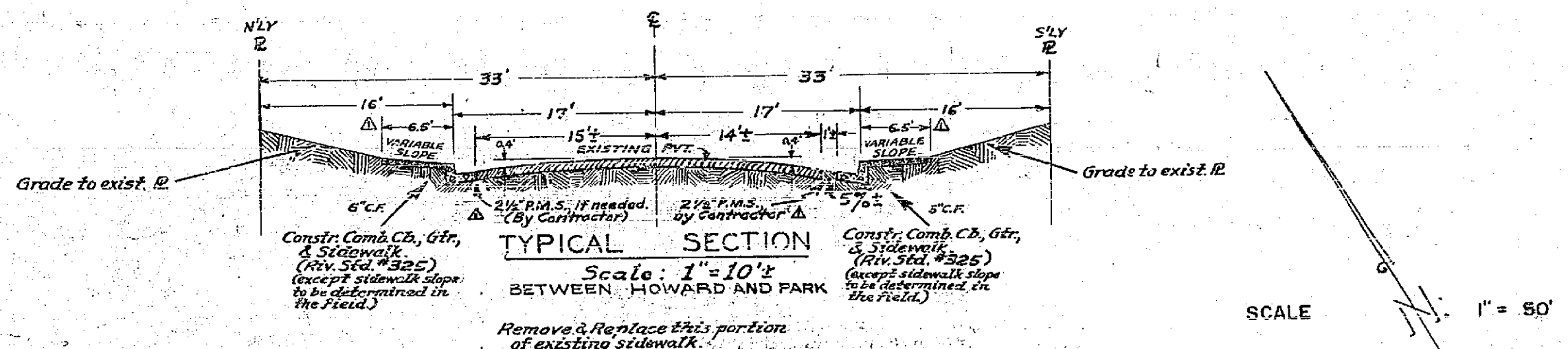
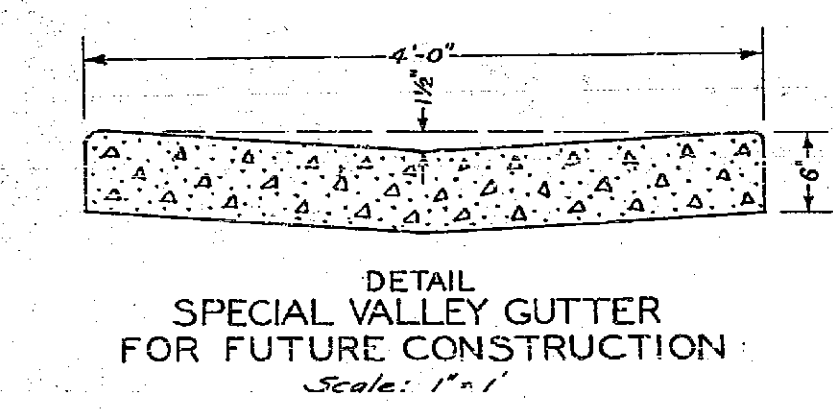

**NOTE:**  
 1- Contractor to join edge of existing paving to top of new gutter.  
 2- Contractor to construct sidewalks City of Park Avenue as per Riv. Std. # 350.  
 3- Contractor to remove trees interfering with construction.  
 4- Shape driveway approaches into sidewalk and increase walk thickness to 6" at approach. (City Ord.)  
 5- Water meters & poles to be relocated by utility concerned.  
 6- Driveways to be built per Riv. Std. # 350. If not shown in the field, estimate is based on lot dimensions, size & location to be determined in the field. Estimate is based on one driveway per lot where curb, gutter, sidewalk are to be constructed, each driveway estimated to be 14' wide overall, grade driveway within 2" of 1/4" slope.

REVISIONS			CITY OF RIVERSIDE CALIFORNIA DEPARTMENT OF PUBLIC WORKS
MARK	DATE	DESCRIPTION	
Δ	3-5-59	Revised Notes 1 & 3, n.s. sidewalk width, n.s.	REVISED <b>HOWARD AVE. &amp; ELEVENTH ST. IMPROVEMENT DISTRICT</b>
*	11-6-59	Changed valley gutter const. to future const. & changed const. sidewalk to existing sidewalk in section const. since original field notes were taken. n.s. Riv. Std. # 350.	
DESIGNED BY W.D.G. DRAWN BY B.L.W. RECOMMENDED BY [Signature]			CHECKED BY [Signature] APPROVED BY [Signature] DIRECTOR OF PUBLIC WORKS
DATE 2-24-59			R-121 SHEET 1 OF 2

PROFILE	DATE
SYMBOL	
NOTES	
DATE	

PLAN	DATE
SYMBOL	
NOTES	
DATE	