

STREET NAME SCHEDULE

| | |
|----------------|------|
| SIERRA GLEN DR | 5500 |
| AINSDALE WAY | 5400 |

Street name signs shall conform to City of Riverside Std. Dwg. No. 662

INDEX MAP

CURVE DATA

| Sta. | Δ | R | T | L |
|------|-------|-------|---------|---|
| 0+00 | 2700' | 2700' | 42.41' | |
| 0+57 | 2700' | 2511' | 40.45' | |
| 1+31 | 3180' | 9004' | 175.49' | |
| 3+37 | 2820' | 7985' | 155.63' | |
| 4+24 | 2700' | 7021' | 135.51' | |
| 6+22 | 3300' | | 151.37' | |

QUANTITY ESTIMATE

| | |
|---------------------------------------|-----------|
| Curb & Gutter Standard No. 200 (C-22) | 562 LF |
| Curb & Sidewalk Standard No. 325 | 6,774 SF |
| 2 1/2" A.C. seal coat | 19,510 SF |
| Cross Gutter Standard No. 220 | 524 SF |
| Imported Base Material | 624 CY |
| 2"x4" Redwood Header | 32 LF |
| Barricade Standard No. 180 | 1 EA |
| Curb & Gutter Standard No. 300 (C-37) | 568 LF |
| Driveway Approaches Standard No. 302 | 19 EA |

CONSTRUCTION NOTES

- Cast, Curb & Gutter Standard No. 200 (C-22)
- Cast, Curb Standard Standard No. 325
- Cast, 2 1/2" A.C. seal
- Cast, Cross Gutter Standard No. 220
- Cast, 2"x4" Redwood Header
- Cast, Barricade Standard No. 180
- Cast, Curb & Sidewalk Standard No. 300 (C-37)

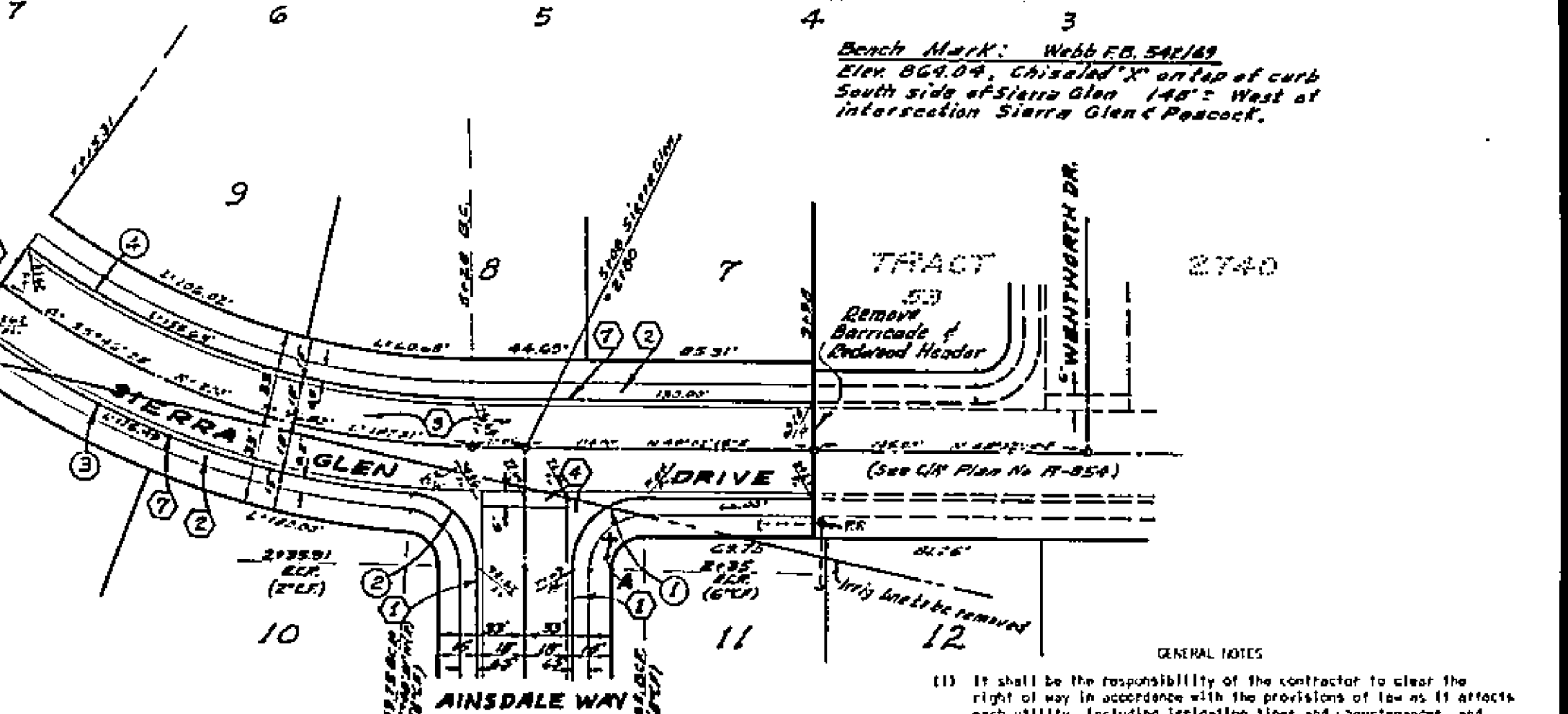

- GENERAL NOTES**
- It shall be the responsibility of the contractor to clear the right of way in accordance with the provisions of law as it affects each utility, including irrigation lines and waterlines, and at no cost to the City.
 - Construction shall be in accordance with the City of Riverside, Department of Public Works, Specifications No. 401 and Standard Drawings.
 - Prime coat, seal coat, and paint binder are required.
 - Grading will require a permit under Ordinance 2093 for a cut or fill exceeding 100 cubic yards, or a fill over one foot in depth.
 - The subdivider shall arrange for a soil test to be made by a Soil Engineer after the streets have been graded to rough grade. Depth of base material and A.C. paving shall be determined by City of Riverside Design Standards and Test Procedures.
 - Trim edge of existing pavement, where new paving joints existing pavement, to a clean, straight line. Construct match-up paving to show and center paving as directed in the field to produce a smooth crown section.
 - Driveways to be constructed per Std. Dwg. No. 302 and are to be located in the field.

| | | | |
|--|--|---|--|
| ALBERT A. WEBB ASSOCIATES CIVIL ENGINEERS RIVERSIDE, CALIFORNIA APPROVED BY: <i>[Signature]</i> DATE: 6/14/69 R.E. No. 3072 | CITY OF RIVERSIDE, CALIFORNIA DEPARTMENT OF PUBLIC WORKS APPROVED BY: <i>[Signature]</i> DATE: 6-23-69 DIRECTOR OF PUBLIC WORKS | STREET PLAN & PROFILE SIERRA GLEN DRIVE DELLVALE PLACE AINSDALE WAY TRACT No. 3786 | PROJECT NO. R-1212 SHEET 1 OF 1 FILE NO. GG-90 A |
| | | DESIGNED BY: <i>[Signature]</i> DRAWN BY: <i>[Signature]</i> CHECKED BY: <i>[Signature]</i> | |