

**GENERAL NOTES**

- It shall be the Responsibility of the Contractor to verify the City's Accuracies with provisions of minimum of 1/4" = 100' and to include in the Contract Documents and at no cost to the City of Riverside.
- Construction shall be in accordance with the City of Riverside Dept. of Public Works Specification W-461 and Standard Drawings.
- Prime Coat, Seal Coat and Final Surface are required.
- Trim Edges on Existing Pavement where New Sidewalk Joins Existing Pavement to a depth of 4" below existing surface. All trim to be finished to slope and finished with Crown Squeegee.
- For relocation of any City Department on Intersection Water Facility or Electric Power Utility facilities, to be done by the City of Riverside. The City Water Commercial Engineer at 187-7441, Schedule about 2 weeks to process a Work Order, before relocation begins.
- Grading will require a permit under Ordinance 3283 for a cut or fill exceeding 100 cu. yds, or a fill over one foot in depth.
- The amount of Asphalt overlay on existing pavement has been estimated by the Engineer to be approximately 22 tons.

**CONSTRUCTION NOTES**

- CONST. R.C.C. CURB & GUTTER PER CURB BENCH RIV. CITY STD. NO. 200
- CONST. R.C.C. DRIVEWAY PER CITY STD. NO. 302 A=10' B=23'
- CONST. R.C.C. SIDEWALK RIV. CITY STD. NO. 350
- PLACE 2 1/2" A.C.W. SEAL COAT OVER BITUM. BASE
- CONST. 2"x4" R/W HEADER
- EXCAVATION
- CONST. A.C. OVERLAY/SEAL COAT OVER EXISTING PAVEMENT IN AREA SHOWN THUS
- RELOCATE EXISTING SPEED LIMIT SIGN AS DIRECTED.

**QUANTITY ESTIMATE**

NO.	DESCRIPTION	QUANTITY	UNIT
1	CONST. R.C.C. CURB & GUTTER PER CURB BENCH RIV. CITY STD. NO. 200	100	L.F.
2	CONST. R.C.C. DRIVEWAY PER CITY STD. NO. 302 A=10' B=23'	254	S.F.
3	CONST. R.C.C. SIDEWALK RIV. CITY STD. NO. 350	420	S.F.
4	PLACE 2 1/2" A.C.W. SEAL COAT OVER BITUM. BASE	720	S.F.
5	CONST. 2"x4" R/W HEADER	52	L.F.
6	EXCAVATION	28	C.Y.
7	CONST. A.C. OVERLAY/SEAL COAT OVER EXISTING PAVEMENT IN AREA SHOWN THUS	9.5	TONS

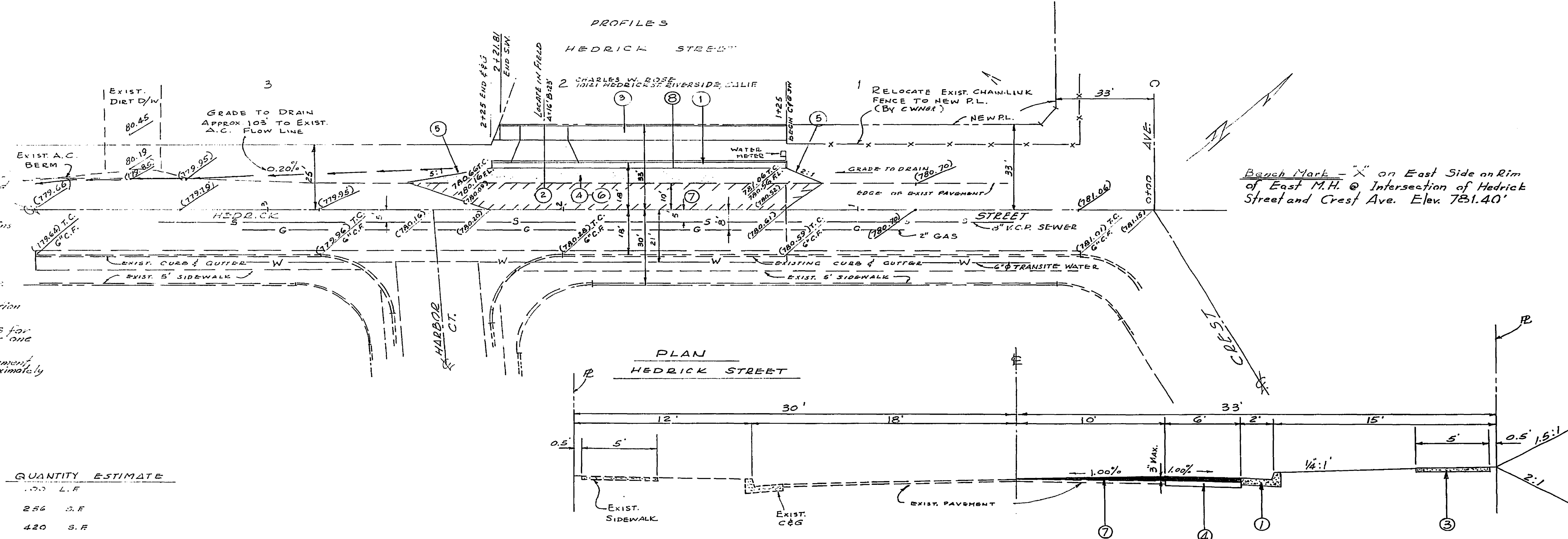

TYPICAL CROSS SECTION  
HEDRICK STREET  
SCALE: 1" = 4'

<b>THORNE SURVEYING SERVICE</b> RIVERSIDE, CALIFORNIA <b>C. V. BROWN JR. CIVIL ENG.</b> APPROVED: <i>[Signature]</i> DATE: 1-23-67		<b>CITY OF RIVERSIDE, CALIFORNIA</b> <b>DEPARTMENT OF PUBLIC WORKS</b> APPROVED BY: <i>[Signature]</i> DATE: 9-11-67 ASSISTANT CITY ENGINEER		PROJECT NO. <b>R-1217</b> SHEET 1 OF 1 FILE NO.
DESIGNED BY: C.V.B. DRAWN BY: W.D.L. CHECKED BY:		REVISIONS:		PLAN AND PROFILE N/W SIDE HEDRICK STREET 1+25 - 2+25 S.W. CREST AVENUE 10121 HEDRICK STREET HORIZ. SCALE: 1" = 20' VERT. SCALE: 1" = 4'