

- STREET LIGHT LEGEND / NOTES**
- Indicates City of Riverside standard light standard No. 68110 with 24" x 24" x 40" W. Type III "Line Material" mercury vapor laminaire. C.C. No. LM 532E or approved equal.
 - Indicates No. 3/4 pullbox "Brooks Products Inc." or approved equal.
 - Indicates 1" rigid galv. steel conduit, except as noted.
 - Indicates existing Standard.
- All street light standards and pullboxes to be located in the field by contractor according to notes and approved by utilities personnel.
 - All street light standards shall be checked for clearance of driveways and placed 1' from end of curb returns.
 - See City of Riverside Div. No. 11-13011 for light standard details, and Div. No. 11-13003 for pullbox details.
 - All cable to be AWG No. 8 copper.
 - This is a 2-wire 240 volt multiple system.
 - All construction to comply with City of Riverside Street Light Specifications.
 - Excavations to be called for as outlined in specifications.
 - Feed point to be confirmed at time of construction.
 - See R.E. inspection fee to be paid. (date paid)
 - The City of Riverside Traffic Engineering Division will pay 50% toward the cost of this project to the Developer upon completion of the work or receipt of statement from the Developer.
 - Excavation for street light standards, pullboxes and conduits must be done in 10' wide excavation with curb & gutters, and before installation of sidewalks.
 - Backfill to be of type and compacted as specified by City of Riverside Public Works Dept.
 - Contractor to obtain a street lighting permit from City of Riverside Public Works Department before using any excavation in proposed or dedicated street right-of-way.

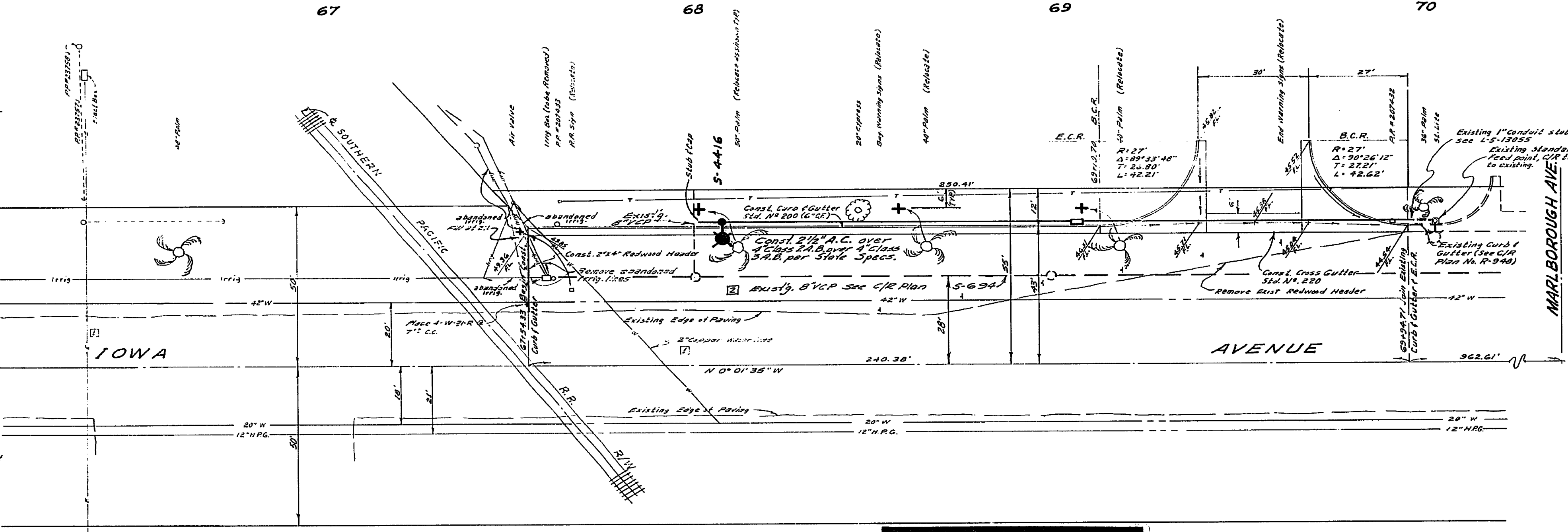
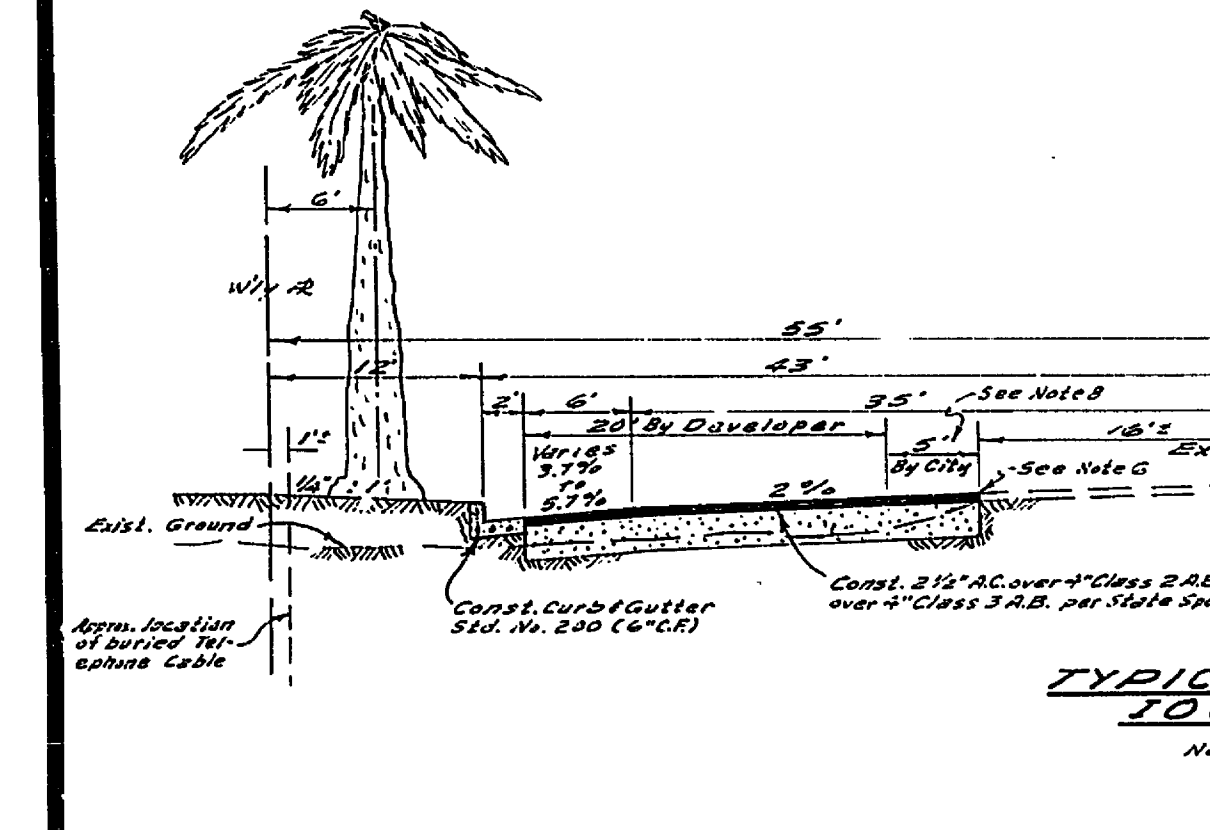

- GENERAL NOTES**
- It shall be the responsibility of the contractor to clear the right of way in accordance with the provisions of the 1951 Act, and to provide for the protection of existing structures, lines, and appurtenances, and at his cost to the City.
 - Construction shall be in accordance with the City of Riverside Department of Public Works, Specifications, Standard and Standard Drawings.
 - Prime coat, base coat, and point binder are not shown.
 - Gravel will require a permit under Department Order for a permit to fill exceeding 100 cubic yards, or a fill over one foot in depth.
 - The City of Riverside shall arrange for a soil test to be made at the location of the proposed improvement to be determined by the City of Riverside Design Standards and Test Procedures.
 - The edge of existing pavement, where new paving joints are to be placed, or a new, straight line. Contract markings shall be shown and clearly visible in the field in the first 100 feet of a month of construction.
 - The finished subgrade shall have a compaction of not less than 96% for a depth of 6" below as determined by test method No. "C" of the City of Riverside, immediately prior to placement of cover.
 - Contractor to negotiate with the City Engineer for the construction of the City portion of this improvement two weeks prior to construction.
 - The base material shall not be installed until the sewer per City of Riverside Div. No. 5 has been installed to the specs of the Public Works Dept.
 - Contractor shall raise or lower existing manholes as required, to meet top of new pavement.

QUANTITY ESTIMATE

Curb & Gutter Standard No. 200 (6" CR)	241 L.F.
2 1/2" A.C. and Seal Coat	3,630 S.F.
24" Redwood Header	24 L.F.
Imported Base Material	90 C.Y.
Trees to be relocated	3 EA.
2 1/2" A.C. and Seal Coat (By City)	560 S.F.
Imported Base Material (By City)	14 C.Y.
Cross Gutter Standard No. 200	516 S.F.

-CAUTION- PACIFIC TELEPHONE CABLES UNDERGROUND BEFORE EXCAVATING

CALL COLLECT:

Alter Hours	7:30 A.M. to 5 P.M. & Holidays
Orange County	714-633-0811 - 714-547-6606
Riverside County	714-684-0071 - 714-547-6606
Inyo County	714-684-0071 - 714-547-6606
San Bernardino County	714-684-0071 - 714-547-6606
Los Angeles County	213-621-3111 - 24 HOUR SERVICE
Ventura County	213-621-3111 - 24 HOUR SERVICE
San Diego County	714-298-0555 - 714-232-0027

FOR FREE CABLE LOCATING SERVICE

Approved by Irrigation Div.
Howard L. Cream
 GEN. SUPV. ENGINEER
 DATE: 3-8-67

Approved for Street Lights
James Marshall
 GEN. SUPV. ENGINEER
 DATE: 3-2-67

ALBERT A. WEBB ASSOCIATES
 CIVIL ENGINEERS
 RIVERSIDE, CALIFORNIA

APPROVED BY: *[Signature]* DATE: 3/2/67
 R.E. No. 9876

W.O. 6756 FOR: Southwest Eng. Products 1.8.62

CITY OF RIVERSIDE, CALIFORNIA DEPARTMENT OF PUBLIC WORKS

APPROVED BY: *[Signature]* DATE: 3-13-67
 OFFICE ENGINEER
 PARK DEPARTMENT
 TRAFFIC DIVISION

APPROVED BY: *[Signature]* DATE: 4-28-67
 DIRECTOR OF PUBLIC WORKS

ASSISTANT CITY ENGINEER

S.R. # 494 R-50

STREET PLAN & PROFILE

IOWA AVENUE
 WEST SIDE, BETWEEN 30th ST. & R.R. AND MARLBOROUGH AVE.

M.P. 3-667

PROJECT NO. **R-1220**
L-5-13237
 SHEET 1 OF 1

HORIZ. SCALE: 1" = 20' VERT. SCALE: 1" = 4'

FILE NO. 67-56-1