

BENCH MARK  
 Sta. 824.00, P.C. in road W. curb of Palm Ave on E. of  
 M<sup>c</sup>Crays St. produced C.S.P. R.S. 650/256

- GENERAL NOTES
- (1) It shall be the responsibility of the contractor to clear the right of way in accordance with the provisions of law as it affects each utility, including irrigation lines, and appurtenances, and at no cost to the City.
  - (2) Construction shall be in accordance with the City of Riverside, Department of Public Works, Specifications No. 461 and Standard Drawings.
  - (3) Prime coat, seal coat, and paint binder are required.
  - (4) Grading will require a permit under Ordinance 5093 for a cut or fill exceeding 100 cubic yards, or a fill over one foot in depth.
  - (5) The subdivisor shall arrange for a soil test to be made by a Soils Engineer after the streets have been prepared to rough grade. Depth of base material and A.C. paving shall be determined by City of Riverside Design Standards and Test Procedures.
  - (6) Trim edge of existing pavement, where now paving joins existing pavement, to a clean, straight line. Construct match-up paving as shown and overlay paving as directed in the field to produce a smooth crown section.
  - (7) The Contractor to contact Port Dept. phone 787-7300 for location of the utility and the Public Utilities Dept. phone 462-7500 for street light locations, prior to construction of curb type sidewalk.
  - (8) The amount of asphalt overlay on existing pavement has been estimated by the Engineer to be approximately 84 tons.
  - (9) The size, location & number of Driveway Approaches to be approved by Traffic Engineer prior to any construction.
  - (10) All trees that are affected by construction are to be relocated per Port Dept. Specifications and direction. The new locations are not shown. It is the Contractor's responsibility to contact Port Dept. prior to construction for locations.

QUANTITY ESTIMATE

Curb & Gutter Standard No. 200 (C.C.P.)	426 LF
3 1/2" A.C. & Seal Coat	5,990 SF
2 1/2" A.C. & Seal Coat	2,317 SF
Sidewalk Standard No. 325	1,830 SF
Sidewalk Standard No. 350	757 SF
Catch Basin Standard No. 405	1 EA
12" R.C.P. 2000	35 LF
Driveway Approach Standard 302	332 SF
Driveway Approach (Special)	280 SF
Curb & Gutter Removal	530 LF
Sidewalk Removal	2,000 SF
W-21-R	1 EA
Palm tree Relocation	9 EA
Imported Base Material	175 CY

ALBERT A. WEBB ASSOCIATES CIVIL ENGINEERS RIVERSIDE, CALIFORNIA APPROVED BY: <i>[Signature]</i> DATE 1/14/67 R.E. NO. 9876 W.O. 67-425 FOR: AUTO. CLUB OF SO. CALIF. FB.	CITY OF RIVERSIDE, CALIFORNIA DEPARTMENT OF PUBLIC WORKS OFFICE ENGINEER: <i>[Signature]</i> DATE 7-13-66 TRAFFIC DIVISION: <i>[Signature]</i> DATE 5-12-66 ASSISTANT CITY ENGINEER: <i>[Signature]</i> DATE 7/15/66	STREET PLAN & PROFILE PALM AVENUE E. SIDE BETWEEN TIBBETTS ST. & M <sup>c</sup> CRAY STREET Z.C. NO. R-29-678 HORIZ. SCALE: 1" = 20' VERT. SCALE: 1" = 4'	PROJECT NO. R-1273 15-13298 SHEET 1 OF 2 FILE NO. 67-425-A
	APPROVED BY: <i>[Signature]</i> DATE 4-17-68 DIRECTOR OF PUBLIC WORKS		



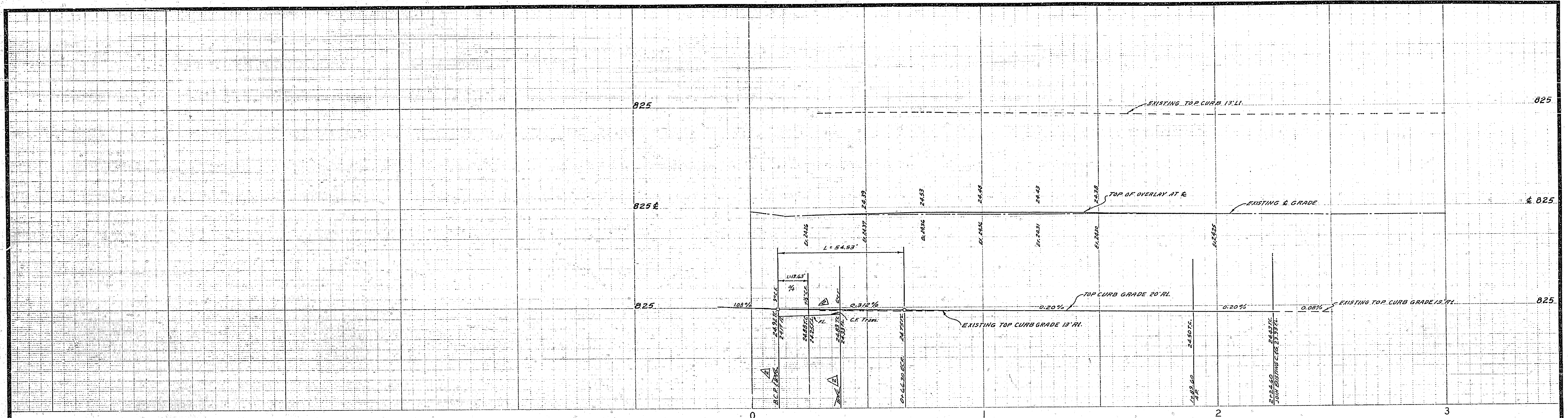

BENCH MARK  
Elev. 824.00, P.C. in East W/4 curb of Palm Ave at  
E of McCray St. produced, CIP F.B. 6/8/56

- STREET LIGHT NOTES**
- (1) All street light standards and pullboxes to be field located by contractor, according to plans, and approved by utilities personnel.
  - (2) All street light standards shall be checked for clearance of driveways, fire hydrants, and radius returns.
  - (3) Excavation for street light standard bases, pullboxes, and conduits must be done after installation of curbs and gutters, but before installation of sidewalks.
  - (4) Contractor to obtain a street opening permit from City of Riverside Public Works Department prior to any excavation in proposed or dedicated street Right-of-Way.
  - (5) Backfill to be of type and compacted as specified by City of Riverside Public Works Department Specification #461.
  - (6) All construction to comply with the latest revision of the City of Riverside Public Utilities Department Street Light Specification #119.
  - (7) Inspectors to be called for as outlined in Specification #119.
  - (8) This is a two wire 240 volt multiple system.
  - (9) All cable to be as specified in Specification #119.
  - (10) Feed point(s) to be confirmed at time of construction.
  - (11) See City of Riverside Div. No. 11-13008 for Light Standard Details, and Div. No. 11-13201 for Pole Details.
  - (12) \$89.00 connection and inspection fees to be paid **2-0-68** (date paid)
  - (13) \$225.00 fee for mast arm installation to be paid **2-0-68** (date paid)

- STREET LIGHT LEGEND**
- ⊗ Indicates City of Riverside standard light standard in 450A with 7000L, 175W, 120V, 12' height as indicated. "Line Material" measures under dimensions with individual photoelectric, receptacle and control unit. CIP No. LM 2741 or approved equal.
  - Indicates 1" rigid galv. steel conduit, except as noted.
  - ⊙ Indicates mast arm with mast arm light installed by Utility Dept. upon receipt of payment of \$225.00.
  - Indicates existing facilities.

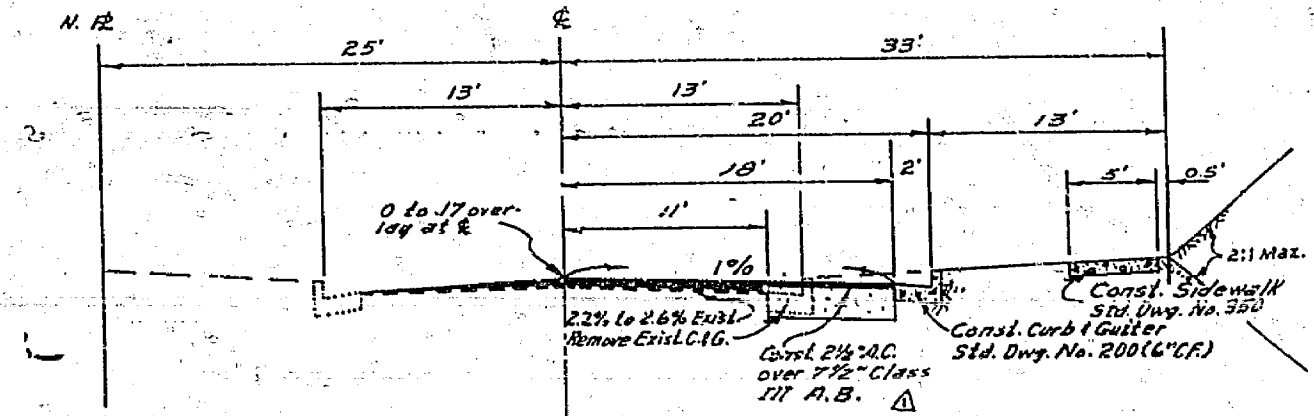
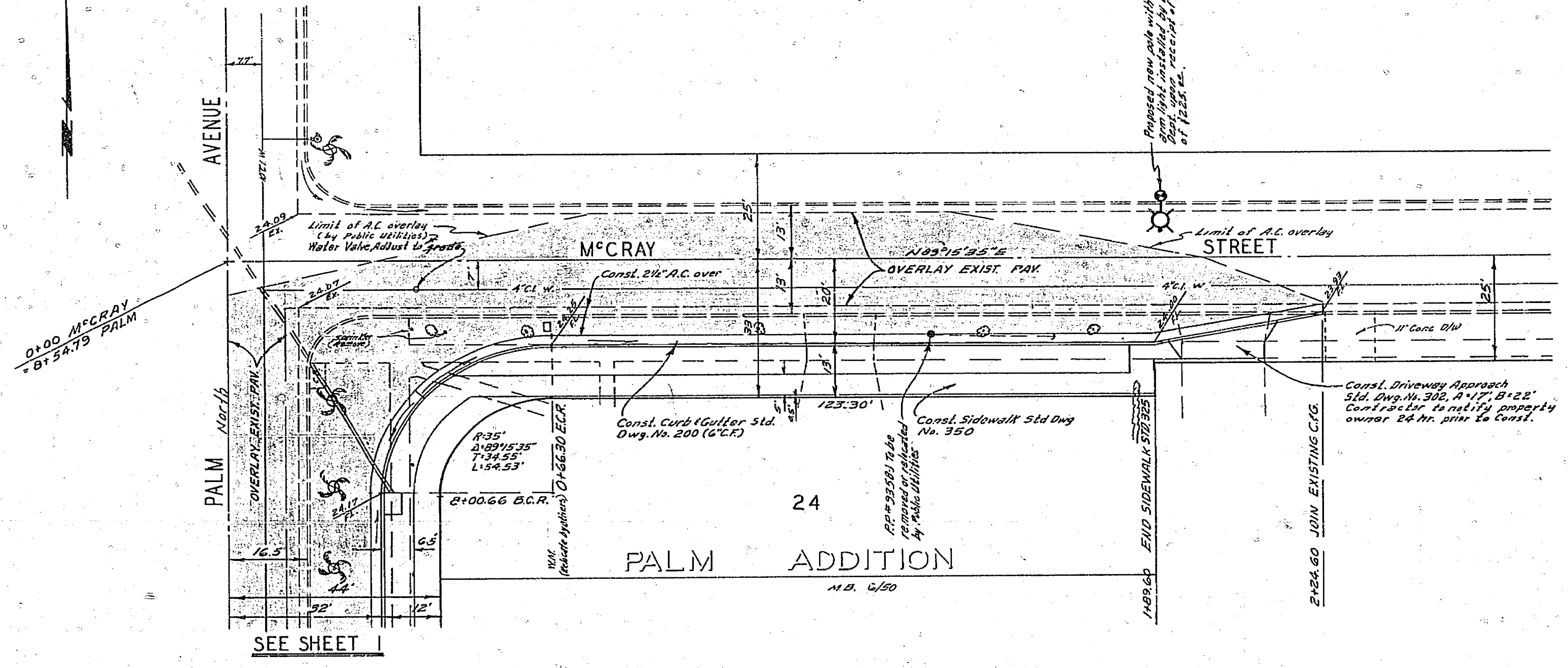

TYPICAL SECTION  
MCCRAY STREET  
NO SCALE  
7.1. = 5

ALBERT A. WEBB ASSOCIATES CIVIL ENGINEERS RIVERSIDE, CALIFORNIA		CITY OF RIVERSIDE, CALIFORNIA DEPARTMENT OF PUBLIC WORKS		STREET PLAN & PROFILE MCCRAY STREET		PROJECT NO. R-1273	
APPROVED BY: <i>Albert A. Webb</i> DATE: 4/17/69 R.E. NO. 9876		APPROVED BY: <i>Alvin L. ...</i> DATE: 4-17-69 TRAFFIC DIVISION ASSISTANT CITY ENGINEER		S.S. BETWEEN MAGNOLIA AVE. & PALM AVENUE Z.C. NO. R-29-678		L5-13298 SHEET 2 OF 2	
DESIGNED BY: B.E.L. DRAWN BY: B.E.L. CHECKED BY: F.		DATE: 5-12-68		HORIZ. SCALE: 1" = 20'		VERT. SCALE: 1" = 4'	
W.O. 67-425 FOR: AUTO. CLUB OF SO. CALIF. FB.				FILE NO. 67-425-A			