

CONSTRUCTION LEGEND

MATCH EXIST. DEPRESS BACK OF D/W IF NECESSARY

320 A CONST. CURB AND GUTTER PER STD. DWS. 200 CURB FACE AS NOTED ON CURB PROFILES.

322 CONST. DRIVEWAY APPROACH PER STD. DWS. 802. DIMENSION AS SHOWN ON THE PLAN. STATIONS SHOWN ON PLAN ARE ± 2'.

325 A CONST. CURB SIDEWALK PER STD. DWS. 325-A BACK OF SIDEWALK TO MEET EXIST. SIDEWALK AT SAWCUTS TO LIMITS SHOWN ON PLAN.

320 A CONST. SIDEWALK PER STD. DWS. 320-A BACK OF SIDEWALK TO MEET EXIST. SURFACE.

405 CONST. CATCH BASIN PER STD. DWS. 405. OPENINGS AND 'V' AS SHOWN ON PLAN.

425 CONST. CLEANOUT BOX PER STD. DWS. 425 AND AS SHOWN IN DETAILS AS SPECIFIED.

1 OVERLAY EXIST. PAVEMENT WITH VARIABLE THICKNESS OF ASPHALT CONCRETE.

2 PLACE ASPHALT CONCRETE PAVEMENT PER ALTERNATES SHOWN IN STRUCTURAL SECTION SCHEDULE ON THIS SHEET.

3 REPLACE OR REGRADE AREA TO ELEVATIONS FURNISHED BY ENGINEER. MATERIAL AS SHOWN ON PLAN.

4 ADJUST EXIST. MANHOLE TO GRADE.

L INDICATES LIMITS OF CONSTRUCTION.

E REMOVE EXIST. TREE. "I" INDICATES TREE DIAMETER OF 6" TO 18". "II" INDICATES TREE DIA. OF 18" TO 24". "III" INDICATES TREE DIAMETER OF OVER 24". TREES WITH DIAMETERS LESS THAN 6" SHALL BE REMOVED AS PART OF CLEARING & GRUBBING.

STA. LEAVE 8" DIAM. HOLE IN PROPOSED SIDEWALK FOR STREET SIGNS. CENTER OF HOLE TO BE 2' FROM CURB FACE AT STATIONS SHOWN ON PLAN.

PROPOSED TELEPHONE CONDUIT TO BE INSTALLED AT TIME OF STREET CONSTRUCTION.

PROPOSED STORM DRAIN PIPES TO BE INSTALLED AS PART OF THE STREET CONSTRUCTION.

CONST. DISINTEGRATED GRANITE WALKWAY (90% RELATIVE COMPACTION) WIDTH SHOWN ON PLAN.

GENERAL CONSTRUCTION NOTES

- WHERE NEW CONSTRUCTION IS INDICATED:
 - CLEAR AND GRUB.
 - REMOVE CURB, GUTTER AND SIDEWALK.
 - REMOVE ALL A.C. PAVEMENT EXCEPT WHERE OVERLAY OF EXISTING PAVEMENT IS SHOWN ON PLAN.
 - RIGHTS OF ENTRY FOR WORK ON PRIVATE PROPERTY HAVE BEEN OBTAINED.
- CURB AND GUTTER, SIDEWALK AND DRIVEWAY REMOVAL SHALL BE TO THE LIMITS SHOWN ON THE PLAN OR TO THE NEAREST CONSTRUCTION JOINT BEYOND THE PLAN LIMITS.
- TRANSITION NEW CONSTRUCTION TO MEET EXISTING AS DIRECTED BY THE ENGINEER.
- EXISTING DRAIN PIPES THROUGH THE CURB SHALL BE CUT BACK OR RECONSTRUCTED TO EXIT THROUGH NEW CURB.
- PLACE OPENGRADED ASPHALT CONCRETE AS SHOWN ON TYPICAL SECTIONS AND AS DIRECTED BY THE ENGINEER.
- ALL TRAFFIC SIGNS IN AREA OF CONSTRUCTION SHALL BE SALVAGED BY THE CONTRACTOR AND TURNED OVER TO THE CITY OF RIVERSIDE PUBLIC SERVICE DEPARTMENT. STREET NAME SIGNS SHALL BE RELOCATED BY THE CONTRACTOR WHERE DESIGNATED ON THE PLAN BY (X) AND SHALL BE SET PER SIGNS IN AREAS OF NEW CONCRETE. THE SIGNS SHALL BE PLACED IN 8" DIAMETER HOLES LEFT PER PLAN ABOVE.
- CONTRACTOR TO EXPOSE EXIST. STORM DRAIN STUBS FOR IDENTIFICATION OF ELEVATIONS PRIOR TO ISSUANCE OF GRADE SHEETS FOR CONNECTOR PIPES. FORM 4" THICK CONCRETE COLLAR WHERE MEETING EXIST. STUB. CONTRACTOR SHALL BE RESPONSIBLE TO REPAIR OR REPLACE IN KIND AT HIS OWN EXPENSE ANY CULVERTS DAMAGED BY HIS CONSTRUCTION.
- SPRINKLERS SHALL BE CUT AND SEALED AT THE PROPERTY LINE WHERE SHOWN ON THE PLAN OR REQUIRED BY THE ENGINEER.
- THESE PLANS ARE FOR STREET CONSTRUCTION ONLY. STREET LIGHTS SHALL BE CONSTRUCTED FROM THE ATTACHED PLAN, NO. L5-4842.

RIVERSIDE CALIFORNIA



**PUBLIC WORKS DEPARTMENT
BROCKTON AVENUE WIDENING
MAGNOLIA AVENUE TO JURUPA AVENUE**

LENGTH OF PROJECT = 2460 Feet = 0.47 Mile

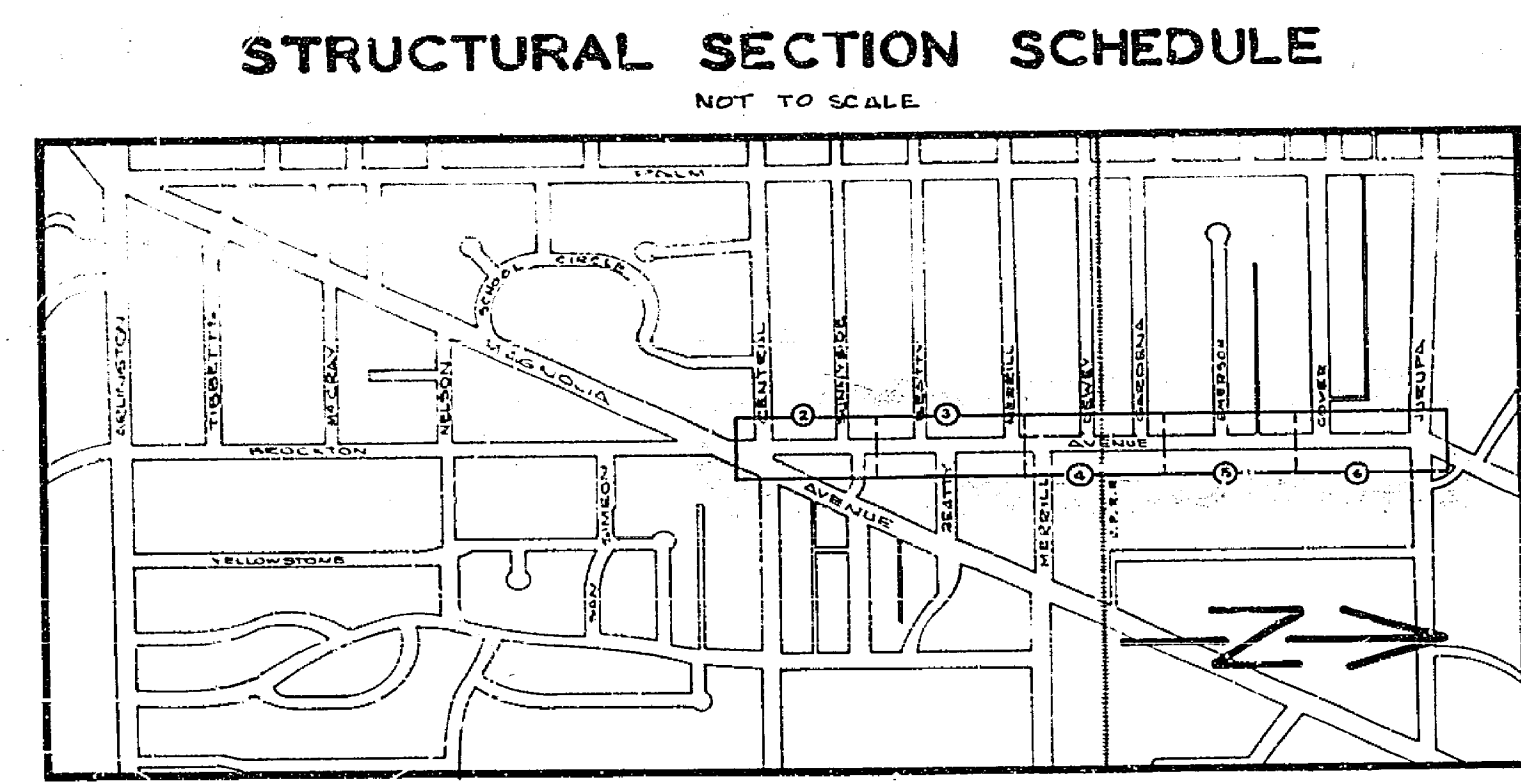
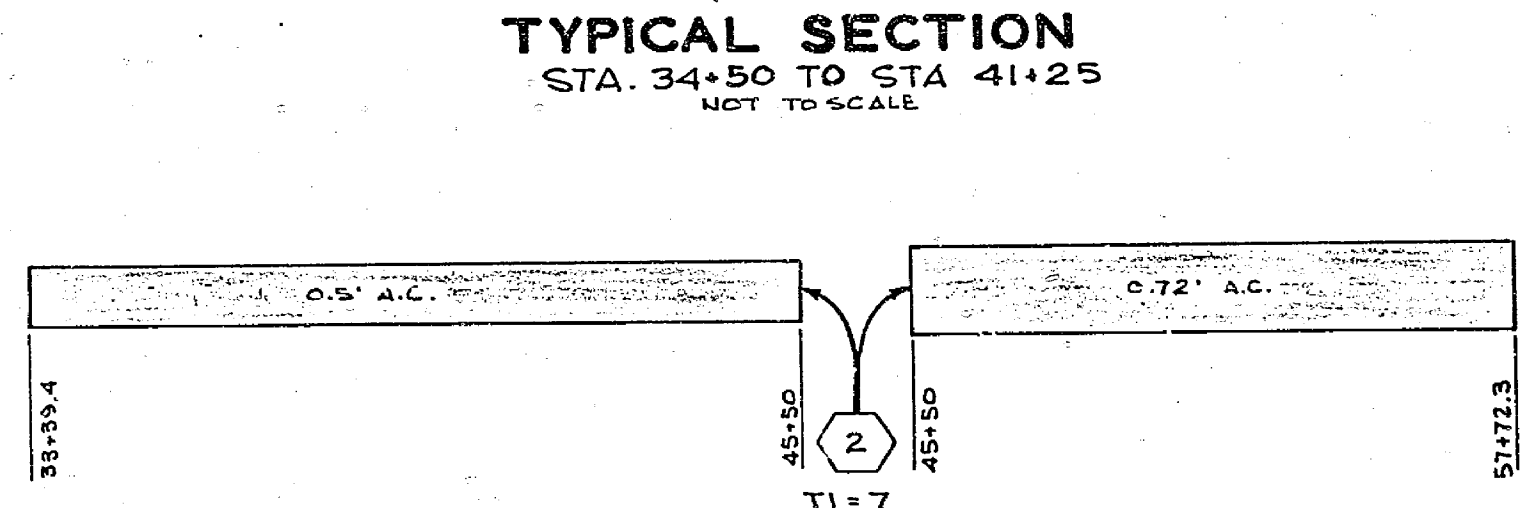
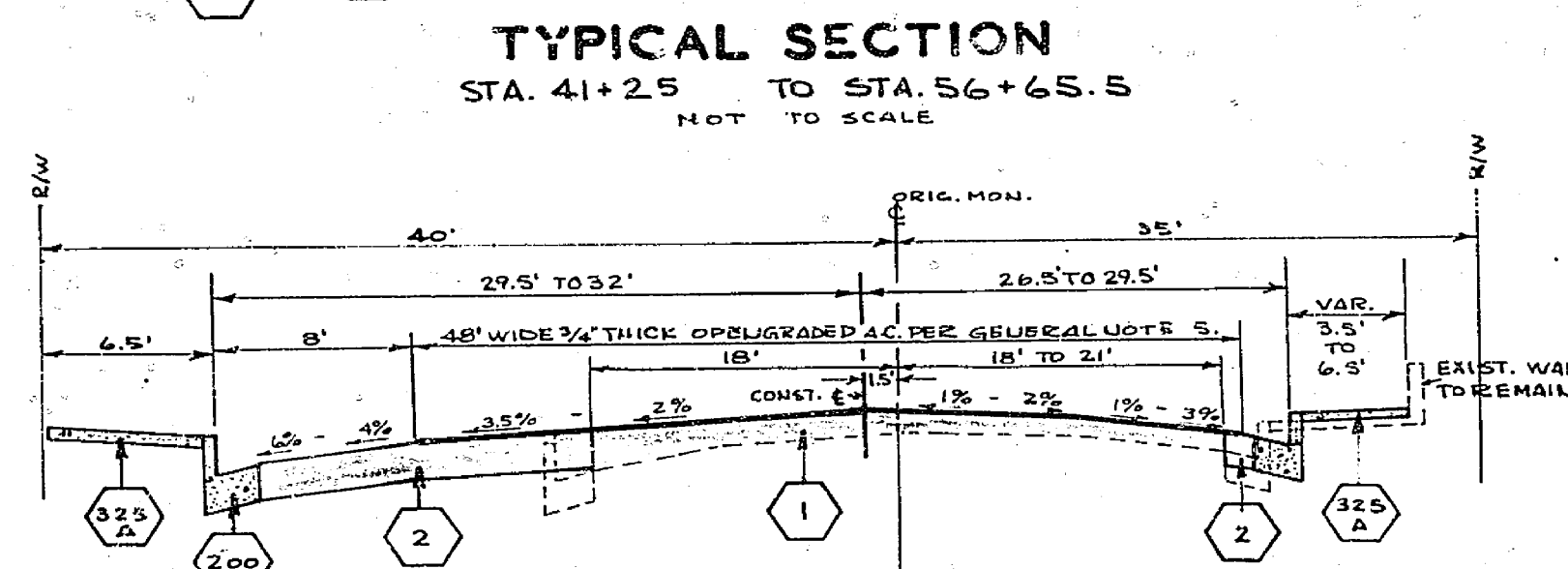
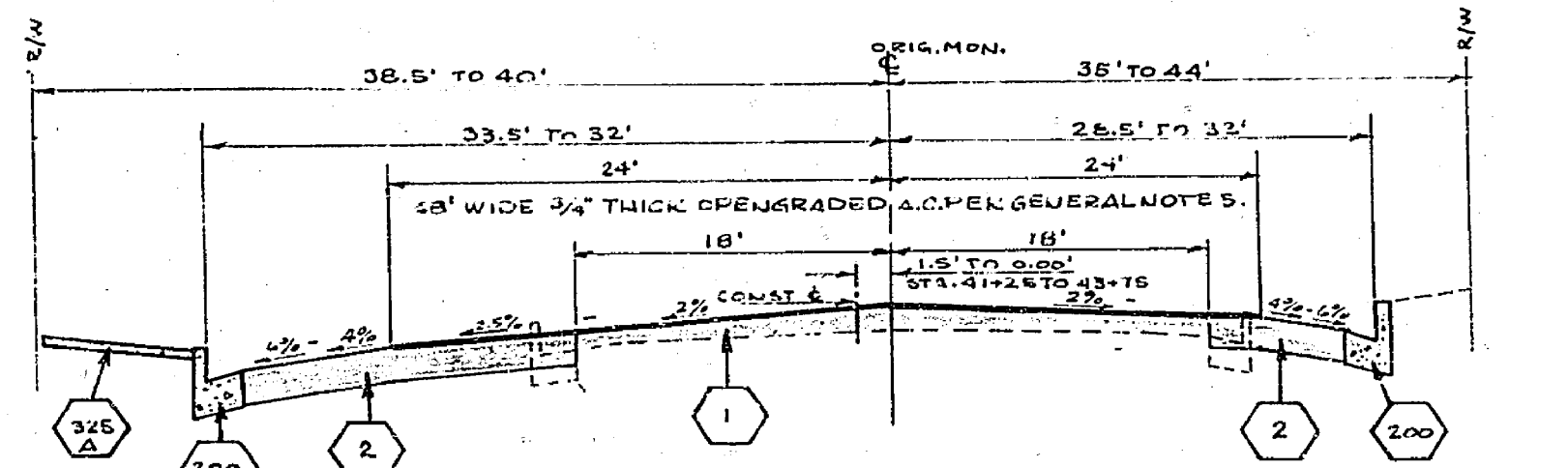

PROJECT LOCATION MAP
SCALE: 1" = 800'

CONFLICTING SEWER LATERALS

- NOTES:
- EXACT LIMITS OF LOWERING AND/OR ENCASING SHALL BE DETERMINED BY THE INSPECTOR AT TIME OF CONSTRUCTION.
 - THE CONTRACTOR SHALL EXPOSE EXIST. LATERALS AND OTHER UTILITIES AS NECESSARY FOR THE INSPECTOR TO DETERMINE THE LIMITS AND GRADE OF LOWERING AND/OR ENCASING.

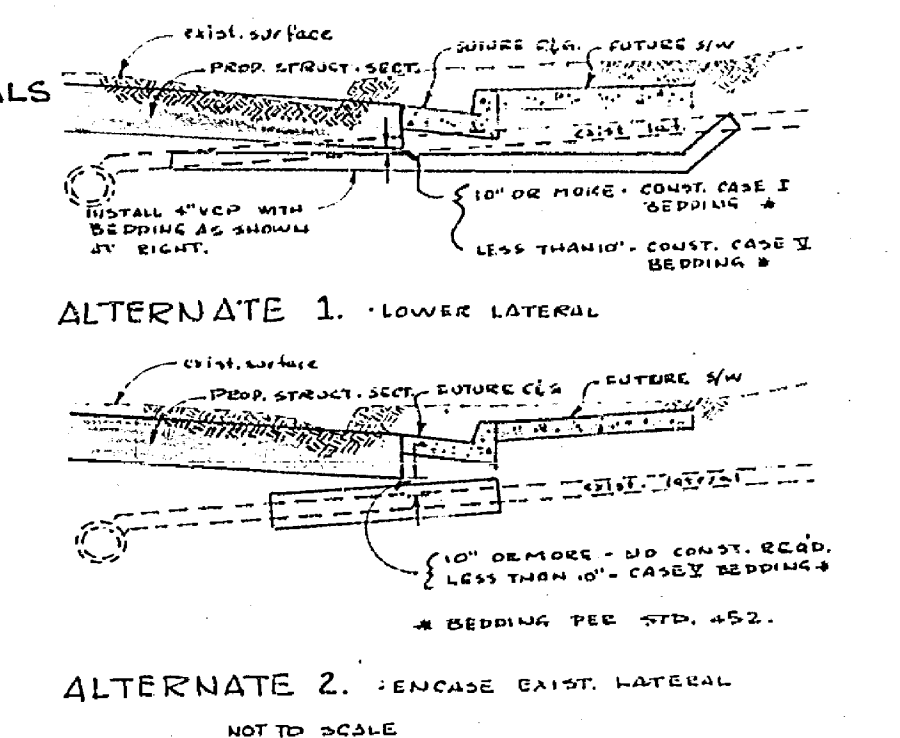

EXISTING CULTURE & UNDERGROUND LEGEND

EXISTING UNDERGROUND UTILITIES

SANITARY SEWER	8" VCP - S	TELEPHONE CONDUIT	T - T
WATER LINE	8" CI - W	ELECTRICAL CONDUIT	E - E
STORM DRAIN	24" RCP - SD	STREET LIGHTING	SL - SL
CULVERT	18" CONC - C	TRAFFIC SIGNAL	SIG - SIG
IRRIGATION LINE	20" IRR	FIRE ALARM	F - F
GAS LINE	3" - C	ABANDONED UTILITY	- - -

EXISTING TOPOGRAPHY

CENTER LINE	- - - - -	PROPOSED TOP OF SLOPE	- - - - -
RIGHT-OF-WAY LINE	R/W - - - - -	PROPOSED TOE OF SLOPE	- - - - -
SUBDIVISION LOT LINE	P - - - - -	PROPOSED DIRECTION OF FLOW	- - - - -

(S) SANITARY SEWER MH	(O) POWER POLE	(R) RAILROAD TRACKS
(S-C) SANITARY SEWER CLEANOUT	(O-P) POLE & GUY ANCHOR	(R-S) RAILROAD SIGN
(SD) STORM DRAIN MH	(DPB) PULL BOX	(R-SG) RAILROAD SIGNAL
(W) IRRIGATION WEIR	(P) PARKING METER	(S) STREET LIGHT
(W-MH) WATER MH	(FA) FIRE ALARM BOX	(T) TRAFFIC SIGNAL
(G) GAS MH		(T-M) TRAFFIC SIGNAL ON MAST ARM
(E) ELECTRIC MH		(T-C) TRAFFIC CONTROL BOX
(T) TELEPHONE MH OR VAULT		(T-D) TRAFFIC SIGNAL DETECTOR
		(P-C) PEDESTRIAN CONTROL FOR TRAFFIC SIGNAL

(M) WATER METER	(G) GAS METER	(T) TREE
(FH) FIRE HYDRANT	(M-B) MAIL BOX	(P) PALM
(SH) SPRINKLER HEAD	(E) ELECTRICAL CONDUIT IN CROSS SECTION	(S) SHRUBBERY
(WV) WATER VALVE		
(GV) GAS VALVE		
(H) HYDRANT OR FAUCET		

CONCRETE
ASPHALT
EDGE OF PAVEMENT
BUILDING
UNDERGROUND OR OVERHANGING STRUCTURE

BLOCK WALL
BOARD FENCE
WIRE FENCE
CHAIN LINK FENCE

TOP OF SLOPE
TOE OF SLOPE
DIRECTION OF FLOW

**BROCKTON AVE. WIDENING
MAGNOLIA AVENUE TO JURUPA AVENUE**

APPROVED BY	BY DATE	APPROVED BY	ACCOUNT NO. 326
PRINCIPAL ENGINEER	11/12/12		DRAWING NUMBER
PARK DEPARTMENT	11/12/12	DIRECTOR OF PUBLIC WORKS	R-1290
TRAFFIC DIVISION	11/12/12	DATE	SHEET 1 OF 6
CHIEF TRAFFIC ENGR.	11/12/12		

DESIGNED BY J.L.S. DRAWN BY J.L.S. CHECKED BY J.L.S.

FB. 649/77
 B.M. 826.57
 PC MAIL IN NE. CO. PT.
 CENTRAL AND MAGNOLIA
 FB. 837/59
 FB. 862/

CURVE DATA				
	Δ	R	L	T
1	90° 56' 33"	35.00'	55.35'	35.37'
2	89° 23' 27"	35.00'	54.60'	34.63'
3	89° 58' 09"	15.00'	23.55'	14.99'
4	90° 01' 51"	20.00'	31.42'	20.01'

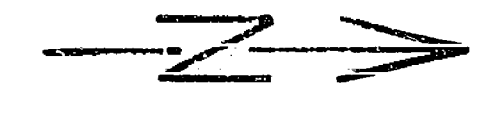
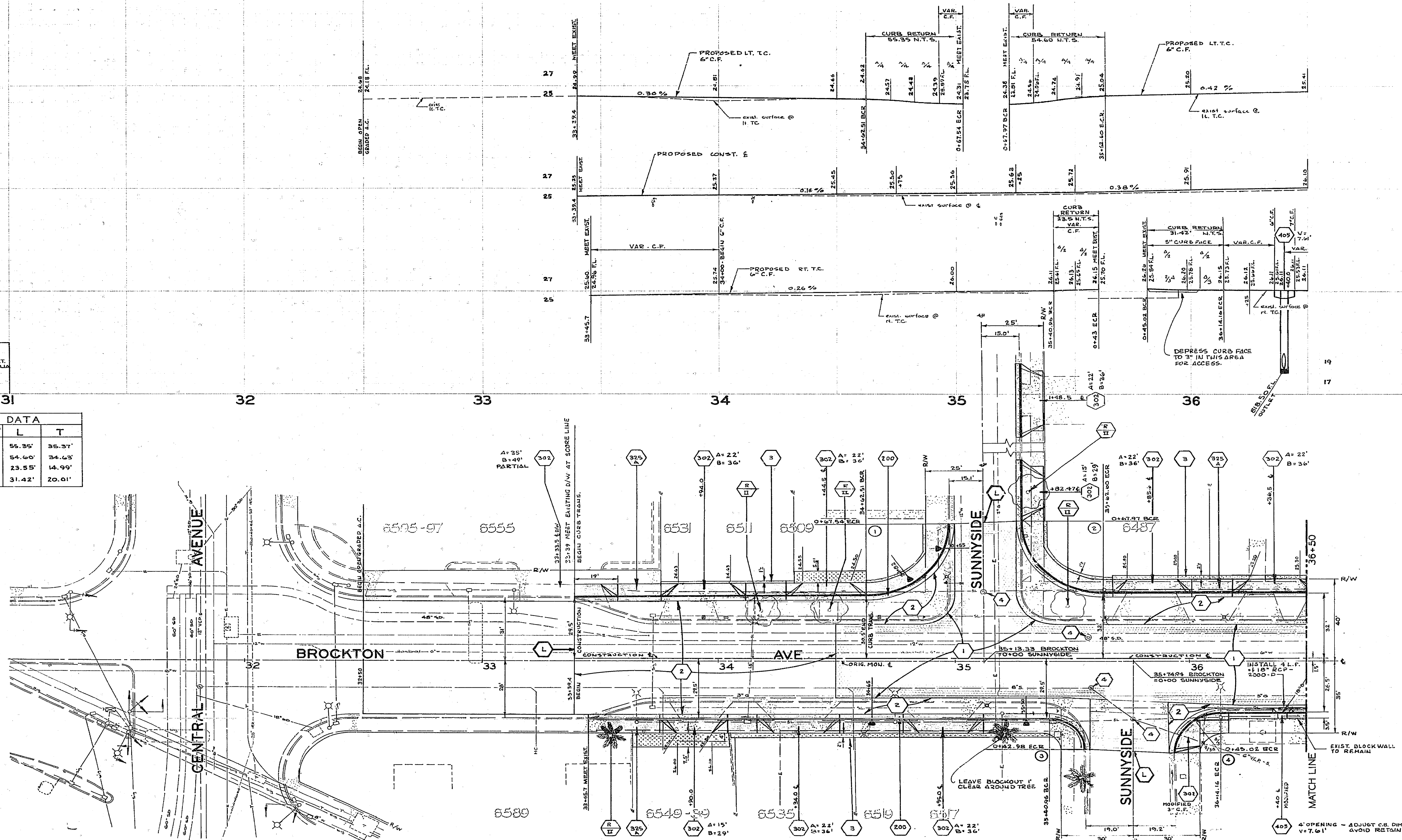

CITY OF RIVERSIDE, CALIFORNIA DEPARTMENT OF PUBLIC WORKS		BROCKTON AVENUE WIDENING MAGNOLIA TO JURUPA		PROJECT NO. 326 R-1290 SHEET 2 OF 6
DESIGNED BY L.L.M. DRAWN BY L.L.M. CHECKED BY L.L.M.	REVISIONS APPR. DATE	APPROVED BY OFFICE ENGINEER PARK DEPARTMENT TRAFFIC DIVISION ASSISTANT CITY ENG.	APPROVED BY DIRECTOR OF PUBLIC WORKS	DATE 5-15-77 HORIZ. SCALE: 1" = 20' VERT. SCALE: 1" = 4' FILE NO.

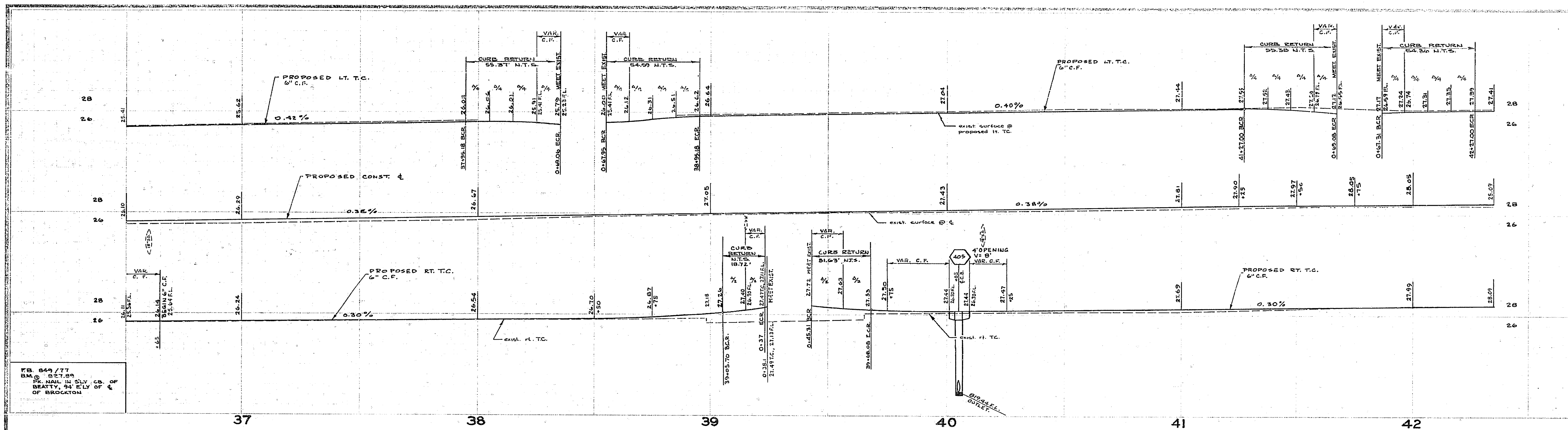

FB 649/77
 BM 827.89
 10' NAIL IN SLY. CO. OF
 BEATTY, 94' ELY OF 4
 OF BROCKTON

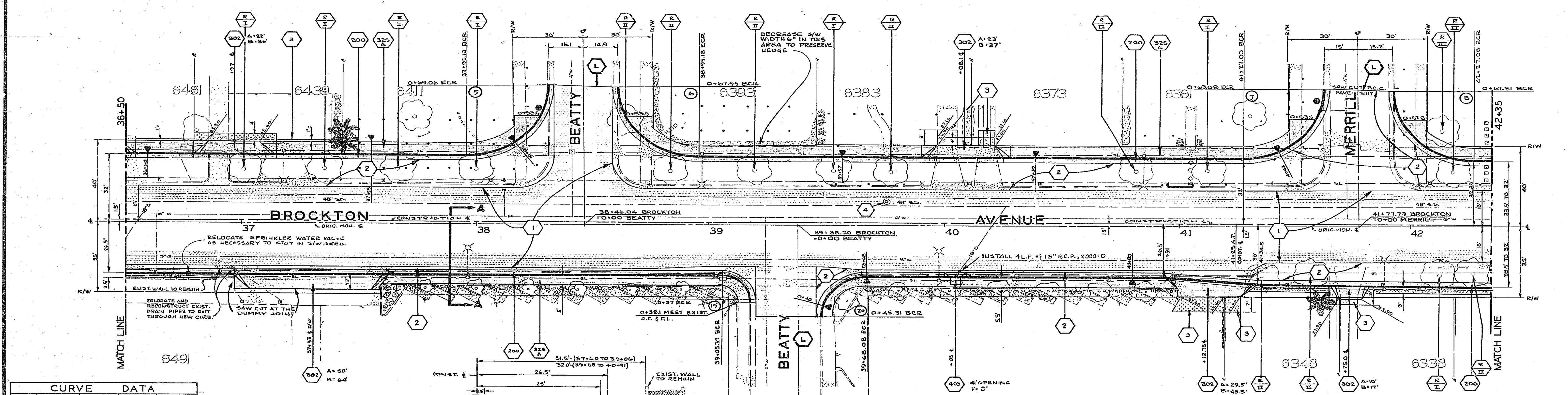

CURVE DATA				
	Δ	R	L	T
⑤	90° 38' 04"	35.00'	55.37'	35.39'
⑥	89° 21' 57"	35.00'	54.59'	34.62'
⑦	90° 29' 32"	35.00'	55.38'	35.41'
⑧	88° 59' 25"	35.00'	54.36'	34.39'
⑨	89° 23' 45"	12.00'	18.72'	11.87'
⑩	90° 36' 15"	20.00'	31.13'	20.21'

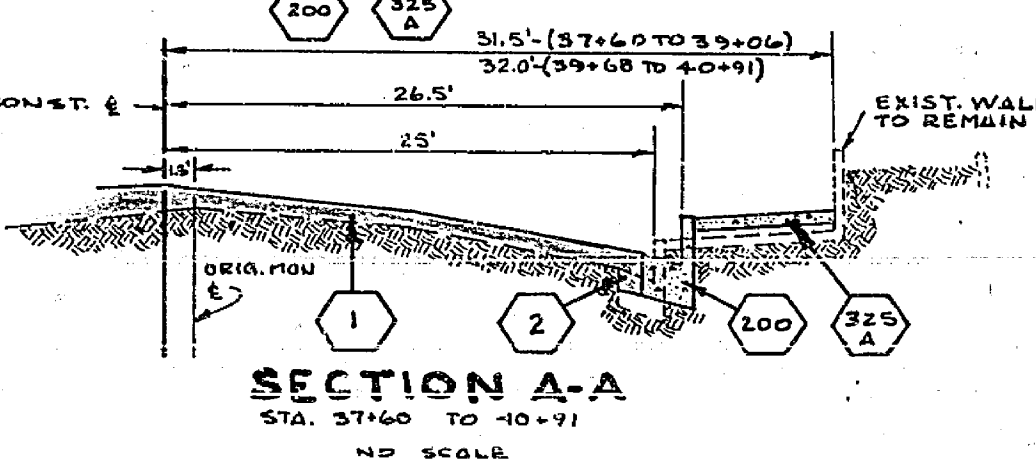

CITY OF RIVERSIDE, CALIFORNIA DEPARTMENT OF PUBLIC WORKS		BROCKTON AVENUE WIDENING MAGNOLIA TO JURUPA		PROJECT NO. 326 R-1290 SHEET 3 OF 6 FILE NO.
APPROVED BY PARK DEPARTMENT TRAFFIC DIVISION ASSISTANT CITY ENG.	APPROVED BY DIRECTOR OF PUBLIC WORKS	DATE 5-15-77	DATE 5-15-77	HORIZ. SCALE: 1" = 20' VERT. SCALE: 1" = 4'

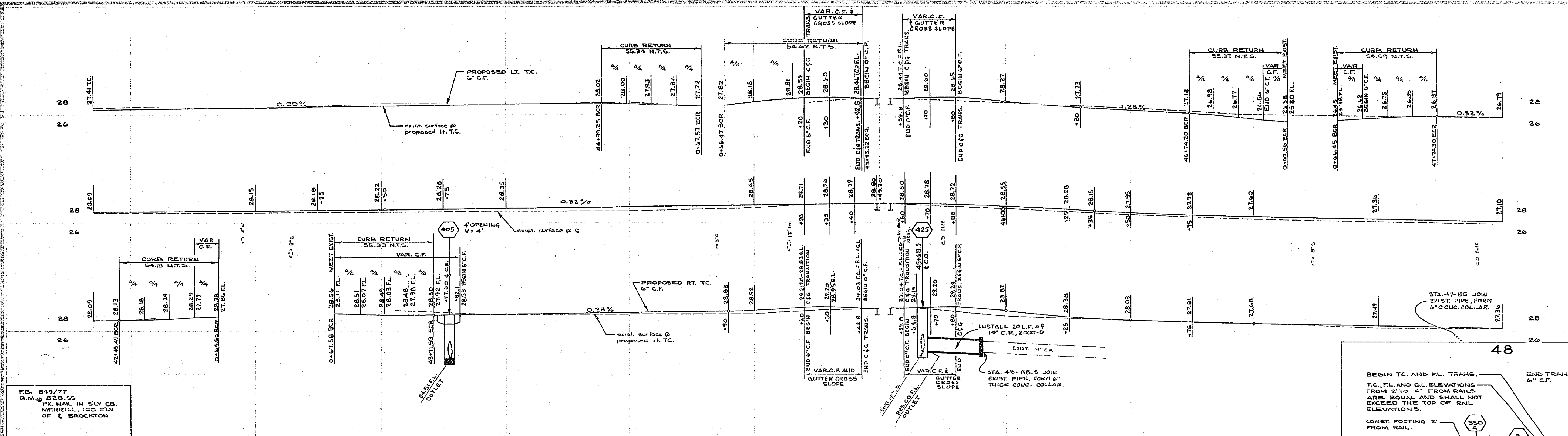

FB. 849/77
D.M. 828.55
PK. NAIL IN 6" V. CB.
MERRILL 100 ELEV.
OF G. BROCKTON

CURVE DATA				
	Δ	R	L	T
(1)	64° 36' 18"	35.00'	54.13'	34.14'
(2)	90° 34' 31"	35.00'	55.33'	35.35'
(3)	90° 35' 37"	35.00'	55.34'	35.37'
(4)	89° 24' 23"	35.00'	54.47'	34.64'
(5)	90° 38' 02"	35.00'	55.37'	35.39'
(6)	89° 21' 54"	35.00'	54.59'	34.62'

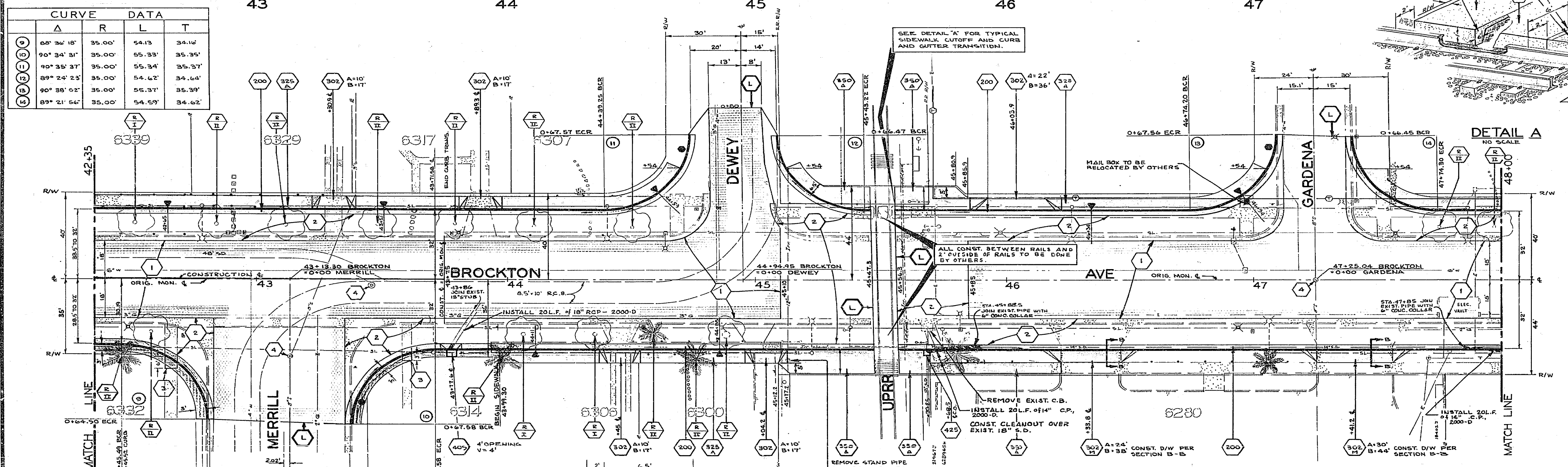

SECTION B-B
STA. 46+33.9, 47+41.2, 51+25.3, 53+42.0
NO. 62418

CITY OF RIVERSIDE, CALIFORNIA
DEPARTMENT OF PUBLIC WORKS

**BROCKTON AVENUE
WIDENING
MAGNOLIA TO JURUPA**

PROJECT NO. 326
R-1290
SHEET 4 OF 6

HORIZ. SCALE: 1" = 20'
VERT. SCALE: 1" = 4'

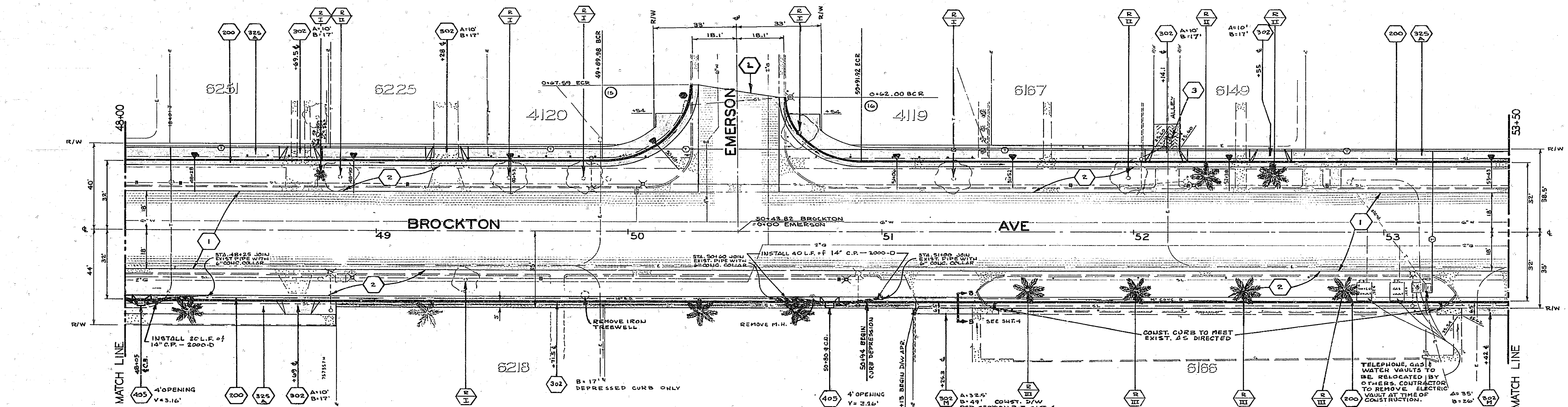
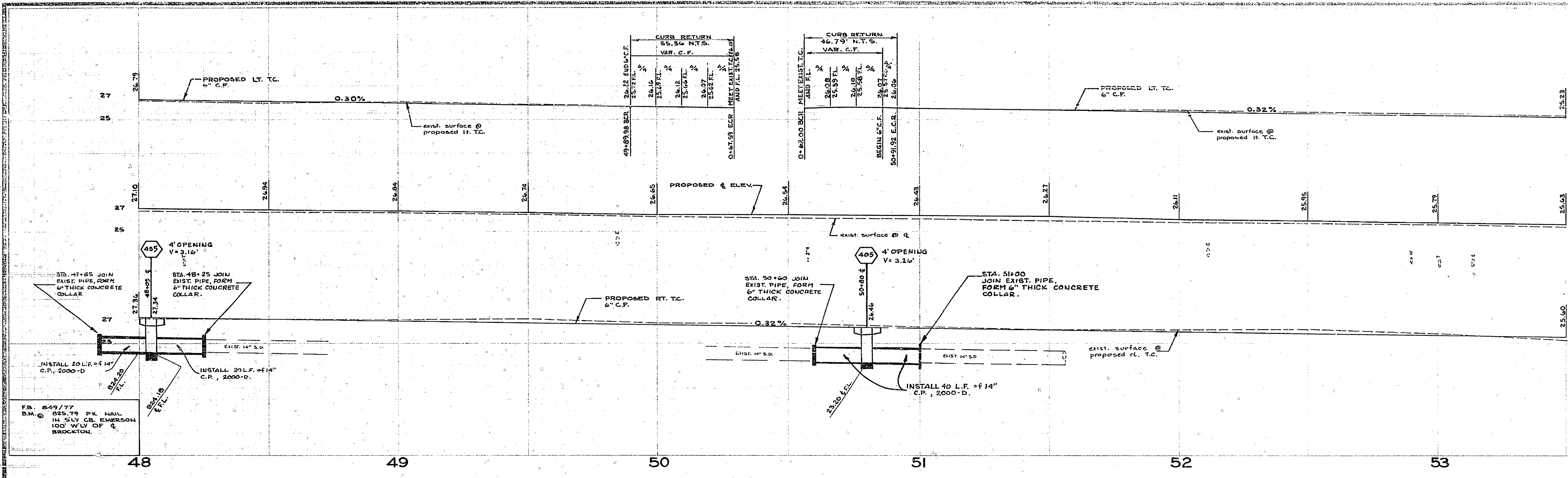

CURVE DATA				
	Δ	R	L	T
(5)	90° 27' 57"	35.00'	55.36'	35.39'
(6)	89° 22' 00"	30.00'	46.79'	29.67'

- CAUTION -
PACIFIC TELEPHONE
CABLES UNDERGROUND
BEFORE EXCAVATING
CALL COLLECT!

After Hours
 7:30 A.M. to 5 P.M. & Holidays
 Orange County 714-833-0811 714-847-8606
 Riverside County 714-884-0271 714-847-6000

NO.	REVISIONS	DATE	BY	CHECKED BY

CITY OF RIVERSIDE, CALIFORNIA
 DEPARTMENT OF PUBLIC WORKS

APPROVED BY: [Signature]
 DATE: 5-15-72

APPROVED BY: [Signature]
 DATE: 5-15-72

DESIGNED BY: [Signature] DRAWN BY: [Signature] CHECKED BY: [Signature]

BROCKTON AVENUE
WIDENING
MAGNOLIA TO JURUPA

HORIZ. SCALE: 1" = 20'
 VERT. SCALE: 1" = 4'

PROJECT NO. 326
R-1290
 SHEET 5 OF 6
 FILE NO.

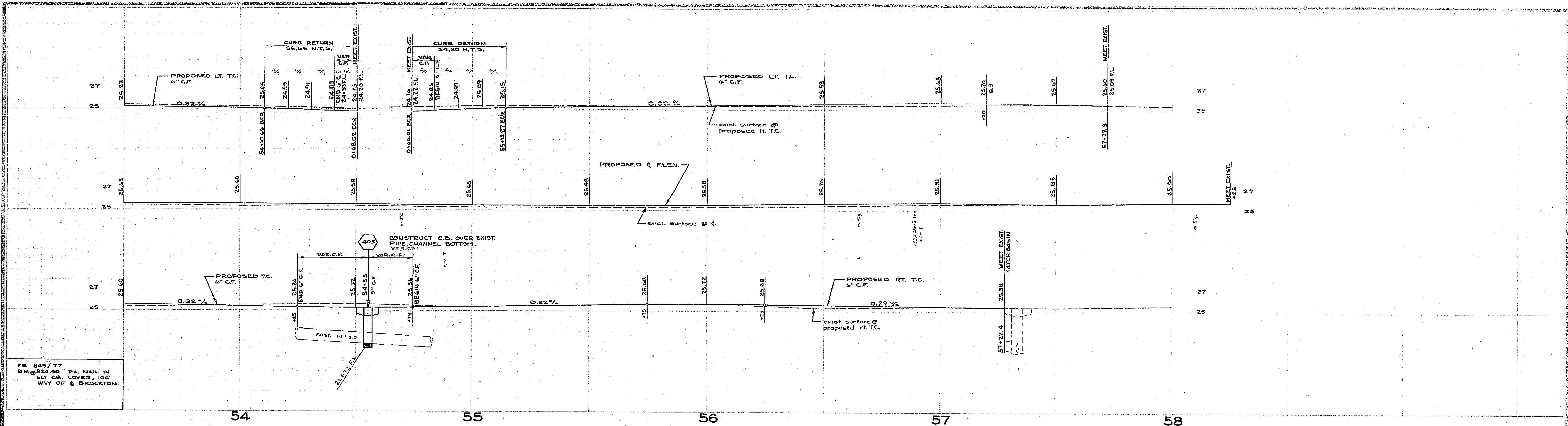

FB 849/77
 B.M. @ 224.50 P.K. NAIL IN
 6" V. C.B. COVER, 100'
 WLY OF & BROCKTON.

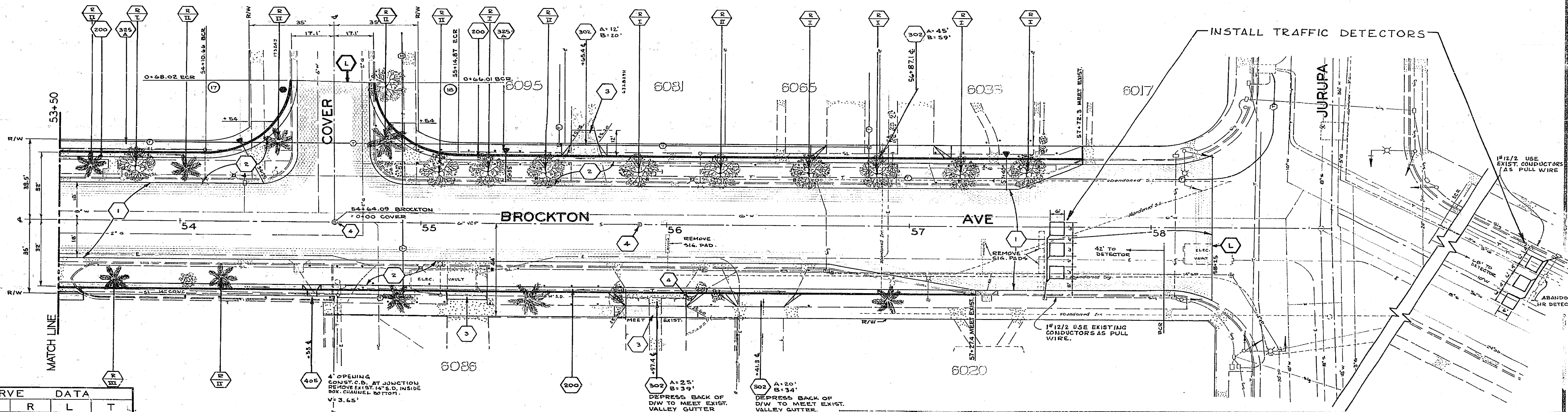

CURVE DATA				
	Δ	R	L	T
(17)	91° 06' 27"	35.00'	55.65'	33.68'
(18)	88° 55' 22"	35.00'	64.20'	34.33'



CITY OF RIVERSIDE, CALIFORNIA DEPARTMENT OF PUBLIC WORKS		BROCKTON AVENUE WIDENING MAGNOLIA TO JURUPA		PROJECT NO. 326 R-1290 SHEET 6 OF 6
APPROVED BY OFFICE ENGINEER PUBLIC DEPARTMENT TRAFFIC DIVISION ASSISTANT CITY ENG.	BY DATE DATE	APPROVED BY DIRECTOR OF PUBLIC WORKS	DATE 5-15-77	HORIZ. SCALE: 1" = 20' VERT. SCALE: 1" = 4' FILE NO.