

B.M. ELEV. 774.22, 'PK' N.L. IN W'LY CB. WAYNE CT. S' S'LY OF P.L. GARFIELD ST. (SEE B.M. BOOK)
 B.M. ELEV. 778.19, 'PK' N.L. IN N'LY CB. GARFIELD ST. 100' E. OF ADAMS ST.
 FIELD BOOKS 572/63, 578/35, 49, 583/58, 594/1-6
 SCALES: HOR. 1" = 50', VERT. 1" = 5'

DATE	
DRAWN BY	
CHECKED BY	
DESIGNED BY	
APPROVED BY	

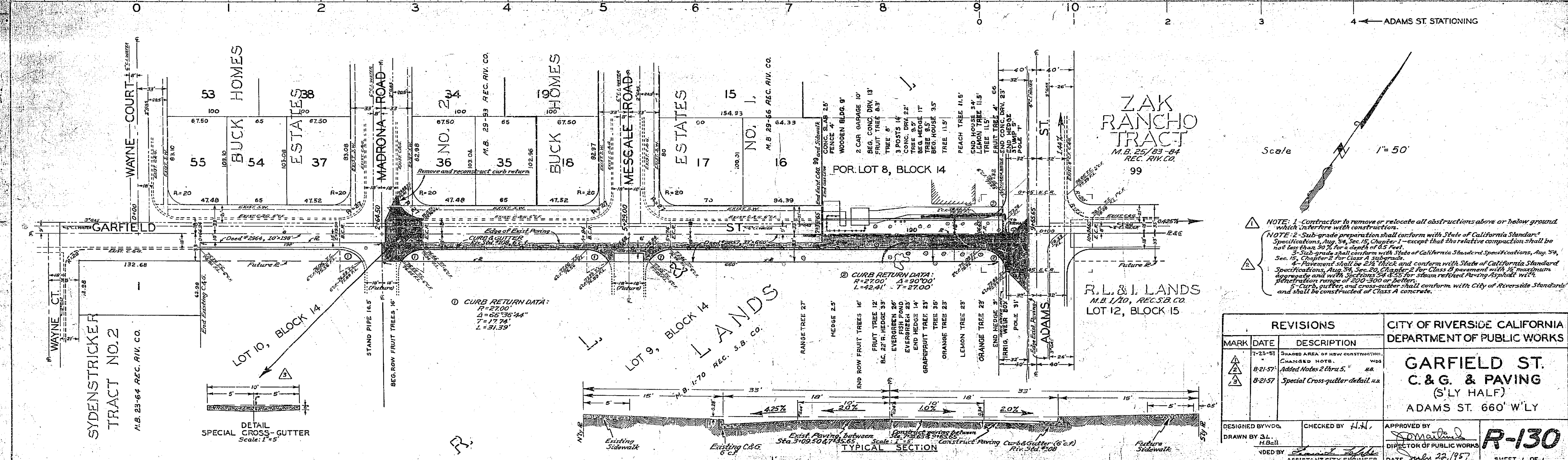

NOTE: 1- Contractor to remove or relocate all obstructions above or below ground which interfere with construction.
 NOTE: 2- Sub-grade preparation shall conform with State of California Standard Specifications, Aug. 54, Sec. 15, Chapter 1 - except that the relative compaction shall be not less than 90% for a depth of 4.5 feet.
 NOTE: 3- Sub-grade shall conform with State of California Standard Specifications, Aug. 54, Sec. 15, Chapter 2 for Class A subgrade.
 NOTE: 4- Pavement shall be 2 1/2" thick and conform with State of California Standard Specifications, Aug. 54, Sec. 20, Chapter 2 for Class B pavement with 1/2" maximum aggregate and with Sections 204 & 205 for stream resistant paving material.
 NOTE: 5- Curb, gutters and cross-gutters shall conform with City of Riverside Standards and shall be constructed of Class A concrete.

REVISIONS			CITY OF RIVERSIDE CALIFORNIA DEPARTMENT OF PUBLIC WORKS
MARK	DATE	DESCRIPTION	
1	7-25-57	SHARDED AREA OF NEW CONSTRUCTION.	GARFIELD ST. C. & G. & PAVING (S'LY HALF) ADAMS ST. 660' W'LY
2	8-21-57	Added Notes 2 thru 5.	
3	8-21-57	Special Cross-gutter detail.	

DESIGNED BY	CHECKED BY	APPROVED BY
DRAWN BY	H.H.	<i>[Signature]</i>
DATE	DATE	DATE
July 22, 1957	July 22, 1957	July 22, 1957

DATE	
DRAWN BY	
CHECKED BY	
DESIGNED BY	
APPROVED BY	

Scale 1" = 50'

R-130
SHEET 1 OF 1