

CONSTRUCTION LEGEND

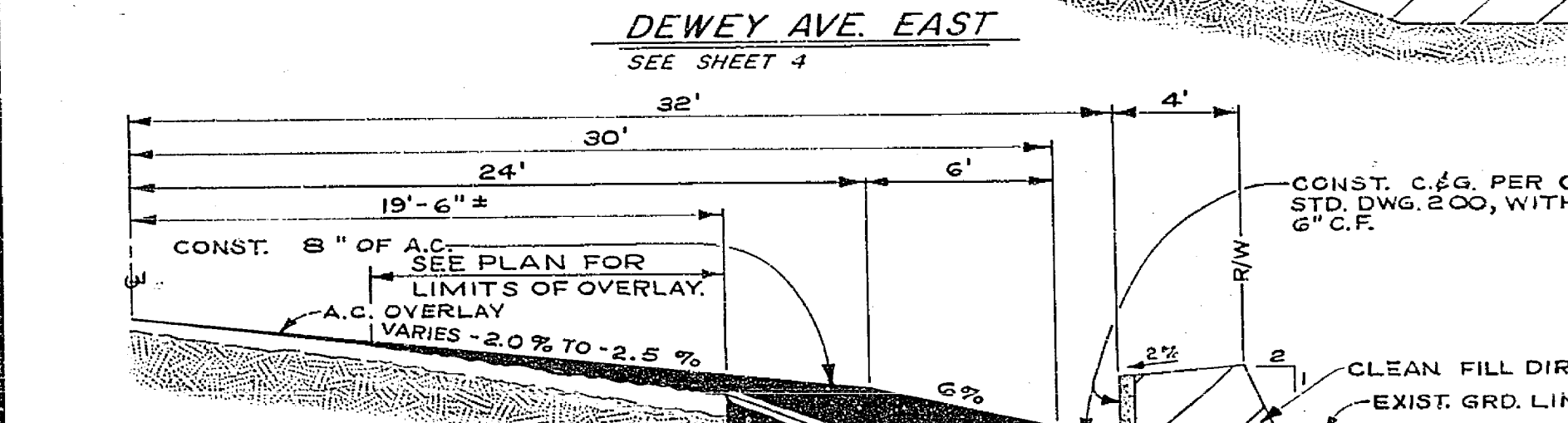
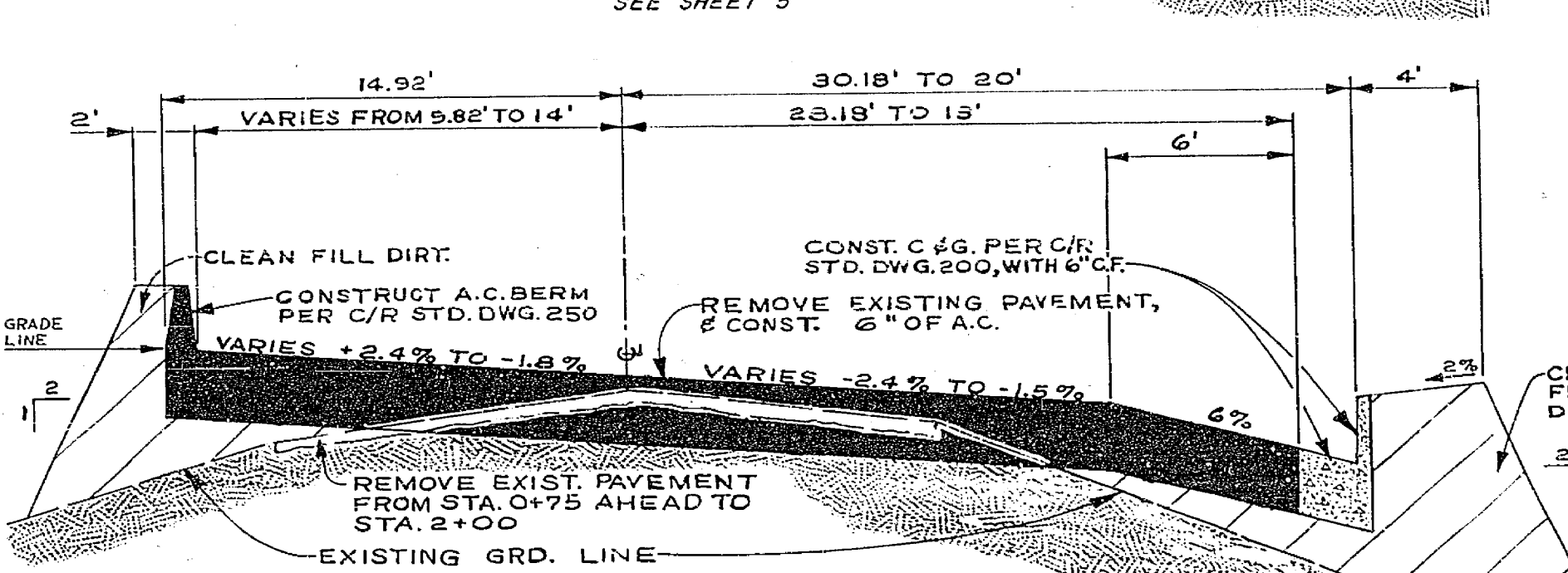
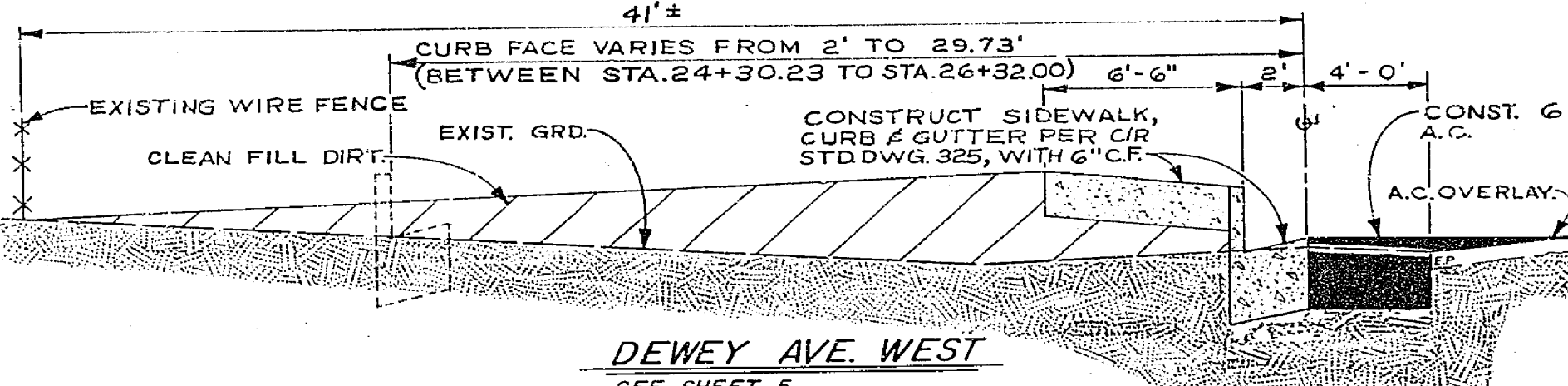
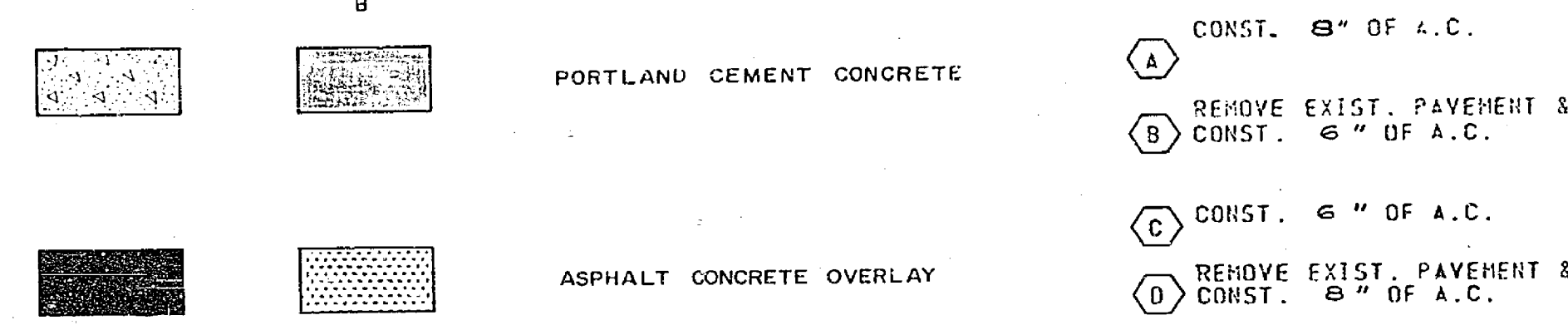
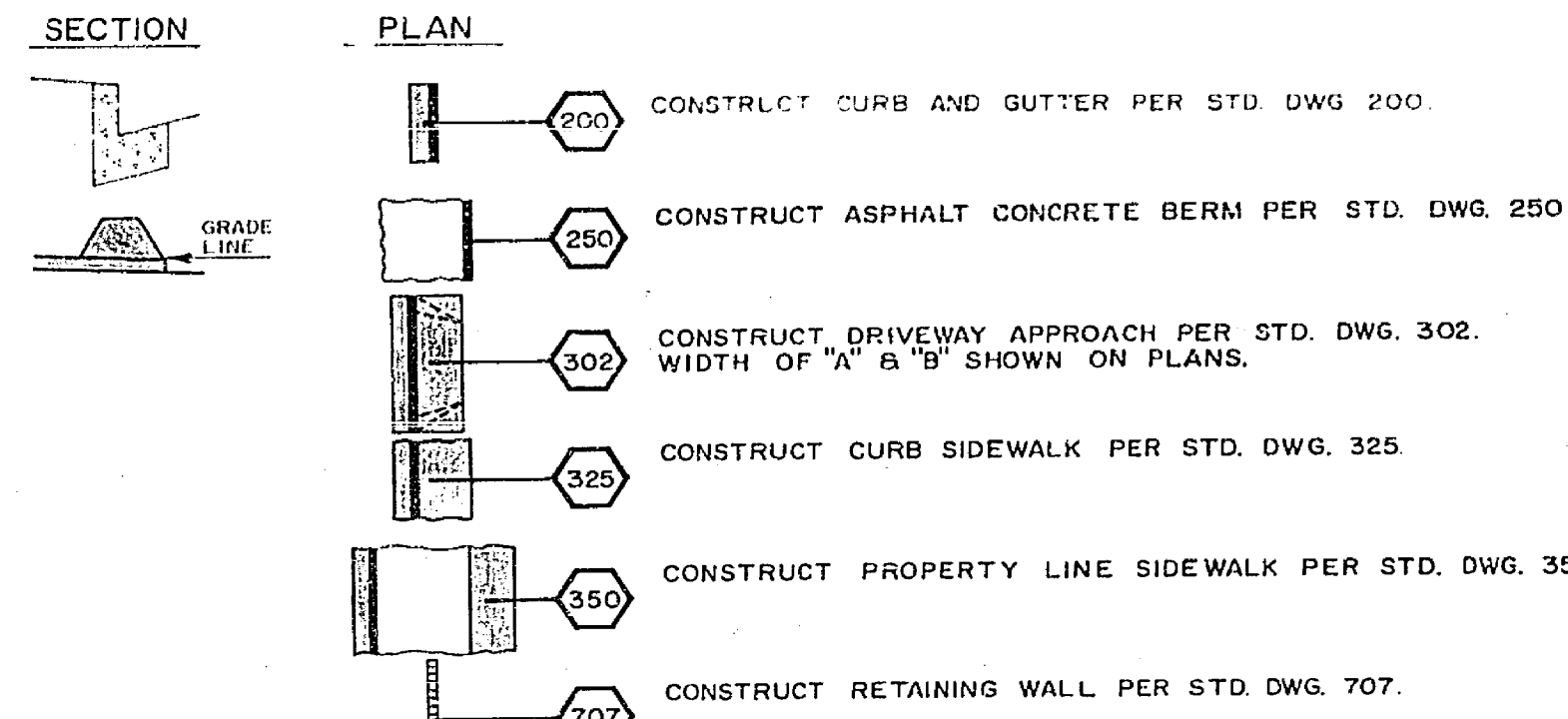
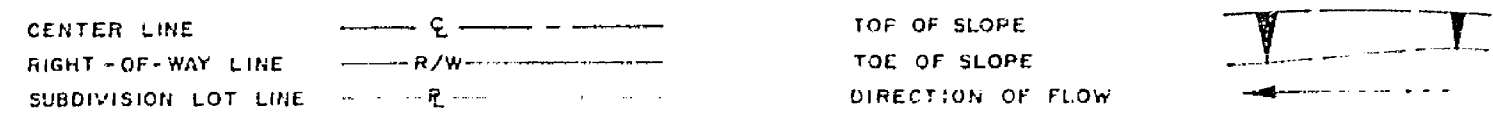

NOTE:
FOR TYPICAL SECTIONS OF STREETER AVENUE AT SIERRA STREET SEE SHEET 2 OF 5

EXISTING 15" R.C.P.-S.D.
13" MIN. EXIST. COVER.

(AT DEWEY)
STREETER AVE.
SEE SHEET 3

TYPICAL SECTIONS
SCALE: HORZ. 1"=5'
VERT. 1"=1'

RIVERSIDE CALIFORNIA



PUBLIC WORKS DEPARTMENT

STREETER AVE. WIDENING

SIERRA TO DEWEY

LENGTH OF PROJECT = 1613 Feet = 0.31 Mile

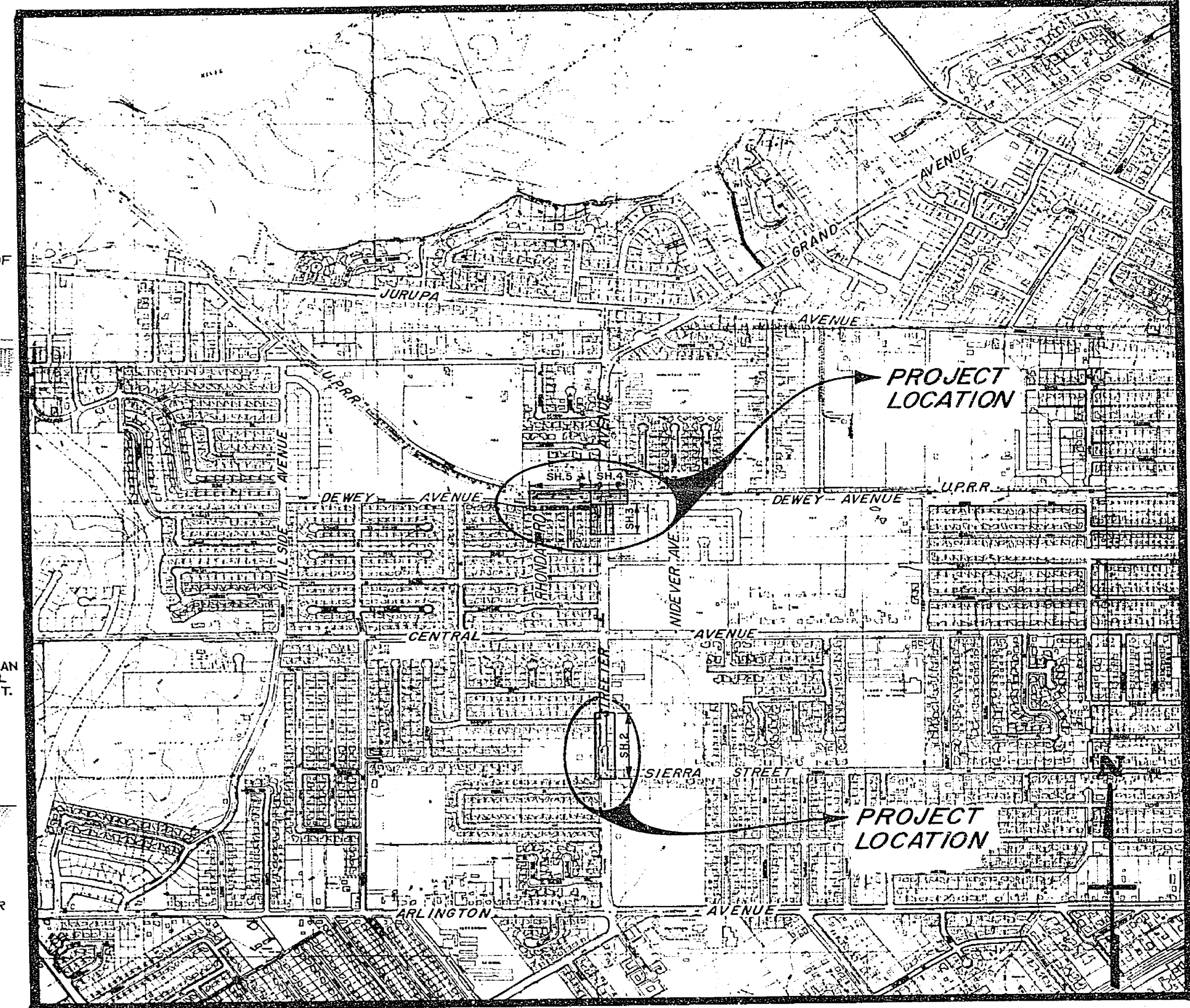

PROJECT LOCATION PLAN

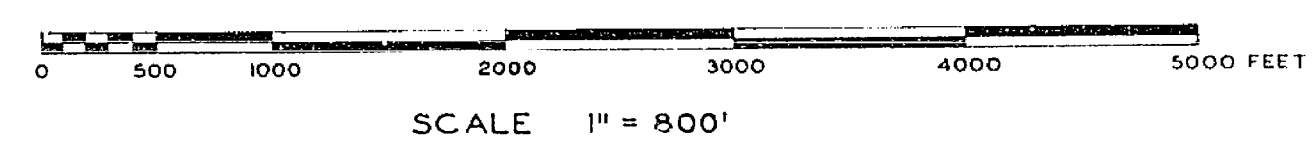

SHEET INDEX

SHEET 1	TITLE SHEET
" 2	PLAN & PROFILE EAST SIDE OF STREETER AVE. AT SIERRA STREET
" 3	PLAN & PROFILE EAST SIDE OF STREETER AVE. AT DEWEY AVENUE
" 4	PLAN & PROFILE OF DEWEY AVE. EAST OF STREETER AVENUE
" 5	PLAN & PROFILE OF DEWEY AVE. WEST OF STREETER AVENUE

GENERAL CONSTRUCTION NOTES

- WHERE NEW CONSTRUCTION IS INDICATED:
(A) CLEAR AND GRUB
(B) REMOVE ALL CURB, GUTTER, SIDEWALK, TREES, RETAINING WALL AND P.C.C.
- WIDTH OF DRIVEWAY APPROACHES SHALL BE 6.5 FEET MEASURED FROM CURB FACE TO THE BACK OF THE APPROACH.
- RIGHT OF ENTRIES HAVE BEEN OBTAINED FOR PROPOSED CONSTRUCTION OUTSIDE OF STREET RIGHT OF WAY.

EXISTING CULTURE & UNDERGROUND LEGEND

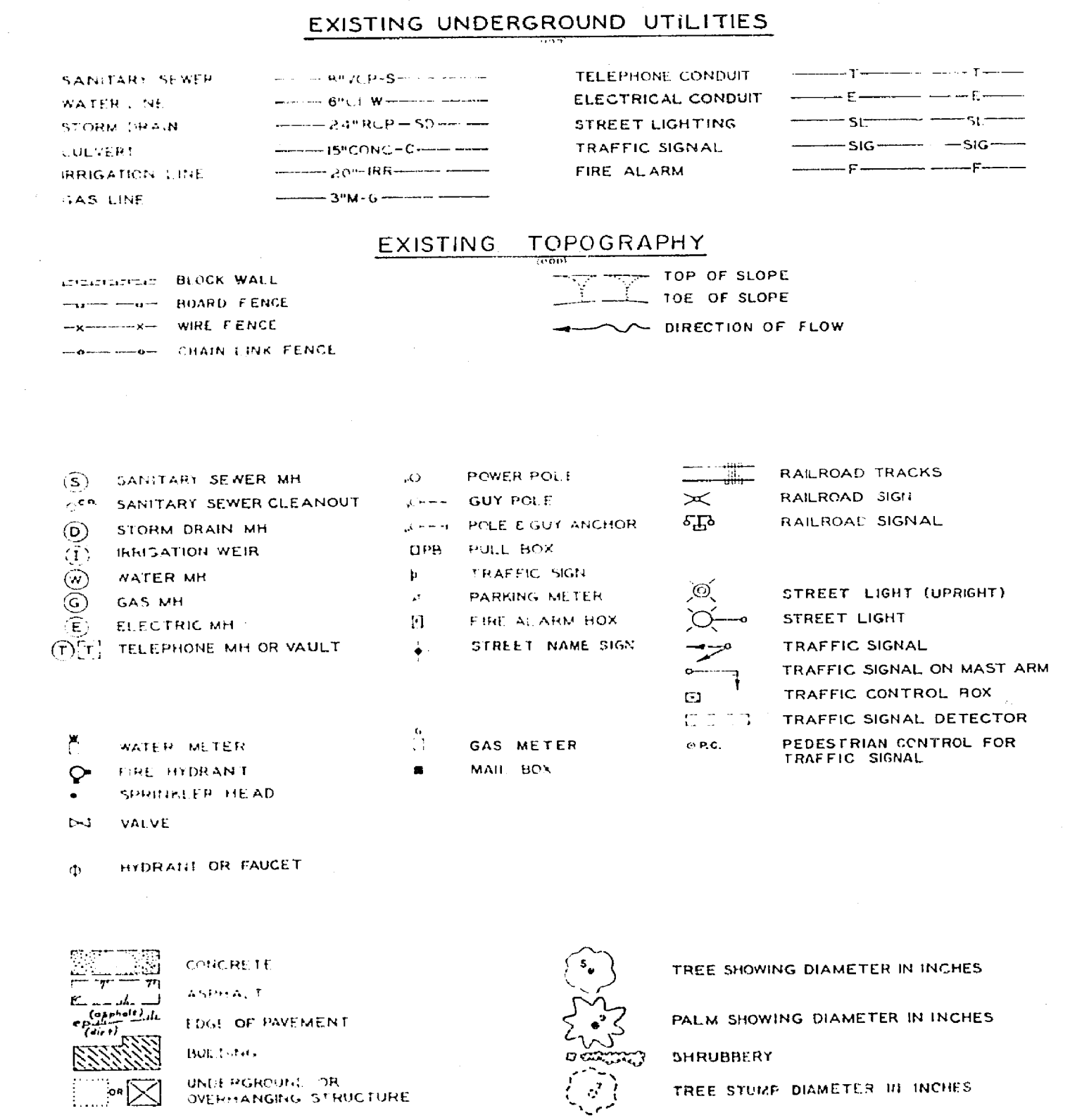

**STREETER AVE. WIDENING
SIERRA TO DEWEY**

APPROVED BY	BY DATE	APPROVED BY	ACCOUNT NO 311
PRINCIPAL ENGINEER	RD 12/17	<i>[Signature]</i>	DRAWING NUMBER
PARK DEPARTMENT	RD 12/21	DIRECTOR OF PUBLIC WORKS	R-1328
TRAFFIC DIVISION	RD 12/21	DATE	SHEET 1 OF 5
CHIEF PUB WKS ENGR	RD 12/1	4-5-71	

DESIGNED BY *[Signature]* DRAWN BY *[Signature]* CHECKED BY *[Signature]*

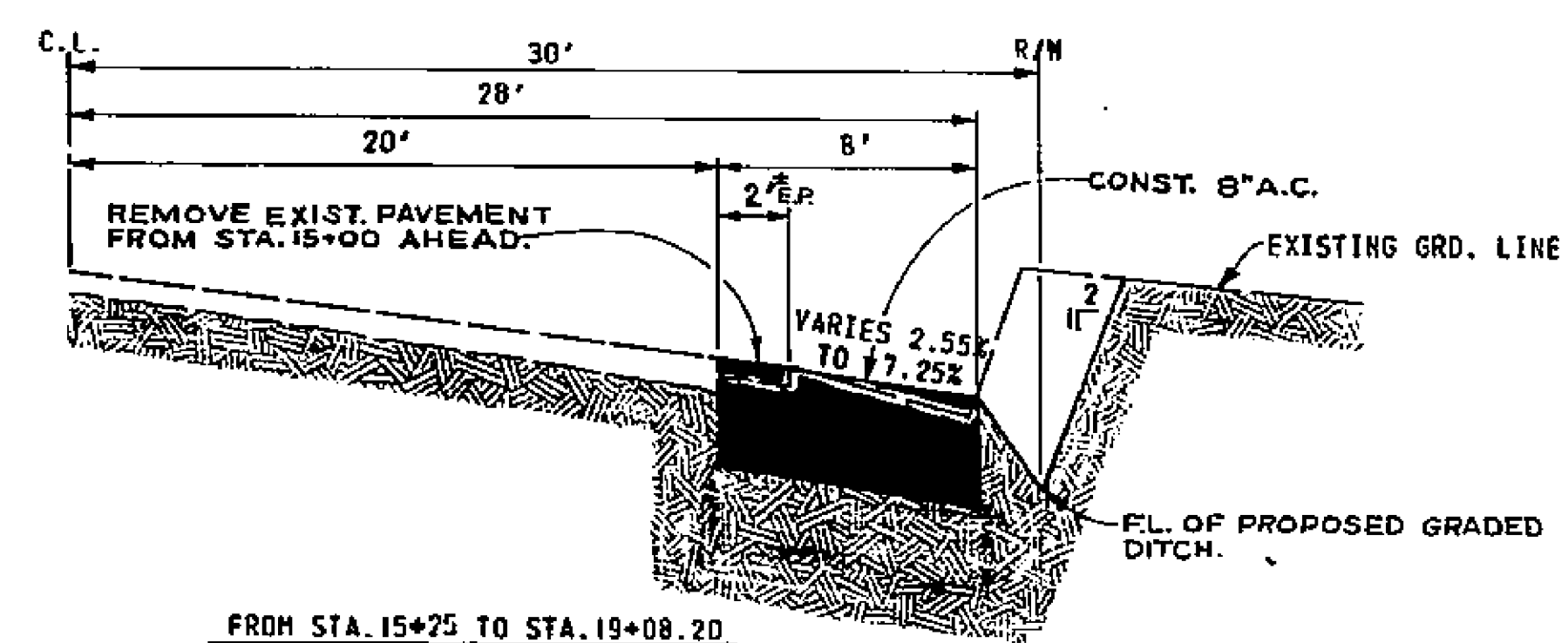
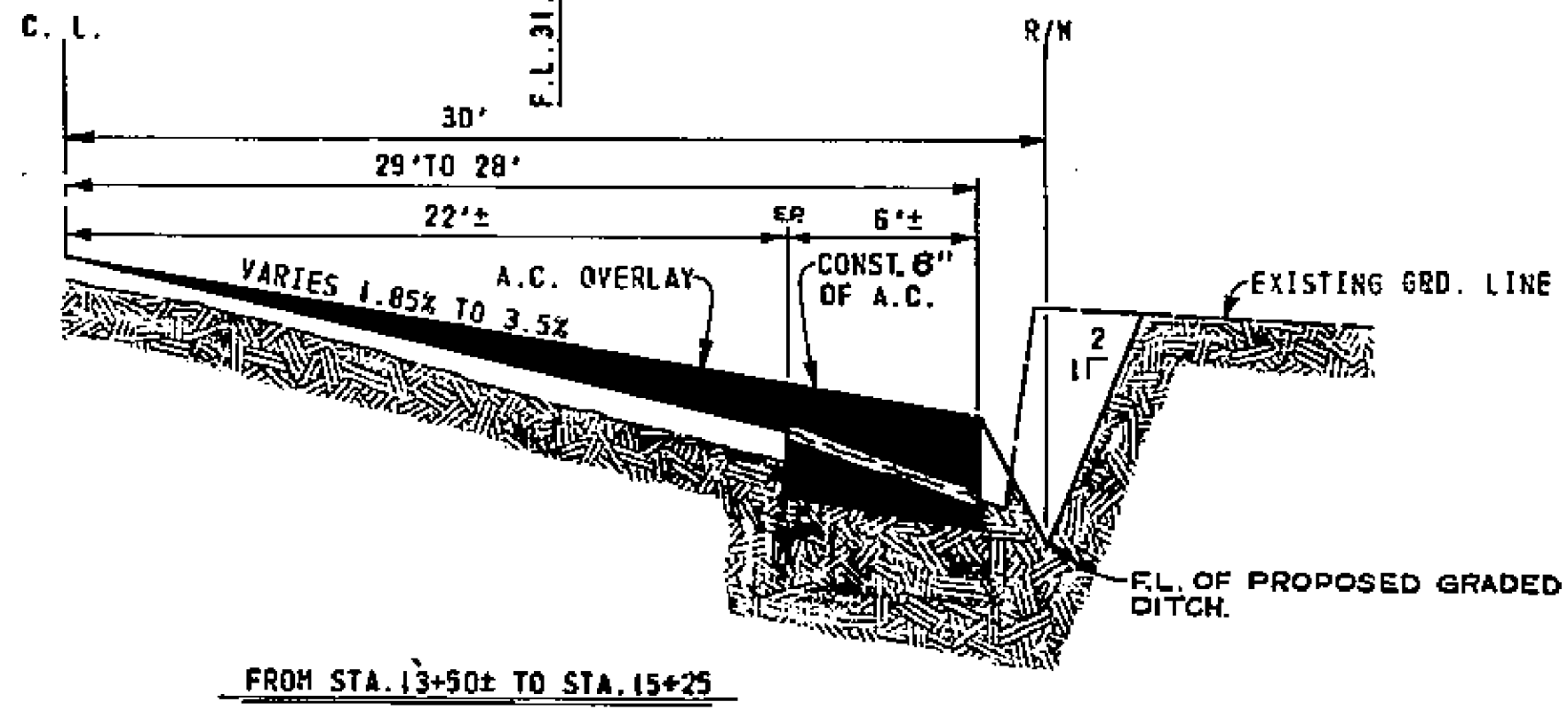
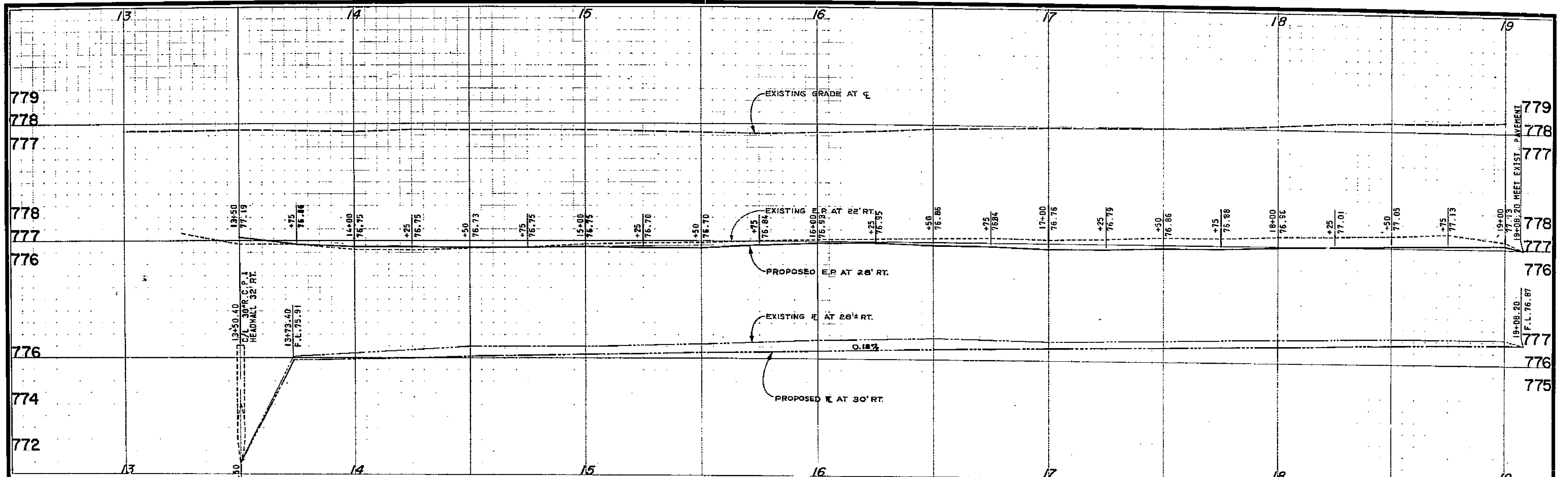

**STREETER AVE.
TYPICAL SECTIONS**

SCALE HORIZ. 1" = 5'
VERT. 1" = 1'

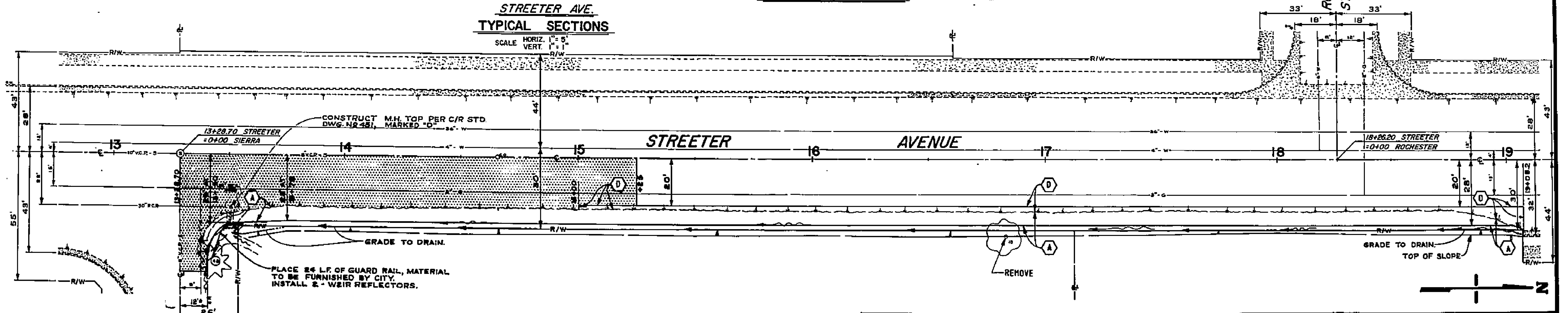

B.M. ELEV. 776.587 S-L IN W. CB. OF STREETER AVE. 40' N. OF C SIERRA ST. (WEST).
B.M. ELEV. 778.17 PK IN S. CB. OF ROCHESTER, 1' W. OF L.C. OF SWCB. RET. OF ROCHESTER & STREETER
F.B. 860/59 # 58

CITY OF RIVERSIDE, CALIFORNIA DEPARTMENT OF PUBLIC WORKS			STREETER AVE. WIDENING SIERRA TO DEWEY		PROJECT NO. 311
APPROVED BY: [Signature] DATE: 12/2/71			APPROVED BY: [Signature] DATE: 4-5-71		R-1328
OFFICE ENGINEER: [Signature]			DIRECTOR OF PUBLIC WORKS: [Signature]		SHEET 2 OF 5
TRAFFIC DIVISION: [Signature]			DATE: 4-5-71		
DESIGNED BY: [Signature]			DRAWN BY: [Signature]		
CHECKED BY: [Signature]					

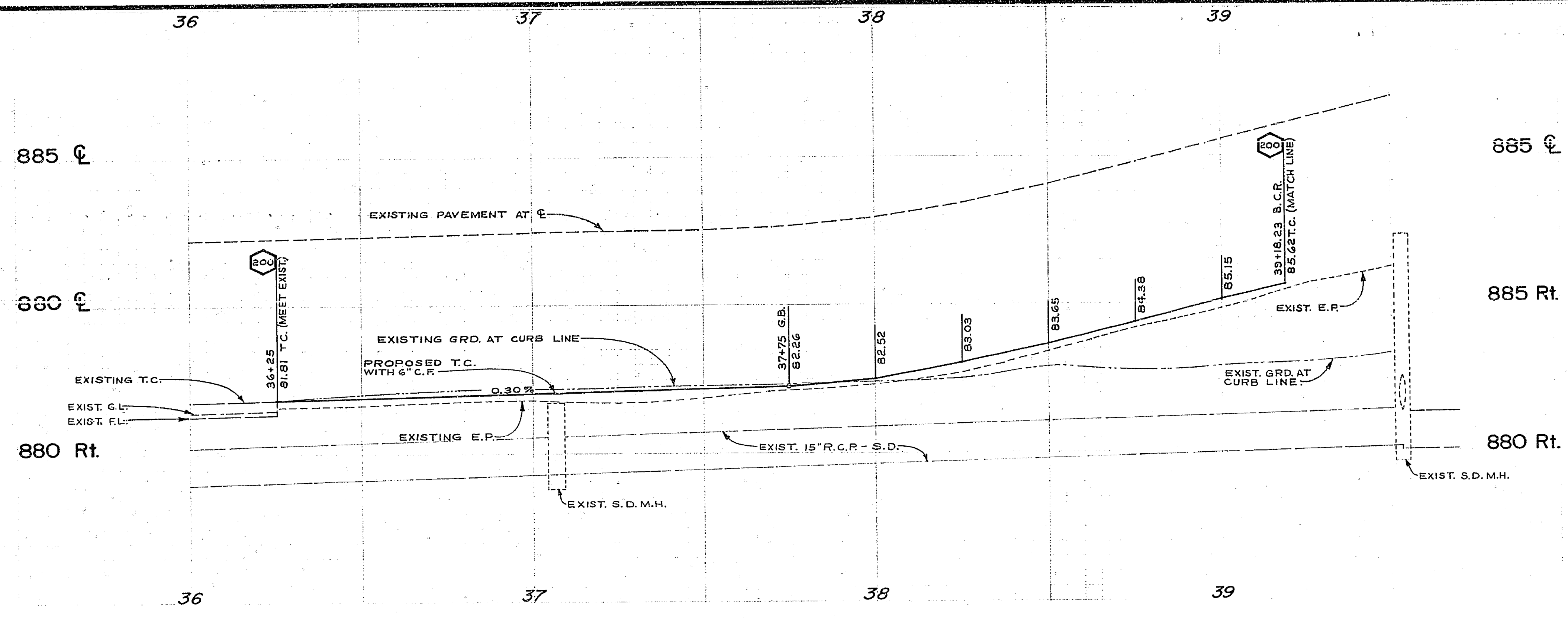

B.M. ELEV. 783.96 PK NAIL IN LEAD ON
 SLY. CB. OF DEWEY AVE. (WEST)
 APPROX. 20' WLY OF B.C. OF
 SW. COR. OF DEWEY AVE.
 (WEST) & STREETER AVE.

FB. 860/62 935/30 & 33

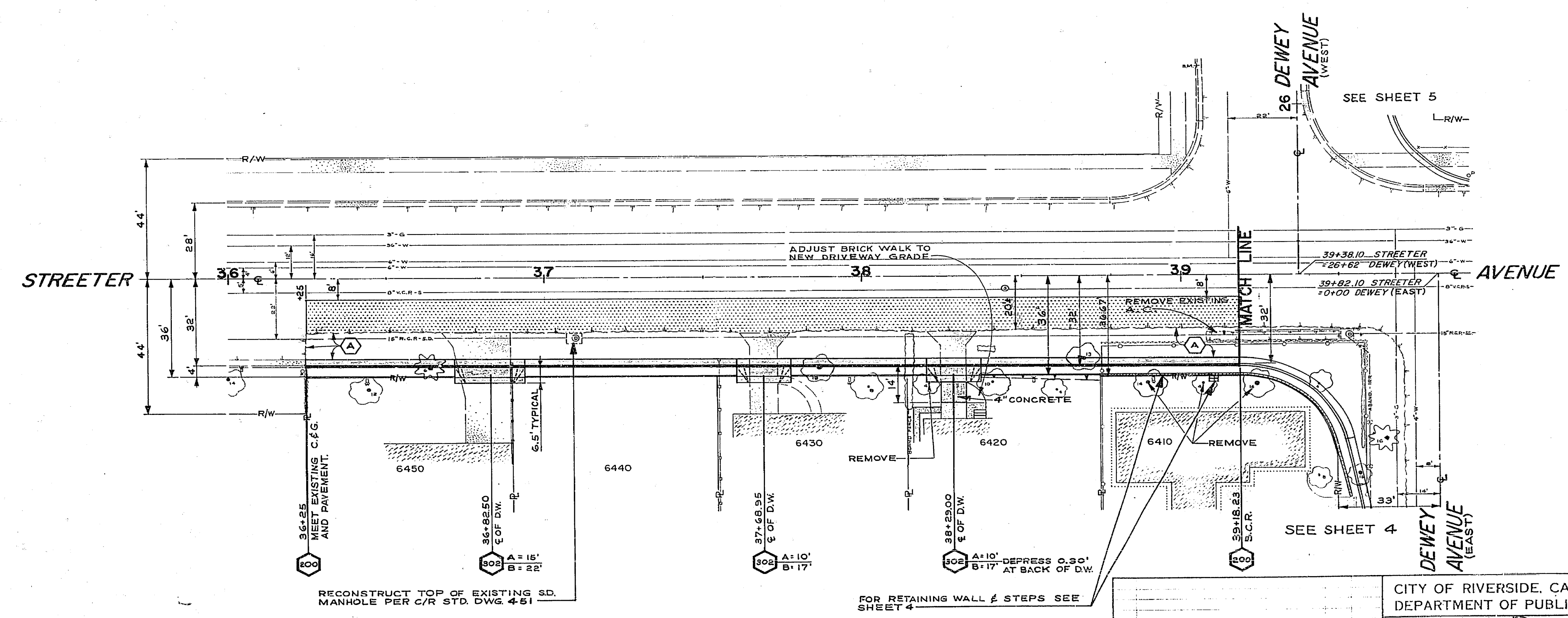

RECONSTRUCT TOP OF EXISTING S.D.
 MANHOLE PER C/R STD. DWG. 4-51

FOR RETAINING WALL & STEPS SEE
 SHEET 4

CITY OF RIVERSIDE, CALIFORNIA DEPARTMENT OF PUBLIC WORKS		STREETER AVE. WIDENING SIERRA TO DEWEY		PROJECT NO. 311
APPROVED BY: <i>[Signature]</i> DATE: 4-5-71		PLAN & PROFILE EAST SIDE OF STREETER AVE. AT DEWEY AVE.		R-1328
DESIGNED BY: J. C. [Signature] DRAWN BY: S. S. [Signature] CHECKED BY: D. C. [Signature]		HORIZ. SCALE: 1" = 20' VERT. SCALE: 1" = 2'		SHEET 3 OF 5

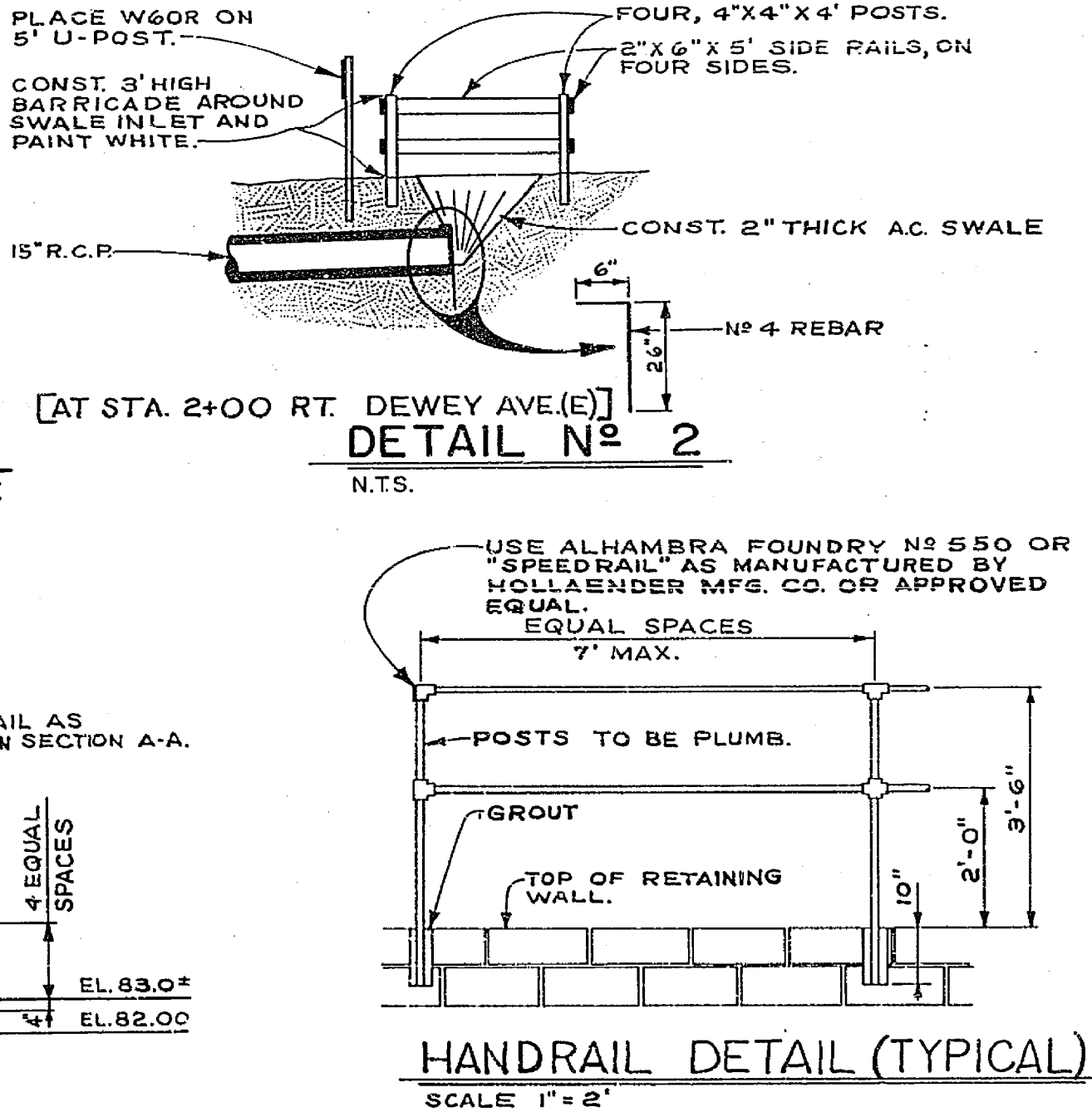
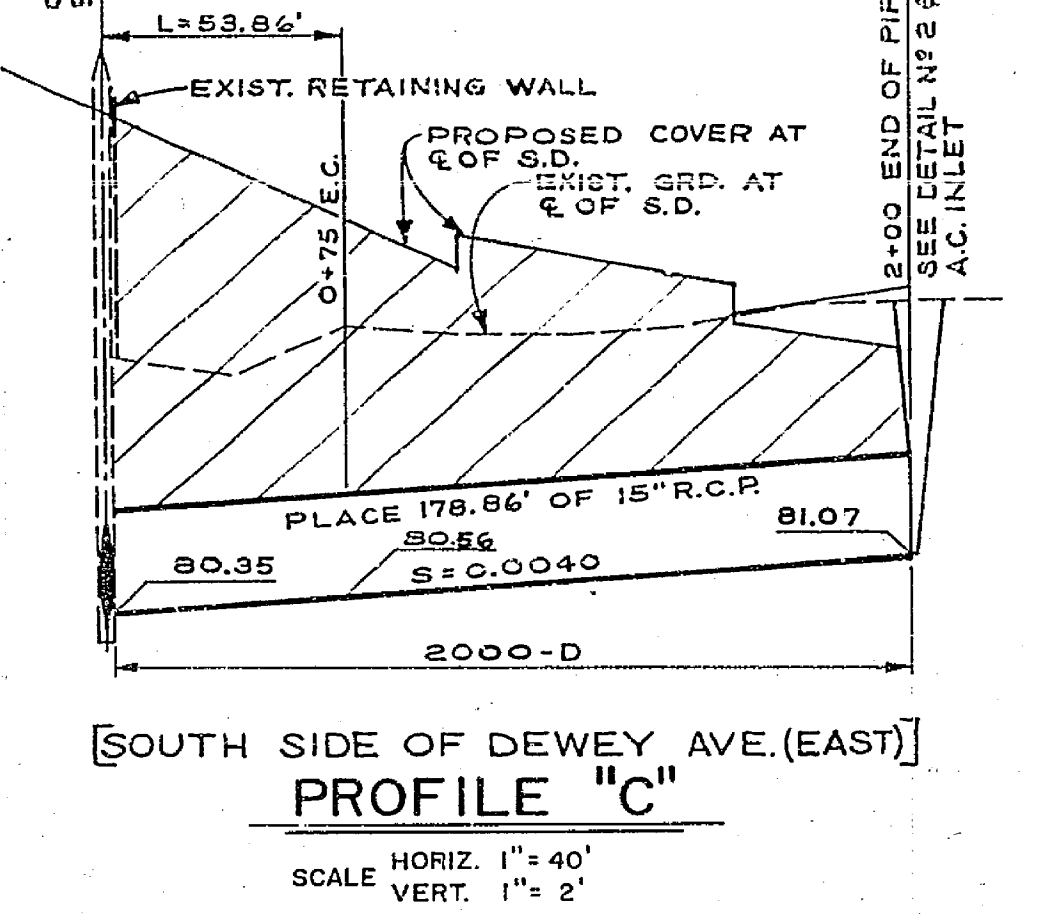
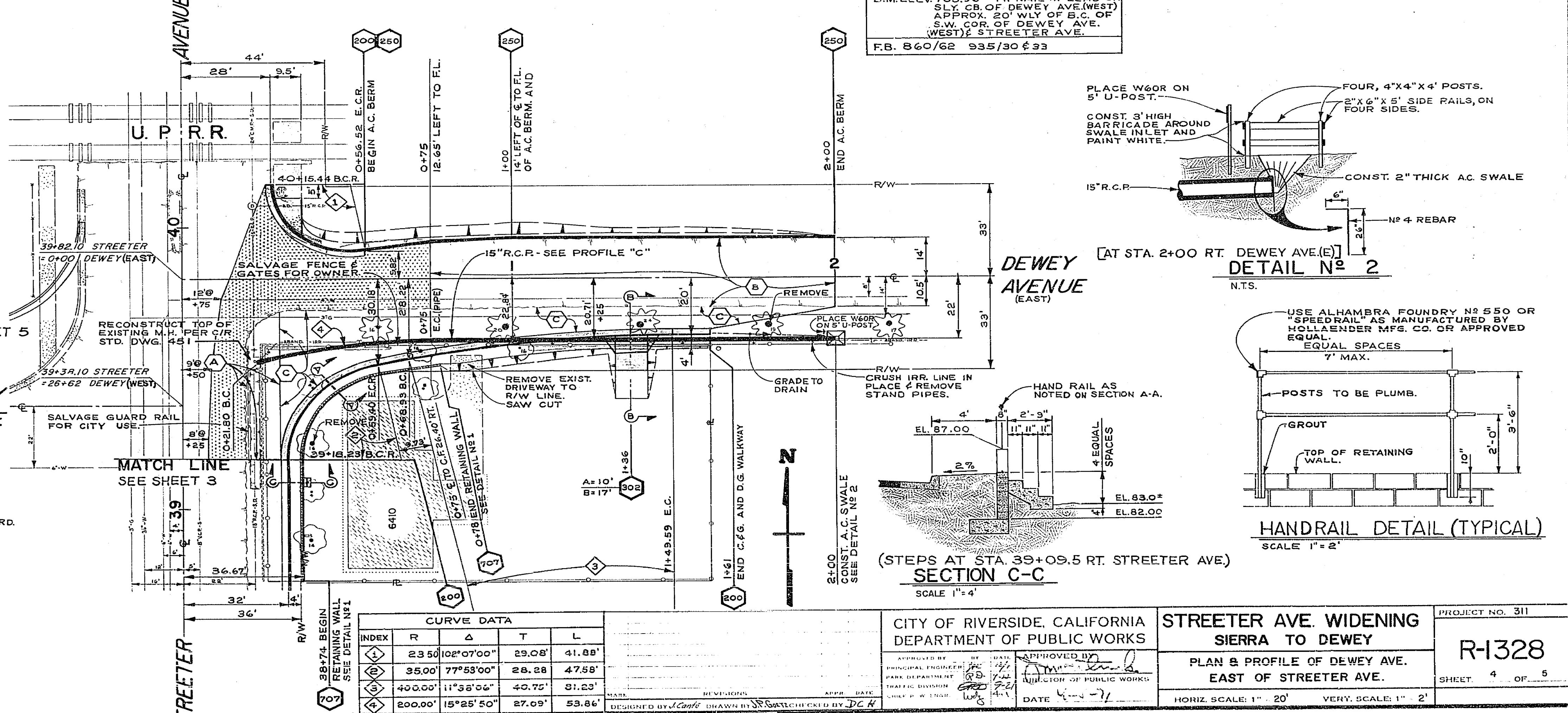
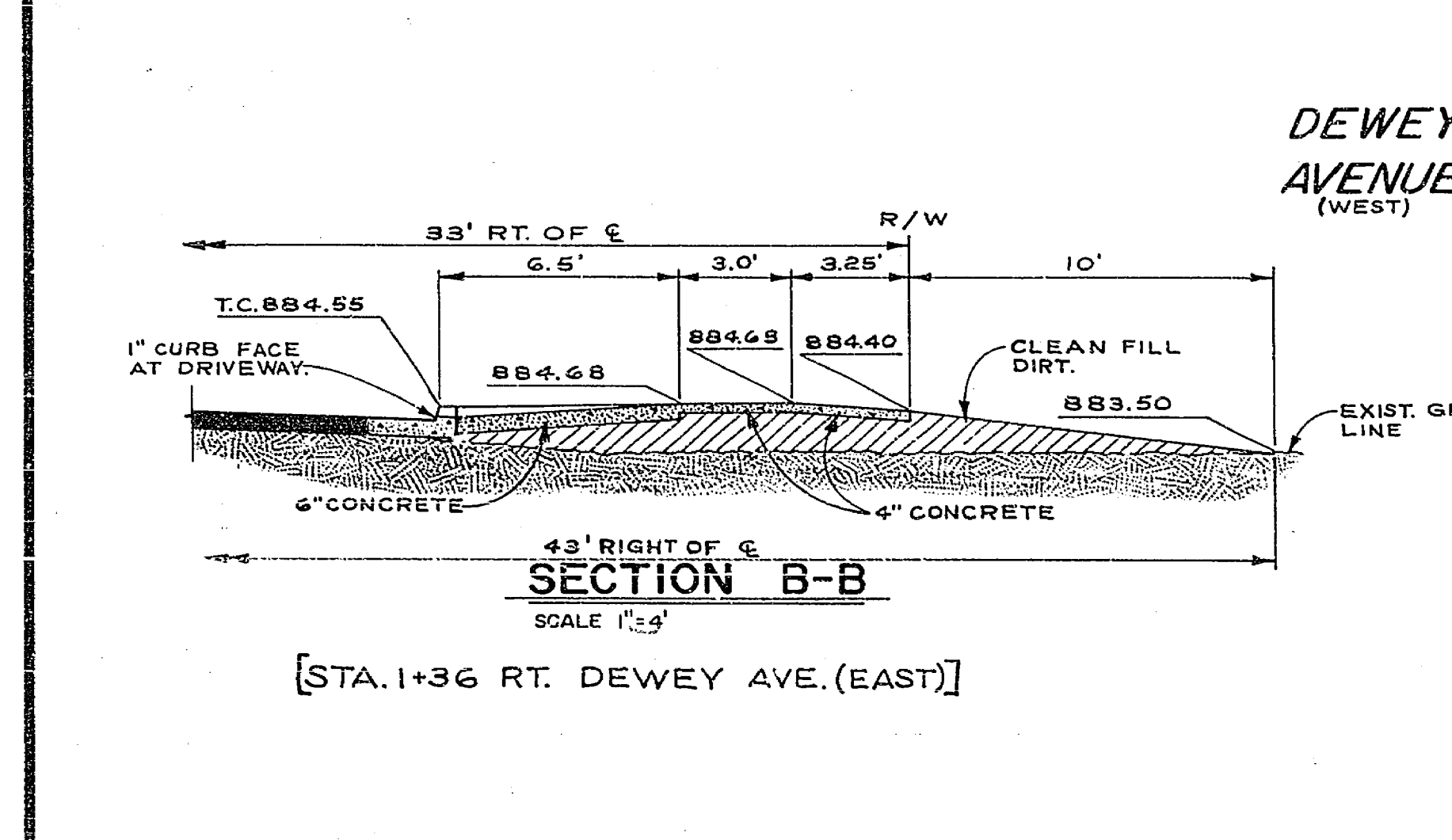
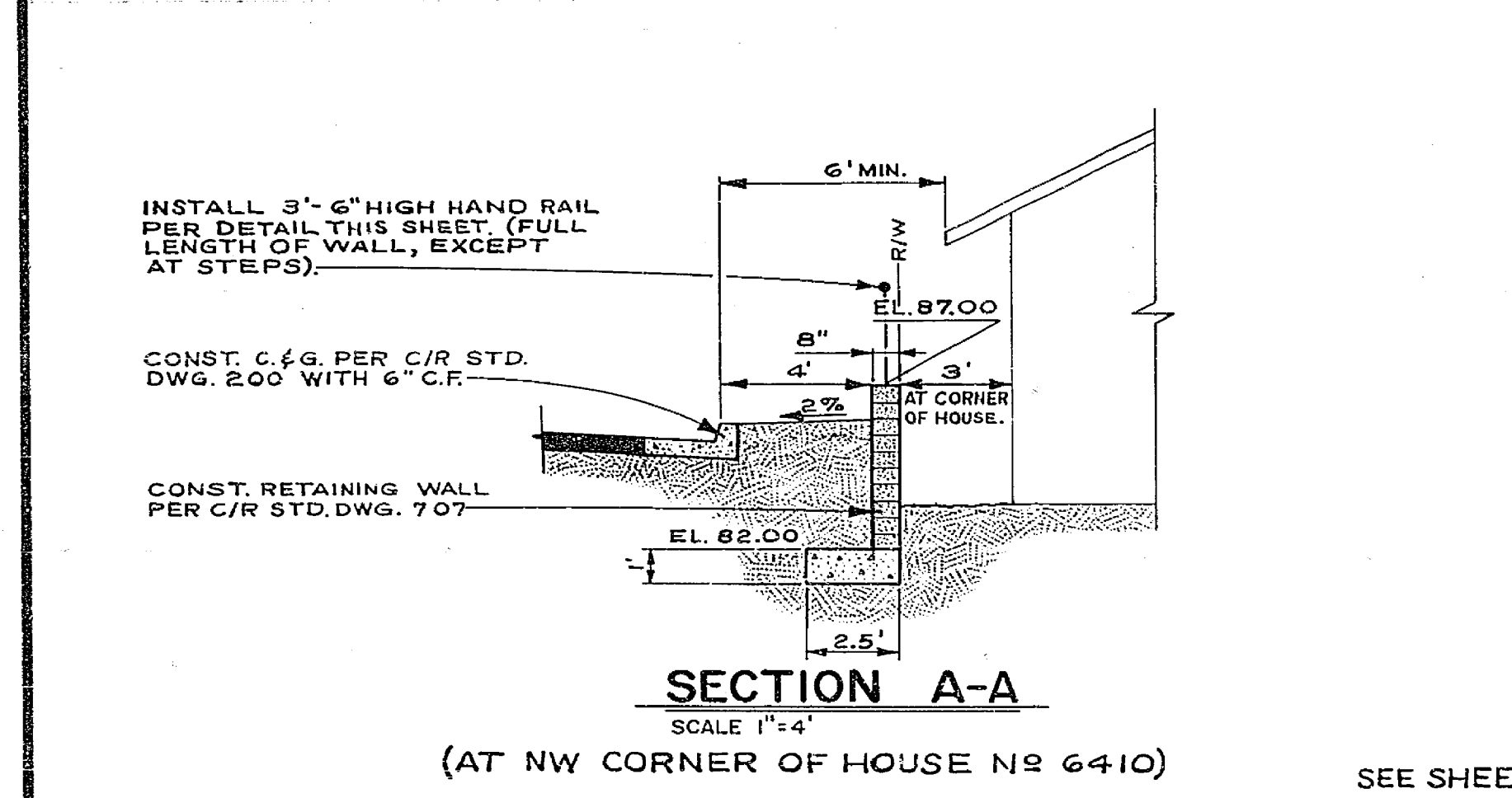
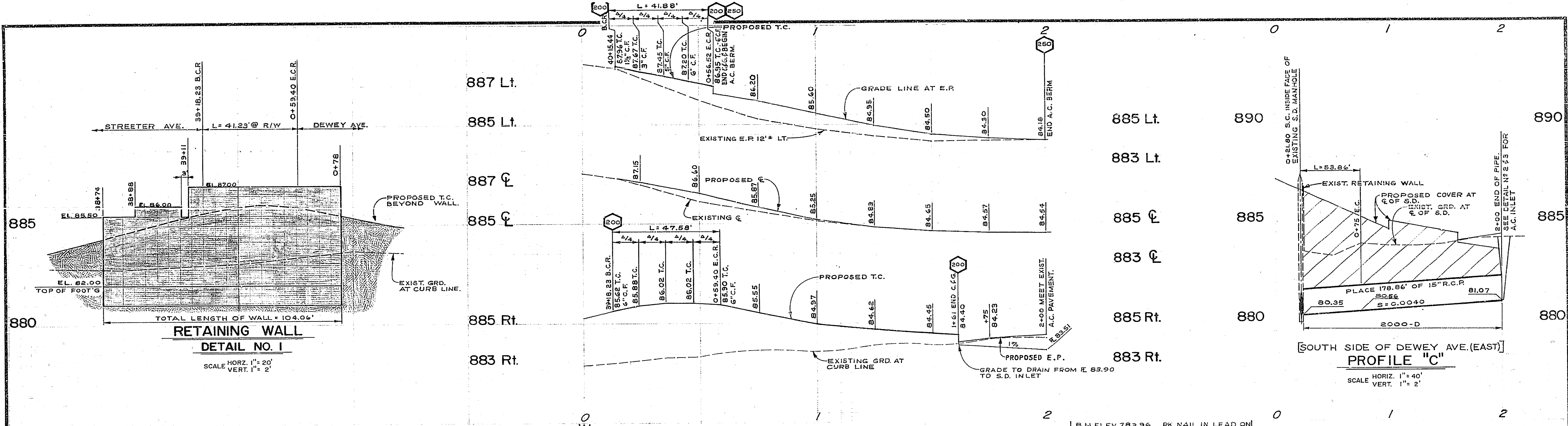

B.M. ELEV. 783.96 PK NAIL IN LEAD ON SLY. CB. OF DEWEY AVE. (WEST) APPROX. 20' WLY OF B.C. OF S.W. COR. OF DEWEY AVE. (WEST) & STREETER AVE.
 F.B. 860/62 935/30 633

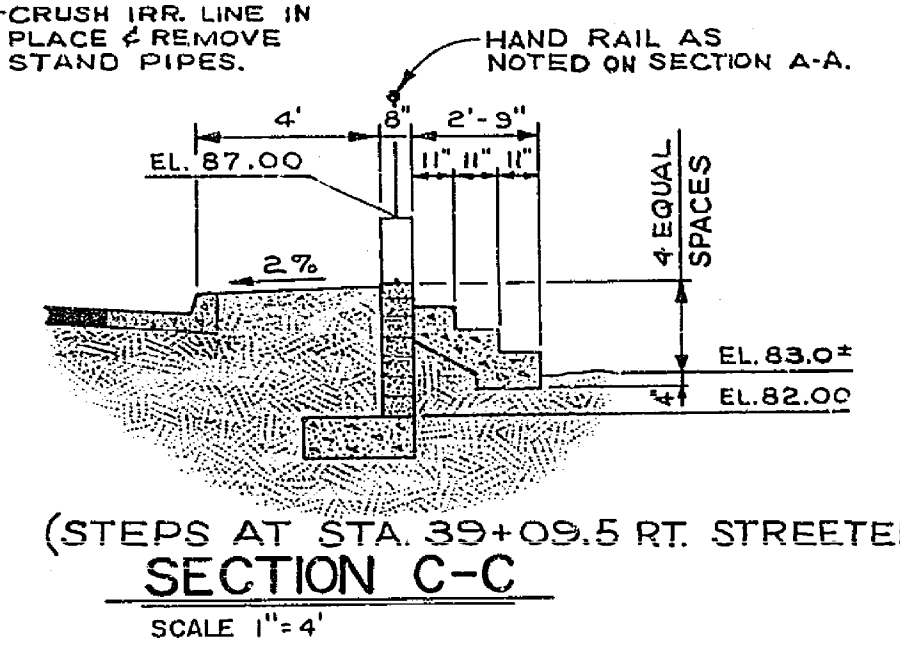

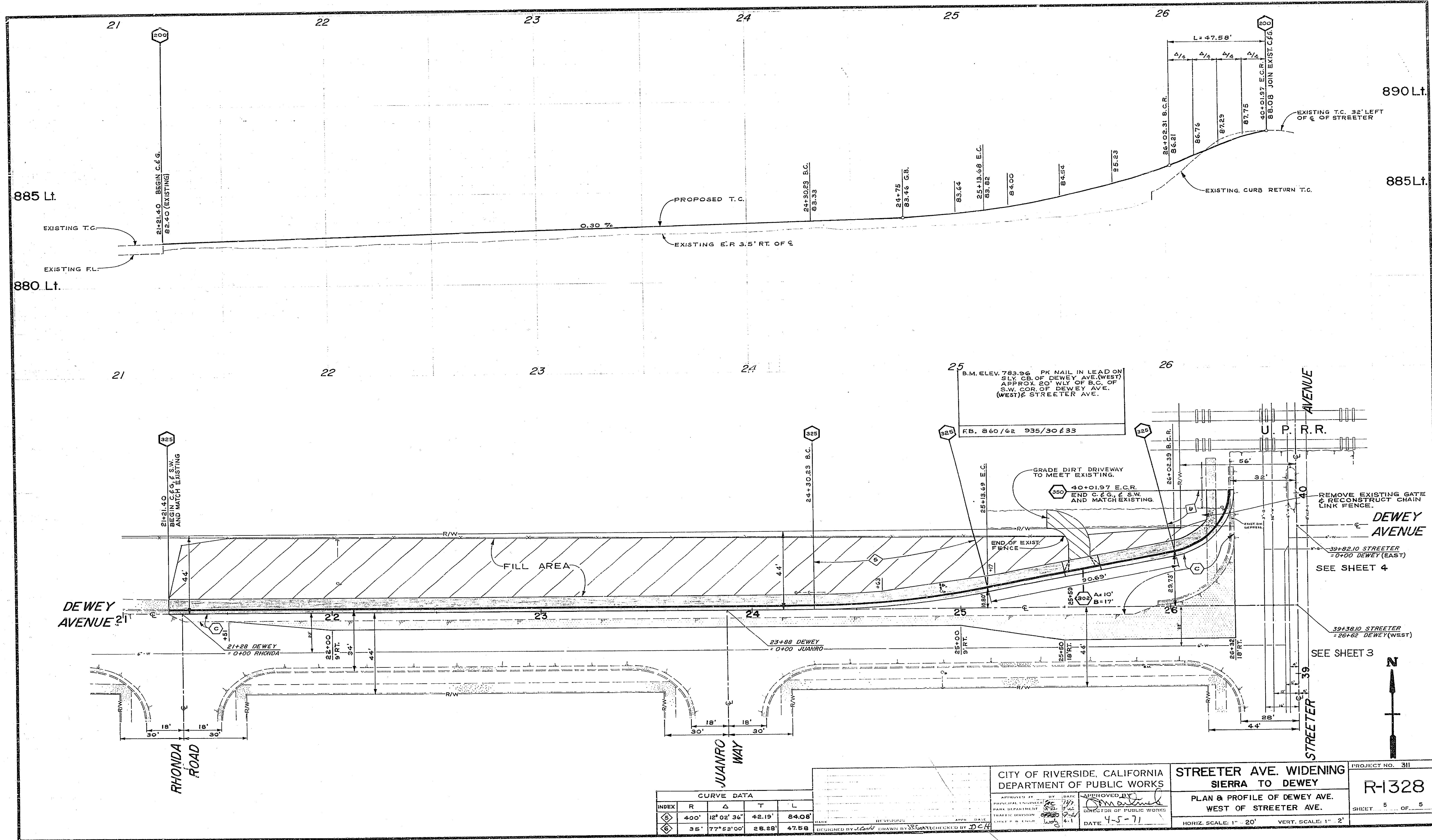

CURVE DATA

INDEX	R	Δ	T	L
①	400'	12° 02' 36"	42.19'	84.08'
②	35'	77° 53' 00"	28.28'	47.58'

CITY OF RIVERSIDE, CALIFORNIA
 DEPARTMENT OF PUBLIC WORKS

APPROVED BY: [Signature]
 DATE: 4-5-71

DESIGNED BY: J. G. [Signature]
 DRAWN BY: S. G. [Signature]
 CHECKED BY: D. C. [Signature]

STREETER AVE. WIDENING
SIERRA TO DEWEY
 PLAN & PROFILE OF DEWEY AVE.
 WEST OF STREETER AVE.

HORIZ. SCALE: 1" = 20'
 VERT. SCALE: 1" = 2'

PROJECT NO. 311
R-1328
 SHEET 5 OF 5