

BENCH MARK
 Checked on curb of Indiana Ave
 127' S. W. of Susan St. (State Hwy.)
 per C.R. F.B. 675/67 - Elev. 825.800
 T.B.M. - Top curb return at E.C.E.
 N.E. Corner Doyle and Indiana
 C.H. Assoc. F.B. 98/98 - Elev. 827.00
 (Sta. 100+65 Indiana)

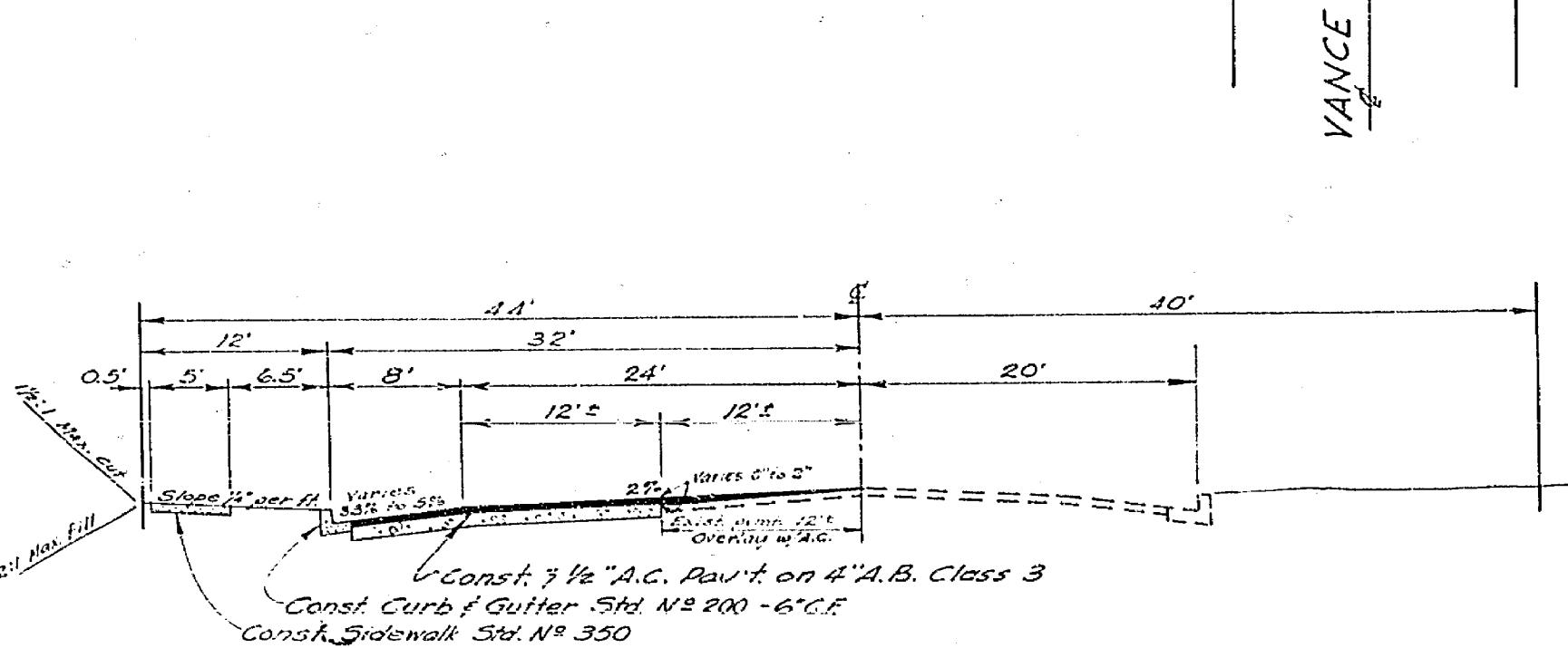
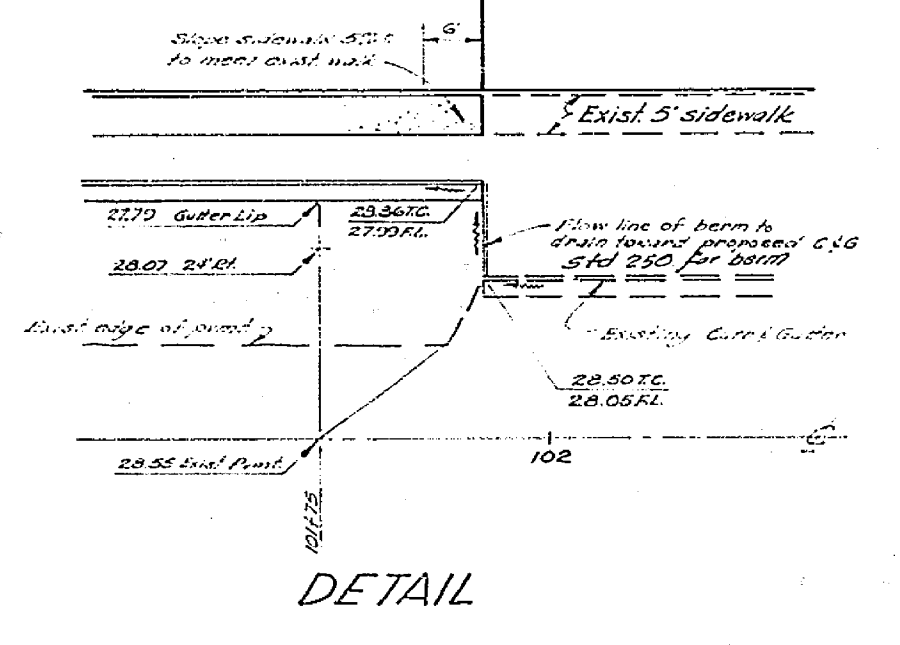
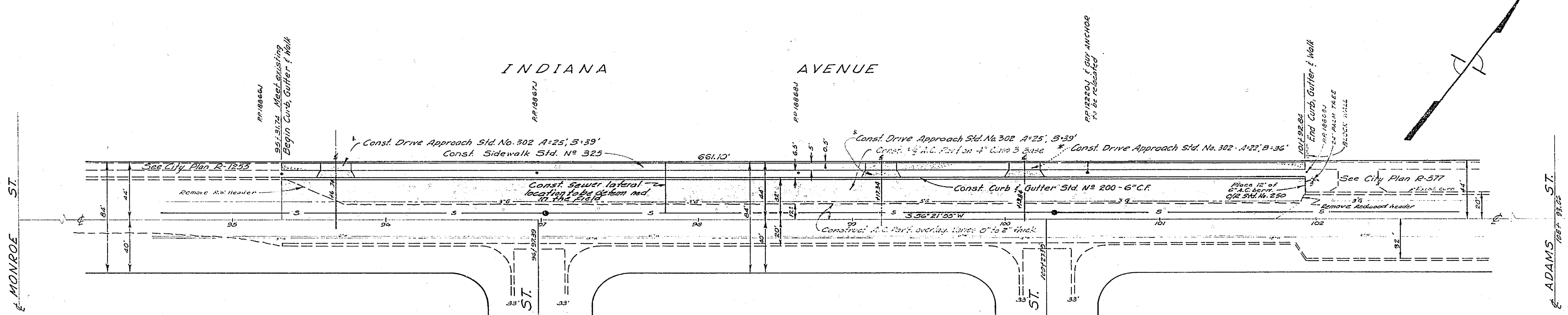

STREET LIGHT LEGEND AND NOTES

- Indicates City of Riverside standard light standards, No. 1500, with 1000 L, 250 W, type II, except as noted. Line Material: mercury vapor luminaire, 500 mA, 115/242 or approved equal.
- Indicates 1/2\"/>

- GENERAL NOTES:**
- It shall be the responsibility of the contractor to clear the right of way in accordance with the provisions of the law as it affects each utility including irrigation lines and appurtenances and at no cost to the city.
 - Construction shall be in accordance with City of Riverside, Department of Public Works Specifications No. 461 and Standard Drawings.
 - Prime coat, seal coat and paint binder are required.
 - Grading will require a permit under Ordinance No. 3093 for a cut or fill exceeding 100 cubic yards or a fill over one foot in depth.
 - Trim edge of existing pavement where new paving joins existing paving to a clean straight edge. Construct match-up paving as shown and overlay as directed in the field to produce a smooth crown section. Engineer estimates the overlay paving to be 20 tons.
 - Driveway approaches shall be in accordance with City of Riverside Std. Dwg. #302 and shall be approved by the Traffic Engineering Division.

TYPICAL SECTION
 INDIANA AVENUE
 Sta. 95+75 to Sta. 101+75
 T.I. - 6

Approved for Street Lights
 General Supt. of Chief Engineer Date

CRAWLEY, HAWKINS & ASSOCIATES
 ENGINEERS AND SURVEYORS
 RIVERSIDE, CALIFORNIA 92502
 Approved: *George O. Crawley* Date 12/27/68
 Reg. Prof. Eng. No. 64451
 FOR: M. J. VODER FB 32

| | | |
|---------|---------------------------------|---------------|
| NO. 1 | ADD 3' DRIVE APPROACHES 2' WIDE | DATE 12-27-68 |
| NO. 2 | ADD 1/2\"/> | |
| NO. 3 | ADD 1/2\"/> | |
| NO. 4 | ADD 1/2\"/> | |
| NO. 5 | ADD 1/2\"/> | |
| NO. 6 | ADD 1/2\"/> | |
| NO. 7 | ADD 1/2\"/> | |
| NO. 8 | ADD 1/2\"/> | |
| NO. 9 | ADD 1/2\"/> | |
| NO. 10 | ADD 1/2\"/> | |
| NO. 11 | ADD 1/2\"/> | |
| NO. 12 | ADD 1/2\"/> | |
| NO. 13 | ADD 1/2\"/> | |
| NO. 14 | ADD 1/2\"/> | |
| NO. 15 | ADD 1/2\"/> | |
| NO. 16 | ADD 1/2\"/> | |
| NO. 17 | ADD 1/2\"/> | |
| NO. 18 | ADD 1/2\"/> | |
| NO. 19 | ADD 1/2\"/> | |
| NO. 20 | ADD 1/2\"/> | |
| NO. 21 | ADD 1/2\"/> | |
| NO. 22 | ADD 1/2\"/> | |
| NO. 23 | ADD 1/2\"/> | |
| NO. 24 | ADD 1/2\"/> | |
| NO. 25 | ADD 1/2\"/> | |
| NO. 26 | ADD 1/2\"/> | |
| NO. 27 | ADD 1/2\"/> | |
| NO. 28 | ADD 1/2\"/> | |
| NO. 29 | ADD 1/2\"/> | |
| NO. 30 | ADD 1/2\"/> | |
| NO. 31 | ADD 1/2\"/> | |
| NO. 32 | ADD 1/2\"/> | |
| NO. 33 | ADD 1/2\"/> | |
| NO. 34 | ADD 1/2\"/> | |
| NO. 35 | ADD 1/2\"/> | |
| NO. 36 | ADD 1/2\"/> | |
| NO. 37 | ADD 1/2\"/> | |
| NO. 38 | ADD 1/2\"/> | |
| NO. 39 | ADD 1/2\"/> | |
| NO. 40 | ADD 1/2\"/> | |
| NO. 41 | ADD 1/2\"/> | |
| NO. 42 | ADD 1/2\"/> | |
| NO. 43 | ADD 1/2\"/> | |
| NO. 44 | ADD 1/2\"/> | |
| NO. 45 | ADD 1/2\"/> | |
| NO. 46 | ADD 1/2\"/> | |
| NO. 47 | ADD 1/2\"/> | |
| NO. 48 | ADD 1/2\"/> | |
| NO. 49 | ADD 1/2\"/> | |
| NO. 50 | ADD 1/2\"/> | |
| NO. 51 | ADD 1/2\"/> | |
| NO. 52 | ADD 1/2\"/> | |
| NO. 53 | ADD 1/2\"/> | |
| NO. 54 | ADD 1/2\"/> | |
| NO. 55 | ADD 1/2\"/> | |
| NO. 56 | ADD 1/2\"/> | |
| NO. 57 | ADD 1/2\"/> | |
| NO. 58 | ADD 1/2\"/> | |
| NO. 59 | ADD 1/2\"/> | |
| NO. 60 | ADD 1/2\"/> | |
| NO. 61 | ADD 1/2\"/> | |
| NO. 62 | ADD 1/2\"/> | |
| NO. 63 | ADD 1/2\"/> | |
| NO. 64 | ADD 1/2\"/> | |
| NO. 65 | ADD 1/2\"/> | |
| NO. 66 | ADD 1/2\"/> | |
| NO. 67 | ADD 1/2\"/> | |
| NO. 68 | ADD 1/2\"/> | |
| NO. 69 | ADD 1/2\"/> | |
| NO. 70 | ADD 1/2\"/> | |
| NO. 71 | ADD 1/2\"/> | |
| NO. 72 | ADD 1/2\"/> | |
| NO. 73 | ADD 1/2\"/> | |
| NO. 74 | ADD 1/2\"/> | |
| NO. 75 | ADD 1/2\"/> | |
| NO. 76 | ADD 1/2\"/> | |
| NO. 77 | ADD 1/2\"/> | |
| NO. 78 | ADD 1/2\"/> | |
| NO. 79 | ADD 1/2\"/> | |
| NO. 80 | ADD 1/2\"/> | |
| NO. 81 | ADD 1/2\"/> | |
| NO. 82 | ADD 1/2\"/> | |
| NO. 83 | ADD 1/2\"/> | |
| NO. 84 | ADD 1/2\"/> | |
| NO. 85 | ADD 1/2\"/> | |
| NO. 86 | ADD 1/2\"/> | |
| NO. 87 | ADD 1/2\"/> | |
| NO. 88 | ADD 1/2\"/> | |
| NO. 89 | ADD 1/2\"/> | |
| NO. 90 | ADD 1/2\"/> | |
| NO. 91 | ADD 1/2\"/> | |
| NO. 92 | ADD 1/2\"/> | |
| NO. 93 | ADD 1/2\"/> | |
| NO. 94 | ADD 1/2\"/> | |
| NO. 95 | ADD 1/2\"/> | |
| NO. 96 | ADD 1/2\"/> | |
| NO. 97 | ADD 1/2\"/> | |
| NO. 98 | ADD 1/2\"/> | |
| NO. 99 | ADD 1/2\"/> | |
| NO. 100 | ADD 1/2\"/> | |
| NO. 101 | ADD 1/2\"/> | |
| NO. 102 | ADD 1/2\"/> | |
| NO. 103 | ADD 1/2\"/> | |
| NO. 104 | ADD 1/2\"/> | |
| NO. 105 | ADD 1/2\"/> | |
| NO. 106 | ADD 1/2\"/> | |
| NO. 107 | ADD 1/2\"/> | |
| NO. 108 | ADD 1/2\"/> | |
| NO. 109 | ADD 1/2\"/> | |
| NO. 110 | ADD 1/2\"/> | |
| NO. 111 | ADD 1/2\"/> | |
| NO. 112 | ADD 1/2\"/> | |
| NO. 113 | ADD 1/2\"/> | |
| NO. 114 | ADD 1/2\"/> | |
| NO. 115 | ADD 1/2\"/> | |
| NO. 116 | ADD 1/2\"/> | |
| NO. 117 | ADD 1/2\"/> | |
| NO. 118 | ADD 1/2\"/> | |
| NO. 119 | ADD 1/2\"/> | |
| NO. 120 | ADD 1/2\"/> | |
| NO. 121 | ADD 1/2\"/> | |
| NO. 122 | ADD 1/2\"/> | |
| NO. 123 | ADD 1/2\"/> | |
| NO. 124 | ADD 1/2\"/> | |
| NO. 125 | ADD 1/2\"/> | |
| NO. 126 | ADD 1/2\"/> | |
| NO. 127 | ADD 1/2\"/> | |
| NO. 128 | ADD 1/2\"/> | |
| NO. 129 | ADD 1/2\"/> | |
| NO. 130 | ADD 1/2\"/> | |
| NO. 131 | ADD 1/2\"/> | |
| NO. 132 | ADD 1/2\"/> | |
| NO. 133 | ADD 1/2\"/> | |
| NO. 134 | ADD 1/2\"/> | |
| NO. 135 | ADD 1/2\"/> | |
| NO. 136 | ADD 1/2\"/> | |
| NO. 137 | ADD 1/2\"/> | |
| NO. 138 | ADD 1/2\"/> | |
| NO. 139 | ADD 1/2\"/> | |
| NO. 140 | ADD 1/2\"/> | |
| NO. 141 | ADD 1/2\"/> | |
| NO. 142 | ADD 1/2\"/> | |
| NO. 143 | ADD 1/2\"/> | |
| NO. 144 | ADD 1/2\"/> | |
| NO. 145 | ADD 1/2\"/> | |
| NO. 146 | ADD 1/2\"/> | |
| NO. 147 | ADD 1/2\"/> | |
| NO. 148 | ADD 1/2\"/> | |
| NO. 149 | ADD 1/2\"/> | |
| NO. 150 | ADD 1/2\"/> | |
| NO. 151 | ADD 1/2\"/> | |
| NO. 152 | ADD 1/2\"/> | |
| NO. 153 | ADD 1/2\"/> | |
| NO. 154 | ADD 1/2\"/> | |
| NO. 155 | ADD 1/2\"/> | |
| NO. 156 | ADD 1/2\"/> | |
| NO. 157 | ADD 1/2\"/> | |
| NO. 158 | ADD 1/2\"/> | |
| NO. 159 | ADD 1/2\"/> | |
| NO. 160 | ADD 1/2\"/> | |
| NO. 161 | ADD 1/2\"/> | |
| NO. 162 | ADD 1/2\"/> | |
| NO. 163 | ADD 1/2\"/> | |
| NO. 164 | ADD 1/2\"/> | |
| NO. 165 | ADD 1/2\"/> | |
| NO. 166 | ADD 1/2\"/> | |
| NO. 167 | ADD 1/2\"/> | |
| NO. 168 | ADD 1/2\"/> | |
| NO. 169 | ADD 1/2\"/> | |
| NO. 170 | ADD 1/2\"/> | |
| NO. 171 | ADD 1/2\"/> | |
| NO. 172 | ADD 1/2\"/> | |
| NO. 173 | ADD 1/2\"/> | |
| NO. 174 | ADD 1/2\"/> | |
| NO. 175 | ADD 1/2\"/> | |
| NO. 176 | ADD 1/2\"/> | |
| NO. 177 | ADD 1/2\"/> | |
| NO. 178 | ADD 1/2\"/> | |
| NO. 179 | ADD 1/2\"/> | |
| NO. 180 | ADD 1/2\"/> | |
| NO. 181 | ADD 1/2\"/> | |
| NO. 182 | ADD 1/2\"/> | |
| NO. 183 | ADD 1/2\"/> | |
| NO. 184 | ADD 1/2\"/> | |
| NO. 185 | ADD 1/2\"/> | |
| NO. 186 | ADD 1/2\"/> | |
| NO. 187 | ADD 1/2\"/> | |
| NO. 188 | ADD 1/2\"/> | |
| NO. 189 | ADD 1/2\"/> | |
| NO. 190 | ADD 1/2\"/> | |
| NO. 191 | ADD 1/2\"/> | |
| NO. 192 | ADD 1/2\"/> | |
| NO. 193 | ADD 1/2\"/> | |
| NO. 194 | ADD 1/2\"/> | |
| NO. 195 | ADD 1/2\"/> | |
| NO. 196 | ADD 1/2\"/> | |
| NO. 197 | ADD 1/2\"/> | |
| NO. 198 | ADD 1/2\"/> | |
| NO. 199 | ADD 1/2\"/> | |
| NO. 200 | ADD 1/2\"/> | |

CITY OF RIVERSIDE, CALIFORNIA
 DEPARTMENT OF PUBLIC WORKS
 APPROVED BY: *George O. Crawley* DATE 12/27/68
 OFFICE ENGINEER
 TRAFFIC DIVISION
 DATE 3-7-69

Soil Report #695 R-77
STREET PLAN & PROFILE
 INDIANA AVENUE
 FROM DOYLE ST. TO YANCEY ST.
 NORTHERLY SIDE ONLY
 R-11-689
 HORIZ. SCALE: 1" = 40'
 VERT. SCALE: 1" = 4'

PROJECT NO.
R-1330
 SHEET 1 OF 1
 FILE NO. 4144