

B.M. R/R SPUR IN PR. 063152 (New) IN 09+18.33 S.S. HOLE CORNER. HEDRICK AVE. ILL. 708.42 C.R. R.R. 704129

- GENERAL NOTES**
1. ALL CONSTRUCTION SHALL BE IN ACCORDANCE WITH THE CITY OF RIVERSIDE, DEPT. OF PUBLIC WORKS SPECIFICATION No. 401 AND STANDARD DWGS.
 2. IT SHALL BE THE RESPONSIBILITY OF THE CONTRACTOR TO CLEAR THE RIGHT-OF-WAY IN ACCORDANCE WITH THE PROVISIONS OF THE LAW AS IT APPLICABLE TO EACH UTILITY INCLUDING RELOCATION LINES AND APPROVED AND A-NO COST TO THE CITY.
 3. TRIM EDGE OF EXISTING PAVEMENT WHILE NEW PAVEMENT JOINS EXISTING PAVEMENT TO A CLEAN STRAIGHT LINE. CONSTRUCT MATCH-UP PAVEMENT AS SHOWN, AND OVERLAY IN VARIATION IN THE FIELD TO PROVIDE A SMOOTH CROWN SECTION. ENGINEER ESTIMATES OVERLAY TO BE APPROXIMATELY 22 THICK.

4. FOR RELOCATION OF CITY ELECTRIC FACILITY CONTACT Mr. HARR AT 787-7442. ALLOW 2 WEEKS TO FURNISH A WORK ORDER AND RELOCATION WORK BEGINS.
5. PRIME COAT, SEAL COAT, AND PAINT BINDER ARE REQUIRED.
6. CONTRACTOR TO CONTACT THE CITY ENGINEER TO NEGOTIATE FOR THE CITY'S PORTION OF THIS CONSTRUCTION. ALLOW 2 WEEKS TO PROCESS A WORK ORDER.
7. CONTACT SUBWAY WATER CO. AT (714) 689-4824 24 HRS. PRIOR TO CONSTRUCTION FOR EXACT WATER LINE LOCATION.

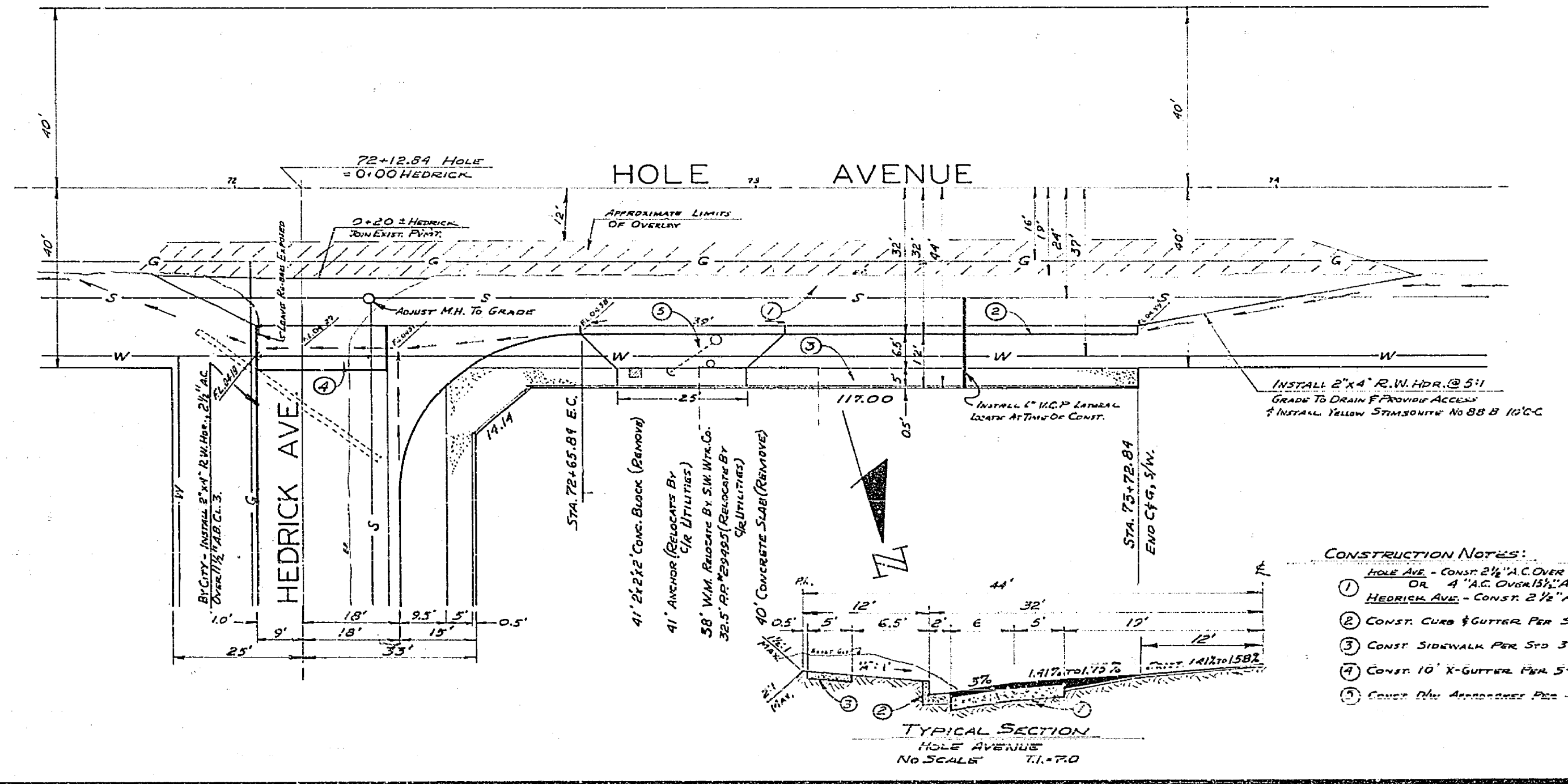

- CONSTRUCTION NOTES:**
1. HOLE AVE. - CONST. 2 1/2" A.C. OVER 4" A.B. CL. 2 OVER 1 1/2" A.B. CL. 3
 2. HEDRICK AVE. - CONST. 2 1/2" A.C. OVER 1 1/2" A.B. CL. 3
 3. CONST. CURB & GUTTER PER STA. 200 6" C.F.
 4. CONST. SIDEWALK PER STA. 350
 5. CONST. 10" X-GUTTER PER STA. 280
 6. CONST. ALL APPROVED PER STA. 308 AS SHOWN

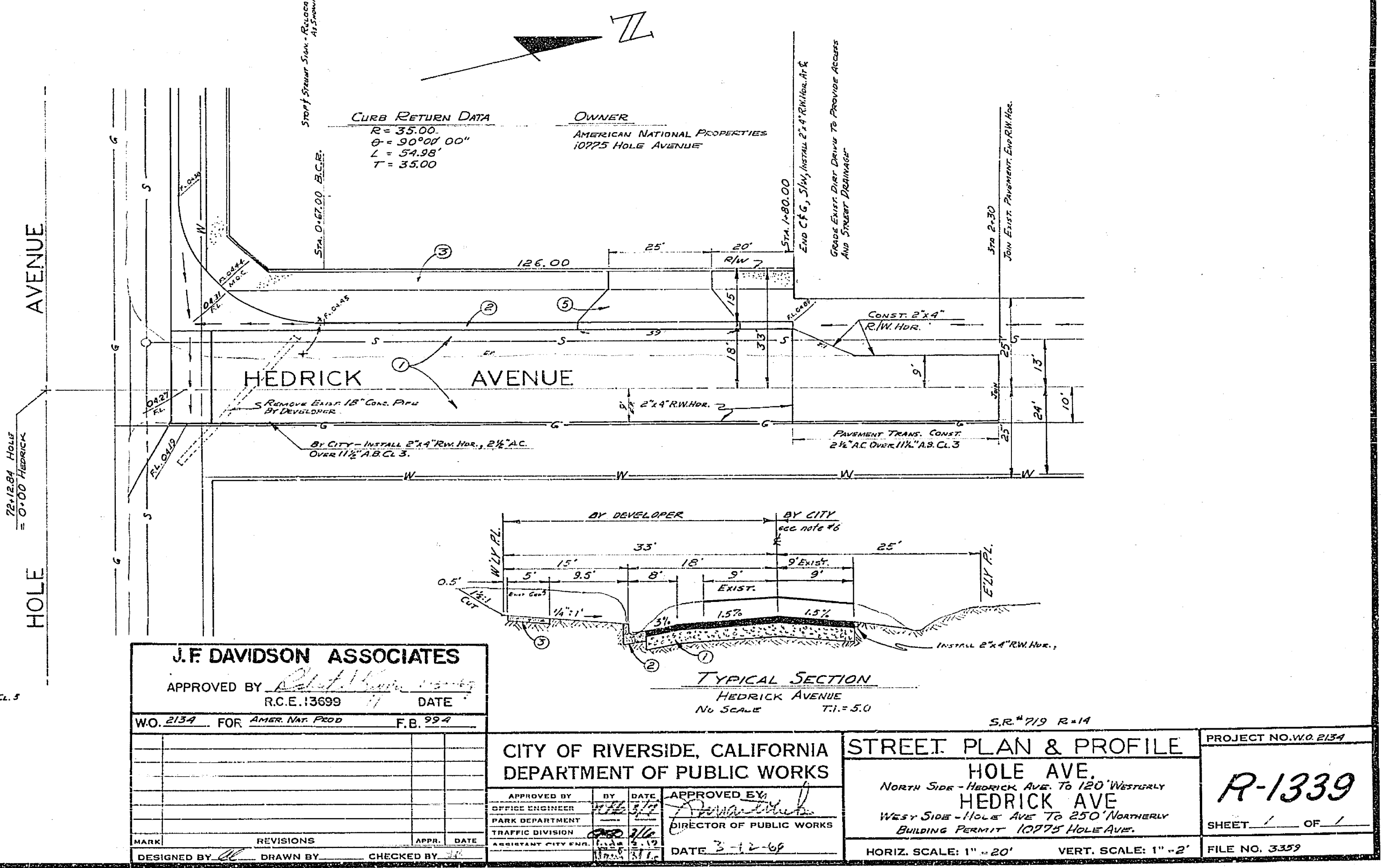

J.F. DAVIDSON ASSOCIATES APPROVED BY: <i>[Signature]</i> R.C.E. 13699 DATE: <i>[Date]</i>		CITY OF RIVERSIDE, CALIFORNIA DEPARTMENT OF PUBLIC WORKS		STREET PLAN & PROFILE HOLE AVE NORTH SIDE - HEDRICK AVE. TO 120' WESTWARD HEDRICK AVE WEST SIDE - HOLE AVE. TO 250' NORTHEAST BUILDING PERMIT 10775 HOLE AVE.		PROJECT NO. WO. 2134 R-1339 SHEET 1 OF 1 FILE NO. 3.357	
WO. 2134 FOR AMER. NAT. PROD. F.B. 994		APPROVED BY: <i>[Signature]</i> DIRECTOR OF PUBLIC WORKS DATE: 3-12-69		HORIZ. SCALE: 1" = 20' VERT. SCALE: 1" = 2'		DESIGNER: <i>[Signature]</i> DRAWN BY: <i>[Signature]</i> CHECKED BY: <i>[Signature]</i>	