

Scale 1"=100'

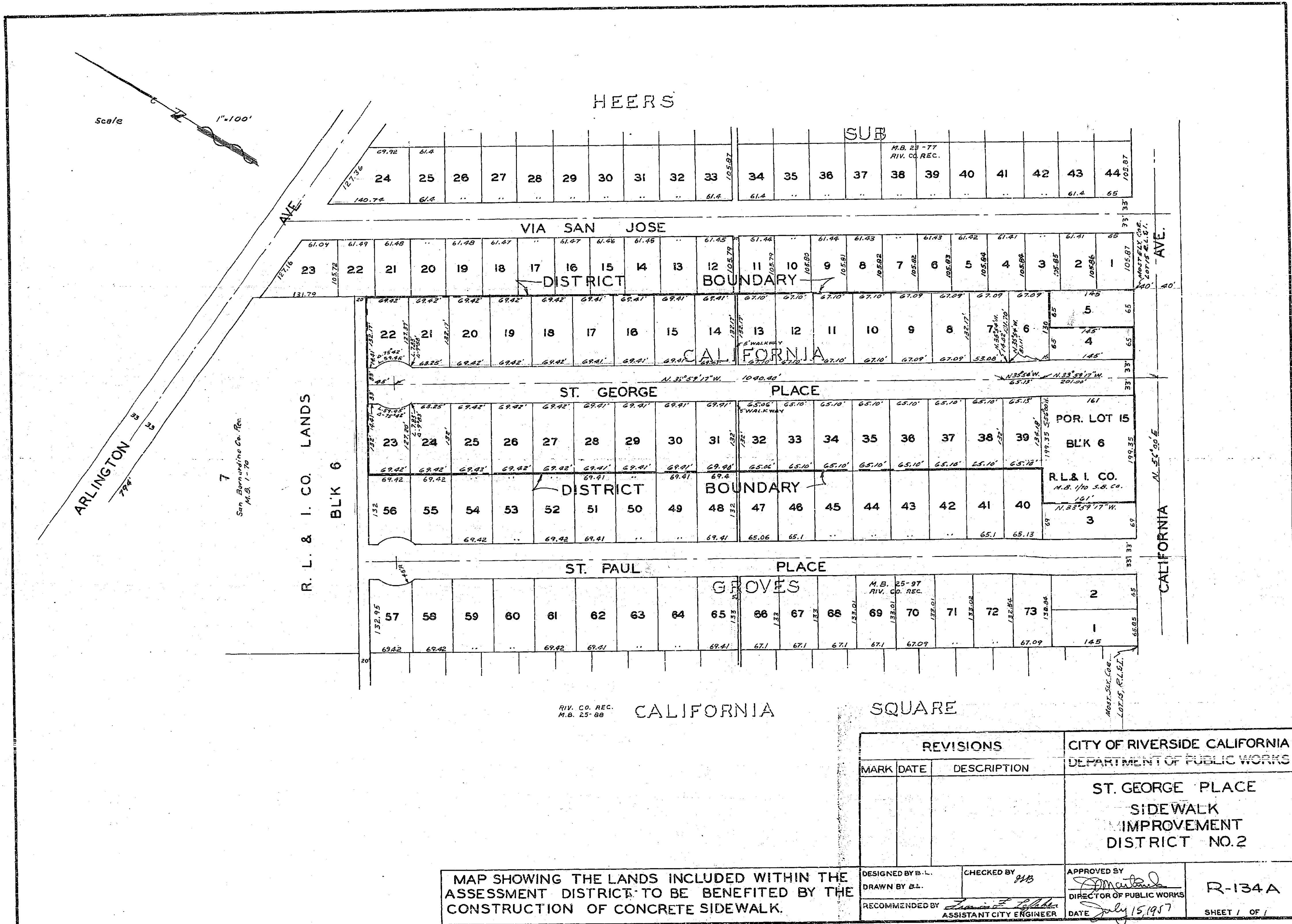

MAP SHOWING THE LANDS INCLUDED WITHIN THE ASSESSMENT DISTRICT TO BE BENEFITED BY THE CONSTRUCTION OF CONCRETE SIDEWALK.

REVISIONS		CITY OF RIVERSIDE CALIFORNIA DEPARTMENT OF PUBLIC WORKS	
MARK	DATE	DESCRIPTION	
			ST. GEORGE PLACE SIDEWALK IMPROVEMENT DISTRICT NO.2
DESIGNED BY B.L.		CHECKED BY <i>HB</i>	APPROVED BY <i>[Signature]</i>
DRAWN BY B.L.			DIRECTOR OF PUBLIC WORKS
RECOMMENDED BY <i>[Signature]</i>		ASSISTANT CITY ENGINEER	DATE July 15, 1917
			R-134A SHEET 1 OF 1