

77

77

77

77

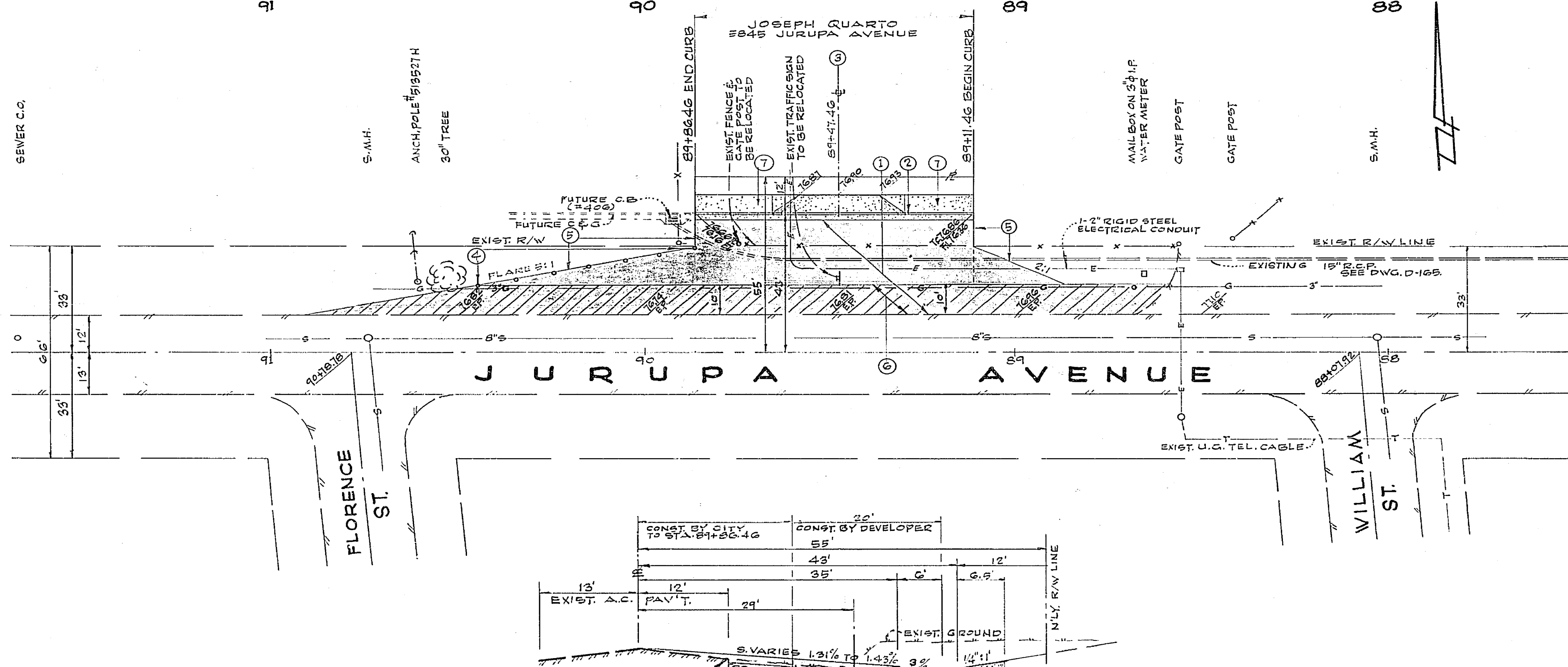
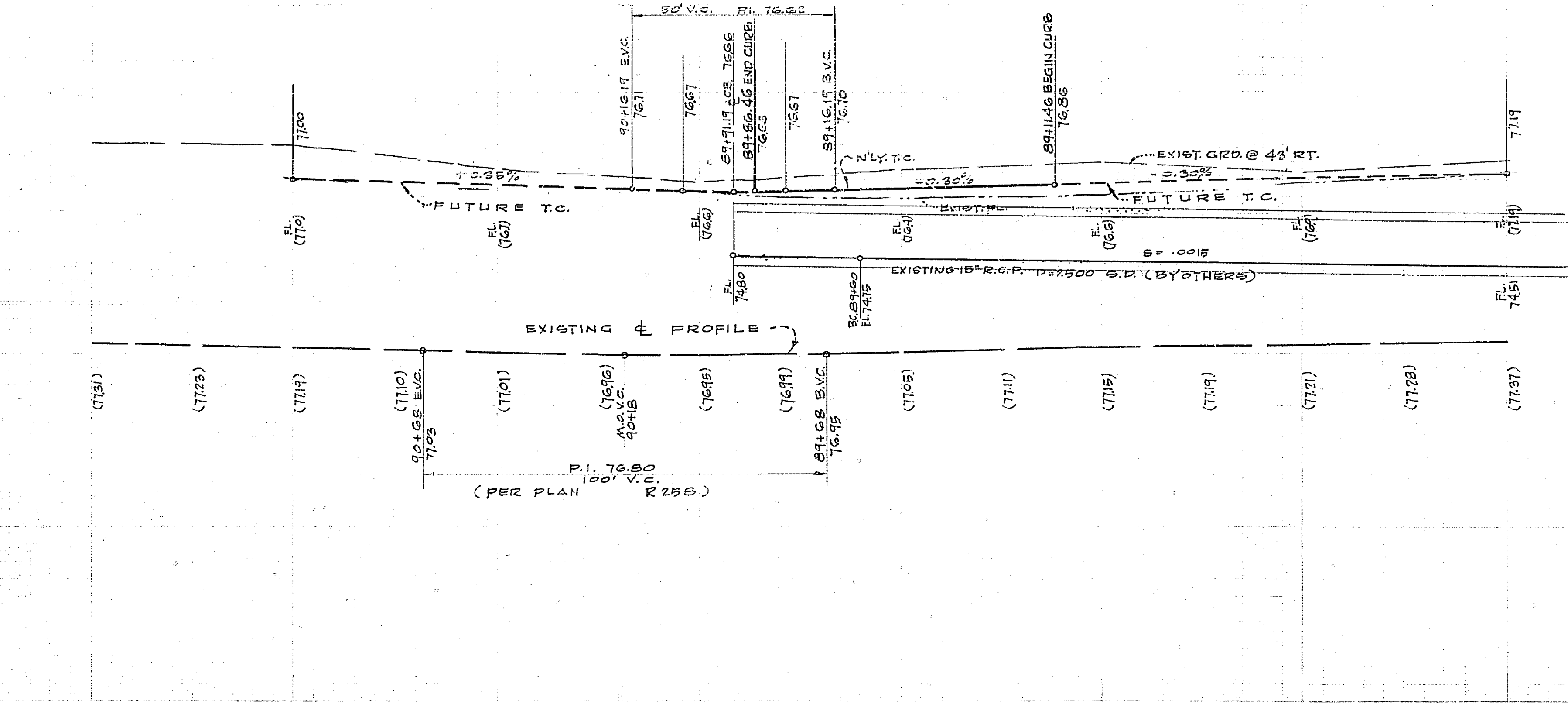

GENERAL NOTES

- CONSTRUCTION SHALL BE IN ACCORDANCE WITH THE CITY OF RIVERSIDE DEPARTMENT OF PUBLIC WORKS SPECIFICATIONS NO. 401 AND STANDARD DRAWINGS.
- IT SHALL BE THE RESPONSIBILITY OF THE CONTRACTOR TO CLEAR THE RIGHT OF WAY IN ACCORDANCE WITH THE PROVISIONS OF THE LAW AS IT EFFECTS EACH UTILITY INCLUDING IRRIGATION LINES AND APPURTENANCES AT NO COST TO THE CITY.
- PRIME COAT, SEAL COAT AND PAINT BINDER ARE REQUIRED.
- GRADING WILL REQUIRE A PERMIT UNDER ORDINANCE NO 3095 FOR CUT OR FILL EXCEEDING 100 CUBIC YARDS OR A FILL OVER ONE FOOT IN DEPTH.
- TRIM EDGES OF EXIST. PAVEMENT WHERE NEW PAVEMENT JOINS EXISTING PAVEMENT TO A CLEAN STRAIGHT EDGE. CONSTRUCT MATCH-UP PAVING AS SHOWN AND OVERLAY AS DIRECTED IN THE FIELD TO PRODUCE A SMOOTH CROWN SECTION. ENGINEER'S ESTIMATE OF PAVEMENT OVERLAY IS LESS THAN 1-TON.

CONSTRUCTION NOTES

- CONST. 0.33' A.C. OVER 1.33' CLASS 3 A.B.
- CONST. CURB & GUTTER STD. NO. 200 (6\"/>

NOTE: CONTRACTOR TO CONTACT CITY ENGINEER TWO WEEKS PRIOR TO CONSTRUCTION TO NEGOTIATE FOR CITY'S PORTION.

QUANTITY ESTIMATE

STREET EXCAVATION	190	CY
STREET EMBANKMENT	NONE	CY
4\"/>		

BENCH MARK CITY OF RIVERSIDE - PK. NAIL IN ELY. CURB OF FLORENCE ST. AND 84' G'LY. OF E.O. JURUPA AVE. - 56.6307 ELEV. 776.55

-CAUTION-
PACIFIC TELEPHONE
CABLES UNDERGROUND
BEFORE EXCAVATING
CALL COLLECT

7:30 A.M. to 5 P.M. After Hours

Orange County	714-833-0811	714-547-4606
Riverside County	714-864-0071	714-547-4606
Inyo County	714-864-0071	714-547-4606
San Bernardino County	714-864-0071	714-547-4606
Los Angeles County	213-621-3111	24 HOUR SERVICE
Ventura County	213-621-3111	24 HOUR SERVICE
San Diego County	714-798-0395	714-732-0027

FOR FREE CABLE LOCATING SERVICE

TYPICAL HALF SECTION JURUPA AVE. SCALE: HORIZ. 1\"/>

CRAWLEY, HAWKINS & ASSOC.
 ENGINEERS & SURVEYORS
 RIVERSIDE CALIF. 664-9522

APPROVED: *George A. Crawley* DATE 5-5-69
 REG. CIVIL ENGINEER NO. 9455

FOR JOB QUARTO RB. 30/39

CHANGED PROPOSED 15\"/>

CITY OF RIVERSIDE, CALIFORNIA
DEPARTMENT OF PUBLIC WORKS

APPROVED BY: *[Signature]* DATE 7-25-69
 OFFICE ENGINEER
 PARK DEPARTMENT
 TRAFFIC DIVISION
 ASSISTANT CITY ENG. *[Signature]*

STREET PLAN & PROFILE
 BLDG. PERMIT 8845 JURUPA AVE.

JURUPA AVENUE
 FROM 10354' TO 17854' W'LY OF WILLIAM ST.

HORIZ. SCALE: 1\"/>

PROJECT NO. **R-1377**

SHEET **1** OF **1**

FILE NO. **4153**