

B.M. 816.22 - 20' SPK IN POLE # 6290 J, SLY SIDE INDIANA
 1977 WLY OF MONROE
 B.M. 830.26 - PK IN NLY CB INDIANA, NW COR. OF
 JACKSON & INDIANA. (SEE B.M. BOOK)
 FB: 548/14
 SCALES: HOR. 1" = 40', VERT. 1" = 4'

NOTE:
 1. Contractor to remove or replace all obstructions above or below ground which interfere with construction.
 2. Sub-grade preparation shall conform with State of California Standard Specifications, Part 500, Section 500.01
 except that the relative to section shall be not less than 90% for a depth of 0.5' feet.
 3. Sub-grade shall conform with State of California Standard Specifications, Part 500, Chapter 500.01, Class A and
 whenever that is 2% thick and conform with State of California Standard Specifications, Part 500, Chapter 500.01, Class
 for Class B pavement with 18 maximum aggregate and with Sections 54 & 55 for stone reinforced Paving A minimum
 construction range of 200-300 or better.

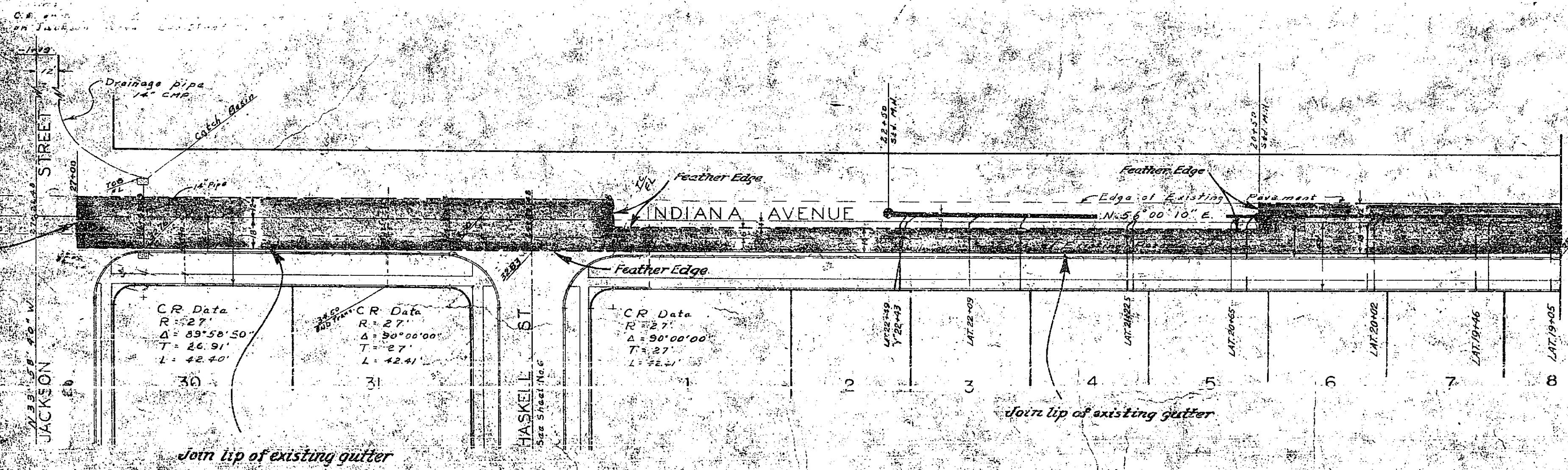

STATION	0	1	2	3	4	5	6	7	8
ELEVATION	830.00	830.00	830.00	830.00	830.00	830.00	830.00	830.00	830.00
PROPOSED	830.00	830.00	830.00	830.00	830.00	830.00	830.00	830.00	830.00
EXISTING	830.00	830.00	830.00	830.00	830.00	830.00	830.00	830.00	830.00

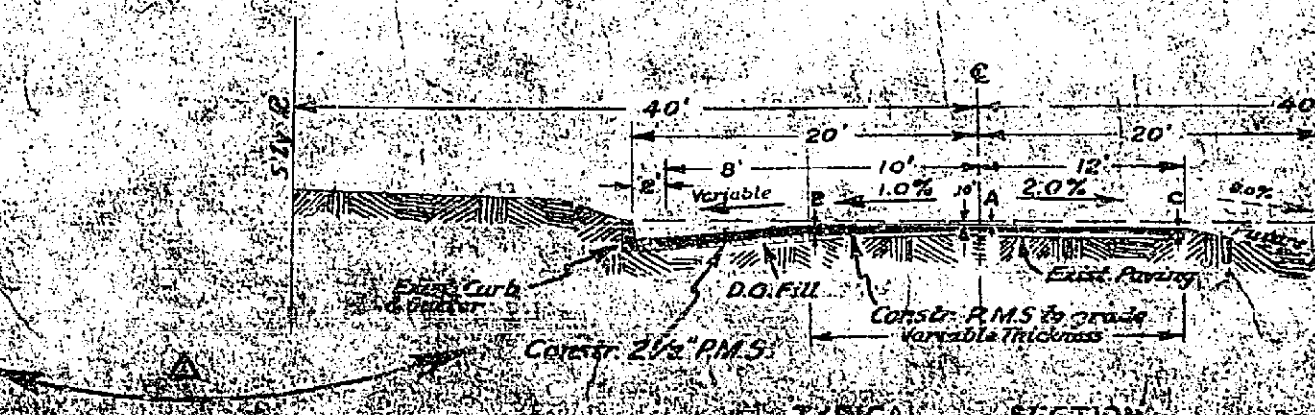

TYPICAL SECTION
 Scale: 1" = 10'
 13+00 TO 20+50
 24+00 TO 27+00

STATION	E
20+00	0
21+00	18
22+00	27
23+00	36
24+00	45
25+00	54
26+00	63
27+00	72

REVISIONS		
MARK	DATE	DESCRIPTION
Δ	10-3-57	Modified Cross Sections

CITY OF RIVERSIDE CALIFORNIA
 DEPARTMENT OF PUBLIC WORKS
 PAVING PLAN 6, P.C.
 INDIANA AVENUE
 MATCH-UP PAVING IN CONNECTION
 WITH STREET REPAIRS
 HORIZ. SCALE: 1" = 40'
 DESIGNED BY: H. B. ...
 DRAWN BY: H. B. ...
 APPROVED BY: ...

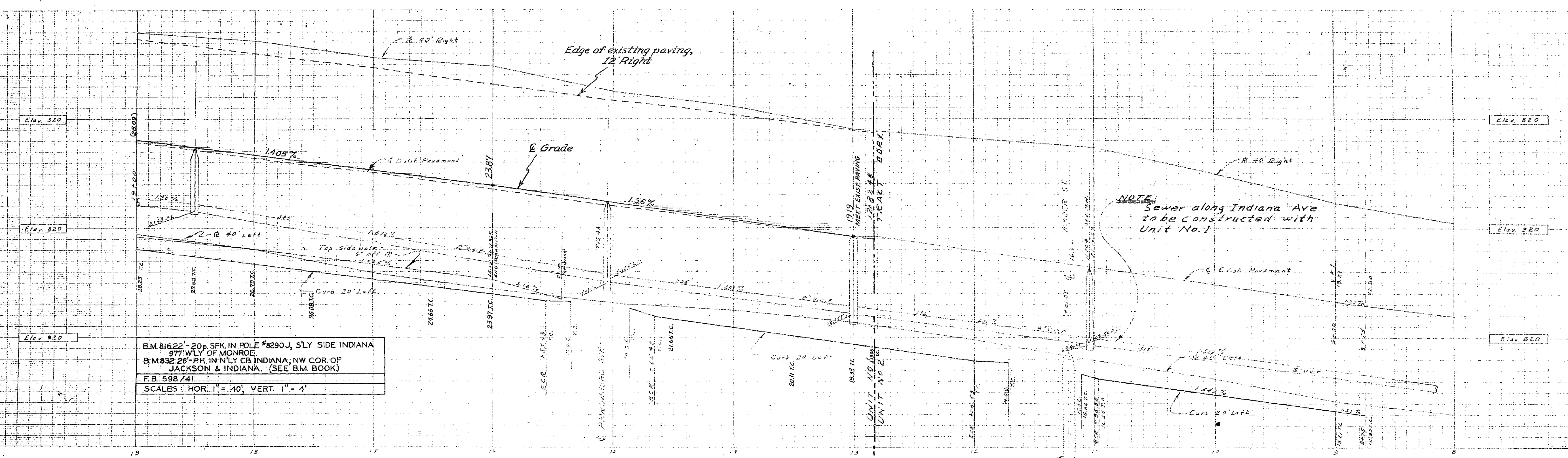

B.M. 81622' - 20p. SPK IN POLE #8290 J, S'LY SIDE INDIANA
 977' W'LY OF MONROE.
 B.M. 83226' - PK. IN N'LY CB. INDIANA, NW COR. OF
 JACKSON & INDIANA. (SEE B.M. BOOK)
 F.B. 598741.
 SCALES: HOR. 1" = 40', VERT. 1" = 4'

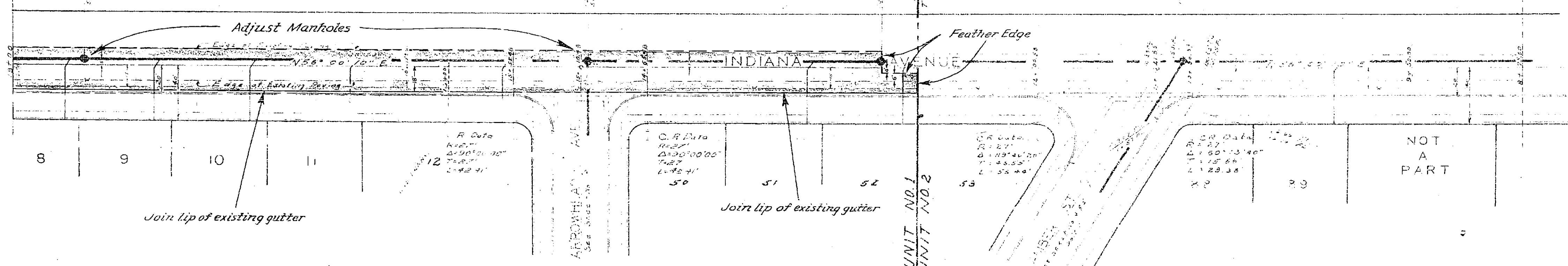

REVISIONS		CITY OF RIVERSIDE, CALIFORNIA DEPARTMENT OF PUBLIC WORKS
MARK	DATE	

DESIGNED BY H. B.
 DRAWN BY H. D.
 RECOMMENDED BY *[Signature]*
 ASSISTANT CITY ENGINEER

APPROVED BY *[Signature]*
 DIRECTOR OF PUBLIC WORKS

DATE *2/26/1957* SHEET *2*

NO. **R-14**

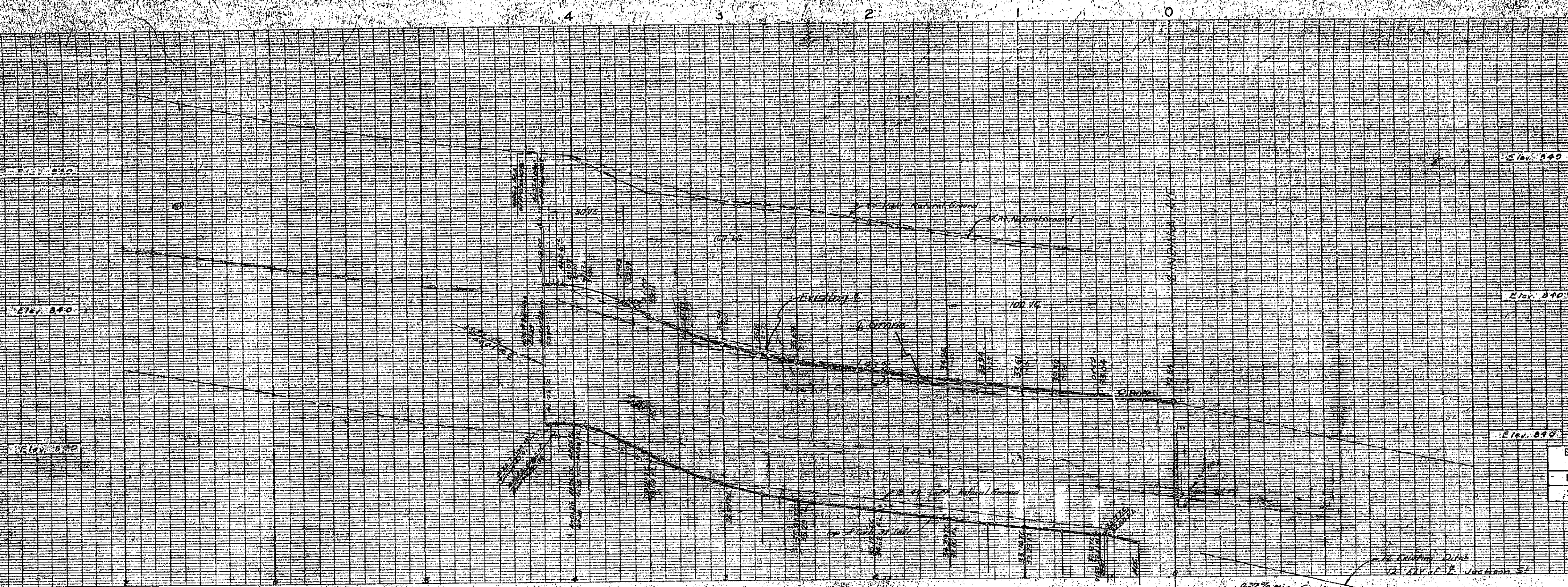

B.M. ELEV. 632.25', PK IN NLY CB, INDIANA,
 NW COR. INDIANA & JACKSON. (SEE B.M. BK.)
 F.B. 550/21, 588/76
 SCALES: HOR. 1" = 40', VERT. 1" = 4'

NOTE: (Jackson St. only)
 1- Paving to be done by the Contractor
 2- Materials to be furnished by the Subdivider.

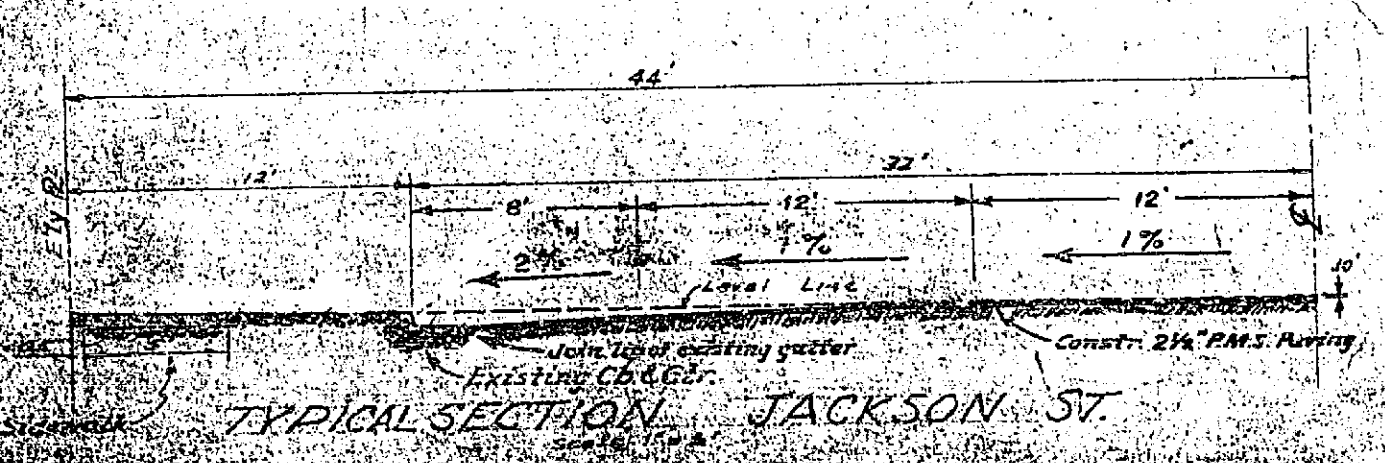
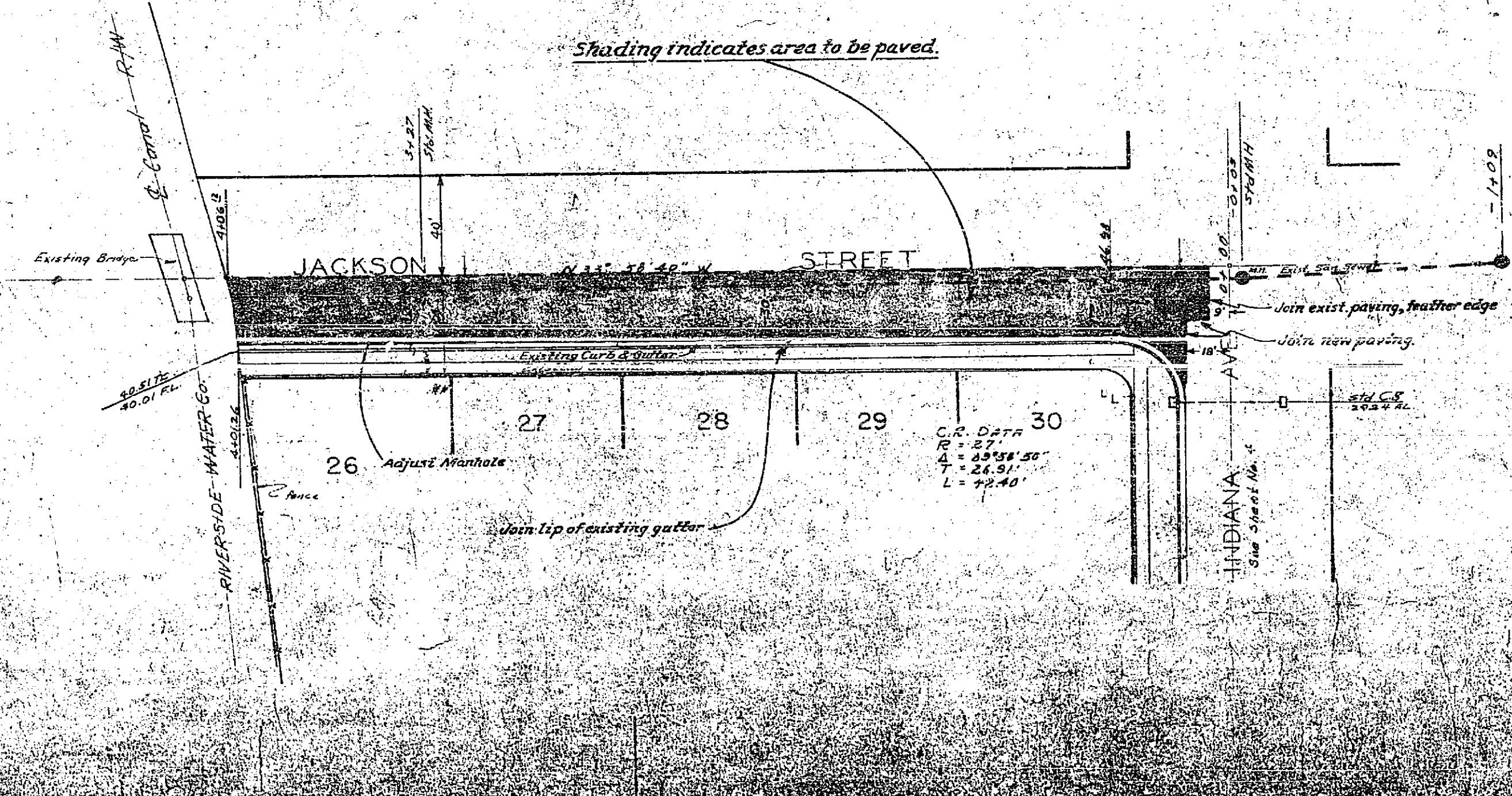

REVISIONS		
MARK	DATE	DESCRIPTION

CITY OF RIVERSIDE, CALIFORNIA
 DEPARTMENT OF PUBLIC WORKS
 PAVING PLAN & PROFILE
 JACKSON STREET
 MATCH-UP PAVING IN CONNECTION WITH
 AMBERWOOD TRAIL
 HORIZ. SCALE 1" = 40' VERT. SCALE 1" = 4'
 DESIGNED BY H.B.H. CHECKED BY W.D.A.
 DRAWN BY H.B.H. APPROVED BY [Signature]
 RECOMMENDED BY [Signature] ASSISTANT CITY ENGINEER
 NO. R-12