

741
 E 740
 RT. 740
 739

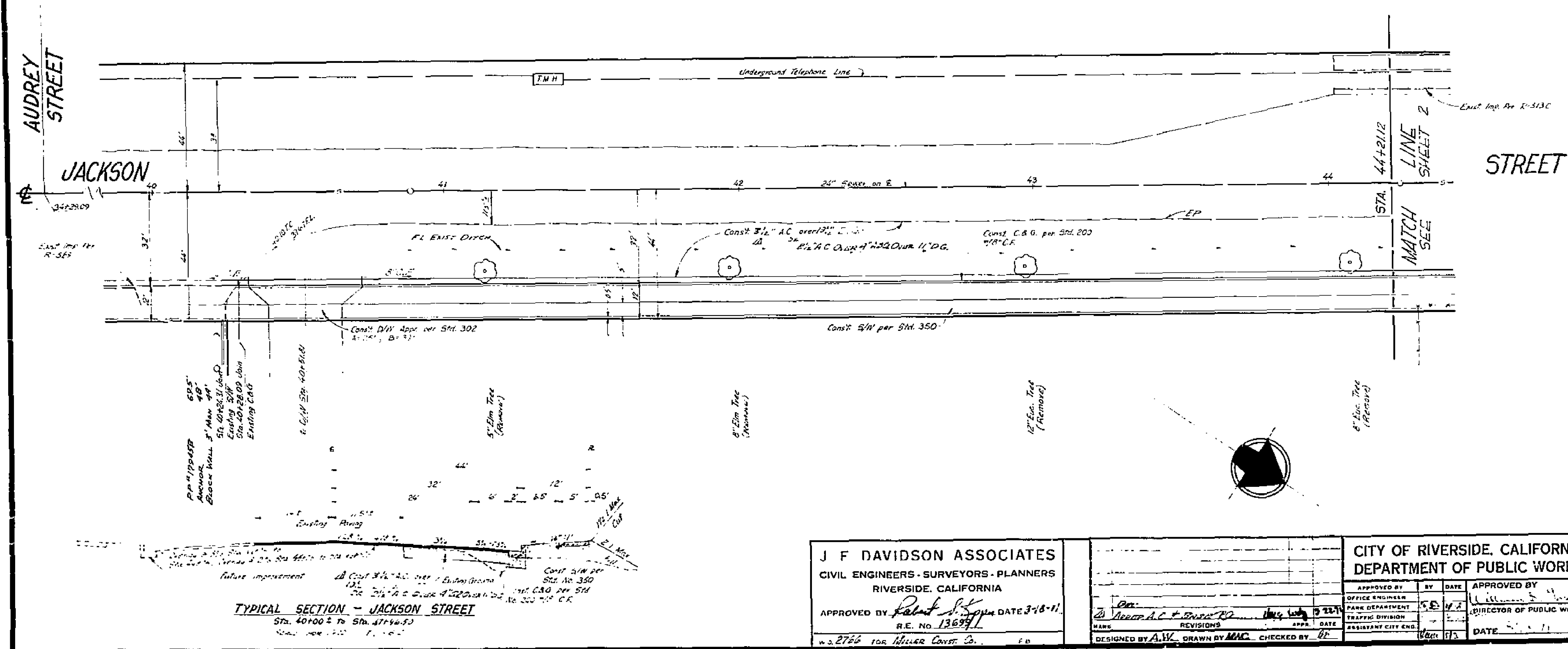

45
 B.M. - PA NAIL IN LEAD AT THE NW COR. OF
 CYPRESS AND 15th ST. ELEV. 736.197
 9/4 FB 908/31-50, 55-57
 I.B.M. - CURB D SOUTH END DIW STATION 40+26
 Elev. 740.26 I.F.D. FB 102515

- GENERAL NOTES:**
1. Construction shall be in accordance with the Standard Specifications for Public Works construction, 1970 Edition and City of Riverside Standard Drawings.
 2. The Developer shall arrange for a soils test at the sub-grade level by a Soils Engineer. Thickness of pavement and thickness and type of aggregate base shall be determined by the Soils Engineer and submitted to the City of Riverside for approval prior to construction.
 3. A.B. Class 2 1/2" Bit Pine Straps Spacing

-CAUTION-
PACIFIC TELEPHONE
CABLES UNDERGROUND
BEFORE EXCAVATING
CALL COLLECT

After Hours & Holidays
 7:30 AM to 5 PM

Orange County	714 631-5451	714 541-5451
San Diego County	714 684-7611	714 541-5454
Imperial County	714 684-6071	714 541-5454
San Bernardino County	714 684-6071	714 541-5454
Los Angeles County	714 684-6071	714 541-5454
Ventura County	213 621-3111	24 HOUR SERVICE
San Diego County	714 594-2595	714 541-5454

FOR FREE CABLE LOCATING SERVICE

J F DAVIDSON ASSOCIATES
 CIVIL ENGINEERS - SURVEYORS - PLANNERS
 RIVERSIDE, CALIFORNIA

APPROVED BY *Robert S. Spivey* DATE 3-18-11
 R.E. No. 136971

DESIGNED BY A.W. DRAWN BY MNC. CHECKED BY GP

CITY OF RIVERSIDE, CALIFORNIA DEPARTMENT OF PUBLIC WORKS	
APPROVED BY	DATE
OFFICE ENGINEER	DATE
TRAFFIC DIVISION	DATE
REVISIONS	DATE
DESIGNED BY	DATE
DRAWN BY	DATE
CHECKED BY	DATE

STREET PLAN AND PROFILE		PROJECT NO.
JACKSON STREET		R-1422
EAST SIDE 600'± TO 1700'± N1/4 OF AUDREY STREET.		SHEET. 1 OF 2
TRACT 4244		FILE NO. 3386
HORIZ. SCALE: 1" = 20'	VERT. SCALE: 1" = 2'	

TYPICAL SECTION - JACKSON STREET
 Sta. 40+00 ± to Sta. 47+50 ±

742
741 ±
740

741
740 RT.
739
738

742
± 741
740

741
740
RT.
739
738

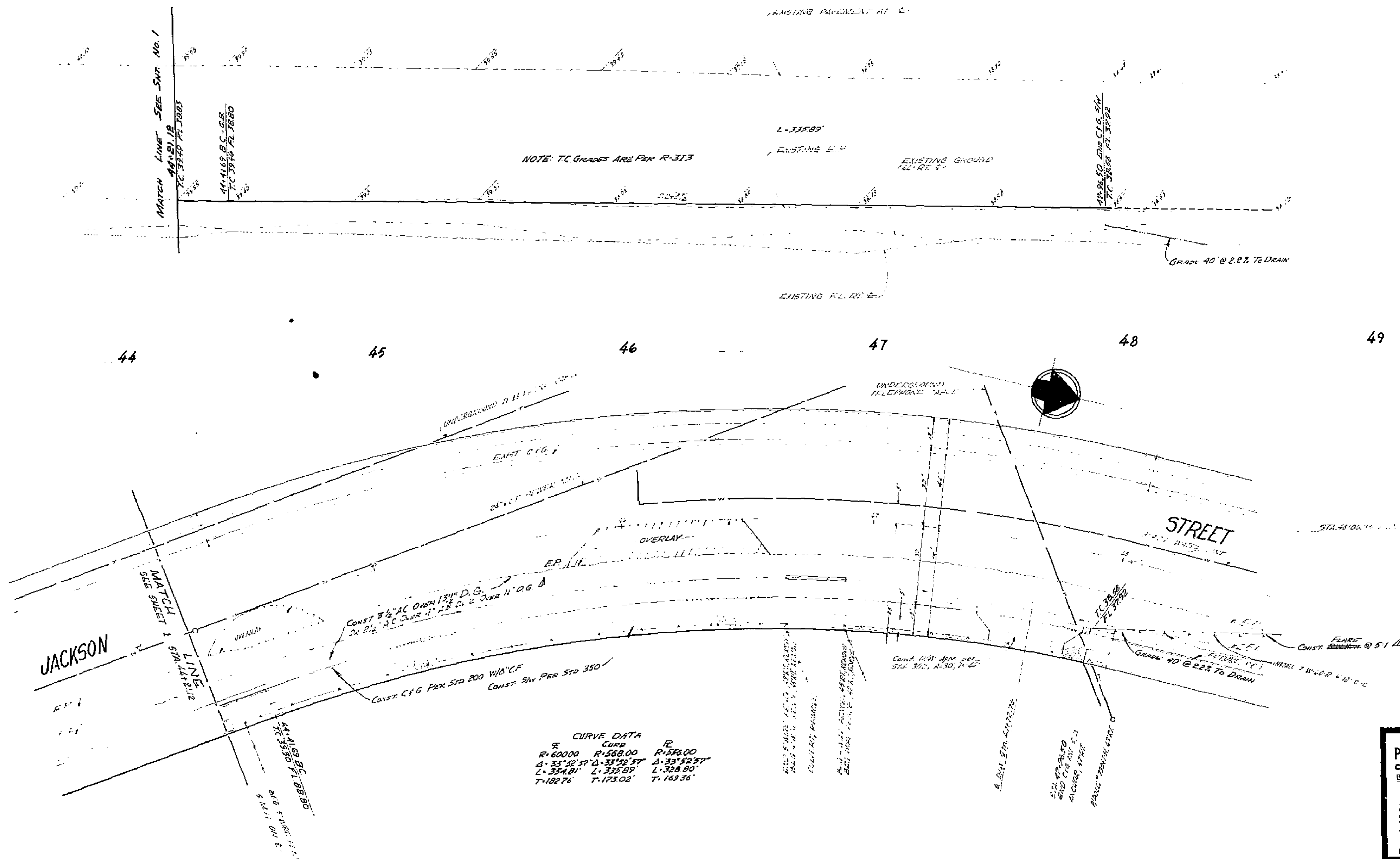

CURVE DATA

Curve	R	L	T
1	60000	558.00	576.00
2	33°52'57" Δ	33°52'57"	33°52'57"
3	354.01'	335.89'	328.80'
4	182.76'	173.02'	169.36'

-CAUTION-
PACIFIC TELEPHONE
CABLES UNDERGROUND
BEFORE EXCAVATING
CALL COLLECT

7:30 A.M. to 5 P.M. & Holidays

San Francisco 714-221-1111
Los Angeles County 714-284-0501
Orange County 714-284-0501
San Bernardino County 714-284-0501
San Diego County 714-284-0501
Ventura County 714-284-0501

FOR FREE CABLE LOCATING SERVICE

J. F. DAVIDSON ASSOCIATES
CIVIL ENGINEERS - SURVEYORS - PLANNERS
RIVERSIDE, CALIFORNIA

APPROVED BY *Robert D. Kopp* DATE 3-18-71
R.E. No. 136971

W.D.P.66 FOR MILLER CONST. CO. F.G.

DESIGNED BY *AW* DRAWN BY *MC* CHECKED BY *RB*

REVISIONS

NO.	DATE	DESCRIPTION
1	3-18-71	AS SHOWN

CITY OF RIVERSIDE, CALIFORNIA
DEPARTMENT OF PUBLIC WORKS

APPROVED BY *[Signature]* DATE 3-18-71
OFFICE ENGINEER
PARK DEPARTMENT
TRAFFIC DIVISION
ASSISTANT CITY ENG.

STREET PLAN AND PROFILE
JACKSON STREET
EAST SIDE 600'± TO 1700'± N/4
OF AUDREY STREET
TRACT 4244

HORIZ. SCALE 1" = 20' VERT. SCALE 1" = 2'

PROJECT NO. **R-1422**
SHEET **2** OF **2**
FILE NO. 3386