

**NOTICE TO CONTRACTOR**  
 The existence and location of any underground utility pipes or structures shown on these plans are obtained in a search of the available records. It is the responsibility of the contractor to locate and mark all utilities shown on these plans.  
 The contractor is to take due precautions to protect the utility lines shown on these plans and any other lines not shown on these plans.

**ALBERT A. WEBB ASSOCIATES**  
 CIVIL ENGINEERS  
 RIVERSIDE, CALIFORNIA  
 APPROVED BY: *[Signature]* DATE: 1/15/71  
 R.E. NO. 2276

**ADDED CURB DEPRESSION** KARL...  
 1-16-71  
 1-21-71

**DESIGNED BY: [Signature] DRAWN BY: [Signature] CHECKED BY: [Signature]**

**CITY OF RIVERSIDE, CALIFORNIA**  
 DEPARTMENT OF PUBLIC WORKS

APPROVED BY	DATE
OFFICE ENGINEER	1-15-71
PARK DEPARTMENT	1-15-71
TRAFFIC DIVISION	1-15-71
ASSISTANT CITY ENG.	1-15-71

APPROVED BY: *[Signature]*  
 DIRECTOR OF PUBLIC WORKS

**STREET PLAN AND PROFILE**  
 ORDWAY STREET  
 ASSESSMENT DISTRICT

HORIZ. SCALE: 1" = 20'  
 VERT. SCALE: 1" = 4'

**PROJECT NO.**  
 R-1432

**SHEET** 1 **OF** 2

**FILE NO.** 70-49

820LT.

820C

820RT.

LT. 800

C 800

RT. 800

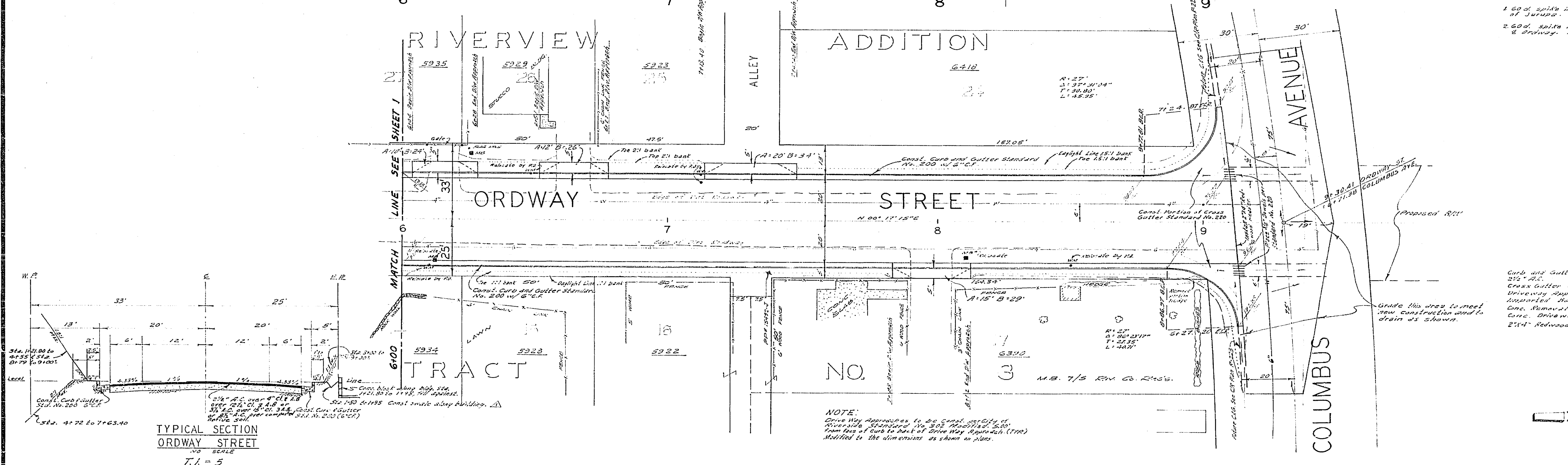
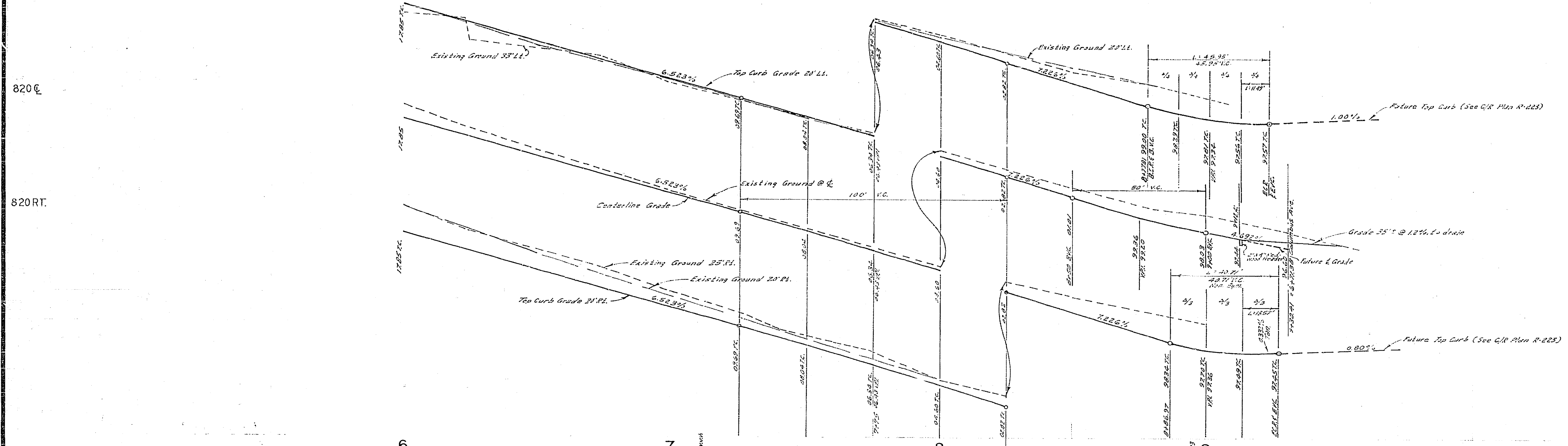

**BENCH MARKS**  
 1.60 d. spike in pole # 2206, 25' W. of Fremont, S.W. of Jurupa. ELEV 797.529 C.M. #B. 630/52.  
 2.60 d. spike in pole # 7202 J. S.W. side of Jurupa opp. E. driveway. ELEV. 815.501 C.M. #B. 630/52.

**QUANTITY ESTIMATE**

Curb and Gutter Standard No. 220 (5'x7')	1,608	L.F.
24" x 48"	28,452	S.F.
Cross Gutter Standard No. 220	395	S.F.
Driveway Approximate Standard No. 302 (Modified)	1,495	S.F.
Asphalt Pave - Residential	628	S.F.
Curb Removal	767	S.F.
Curb, Driveway (6")	923	S.F.
2"x4" Redwood Header	36	L.F.

**NOTE:**  
 Drive Way Approaches to be same capacity of  
 "Miscellaneous Standard" No. 302 (Modified) 24" x  
 48" from face of curb to back of Drive Way Approach (DWA)  
 Modified to the dimensions as shown on plans.

**TYPICAL SECTION**  
 ORDWAY STREET  
 NO SCALE  
 V.V. = 5

<b>ALBERT A. WEBB ASSOCIATES</b> CIVIL ENGINEERS RIVERSIDE, CALIFORNIA APPROVED BY <u>[Signature]</u> DATE <u>4/14/10</u> R.E. NO. <u>2972</u>	CHANGED QUANTITIES DUE TO DETAILING AT INTERSECTION WITH DRIVEWAY APPROACH ALL	<b>CITY OF RIVERSIDE, CALIFORNIA</b> DEPARTMENT OF PUBLIC WORKS		<b>STREET PLAN AND PROFILE</b> ORDWAY STREET ASSESSMENT DISTRICT	<b>PROJECT NO.</b> <u>R-1432</u> <b>SHEET</b> <u>2</u> <b>OF</b> <u>2</u> <b>FILE NO.</b> <u>70-49</u>
		APPROVED BY <u>[Signature]</u> DATE <u>1/16/11</u> TRAFFIC DIVISION ASSISTANT CITY ENG.	APPROVED BY <u>[Signature]</u> DATE <u>1/16/11</u> DIRECTOR OF PUBLIC WORKS		
W.C. 70-49 FOR CITY OF RIVERSIDE K.B. 10/11 DESIGNED BY <u>REL</u> DRAWN BY <u>REL</u> CHECKED BY <u>[Signature]</u>		DATE <u>8/5/10</u>		HORIZ. SCALE: 1" = 20' VERT. SCALE: 1" = 4'	