

830  
828  
826  
832  
830  
828

830  
828  
826  
832  
830  
828

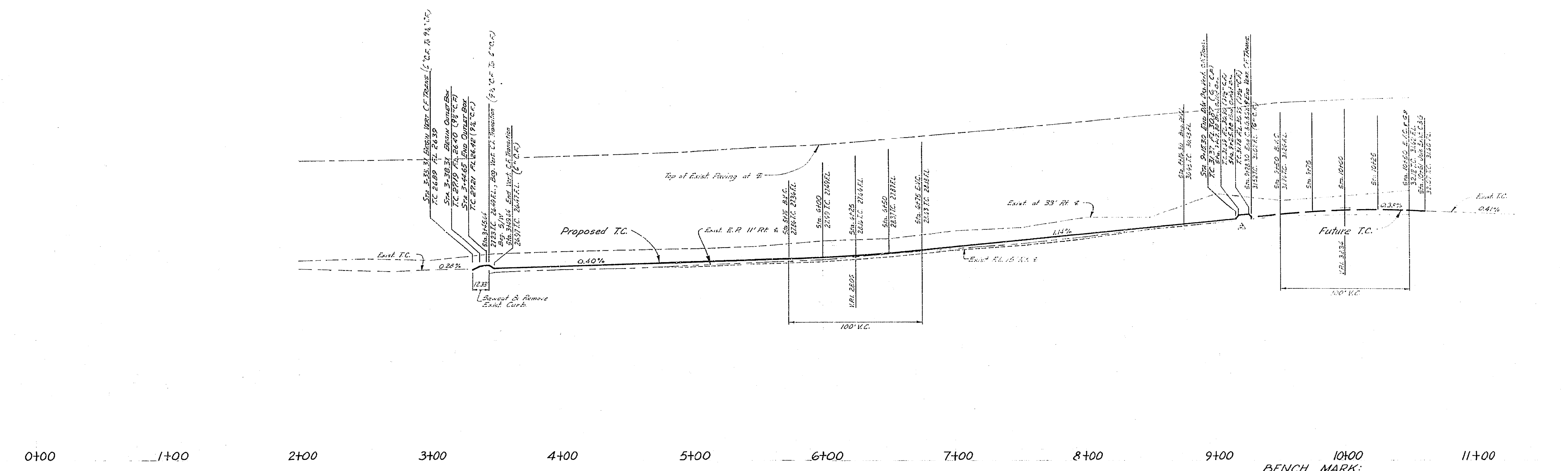

**BENCH MARK:**  
P.N. Nail in curb return S.W. Corner of Columbia Avenue and Orange Street (City of Riverside T.B. 229/48) Elev. 827.37

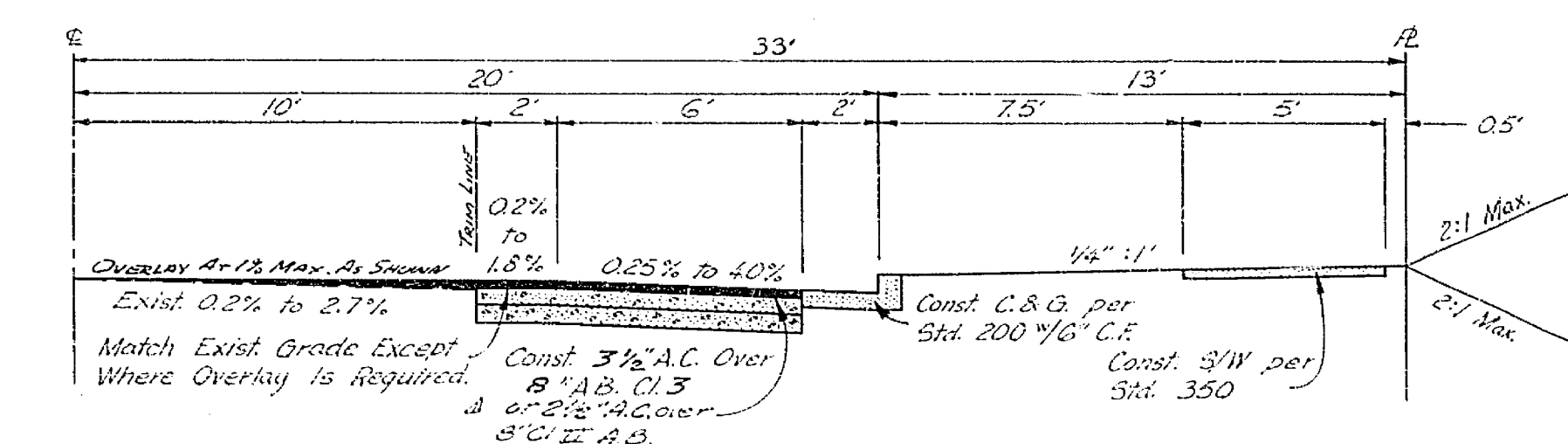
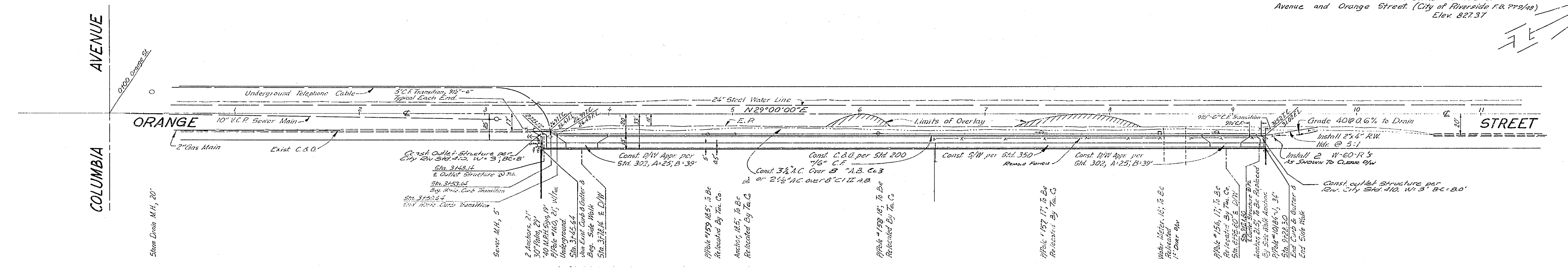

**-CAUTION- PACIFIC TELEPHONE CABLES UNDERGROUND BEFORE EXCAVATING**  
CALL COLLECT: 9:30 A.M. to 5 P.M. After Hours & Holidays  
Orange County: 714-633-0811, 714-547-6800  
Riverside County: 714-684-0871, 714-547-6808  
Inyo County: 714-684-0071, 714-547-6808  
San Bernardino County: 714-484-0071, 714-547-6808  
Los Angeles County: 213-621-3112, 24 HOUR SERVICE  
Ventura County: 213-621-3112, 24 HOUR SERVICE  
San Diego County: 714-298-2576, 714-232-8027

- GENERAL NOTES**
- It shall be the responsibility of the contractor to clear the right of way in accordance with the provisions of law as it affects such utility including irrigation lines and appurtenances and at no cost to the City.
  - Construction shall be in accordance with the City of Riverside, Department of Public Works, Specifications No. 461 and Standard Drawings.
  - Prime coat, seal coat, and paint binder are required.
  - Trim edge of existing paving to clean, straight line. Construct match-up paving as shown, and overlay existing paving as directed in the field to produce a smooth crown section. Engineer estimates the overlay to be approximately 3 tons.
  - Pavement shall not be placed until the sewer as shown on S-797 is constructed.

|  |  |  |  |  |
|--|--|--|--|--|
| <b>J. F. DAVIDSON ASSOCIATES</b><br>CIVIL ENGINEERS - SURVEYORS - PLANNERS<br>RIVERSIDE, CALIFORNIA<br>APPROVED BY: <i>[Signature]</i> DATE: 5-14-70<br>R.E. No. 13614<br>W.O. 2553 FOR Henrich & Sproul F.B. 1005 |  | <b>CITY OF RIVERSIDE, CALIFORNIA</b><br>DEPARTMENT OF PUBLIC WORKS<br>APPROVED BY: <i>[Signature]</i> DATE: 5-14-70<br>DIRECTOR OF PUBLIC WORKS<br>DESIGNED BY: AW DRAWN BY: MKC CHECKED BY: ZLL |  | <b>STREET PLAN &amp; PROFILE</b><br><b>ORANGE STREET</b><br>345.64' NLY TO 928.30' NLY<br>OF COLUMBIA AVENUE.<br>C-29-690, PM-4<br>HORIZ. SCALE: 1" = 40' VERT. SCALE: 1" = 4'<br>PROJECT NO. <b>R-1436</b><br>SHEET 1 OF 1<br>FILE NO. 3389 |
|--|--|--|--|--|