

69  
68  
67  
  
69  
68  
67

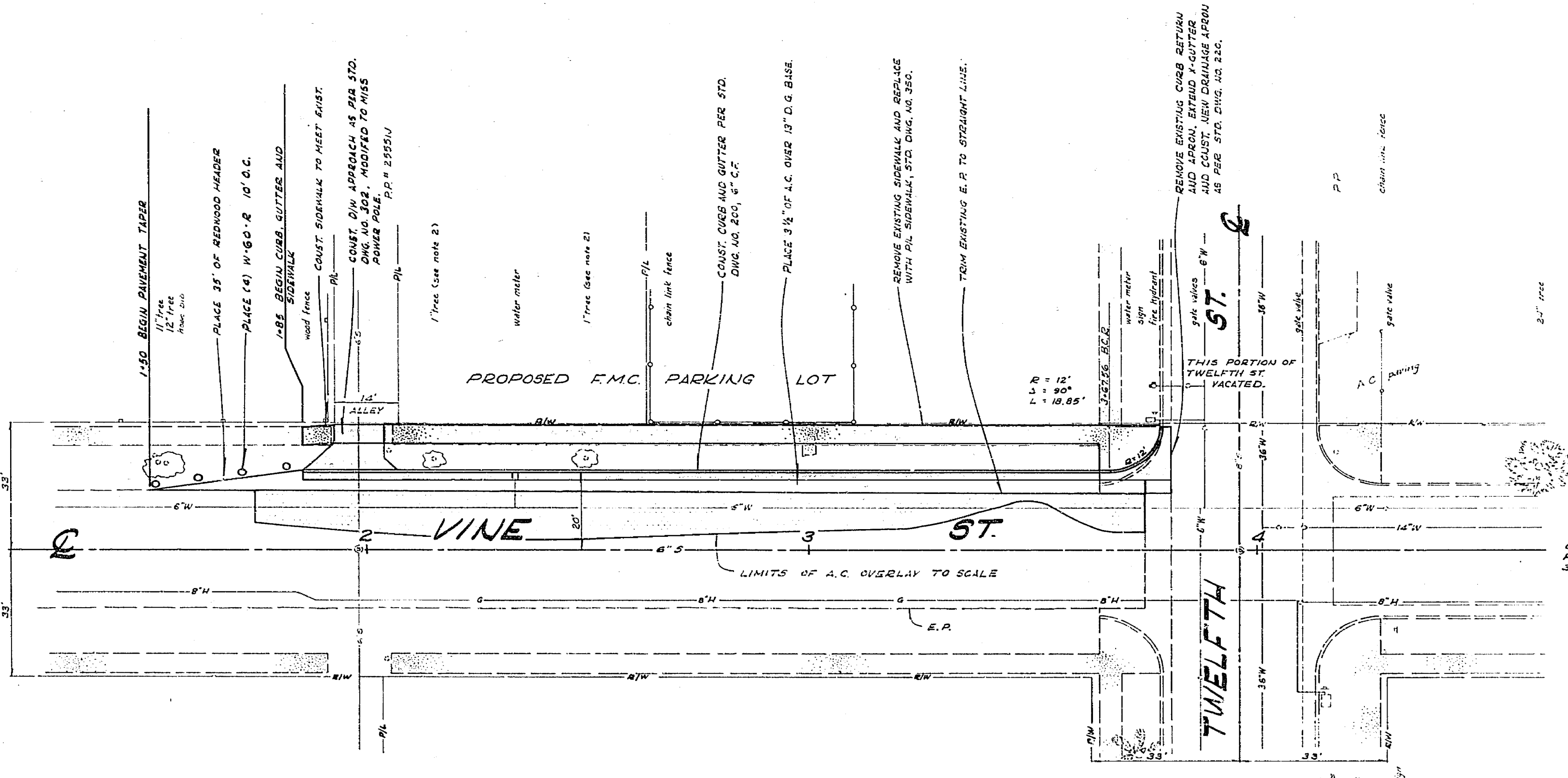

- NOTES**
- CONSTRUCTION SHALL BE IN ACCORDANCE WITH STANDARD SPECIFICATIONS OF PUBLIC WORKS (CONSTRUCTION, 1970 EDITION) AND WITH CITY STANDARD DRAWINGS.
  - RIVERSIDE PARKS AND RECREATION DEPT. WILL REMOVE 2 TREES. CONTRACTOR SHALL NOTIFY MR. DAVENPORT 48 HOURS PRIOR TO CONSTRUCTION. CALL 787-7810.

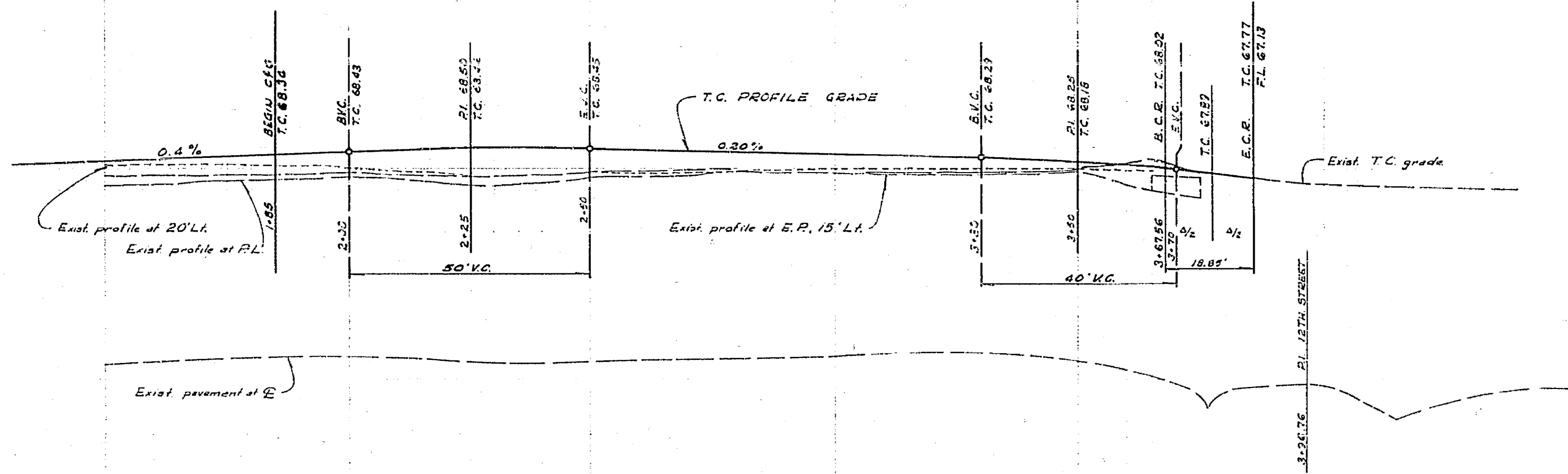
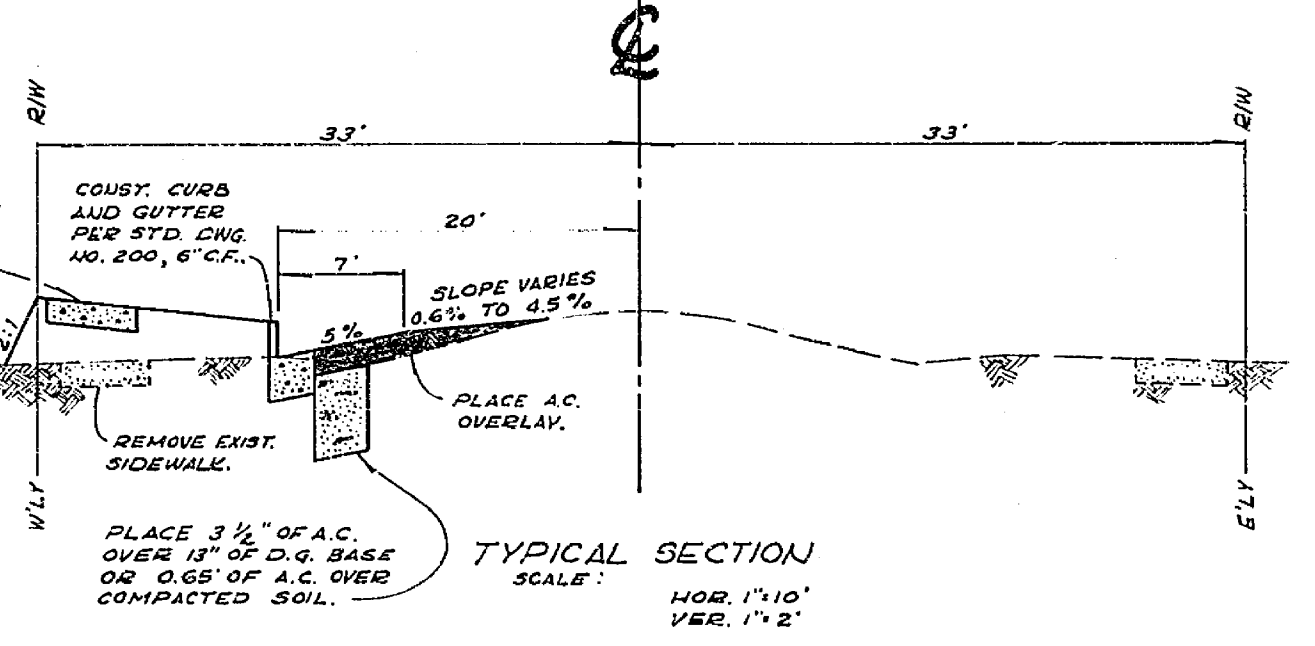
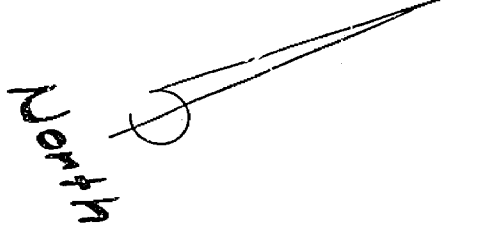

F.B. 948/37-39  
B.M.: Steel pin in N. curb of  
13th st., 57' E. of Vine.  
ELEV. 867.39

CITY OF RIVERSIDE, CALIFORNIA DEPARTMENT OF PUBLIC WORKS		<b>VINE STREET          CURB &amp; GUTTER          TWELFTH ST. TO 190' 5" L.V.</b>		PROJECT NO. 30-578-209-30 <b>R-1472</b>
DESIGNED BY <i>HULL</i> DRAWN BY <i>Karl</i> CHECKED BY	APPROVED BY <i>[Signature]</i> DIRECTOR OF PUBLIC WORKS	DATE <i>3-8-71</i>	HORIZ. SCALE: 1" = 20' VERT. SCALE: 1" = 2'	SHEET <i>1</i> OF <i>1</i> FILE NO.