

1040 Lt.

1040-2

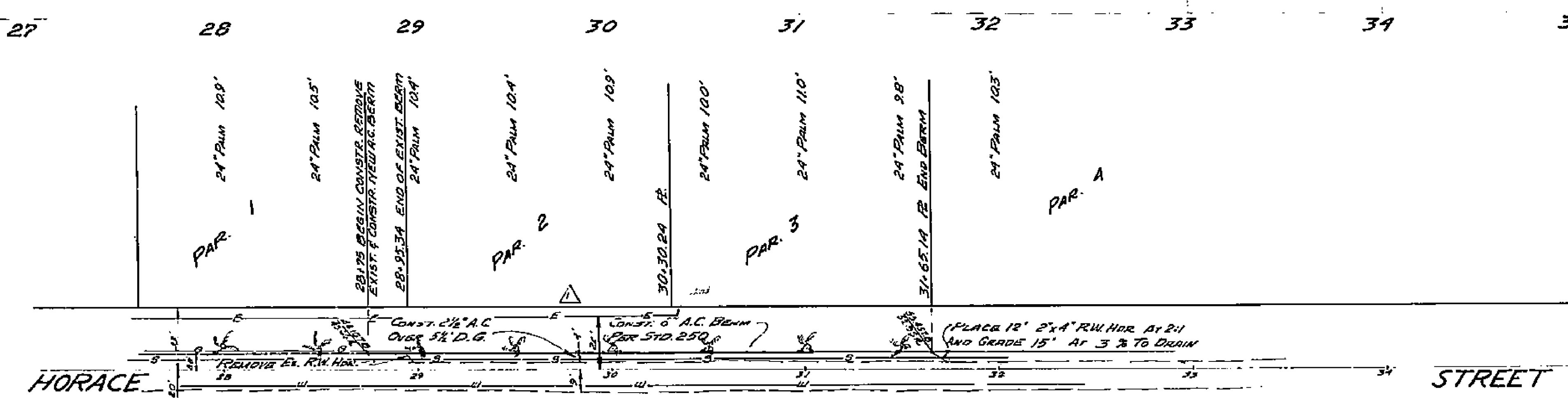
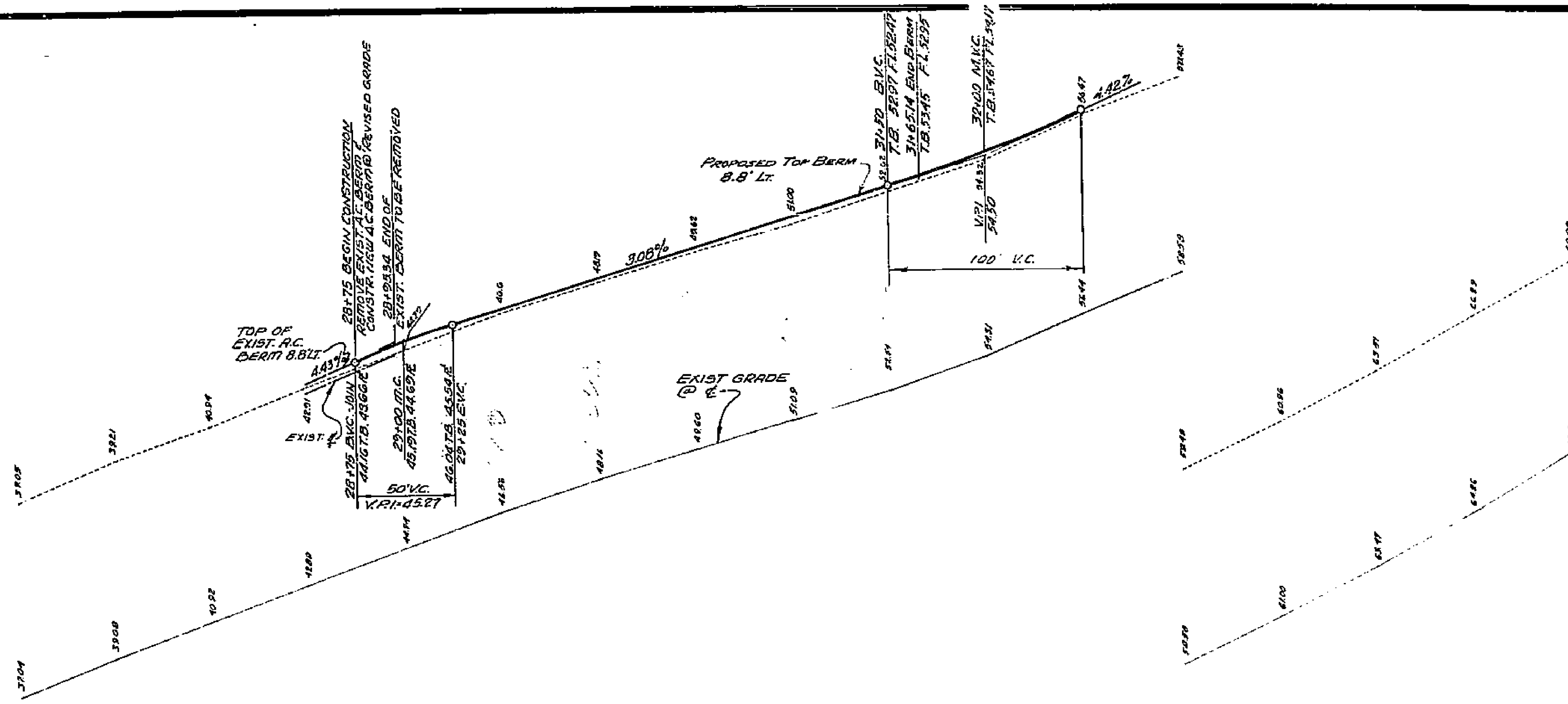

B.M. RIM OF CURVED MAN AT INTER HORACE & VICTORIA FOR '96 DWG. R-227 ELEV. 973.69
 T.B.M. 5 FT. IN LEAD ON ROCK AT S.W. COR. OF HORACE & HAWARDEN DR. J.F.D. FB. 834-10 ELEV. 1074.09

35'-26'-02" INT.
 HAWARDEN DRIVE

GENERAL NOTES:
 1. ALL CONSTRUCTION SHALL BE IN ACCORDANCE WITH THE STANDARD SPECIFICATIONS FOR PUBLIC WORKS CONSTRUCTION 1970 EDITION AND STANDARD DRAWINGS CITY OF RIVERSIDE DEPARTMENT OF PUBLIC WORKS.

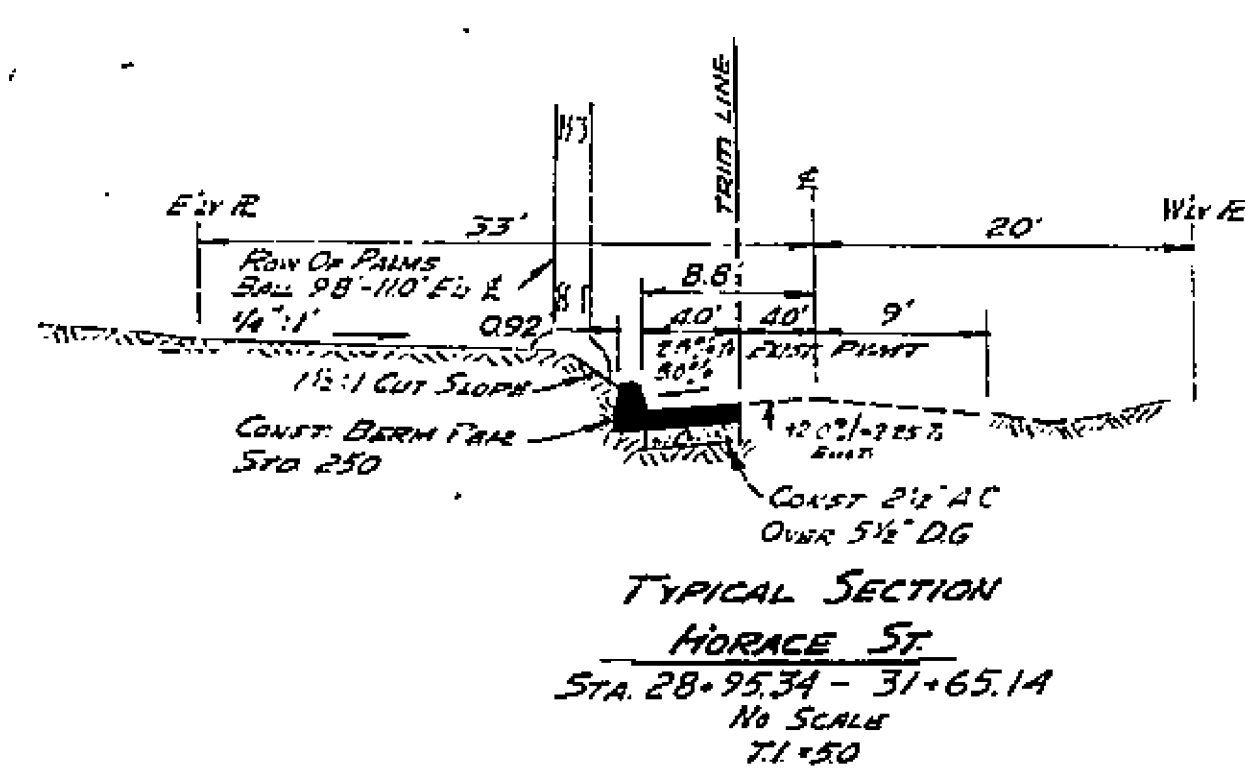

TYPICAL SECTION
 HORACE ST.
 STA. 28+95.34 - 31+65.14
 NO SCALE
 7/1/50

J. F. DAVIDSON ASSOCIATES
 CIVIL ENGINEERS - SURVEYORS - PLANNERS
 RIVERSIDE, CALIFORNIA
 APPROVED BY: *Robert Davidson* DATE 3-27-71
 R.E. NO. 1362A

MARK	REVISIONS	APP. DATE

DESIGNED BY: *A.W.* DRAWN BY: *A.W.* CHECKED BY: *BB*

CITY OF RIVERSIDE, CALIFORNIA
 DEPARTMENT OF PUBLIC WORKS

APPROVED BY	BY	DATE
OFFICE ENGINEER		
PARK DEPARTMENT		
TRAFFIC DIVISION		
ASSISTANT CITY ENGR.		

DATE: 3-27-71

STREET PLAN & PROFILE
 HORACE STREET
 EAST SIDE
 500' - 600' N'LY HAWARDEN
 P.M. 21

PROJECT NO.
R-1487
 SHEET 1 OF 1
 FILE NO. 4402

HORIZ. SCALE: 1" = 40' VERT. SCALE: 1" = 4'