

E.M. - R.R. Spike in plan type of M. Corcoran of Indiana Ave. & Myers St. - Ref. 9462

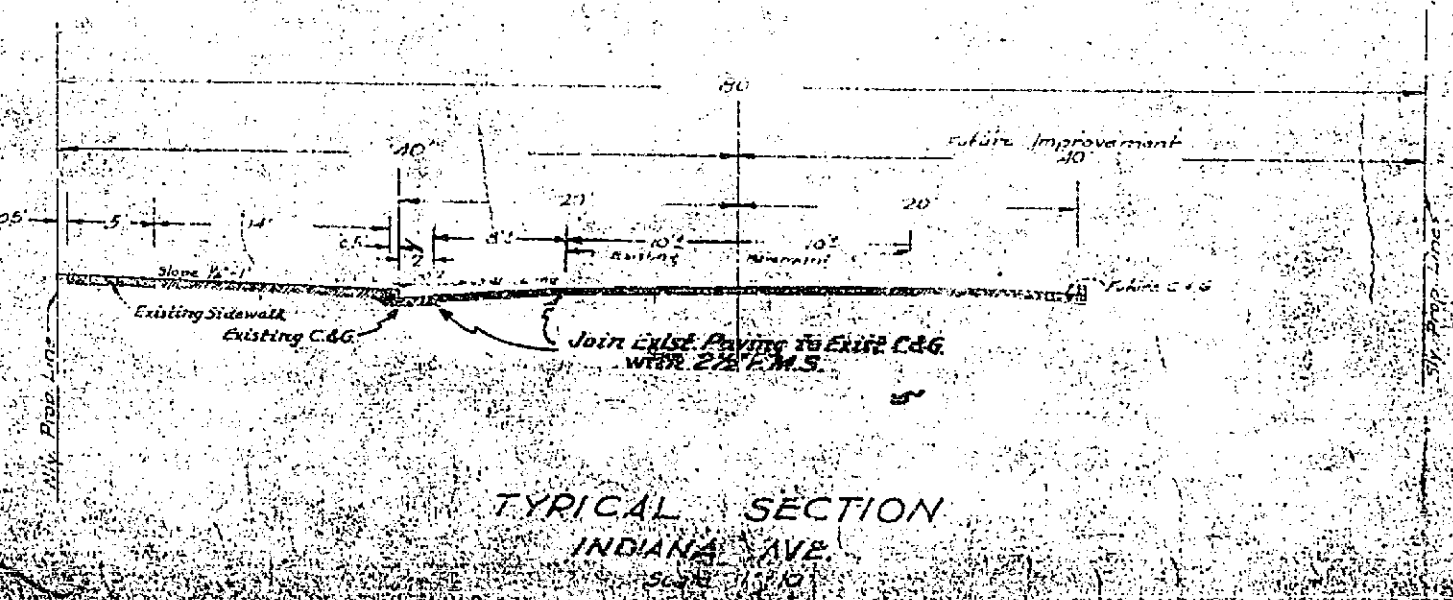

Typical Section
INDIANA AVE.

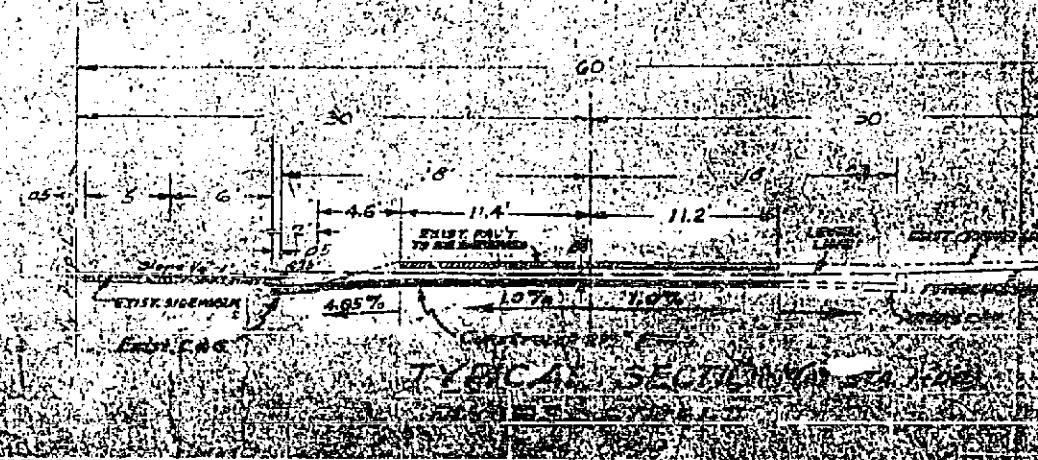

REVISIONS	
MARK	DATE

CITY OF RIVERSIDE, CALIF.
DEPARTMENT OF PUBLIC WORKS
MARGA-JANE DAVIS
INDIANA AVENUE
IN CONNECTION WITH
WALKWAY PROJECT

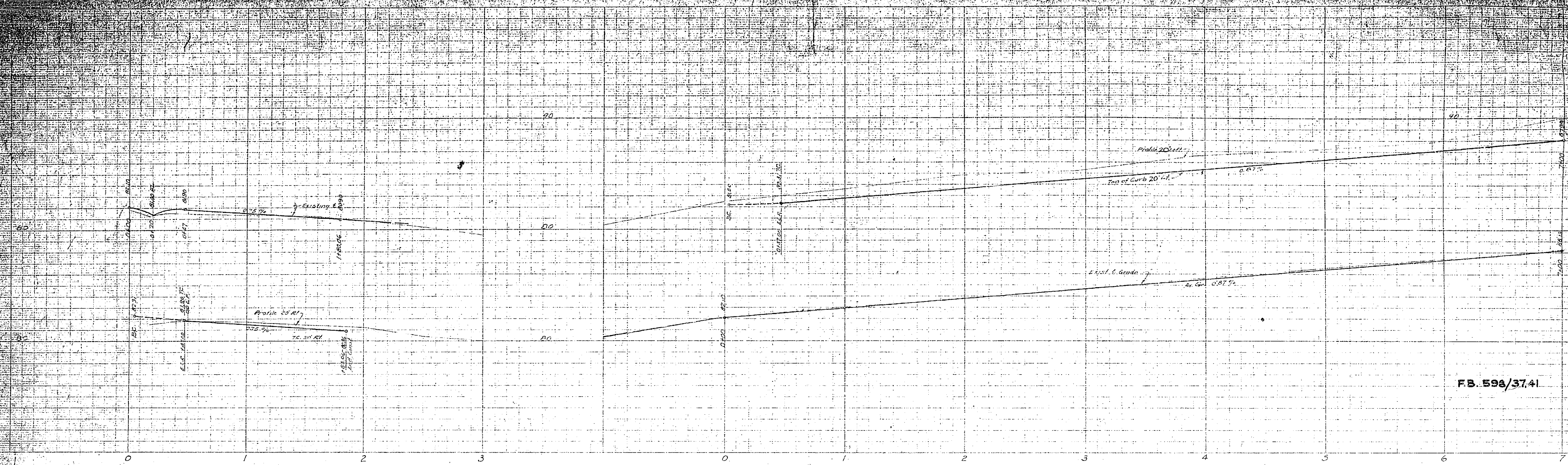

FB. 598/37.41

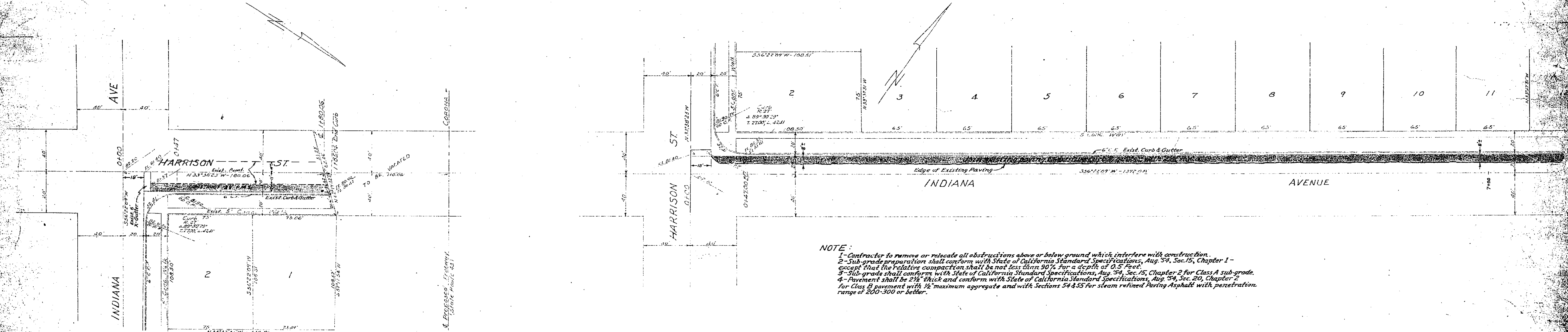

NOTE:
 1- Contractor to remove or relocate all obstructions above or below ground which interfere with construction.
 2- Sub-grade preparation shall conform with State of California Standard Specifications, Aug. 34, Sec. 15, Chapter 1 - except that the relative compaction shall be not less than 90% for a depth of 0.5 Feet.
 3- Sub-grade shall conform with State of California Standard Specifications, Aug. 34, Sec. 15, Chapter 2 for Class A sub-grade.
 4- Pavement shall be 2 1/2" thick and conform with State of California Standard Specifications, Aug. 34, Sec. 20, Chapter 2 for Class B pavement with 1/2" maximum aggregate and with Sections 54.4.55 for steam refined Paving Asphalt with penetration range of 200-300 or better.

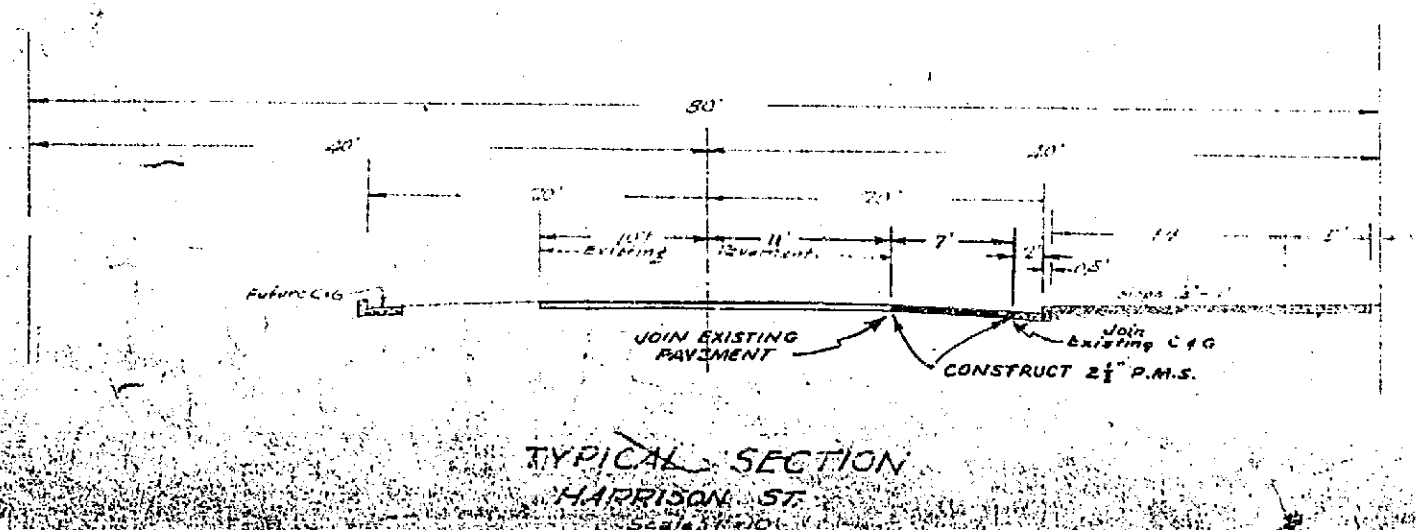

REVISIONS		
MARK	DATE	DESCRIPTION

CITY OF RIVERSIDE, CALIFORNIA
 DEPARTMENT OF PUBLIC WORKS

MATCH-UP PAVING
 INDIANA AVENUE & HARRISON STREET
 in conjunction with
WALNUTWOOD

Orig. Scale - 1" = 40'

DESIGNED BY H.B.	CHECKED BY W.D.G.
DRAWN BY H.B.	APPROVED BY <i>[Signature]</i>
RECOMMENDED BY <i>[Signature]</i>	DATE <i>[Date]</i>