

PLAN AND PROFILE
MATCH-UP PAVING
FROM CALIFORNIA AVE.
5' LY 435.60'
ON EAST SIDE OF
VAN BUREN BLVD.

CITY OF RIVERSIDE - CALIFORNIA
F.B. 611/1, 598/39
SCALES
HORIZ 1" = 50'
VERT 1" = 5'
Designed H.B.
Drawn H.B.
Checked W.D.G.
Recommended

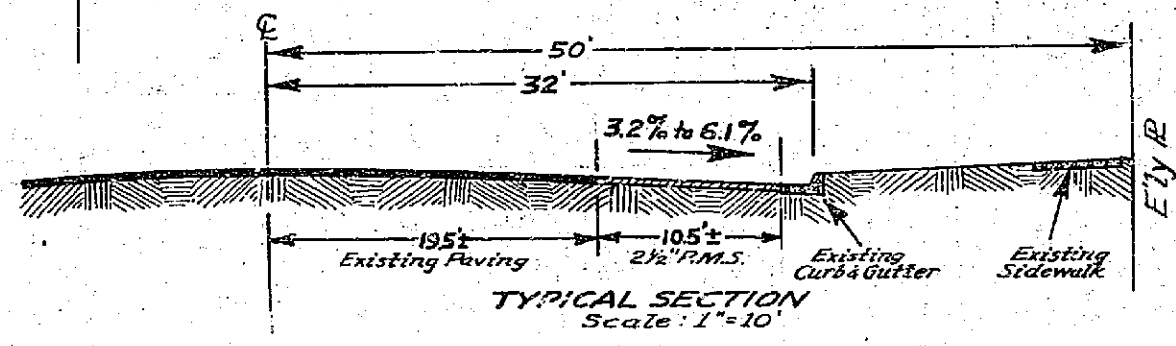
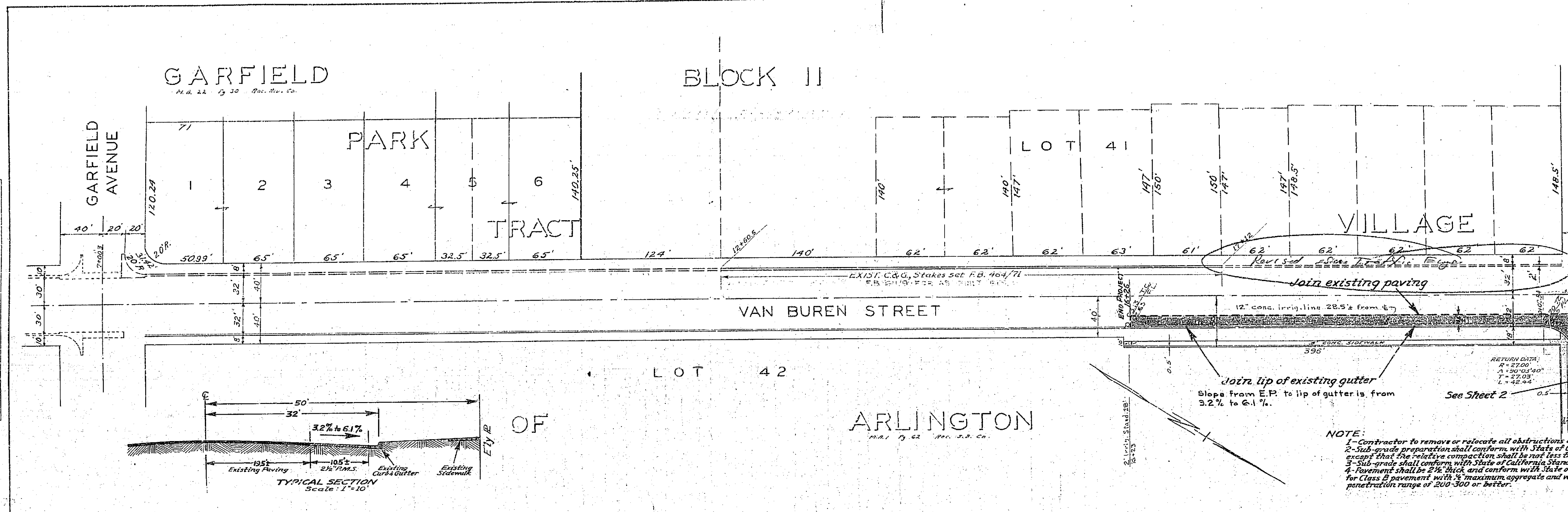

NOTE:
 1- Contractor to remove or relocate all obstructions above or below ground which interfere with construction.
 2- Sub-grade preparation shall conform with State of California Standard Specifications, Aug. 54, Sec. 15, Chapter 1 except that the relative compaction shall be not less than 90% for a depth of 0.5 feet.
 3- Sub-grade shall conform with State of California Standard Specifications, Aug. 54, Sec. 15, Chapter 2 for Class A sub-grade.
 4- Pavement shall be 2" thick and conform with State of California Standard Specifications, Aug. 54, Sec. 20, Chapter 2 for Class B pavement with 1/2" maximum aggregate and with Sections 54 & 55 for Steam-released Paving Asphalt with penetration range of 200-300 or better.

APPROVED: _____
CITY ENGINEER
DATE: _____

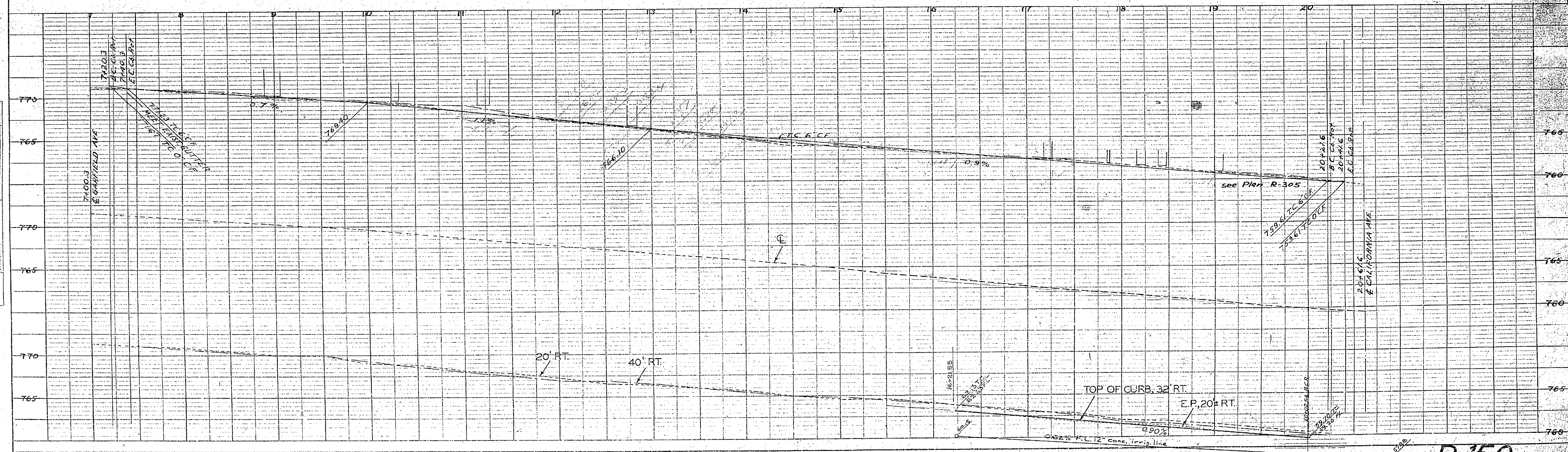

PLATE 1 - PLAN & PROFILE OF R.R. & F. STANDARD
 REG. U.S. PAT. & TRADE-MARK OFFICE
 K & E CO. INC. 348-10

R-150

DATE	
BY	
DESIGNED	
PLOTTED	
NOTE BOOK	
FILE NO.	
NO.	

DATE	
BY	
DESIGNED	
PLOTTED	
NOTE BOOK	
FILE NO.	
NO.	

SCALE: 1" = 100'

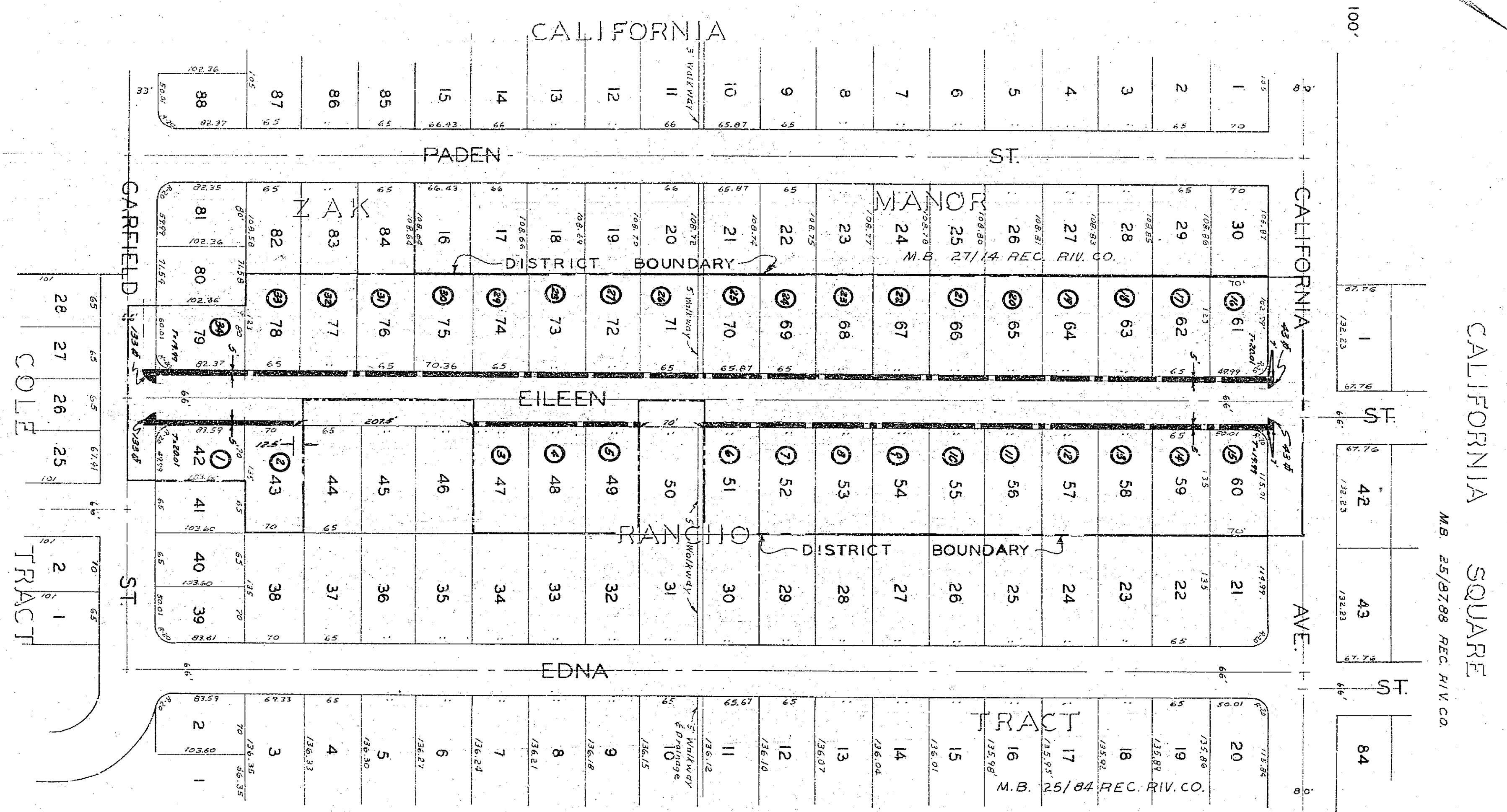

Note:
All existing sidewalk is 3' in length except
where otherwise indicated.

DIAGRAM
OF THE PROPERTY AFFECTED OR BENEFITED
BY THE WORK IN THE
EILEEN STREET SIDEWALK IMPROVEMENT DISTRICT

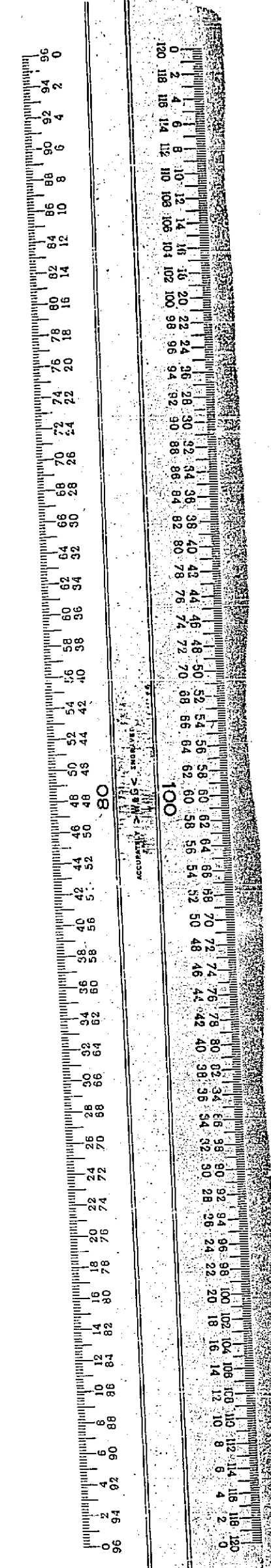

CITY OF RIVERSIDE CALIFORNIA
DEPARTMENT OF PUBLIC WORKS

EILEEN STREET
SIDEWALK IMPROVEMENT
DISTRICT

APPROVED BY
[Signature]
DIRECTOR OF PUBLIC WORKS

DATE: Oct 20 1957

R-151-B
SHEET 1 OF 1

M.B. 27/25 REC. RIV. CO.

M.B. 25/8798 REC. RIV. CO.

M.B. 25/84 REC. RIV. CO.

MANOR

RANCHO

CALIFORNIA

EILEEN

EDNA

PADEN ST.

CALIFORNIA AVE.

CARFIELD ST.

COLE TRACT

DISTRICT BOUNDARY

DISTRICT BOUNDARY

TRACT

- 1 2
- 3 4
- 5 6
- 7 8
- 9 10
- 11 12
- 13 14
- 15 16
- 17 18
- 19 20
- 21 22
- 23 24
- 25 26
- 27 28
- 29 30
- 31 32
- 33 34
- 35 36
- 37 38
- 39 40
- 41 42
- 43 44
- 45 46
- 47 48
- 49 50
- 51 52
- 53 54
- 55 56
- 57 58
- 59 60
- 61 62
- 63 64
- 65 66
- 67 68
- 69 70
- 71 72
- 73 74
- 75 76
- 77 78
- 79 80
- 81 82
- 83 84
- 85 86
- 87 88