

SCALE: 1" = 100'

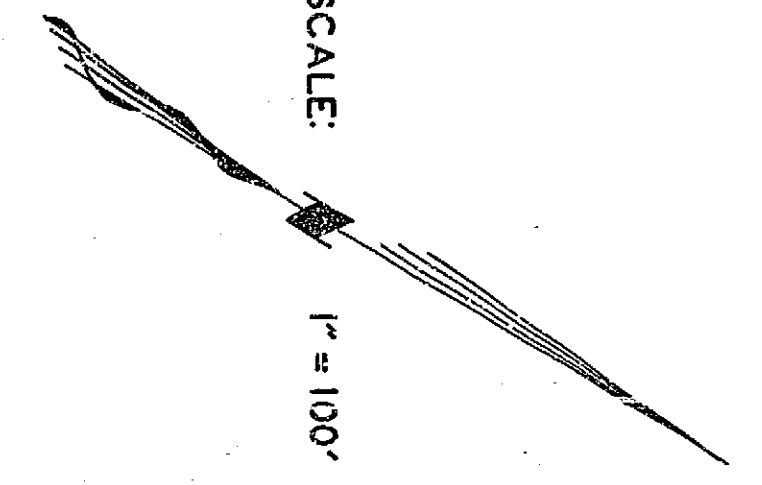

CALIFORNIA SQUARE
M.B. 25/8708 REC. RIV. CO.

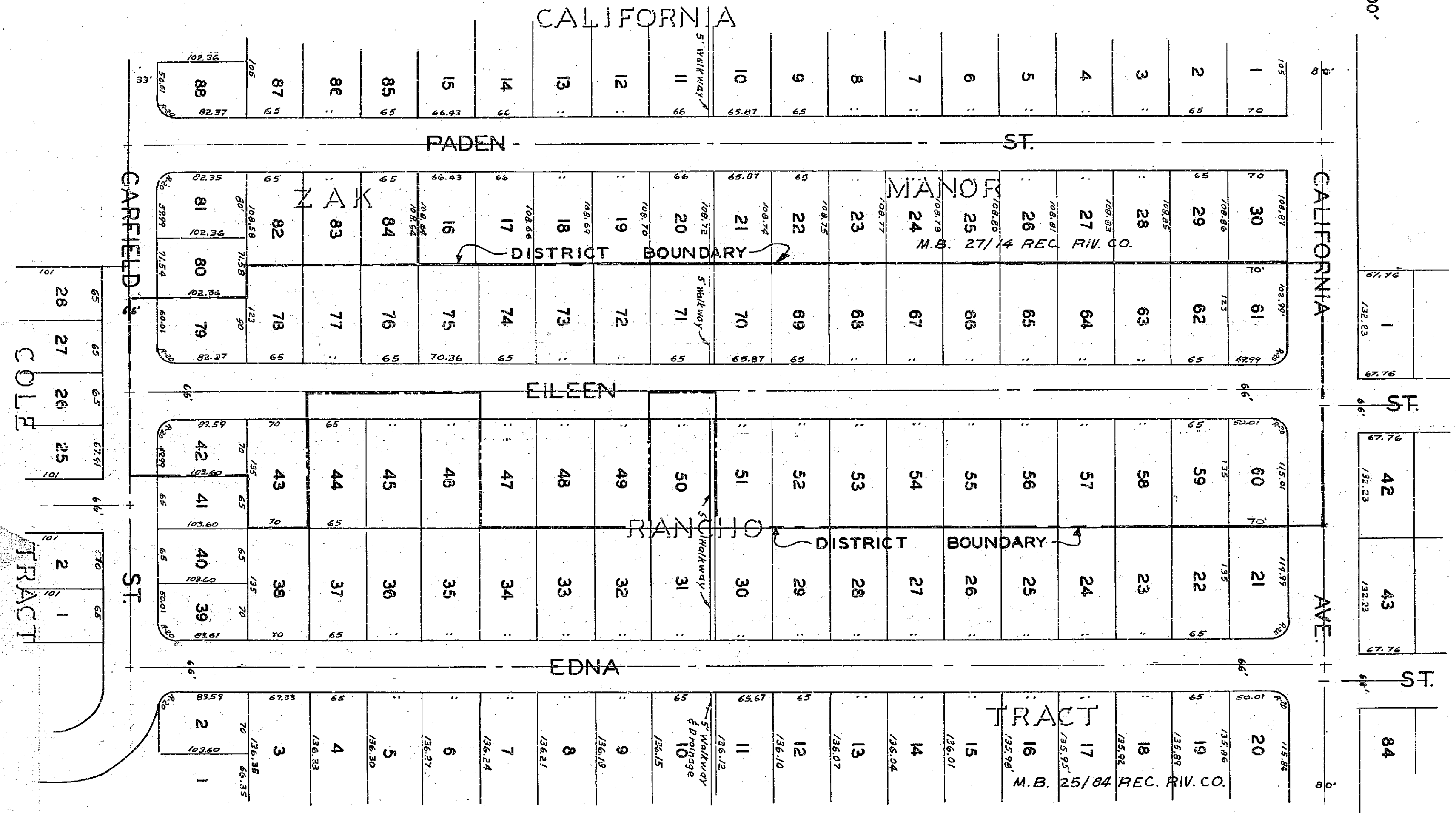

1	2	3	4	5	6	7	8	9	10	11	12	13	14	15	16	17	18	19	20	21	22	23	24	25	26	27	28	29	30	31	32	33	34	35	36	37	38	39	40	41	42	43	44	45	46	47	48	49	50	51	52	53	54	55	56	57	58	59	60	61	62	63	64	65	66	67	68	69	70	71	72	73	74	75	76	77	78	79	80	81	82	83	84	85	86	87	88
---	---	---	---	---	---	---	---	---	----	----	----	----	----	----	----	----	----	----	----	----	----	----	----	----	----	----	----	----	----	----	----	----	----	----	----	----	----	----	----	----	----	----	----	----	----	----	----	----	----	----	----	----	----	----	----	----	----	----	----	----	----	----	----	----	----	----	----	----	----	----	----	----	----	----	----	----	----	----	----	----	----	----	----	----	----	----	----

MAP SHOWING THE LANDS INCLUDED WITHIN THE ASSESSMENT DISTRICT TO BE BENEFITED BY THE CONSTRUCTION OF SIDEWALKS.

REVISIONS		CITY OF RIVERSIDE CALIFORNIA DEPARTMENT OF PUBLIC WORKS	
MARK	DATE	DESCRIPTION	
		EILEEN STREET SIDEWALK IMPROVEMENT DISTRICT	

DESIGNED BY: G.L.
DRAWN BY: G.L.
CHECKED BY: W.S. 3-11-51
RECOMMENDED BY: ASSISTANT CITY ENGINEER

APPROVED BY: [Signature]
DIRECTOR OF PUBLIC WORKS
DATE: 4-20-1957
SHEET 7 OF 7

