

BENCH MARK:
 2x4 Nail in Northwest Corner
 La Sierra Avenue & Collett Avenue
 at Flood Control Channel
 E.L. 68.20 (Control E.L. 704/12
 Elev. 701.61)

- GENERAL NOTES:**
1. It shall be the responsibility of the contractor to clear the right of way in accordance with the provisions of the law as it affects each utility, including irrigation lines and appurtenances and at no cost to the city.
 2. Construction shall be in accordance with Standard Specifications for Public Works Construction, 1970 edition and City of Riverside Standard Drawings.
 3. All flagged elevations shall be staked in the field by the Engineer.
 4. The contractor shall arrange for a 200' feet wide strip by a 200' strip of the street to be prepared to rough grade. Drains and base materials shall be submitted by City of Riverside Design Standards and Specifications.
 5. All traffic signs shall be installed prior to opening the streets to traffic.
 6. The engineer estimates the A.C. Overlay to be 22' wide.

STREET NAME SIGN SCHEDULE

①	WHITFORD AVE	11000
②	MINIER AVE	4600
③	LA SIERRA AVE	4600
④	MINIER AVE	4600

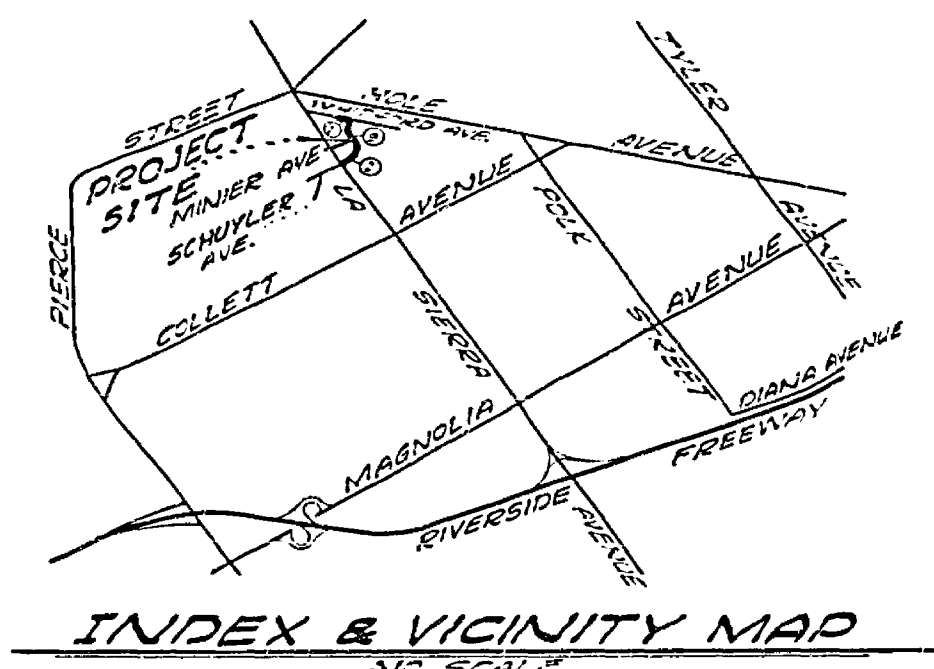

NOTICE TO CONTRACTOR
 The existence and location of any underground utility lines or other features shown on these plans are obtained by a search of the records of the City of Riverside. It is the responsibility of the contractor to locate and protect all existing utilities except as shown on these plans.
 The Contractor is required to take such precautionary measures to protect the utility lines shown and any other lines not of record or not shown on these plans.

SEE SHEET NO. 2 OF 3 FOR
 PLAN AND PROFILE
 FROM MINIER AVE. TO 200' W/LY
 C-13-701 & P.M. 18

ALBERT A. WEBB ASSOCIATES CIVIL ENGINEERS RIVERSIDE, CALIFORNIA		CITY OF RIVERSIDE, CALIFORNIA PUBLIC WORKS DEPARTMENT		ACCOUNT NO. R-1526
APPROVED BY: <i>[Signature]</i> DATE: 5-29-72 R.E. No. 15055		APPROVED BY: <i>[Signature]</i> DATE: 5-29-72 CHIEF PUBLIC WORKS ENGINEER		DRAWING NUMBER R-1526
DESIGNED BY: <i>[Signature]</i> DRAWN BY: <i>[Signature]</i> CHECKED BY: <i>[Signature]</i>		DATE: 5-29-72		SHEET: 1 OF 3
W.O. 88-323 FOR LA SIERRA & MINIER AVENUES FEB. 10, 1978		SCALE: Horiz. 1"=20' Vert. 1"=4'		INC. 68-323-A

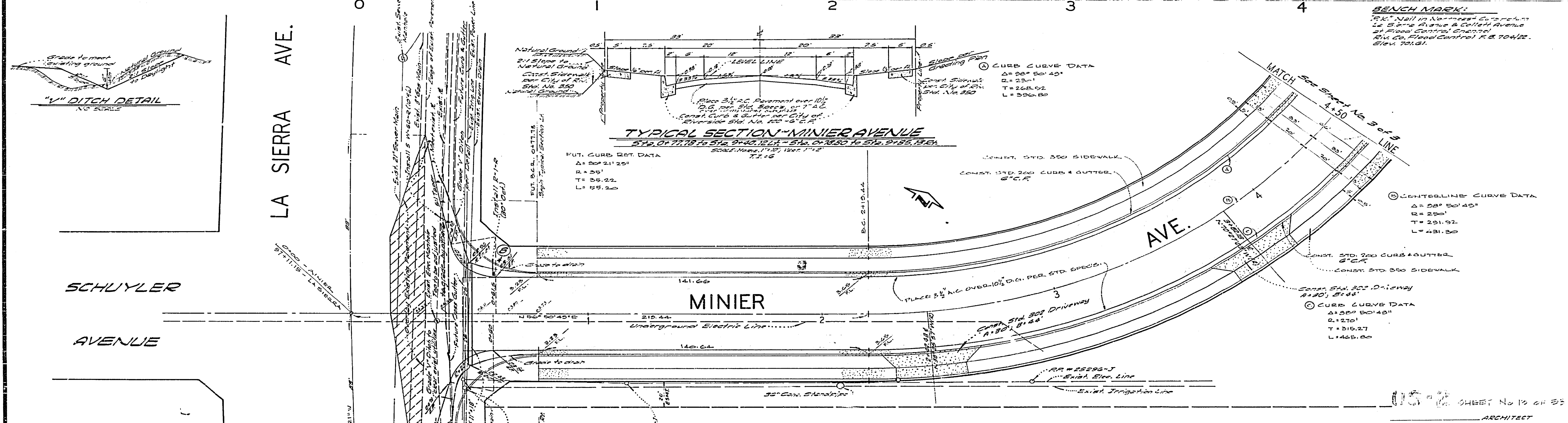
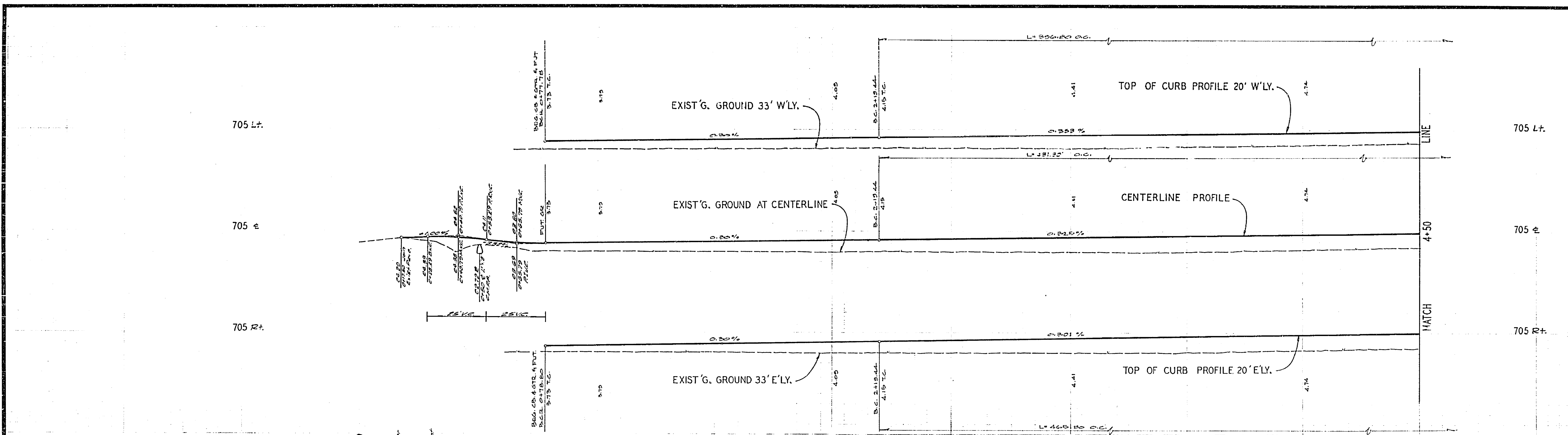

NOTE TO CONTRACTOR
 The existence and location of any underground utility pipes or structures shown on these plans are obtained by a search of the available records. To the best of our knowledge, there are no existing utilities except as shown on these plans.
 The Contractor is required to take the precautionary measures to protect the utility lines shown and any other lines not of record or not shown on these plans.

FUT. CURB DET. DATA
 $\Delta = 90^{\circ} 49' 10''$
 $R = 55'$
 $T = 55.46'$
 $L = 55.46'$

ALBERT A. WEBB ASSOCIATES
 CIVIL ENGINEERS
 RIVERSIDE, CALIFORNIA
 APPROVED BY: *[Signature]* DATE: 7-26-71
 R.E. No. 12002

MARK	REVISIONS	APP.	DATE

CITY OF RIVERSIDE, CALIFORNIA
 PUBLIC WORKS DEPARTMENT
 APPROVED BY: *[Signature]* DATE: 5-30-72
 DIRECTOR OF PUBLIC WORKS

STREET PLAN AND PROFILE
MINIER AVENUE
 LA SIERRA AVE. TO WHITFORD AVE.
 C-B-701 & P.M. 18

ACCOUNT No. **R-1526**
 DRAWING NUMBER
 SHEET 2 OF 3
 I.C. 68-323-A

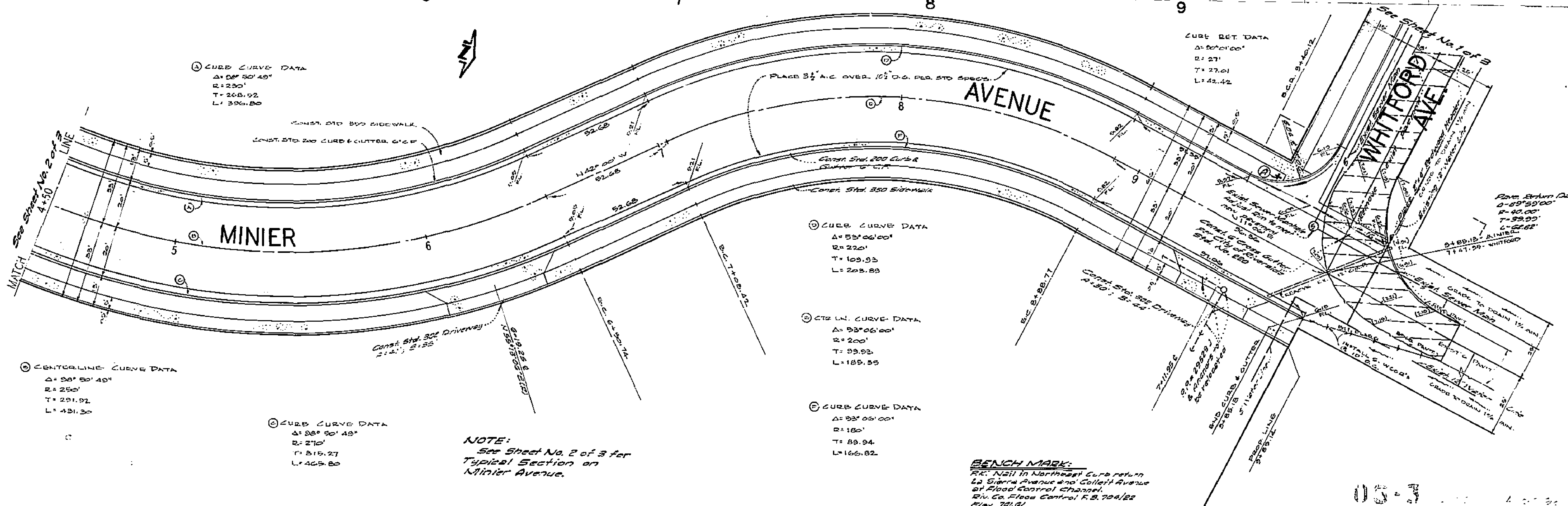
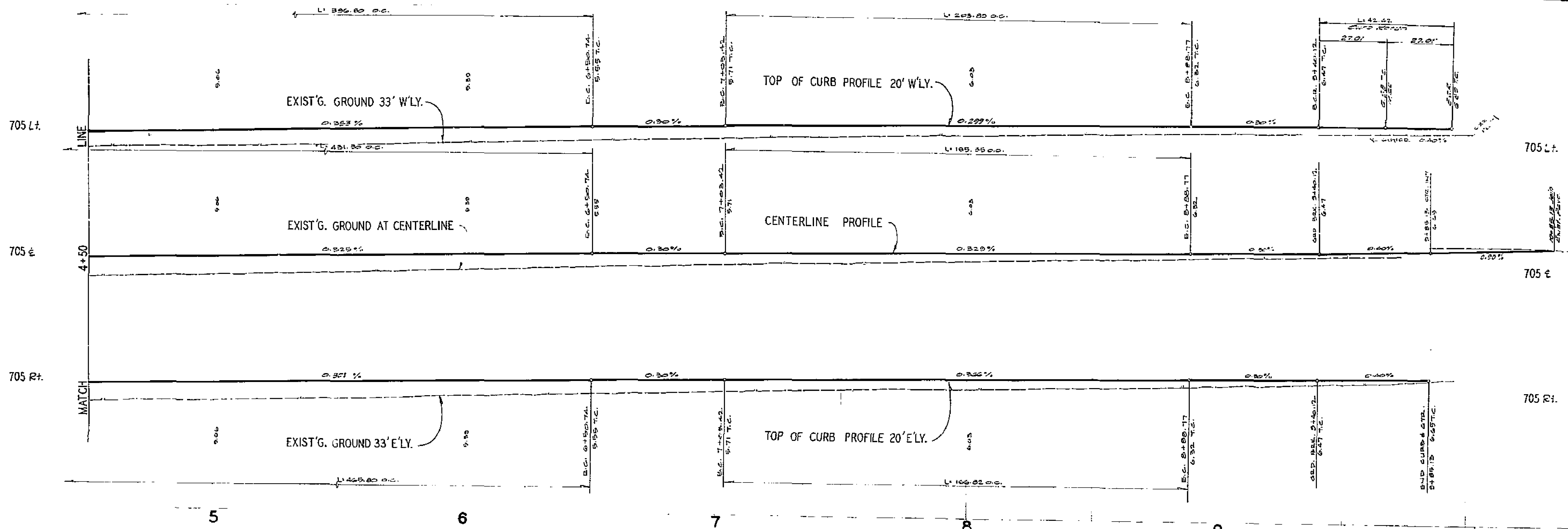

ⓐ CURB CURVE DATA
 $\Delta = 88^\circ 50' 49''$
 $R = 230'$
 $T = 268.92$
 $L = 396.80$

ⓑ CURB CURVE DATA
 $\Delta = 53^\circ 06' 00''$
 $R = 220'$
 $T = 109.93$
 $L = 209.89$

Ⓒ CENTERLINE CURVE DATA
 $\Delta = 88^\circ 50' 49''$
 $R = 250'$
 $T = 291.92$
 $L = 431.30$

Ⓓ CURB CURVE DATA
 $\Delta = 88^\circ 50' 49''$
 $R = 270'$
 $T = 319.27$
 $L = 469.80$

Ⓔ C.T.C. W. CURVE DATA
 $\Delta = 93^\circ 06' 00''$
 $R = 200'$
 $T = 99.93$
 $L = 189.59$

Ⓕ CURB CURVE DATA
 $\Delta = 93^\circ 06' 00''$
 $R = 180'$
 $T = 89.94$
 $L = 166.82$

NOTE:
 See Sheet No. 2 of 3 for
 Typical Section on
 Minier Avenue.

BENCH MARK:
 R.R. Nail in Northeast Curb return
 to Sierra Avenue and Collett Avenue
 at Flood Control Channel
 Riv. Co. Flood Control R.B. 704/82
 Elev. 701.61

ALBERT A. WEBB ASSOCIATES CIVIL ENGINEERS RIVERSIDE, CALIFORNIA APPROVED BY: <i>S.D. Wainwright</i> DATE: 7-25-71 R.E. No. 16058	CITY OF RIVERSIDE, CALIFORNIA PUBLIC WORKS DEPARTMENT APPROVED BY: <i>[Signature]</i> DATE: 5-20-72 DIRECTOR OF PUBLIC WORKS	STREET PLAN AND PROFILE MINIER AVENUE LA SIERRA AVE. TO WHITFORD AVE C-B-701 & P.M. 18		ACCOUNT NO. R-1526
		SCALE: Horiz. - 1" = 20' Vert. - 1" = 4'		SHEET 2 OF 2 M.C. 68-323-A