

RIVERSIDE CALIFORNIA



PUBLIC WORKS DEPARTMENT CROSS GUTTER REMOVAL FOR RCFCD MAGNOLIA CENTER S. D.

SHEET INDEX

SHEET 1	TITLE SHEET
" 2	RIVERSIDE AVE., LAURA LN. TO CENTRAL AVE.
" 3	RIVERSIDE AVE. AT SUNNYSIDE DR.
" 4	MERRILL AVENUE AT: PALM AVE., MAGNOLIA AVE., DE ANZA AVE., AND RIVERSIDE AVE.

CONSTRUCTION LEGEND



PLAN

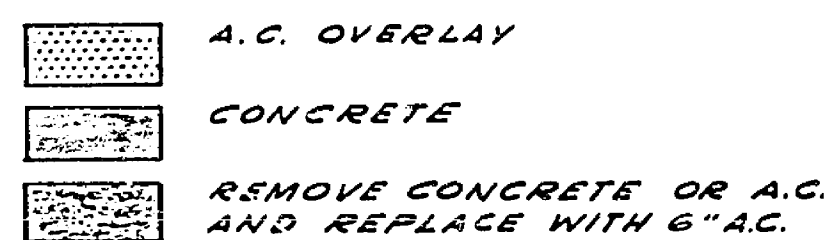
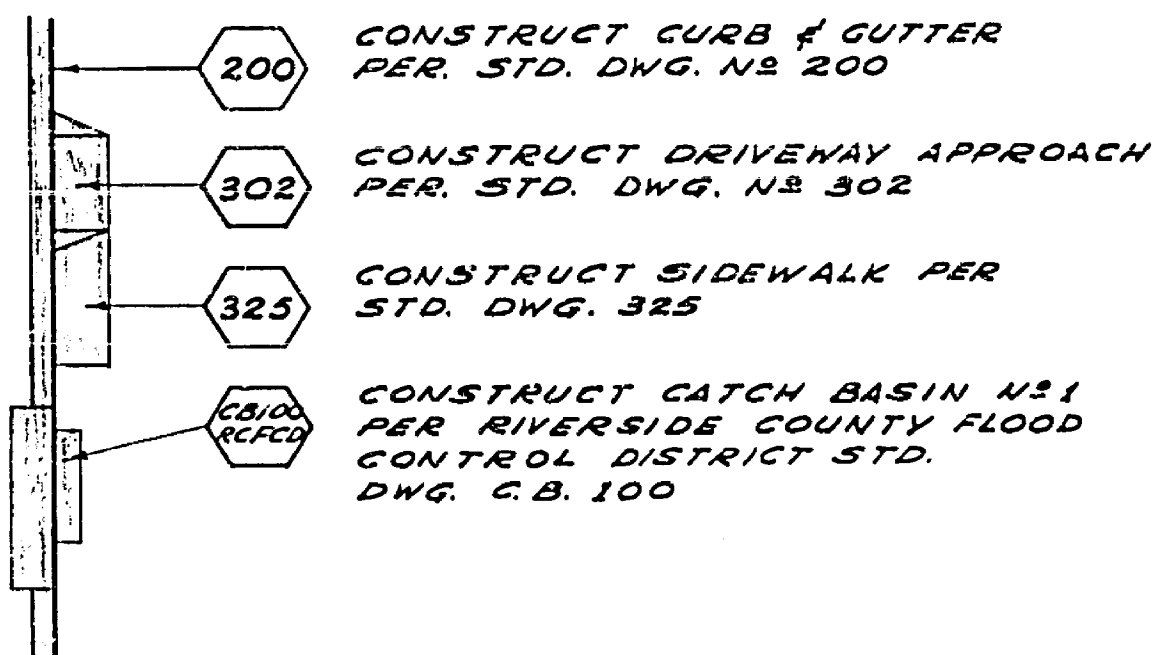

GENERAL CONSTRUCTION NOTES

- EXISTING ELEVATIONS ARE GIVEN IN PARENTHESES S.D. FOR REFERENCE ONLY. CONSTRUCT TOP OF CURB TO MATCH EXISTING SIDEWALK.
- OTHER NOTES ARE SHOWN ON SHEETS WHERE THEY APPLY.
- ADDITIONAL GRADE CONTROLS AT INTERSECTIONS WILL BE FURNISHED TO THE CONTRACTOR PRIOR TO PAVING.

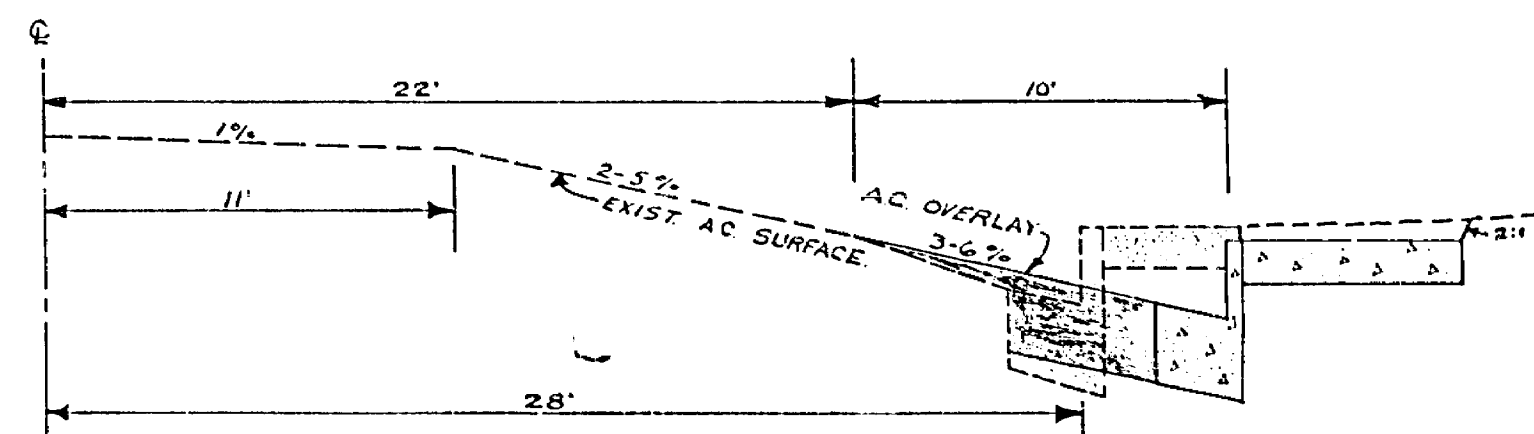

TYPICAL SECTION
1/8" HORIZ. 1" = 1' VERT.
RIVERSIDE AVE.
STA. 9+30 TO 11+60
STA. 15+00 TO 18+10

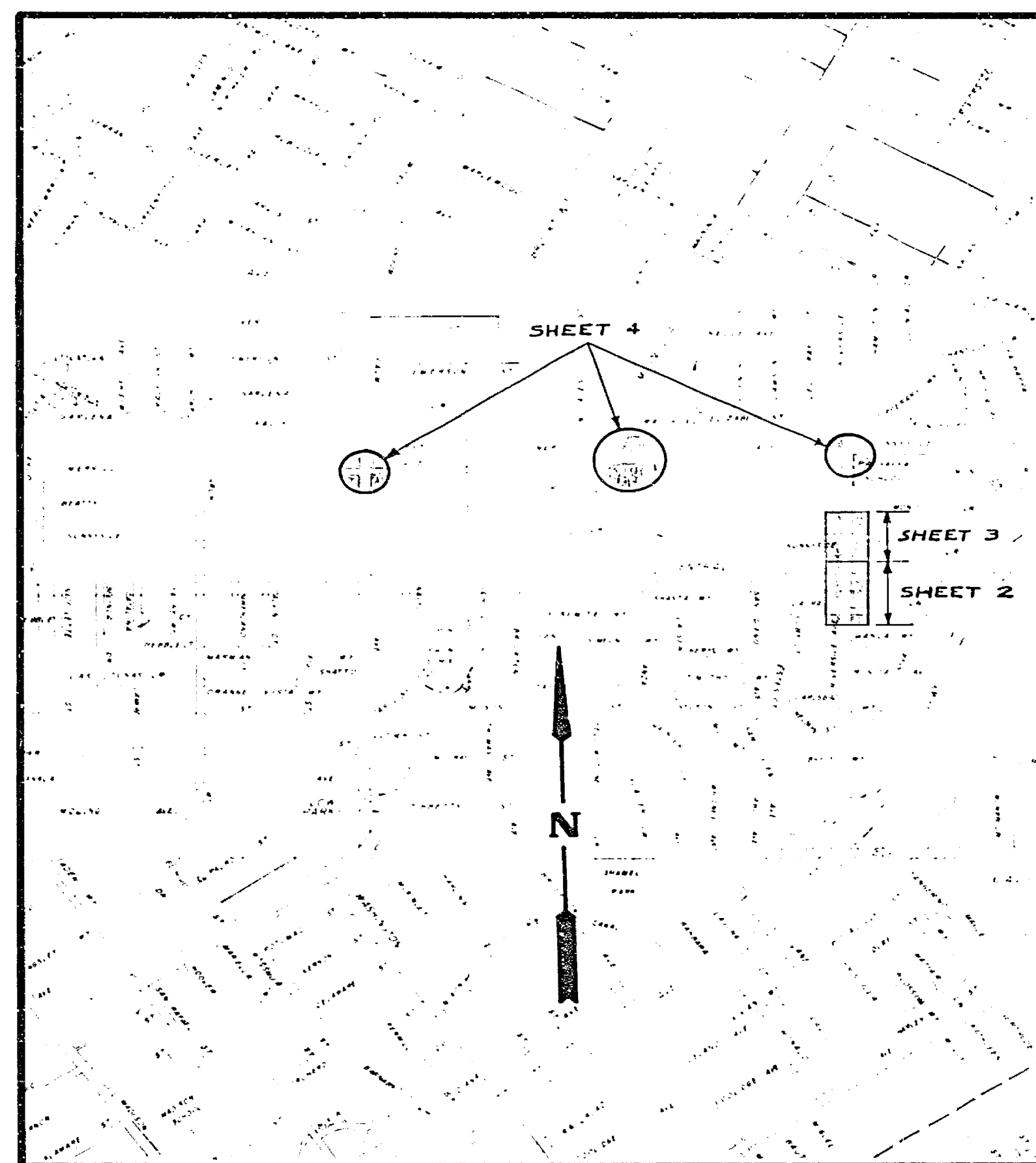

PROJECT LOCATION PLAN

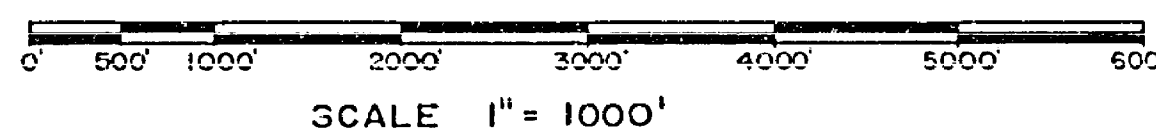

EXISTING CULTURE AND UNDERGROUND LEGEND

EXISTING UNDERGROUND UTILITIES

SANITARY SEWER	8" VCP-S	TELEPHONE CONDUIT	T
WATER LINE	6" CI-W	ELECTRICAL CONDUIT	E
STORM DRAIN	24" RCP-SD	STREET LIGHTING	SL
CULVERT	15" CONC-C	TRAFFIC SIGNAL	SIG
IRRIGATION LINE	20" IRR	FIRE ALARM	F
GAS LINE	3" M-G		

EXISTING TOPOGRAPHY

BLOCK WALL	TOP OF SLOPE
BOARD FENCE	TOE OF SLOPE
WIRE FENCE	DIRECTION OF FLOW
CHAIN LINK FENCE	

SANITARY SEWER MH	POWER POLE	RAILROAD TRACKS
SANITARY SEWER CLEANOUT	GUY POLE	RAILROAD SIGN
STORM DRAIN MH	POLE & GUY ANCHOR	RAILROAD SIGNAL
IRRIGATION WEIR	PULL BOX	
WATER MH	TRAFFIC SIGN	STREET LIGHT (UPRIGHT)
GAS MH	PARKING METER	STREET LIGHT
ELECTRIC MH	FIRE ALARM BOX	TRAFFIC SIGNAL
TELEPHONE MH OR VAULT	STREET NAME SIGN	TRAFFIC SIGNAL ON MAST ARM
WATER METER	GAS METER	TRAFFIC CONTROL BOX
FIRE HYDRANT	MAIL BOX	TRAFFIC SIGNAL DETECTOR
SPRINKLER HEAD	HYDRANT OR FAUCET	PEDESTRIAN CONTROL FOR TRAFFIC SIGNAL
VALVE		

CONCRETE	TREE SHOWING DIAMETER IN INCHES
ASPHALT	PALM SHOWING DIAMETER IN INCHES
EDGE OF PAVEMENT	SHRUBBERY
BUILDING	TREE STUMP DIAMETER IN INCHES
UNDERGROUND OR OVERHANGING STRUCTURE	

CAUTION - PACIFIC TELEPHONE CABLES UNDERGROUND BEFORE EXCAVATING
CALL COLLECT
After Hours: 7:30 A.M. to 5 P.M. & Holidays
Orange County: 714-613-0511, 714-547-6626
San Diego County: 714-444-0071, 714-547-6606

AS BUILT, 6/23/72 RB

CITY OF RIVERSIDE, CALIFORNIA PUBLIC WORKS DEPARTMENT		ACCOUNT No. 228	
APPROVED BY: <i>[Signature]</i> PRINCIPAL ENGINEER		DRAWING NUMBER R-1550	
APPROVED BY: <i>[Signature]</i> DIRECTOR OF PUBLIC WORKS		SHEET 1 OF 4	
DATE: 3/16/72		DESIGNED BY: _____ DRAWN BY: <i>[Signature]</i> CHECKED BY: _____	

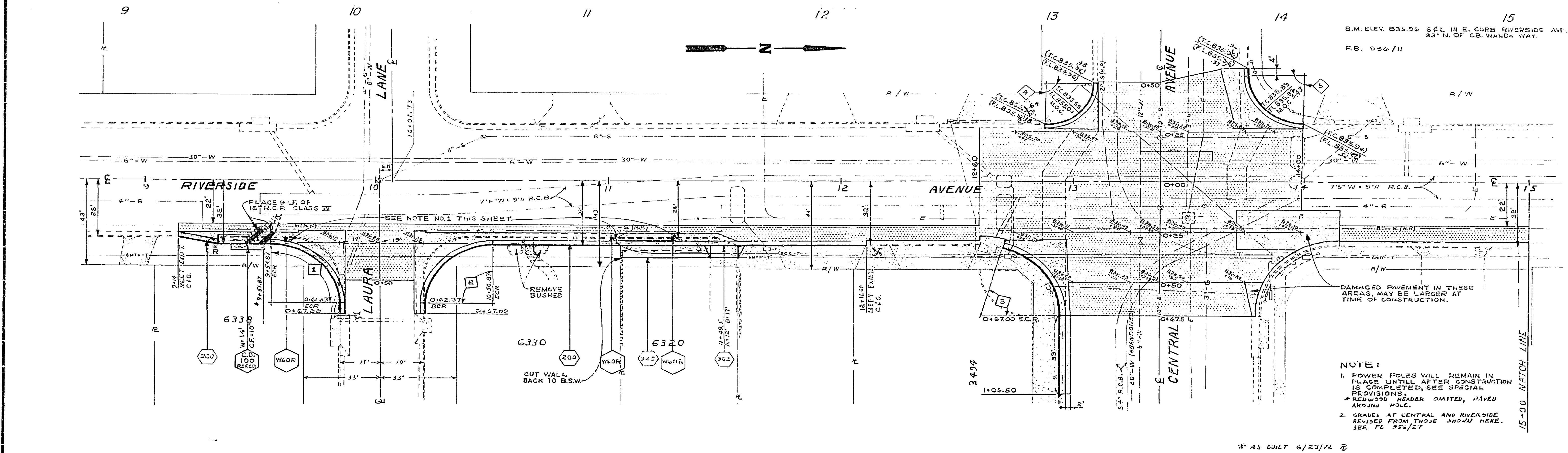
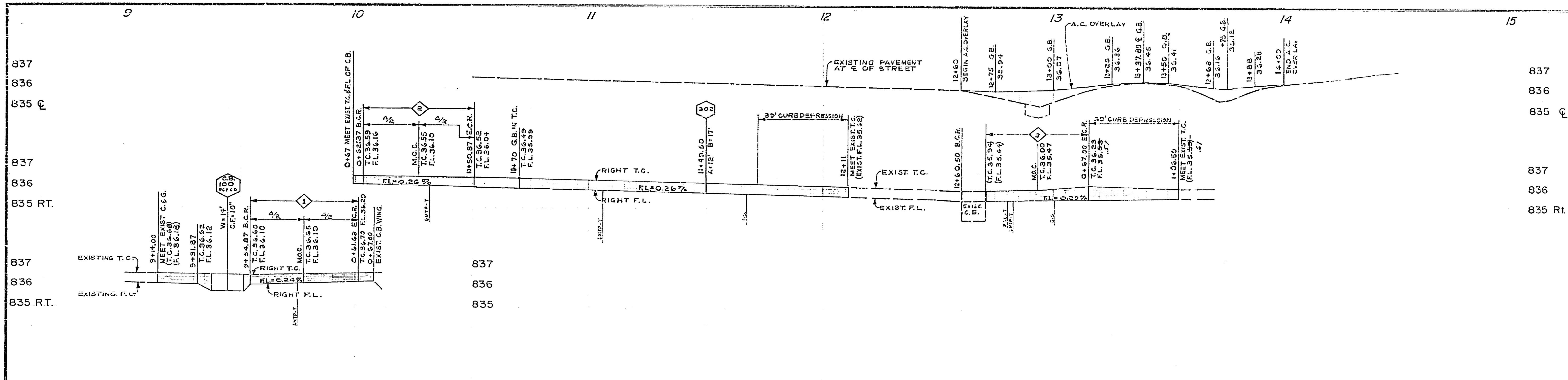

NOTE:
 1. POWER POLES WILL REMAIN IN PLACE UNTIL AFTER CONSTRUCTION IS COMPLETED, SEE SPECIAL PROVISIONS.
 2. GRADES AT CENTRAL AND RIVERSIDE REVISOR FROM THOSE SHOWN HERE. SEE FL 955/27

* AS BUILT 6/23/72

-CAUTION-
PACIFIC TELEPHONE
CABLES UNDERGROUND
 BEFORE EXCAVATING
 CALL COLLECT

CURVE DATA				
INDEX	R	A	T	L
1	30'	89°18'00"	29.63'	46.78'
2	30'	90°42'00"	30.37'	47.49'
3				44.50'
4				31.68'
5				38.94'

CITY OF RIVERSIDE, CALIFORNIA
 DEPARTMENT OF PUBLIC WORKS

CROSS-GUTTER REMOVAL
 FOR RCP&D MAGNOLIA CTR S.D.
 RIVERSIDE AVE.
 LAURA LN TO CENTRAL AVE.

PROJECT NO. 228
R-1550
 SHEET 2 OF 4
 FILE NO.

APPROVED BY
William J. Peterson
 SUPERVISOR OF PUBLIC WORKS
 DATE: 2/16/72

HORIZ. SCALE: 1" = 20' VERT. SCALE: 1" = 2'

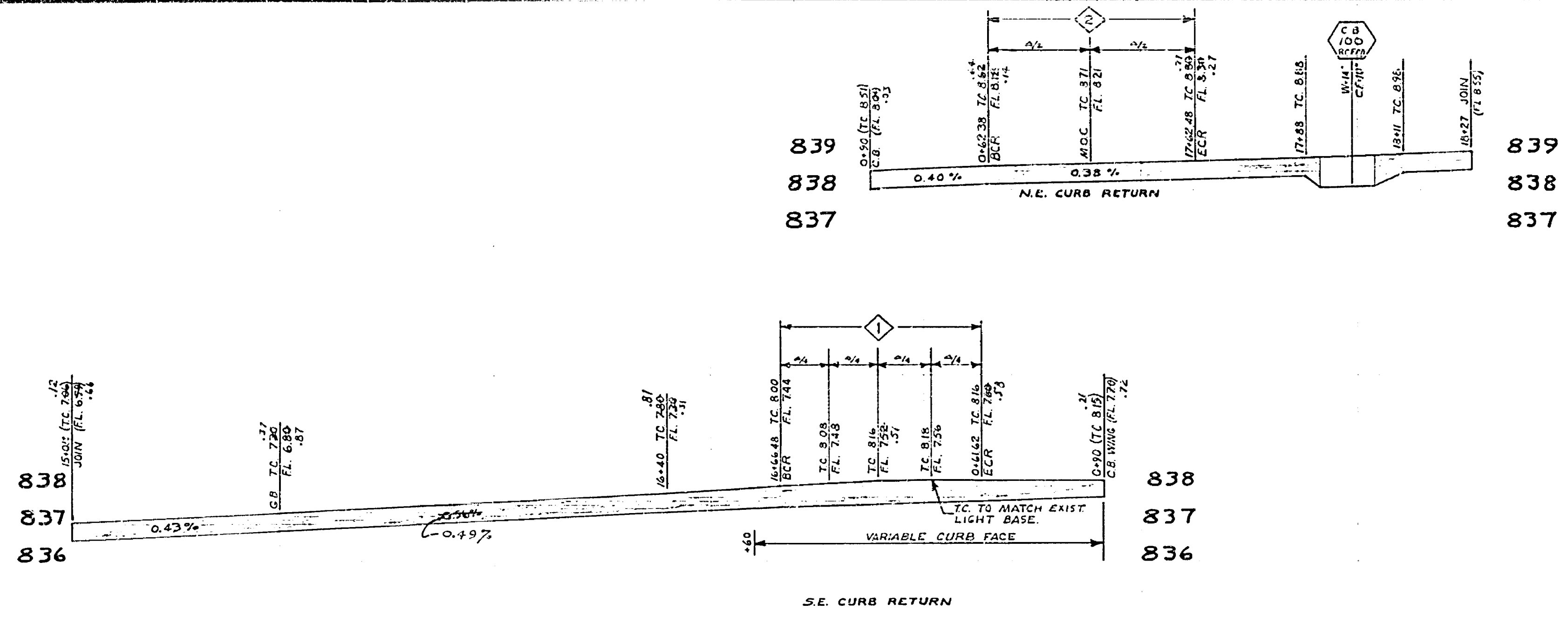

15 16 17 18 19

S.M. 836.96 54L IN E. CURB RIVERSIDE AVE. 33' N. OF CB. WANDA WAY. CRFB 956111.

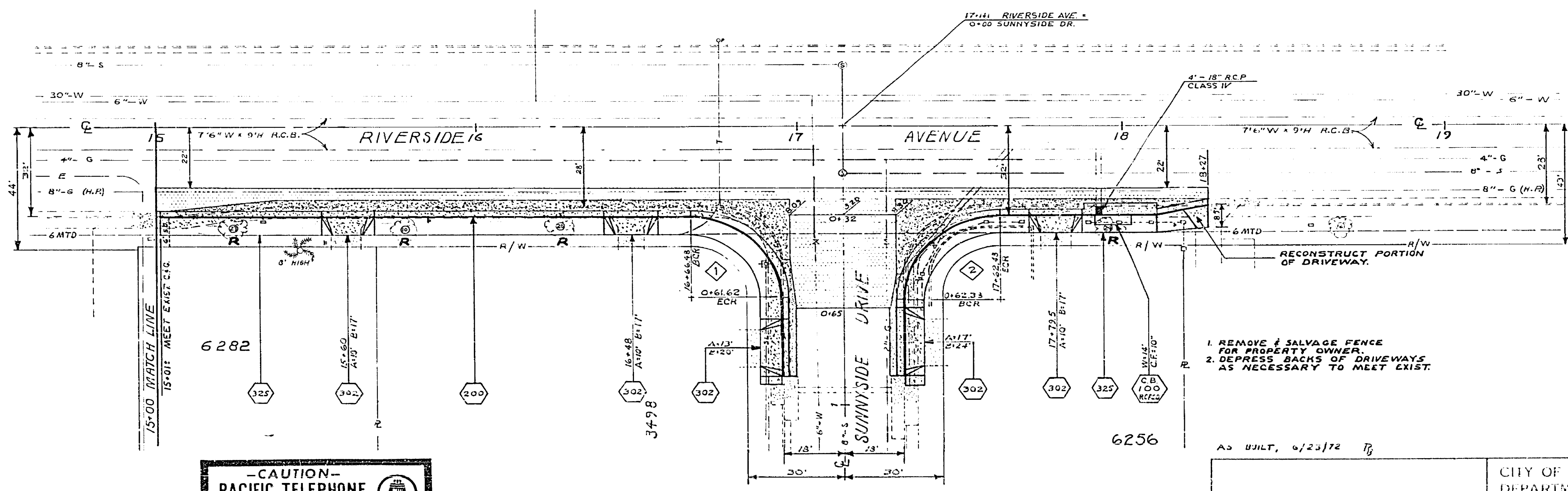
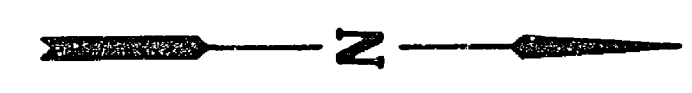

-CAUTION-
PACIFIC TELEPHONE
 CABLES UNDERGROUND
 BEFORE EXCAVATING
 CALL COLLECT

CURVE DATA				
R	A	L	T	
30'	89° 17' 30"	44.75'	29.62'	
30'	90° 45' 00"	47.49'	30.38'	

AD BUILT, 6/23/72

CITY OF RIVERSIDE, CALIFORNIA
 DEPARTMENT OF PUBLIC WORKS

CROSS GUTTER REMOVAL
FOR RCFC MAGNOLIA CTR S.D.
 RIVERSIDE AVE.
 CENTRAL AVE. TO SUNNYSIDE DR.

PROJECT NO. 228
R-1550
 SHEET 3 OF 4
 FILE NO.

HORIZ. SCALE: 1" = 20' VERT. SCALE: 1" = 2'

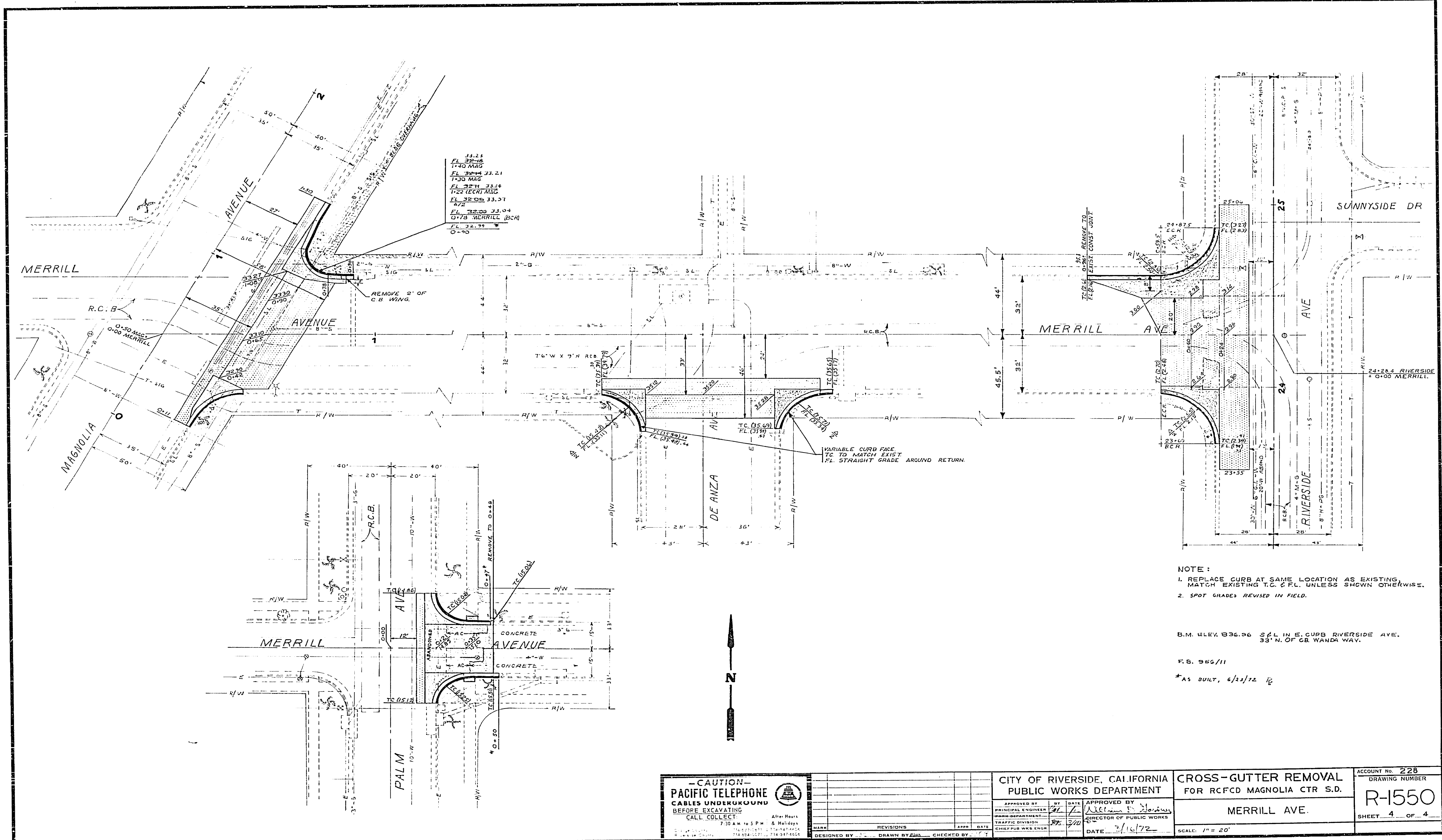

33.23
 FL 32.18
 1"40 MAG
 FL 32.14 33.21
 1"30 MAG
 FL 32.14 33.14
 1"22 REGR/MAG
 FL 32.08 33.07
 4/2
 FL 32.00 33.04
 0+75 MERRILL (BCR)
 FL 32.99
 0+90

VARIABLE CURB FACE
 TO MATCH EXIST
 FL STRAIGHT GRADE AROUND RETURN.

NOTE :
 1. REPLACE CURB AT SAME LOCATION AS EXISTING.
 MATCH EXISTING T.C. & FL. UNLESS SHOWN OTHERWISE.
 2. SPOT GRADES REVISED IN FIELD.

B.M. ELEV 836.96 S&L IN E. CURB RIVERSIDE AVE.
 33' N. OF CB. WANDA WAY.

F.B. 966/11

*AS BUILT, 6/23/72

CAUTION
PACIFIC TELEPHONE
CABLES UNDERGROUND
BEFORE EXCAVATING
CALL COLLECT

DESIGNED BY	DRAWN BY	CHECKED BY

CITY OF RIVERSIDE, CALIFORNIA		PUBLIC WORKS DEPARTMENT	
APPROVED BY	DATE	APPROVED BY	DATE

CROSS-GUTTER REMOVAL
FOR RCFCD MAGNOLIA CTR S.D.
MERRILL AVE.
 SCALE: 1" = 20'

ACCOUNT No. 228
 DRAWING NUMBER
R-1550
 SHEET 4 OF 4