

B.M. ELV. 781.46 "PK" IN S.E. CB. RET.
MADRONA & CALIFORNIA
F.B. 604/67, 574/53
SCALE: HOR. 1" = 50'
VERT. 1" = 5'

CALIFORNIA AVENUE

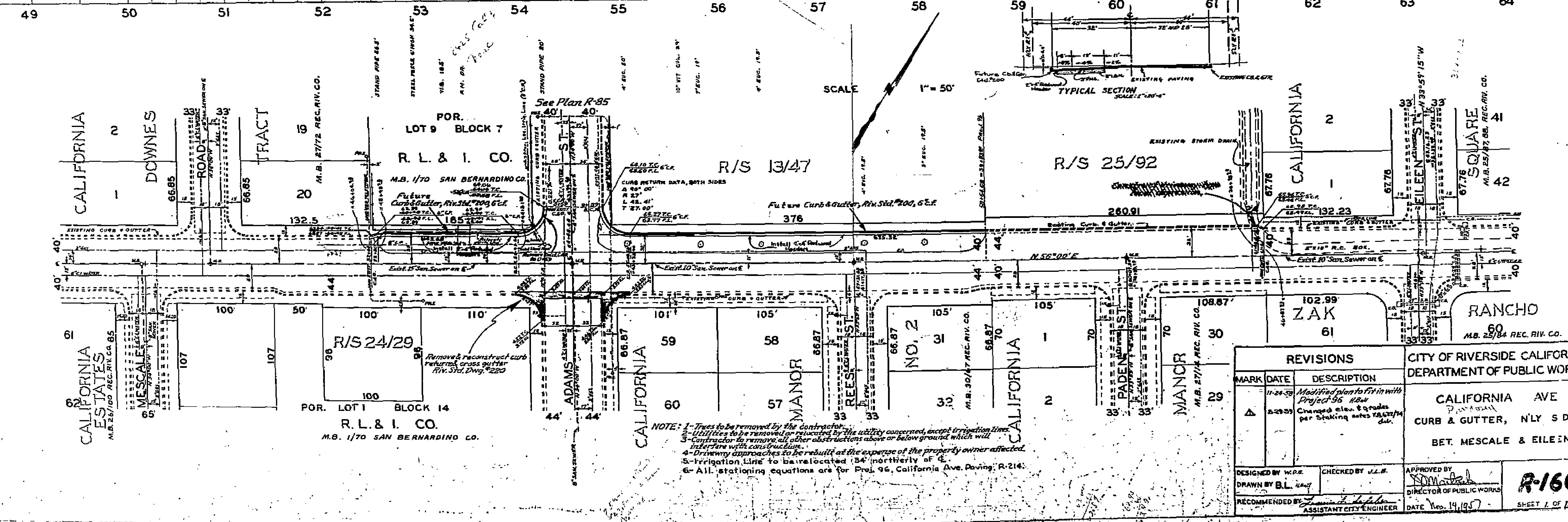

NOTE: 1- Trees to be removed by the contractor.
2- Utilities to be removed or relocated by the utility concerned, except irrigation lines.
3- Contractor to remove all other obstructions above or below ground which will interfere with construction.
4- Driveway approaches to be rebuilt at the expense of the property owner affected.
5- Irrigation Line to be relocated 154' northerly of 4.
6- All stationing equations are for Proj. 96, California Ave. Paving, R-214.

| REVISIONS | | | CITY OF RIVERSIDE CALIFORNIA DEPARTMENT OF PUBLIC WORKS |
|-----------|----------|--|--|
| MARK | DATE | DESCRIPTION | |
| | 11-24-59 | Modified plan to fit in with Project 96 R-214 | CALIFORNIA AVE CURB & GUTTER, NLY S DE BET. MESCALE & EILEEN |
| Δ | 5-29-59 | Changed elev. & grades per staking notes 12/27/54 det. | |

| | | | |
|-----------------------------------|-------------------------|--------------------------------|--------------|
| DESIGNED BY W.D.R. | CHECKED BY J.L.B. | APPROVED BY <i>[Signature]</i> | R-160 |
| DRAWN BY B.L. | | DIRECTOR OF PUBLIC WORKS | |
| RECOMMENDED BY <i>[Signature]</i> | ASSISTANT CITY ENGINEER | DATE Nov. 14, 1957 | SHEET 1 OF 1 |

