

BM. Elev. = 861.589
 S.F.L. in South Headwall of Canal
 Culvert, Indiana & Arlington

SCALE
 Horiz. 1" = 50'
 Vert. 1" = 5'

F.B. 987-22-31, 989/69

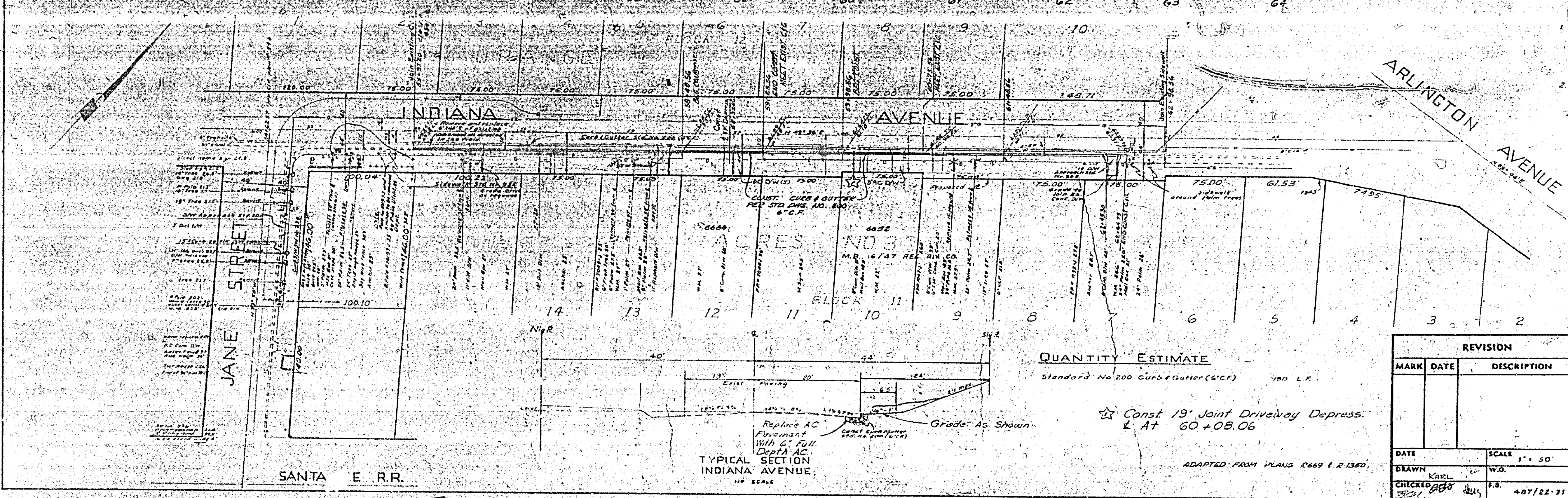

GENERAL NOTES

- Construction shall be in accordance with Standard Specifications for Public Works Construction 1970 Edition and the City of Riverside Standard Drawings.
- Place 4" of AC paving on 6% slope in back of curb depressions for driveways.

APPROVED BY
~~Albert A. Webb~~
 CIVIL ENGINEERS RIVERSIDE, CALIFORNIA
 DATE 10-11-72

CITY OF RIVERSIDE, CALIFORNIA
 DEPARTMENT OF PUBLIC WORKS

6652 & 6666
 INDIANA AVENUE
 JANE STREET
 TO
 ARLINGTON AVENUE

REVISION	
MARK	DATE

APPROVED BY
 DATE 10-11-72

NO. R-1508
 SHEET 1 OF 1

INDEXED