

FB. 937/63
 B.M.: CH. Y. TOP OF RH. SW.
 CORNER 5TH & MARKET.
 ELEV. 850.22

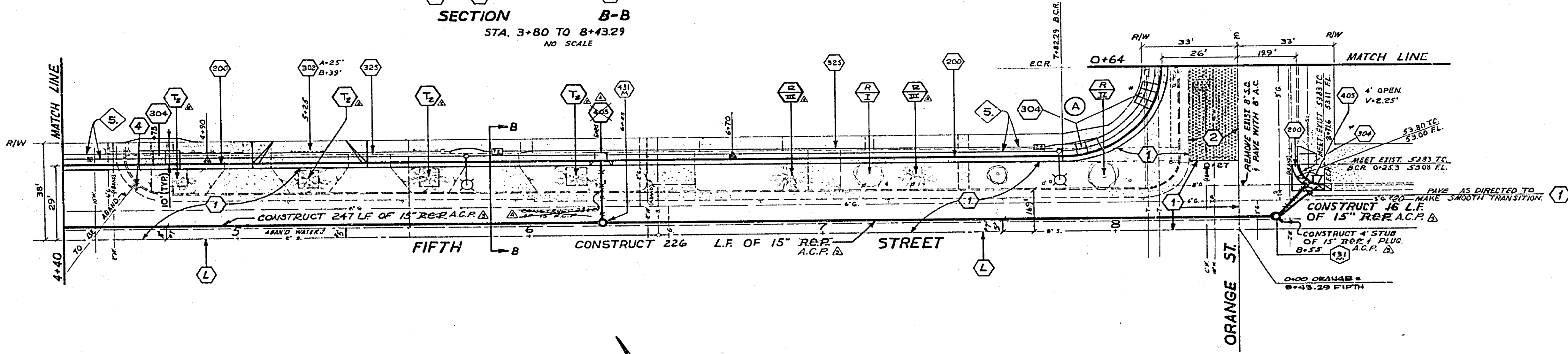

-CAUTION-
PACIFIC TELEPHONE
CABLES UNDERGROUND
BEFORE EXCAVATING
CALL COLLECT
 Orange County 714-833-0811
 Riverside County 714-684-0071

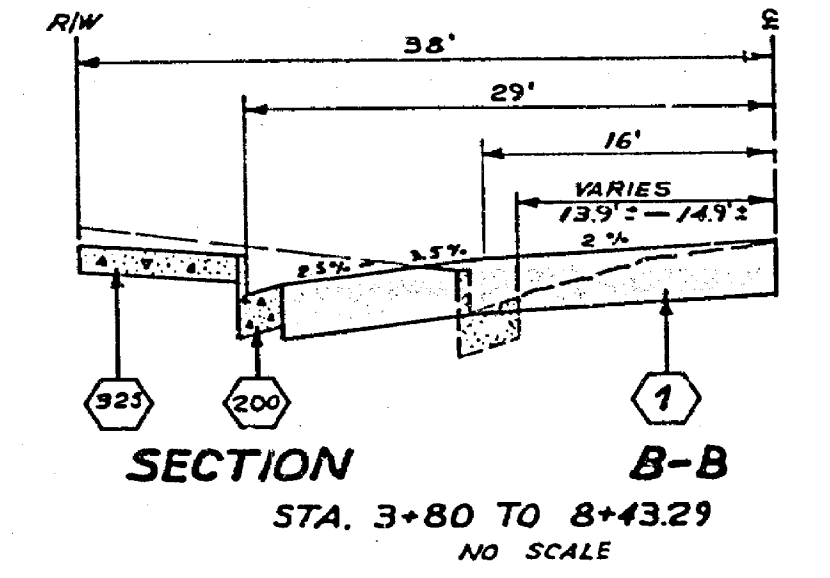
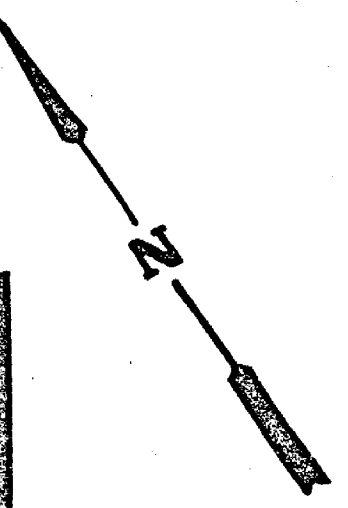

CITY OF RIVERSIDE, CALIFORNIA DEPARTMENT OF PUBLIC WORKS DATE: 7-27-73 DRAWN BY: [Signature] CHECKED BY: [Signature]	FIFTH and ORANGE STREETS WIDENING FIFTH STREET - FROM MAIN STREET TO ORANGE STREET	498 R 1612 SHEET 2 OF 5
	*AS BUILT 8-76 KPT SCALE: 1" = 20' DATE: 7-27-73	576 BM

-CAUTION-
PACIFIC TELEPHONE
CABLES UNDERGROUND
 BEFORE EXCAVATING
 CALL COLLECT
 7:30 A.M. TO 5 P.M. A Holiday
 714 444-0211 714 444-0212
 714 444-0213 714 444-0214

CITY OF RIVERSIDE, CALIFORNIA
 DEPARTMENT OF PUBLIC WORKS
 FIFTH and ORANGE STREETS
 WIDENING
 R 1612

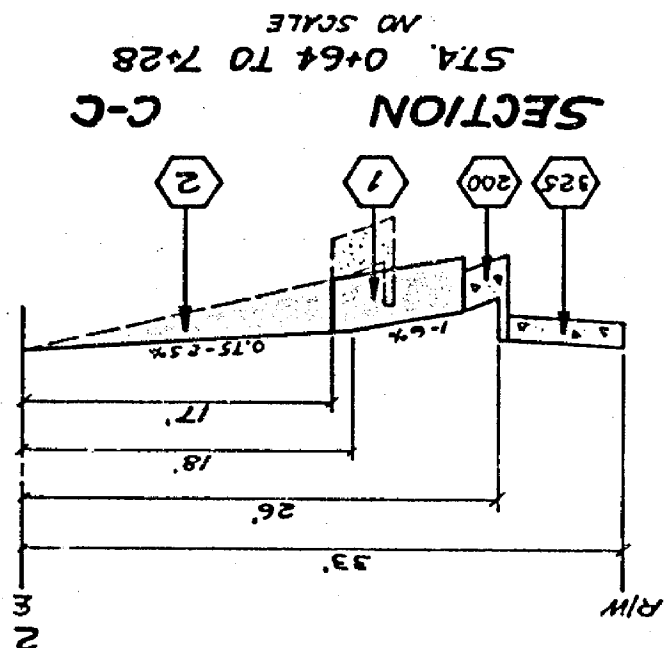
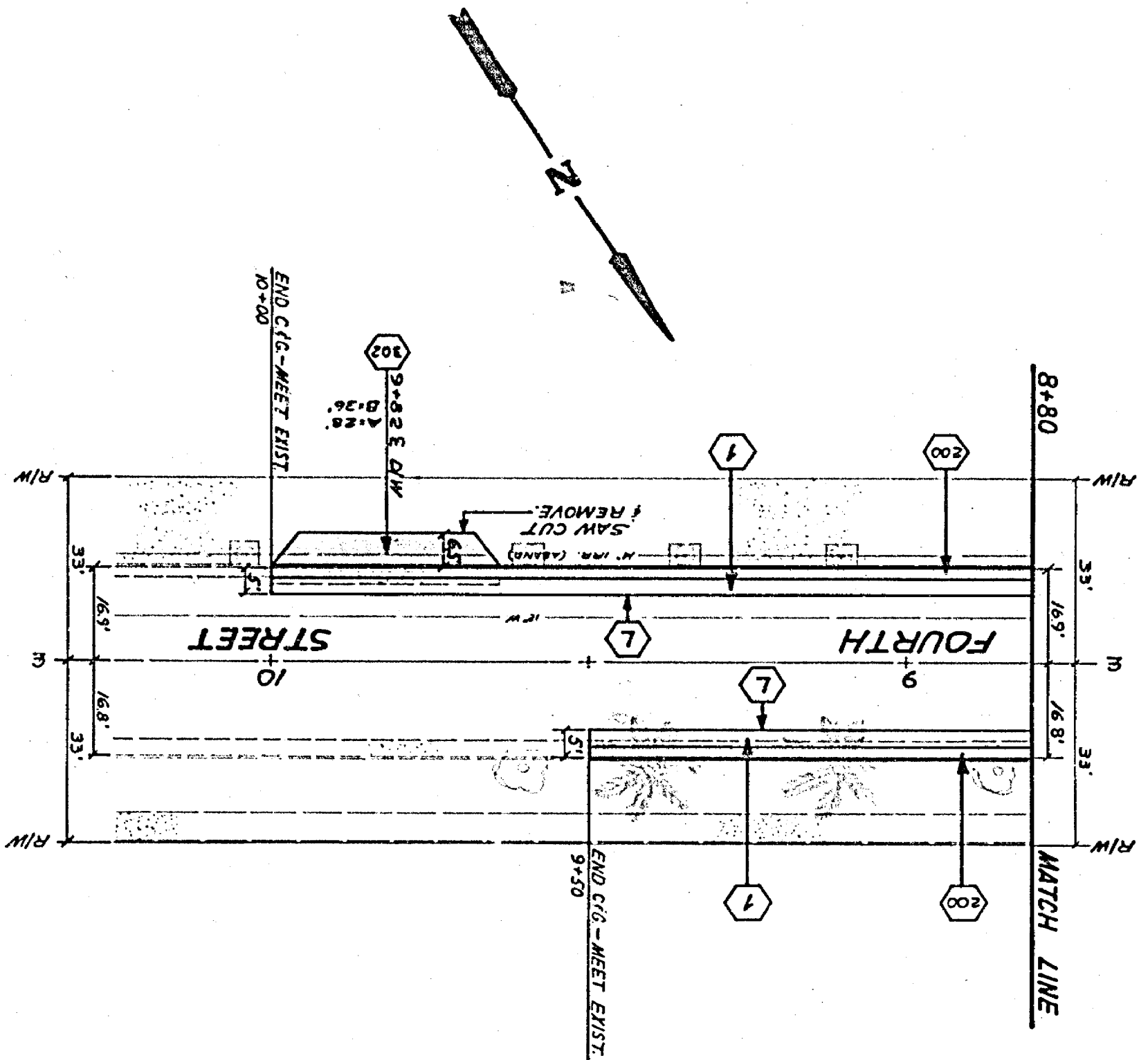
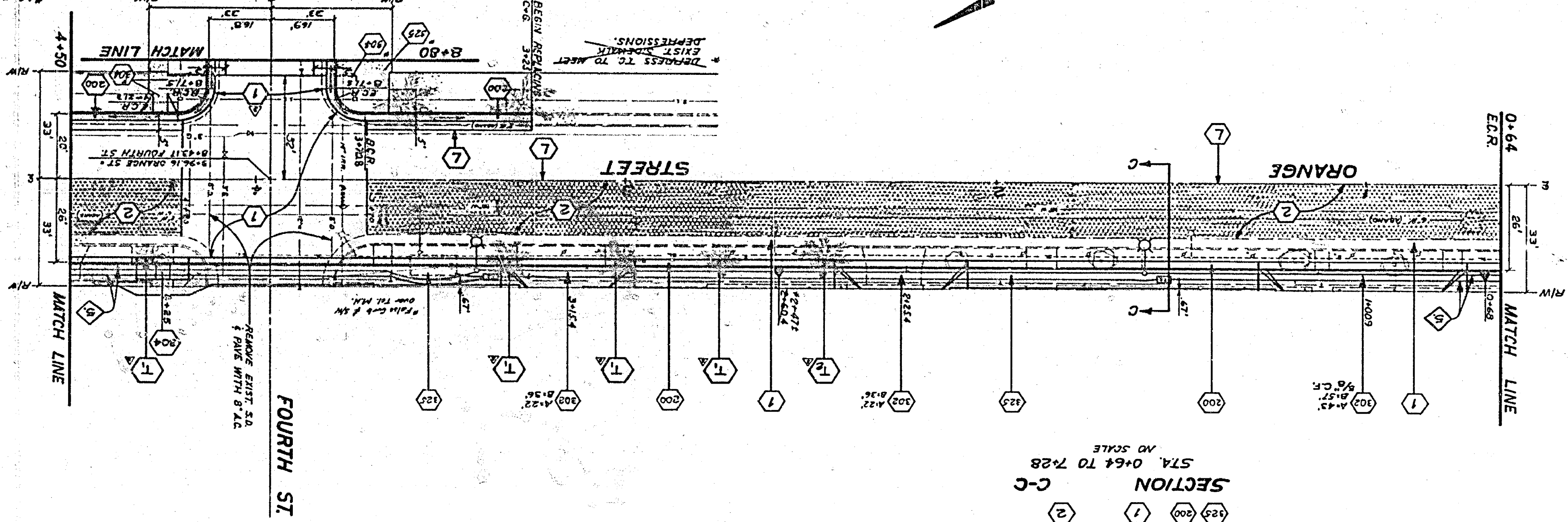

FB. 93763
 B.M. CH. X TOP OF FH. 51V
 CORNER 5" x 1 MARKET
 ELEV. 8.062

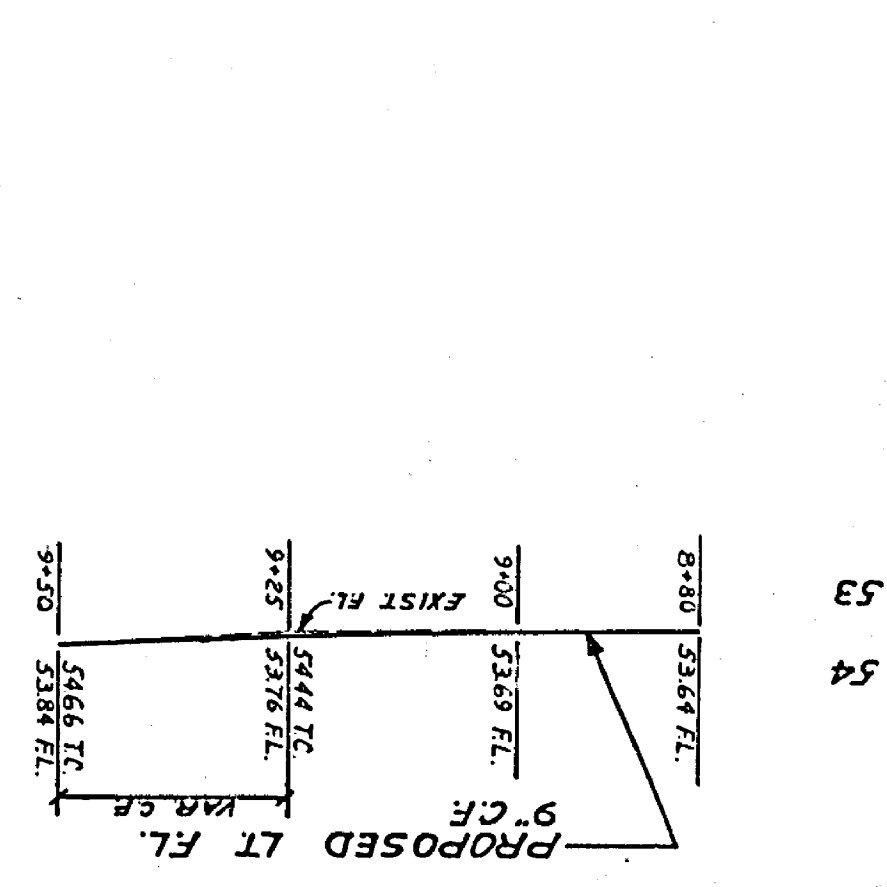
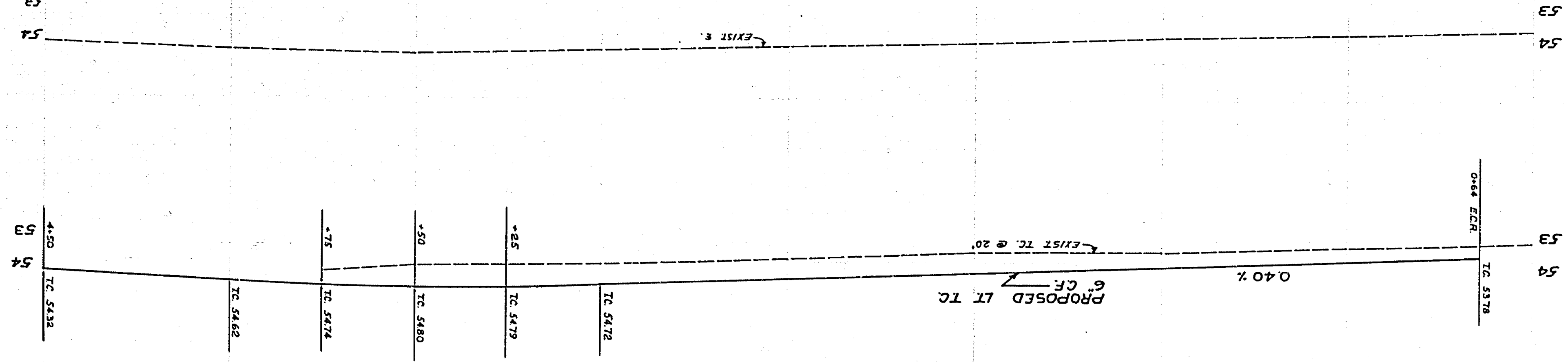
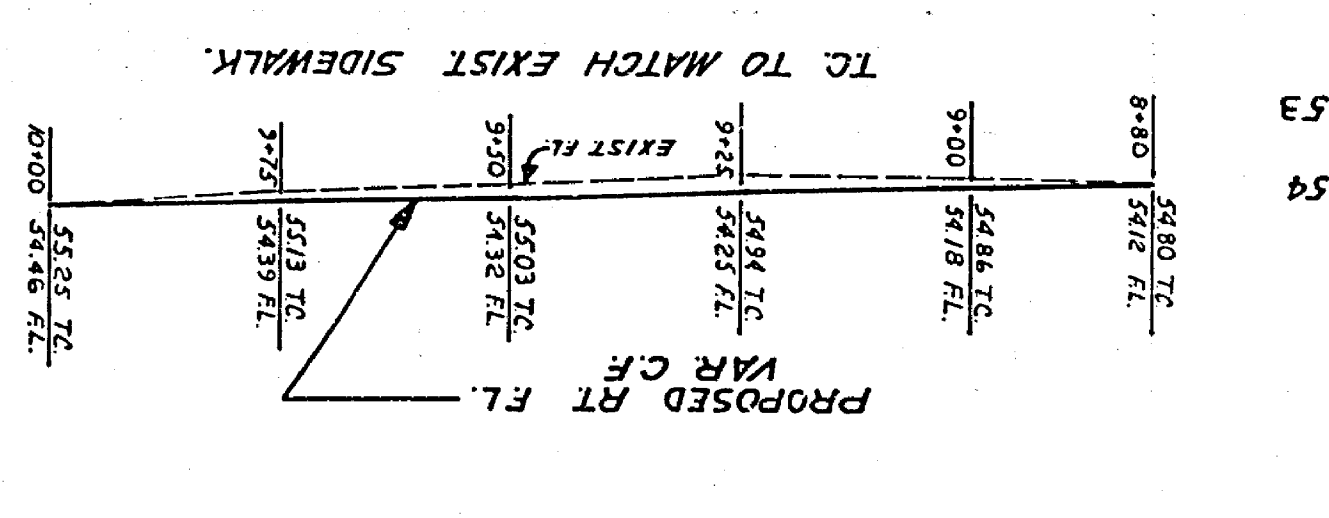
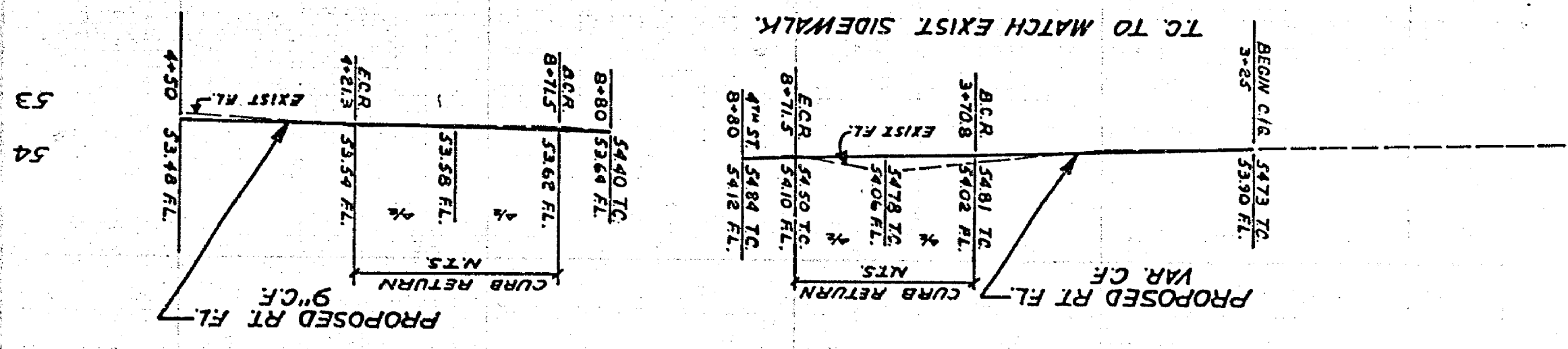

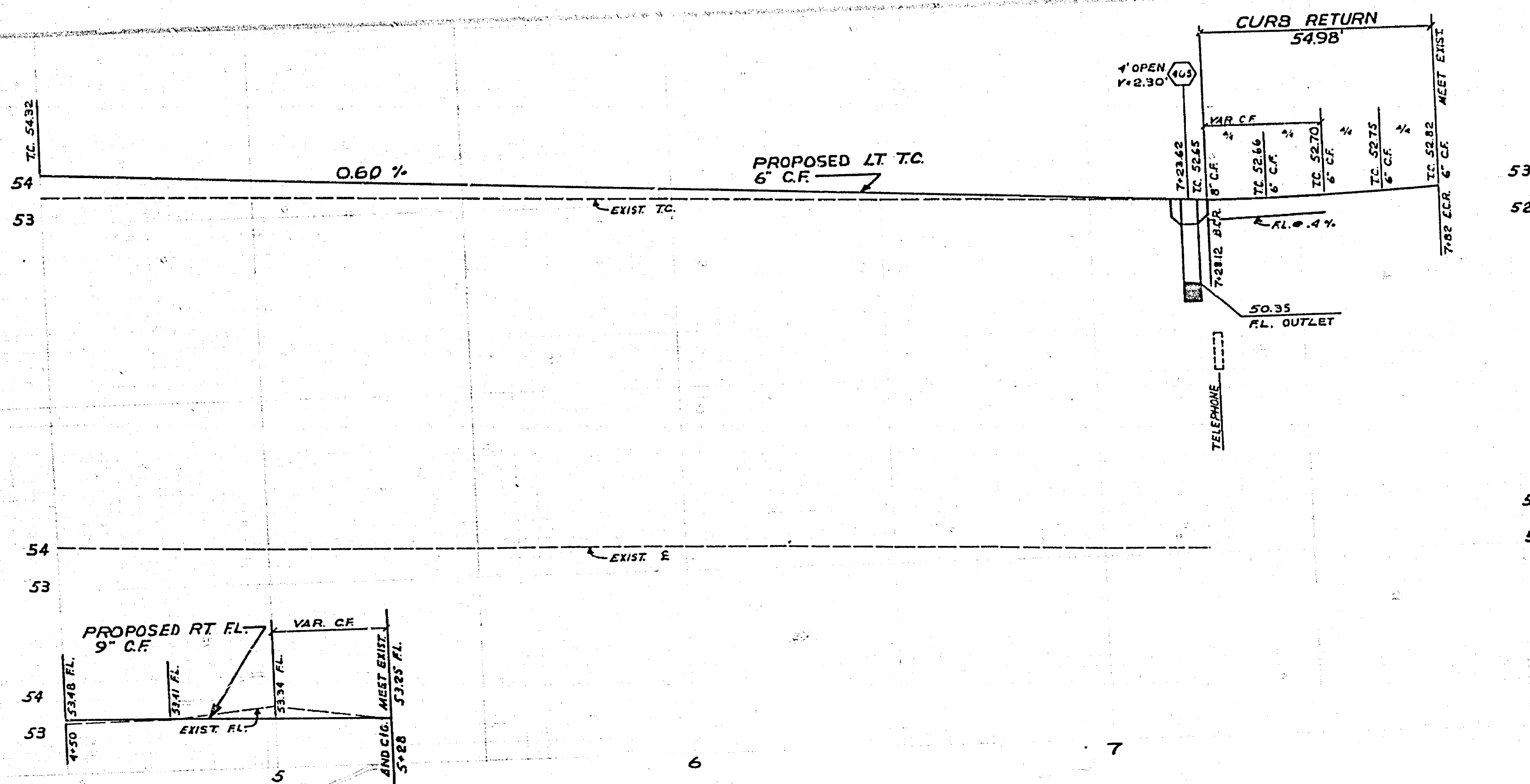

FB. 84.5/53
 B.M. SPIKE LEAD ON E'LY
 CURB OF MAIN ST. APPROX.
 100' N'LY OF THIRD ST.
 ELEV. 850.675

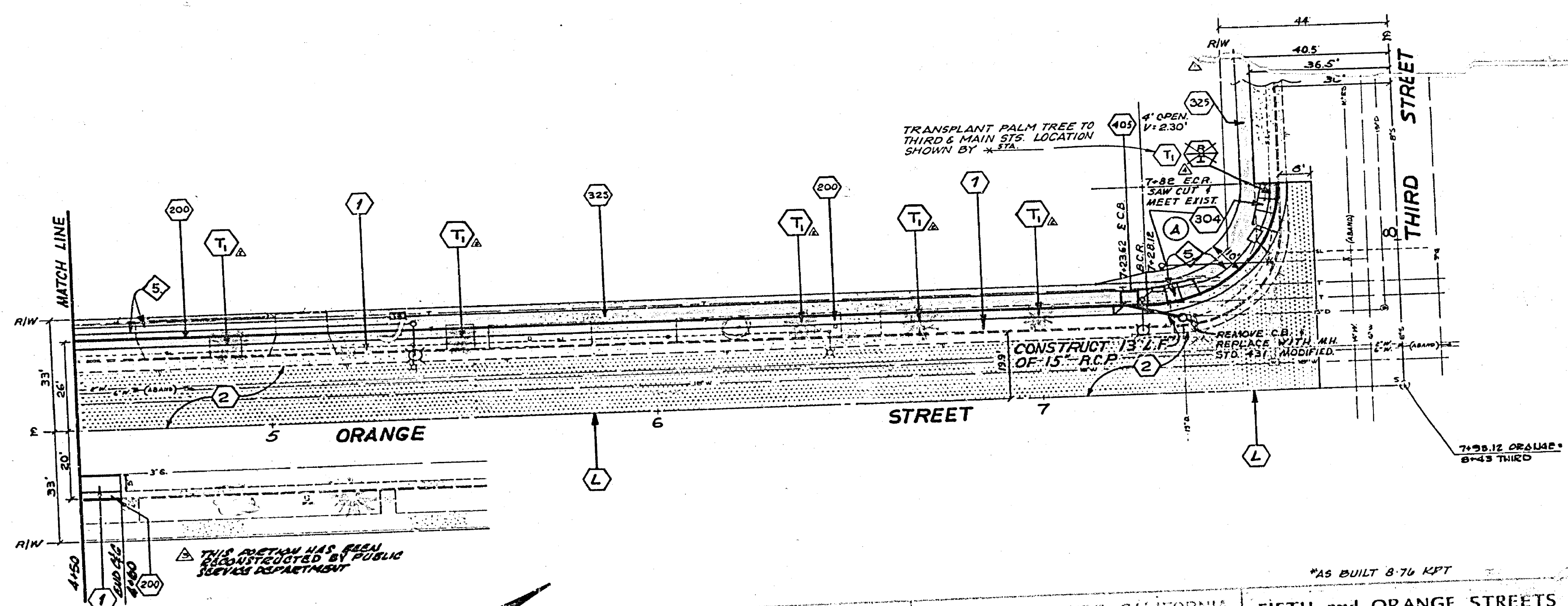

CAUTION
PACIFIC TELEPHONE
CABLES UNDERGROUND
BEFORE EXCAVATING
 CALL COLLECT
 7:30 A.M. to 5 P.M. After Hours
 Orange County 714-633-0811 714-547-6606
 Riverside County 714-684-0071 714-547-6606

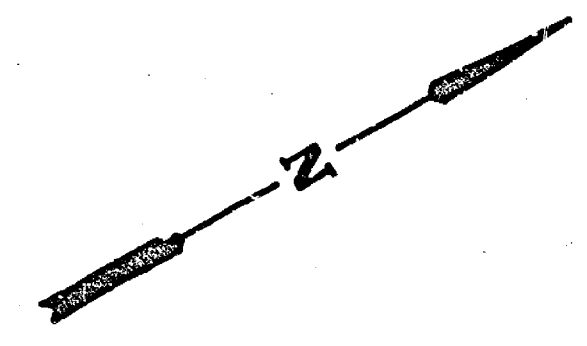

DATE: 4-27-73
 DRAWN BY: [Signature]
 CHECKED BY: [Signature]
 CITY OF RIVERSIDE, CALIFORNIA
 DEPARTMENT OF PUBLIC WORKS

CITY OF RIVERSIDE, CALIFORNIA
 DEPARTMENT OF PUBLIC WORKS
 DATE: 4-27-73
 DRAWN BY: [Signature]
 CHECKED BY: [Signature]

*AS BUILT 8-76 KPT
FIFTH and ORANGE STREETS
WIDENING
 ORANGE STREET—FROM FOURTH STREET
 TO THIRD STREET
 NORTH SCALE: 1" = 20'
 VERT. SCALE: 1" = 2'
R 1612

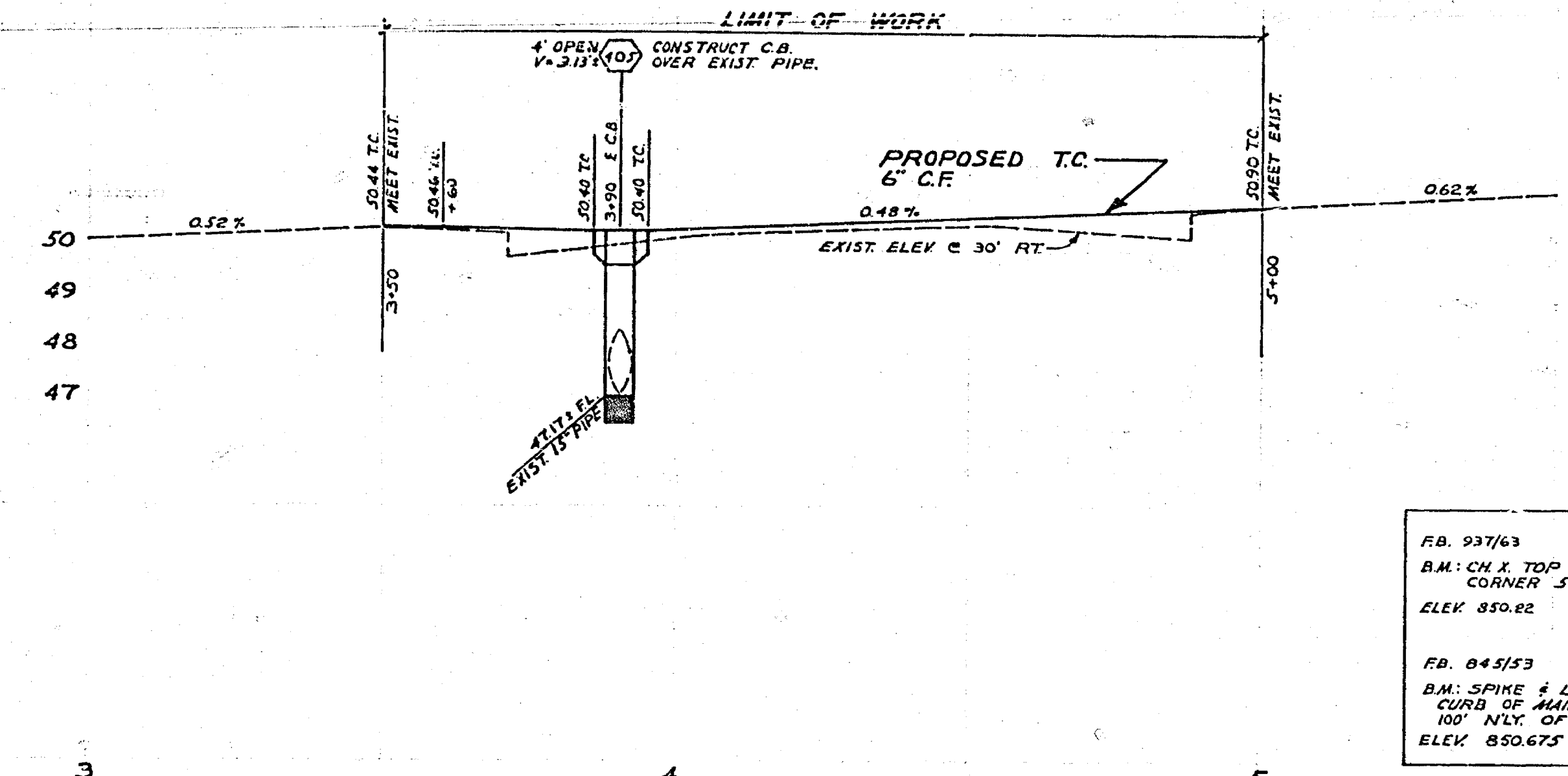
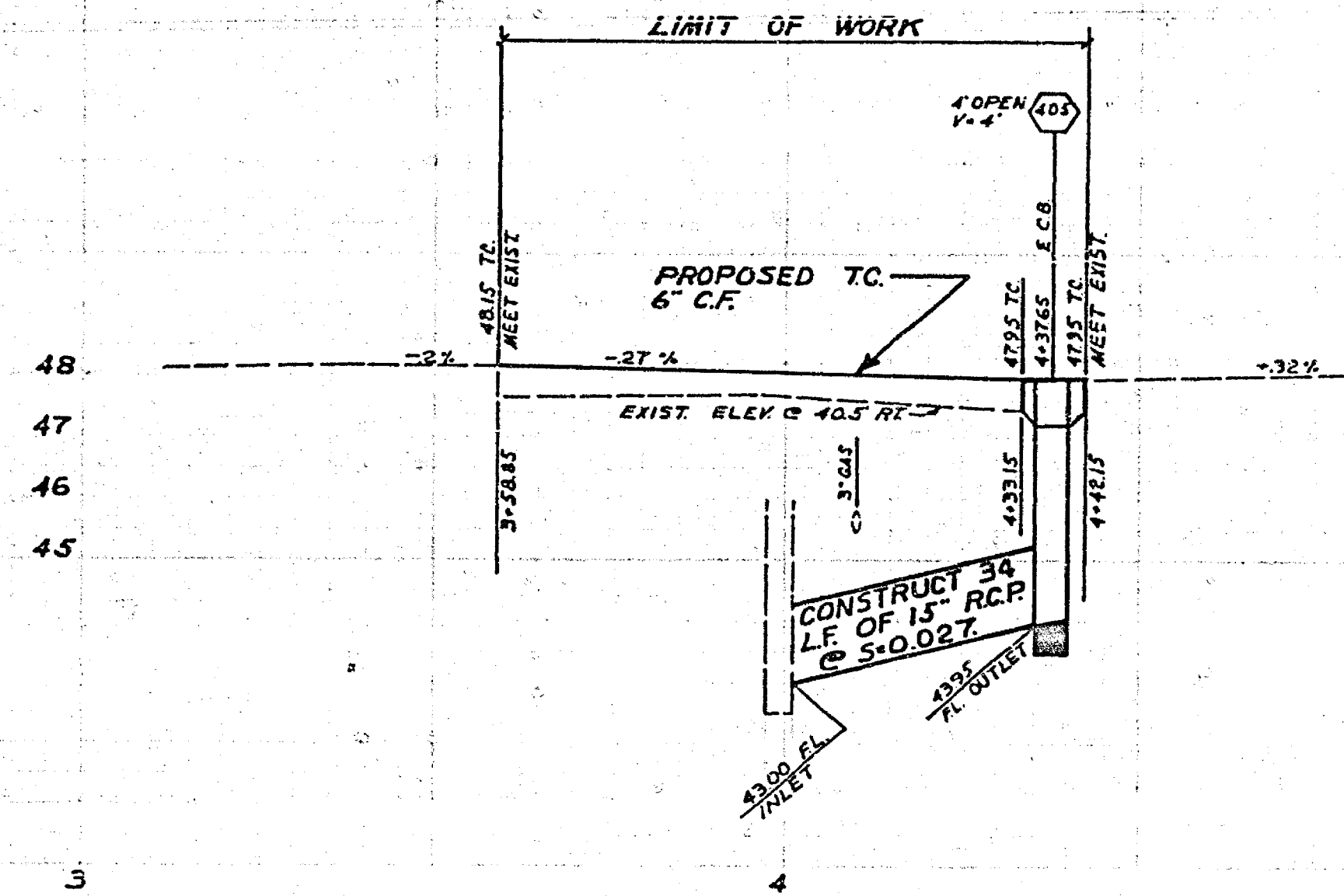

FB. 937/63
 B.M. CH X TOP OF FH. S.W.
 CORNER 5TH & MARKET
 ELEV. 850.82

FB. 645/53
 B.M. SPIKE & LEAD ON ELY
 CURB OF MAIN ST. APPROX.
 100' N.W. OF THIRD ST.
 ELEV. 850.675

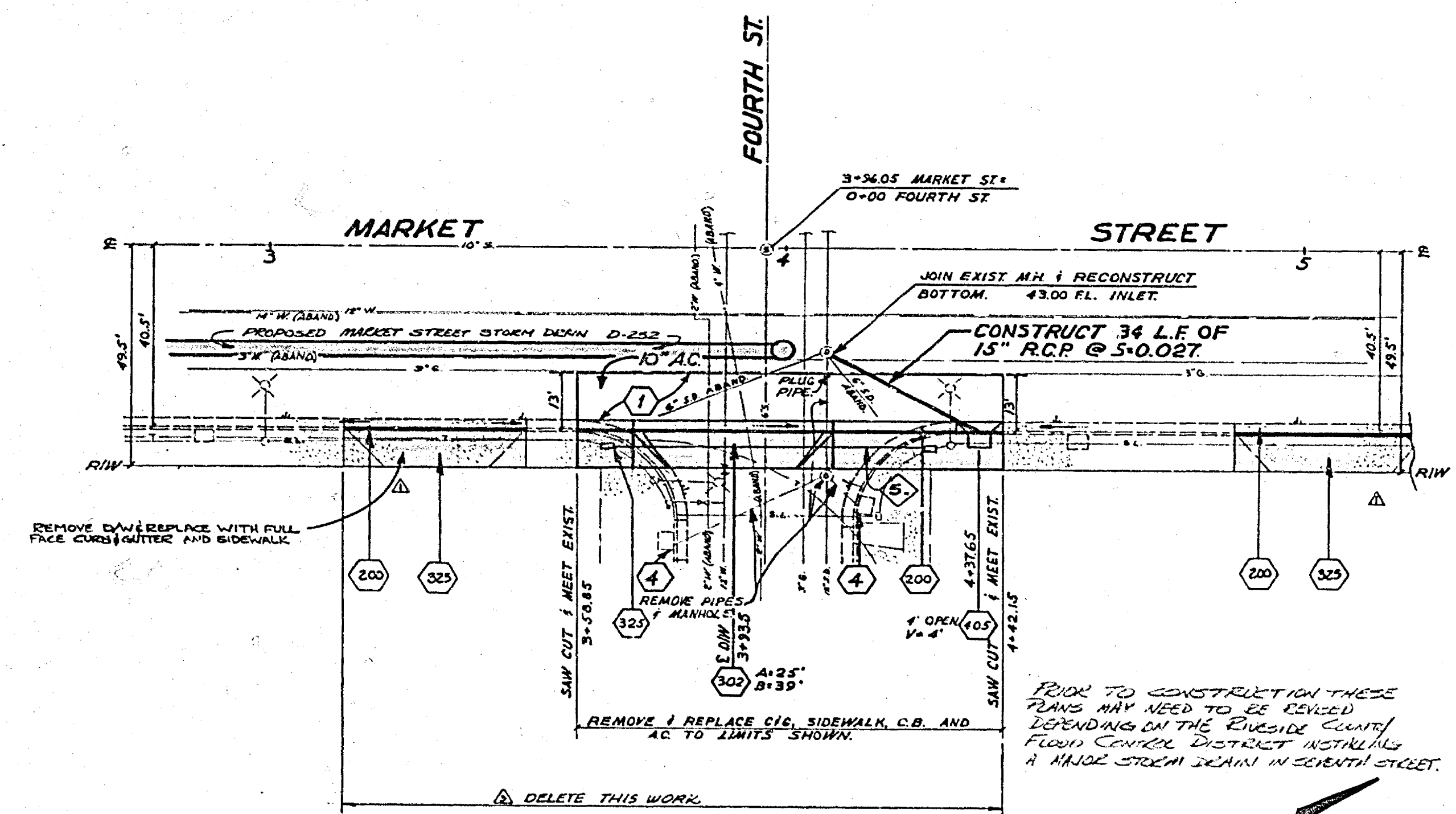

TRANSPLANT PALM TREE TO
 NEW LOCATION AT THIRD ST.
 1/2 MAIN ST. SHOWN BY LEGAL
 CONST. TREE WELL & COVER
 PER STD. DWG. NO. 376.
 RELOCATE STREET LIGHT
 CABLE IF NECESSARY.

PRIOR TO CONSTRUCTION THESE
 FRAMES MAY NEED TO BE REVISED
 DEPENDING ON THE RIVERSIDE COUNTY
 FLOOD CONTROL DISTRICT INSTALLING
 A MAJOR STORM DRAIN IN SEVENTH STREET.

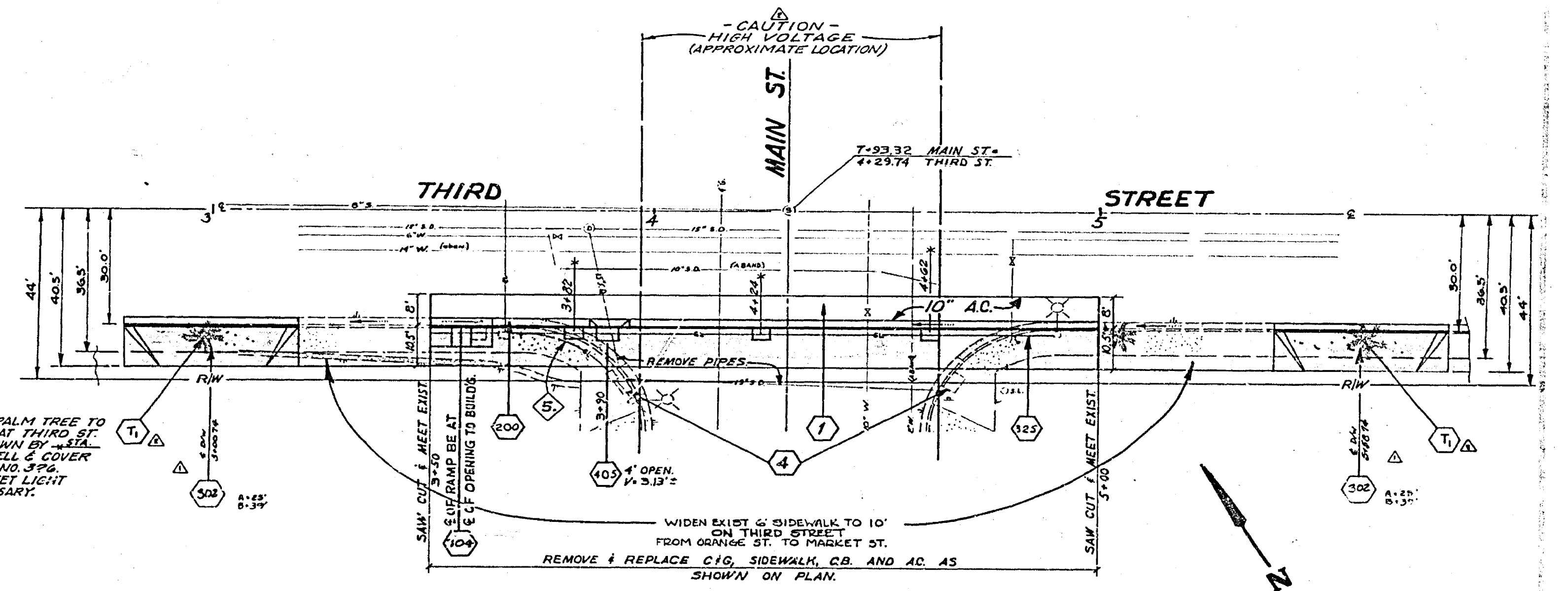

-CAUTION-
PACIFIC TELEPHONE
CABLES UNDERGROUND
BEFORE EXCAVATING
CALL COLLECT

After Hours
& Holidays
 Orange County 714-433-0811 714-547-6409
 Riverside County 714-686-0071 714-547-6505

DELETE WORK PER ARCHITECT'S LET
 LETTER DATED OCT. 16, 1972
 REVISIONS TO ORIGINAL DRAWING
 BY THE ARCHITECT'S OFFICE
 DATE 11/22/72

AS BUILT 876 KPT

CITY OF RIVERSIDE, CALIFORNIA
 DEPARTMENT OF PUBLIC WORKS

Martinez
 4-27-73

FIFTH and ORANGE STREETS
 WIDENING

STREET CLOSURES: FOURTH ST. ELY MARKET
 ST. MAIN ST. ELY THIRD ST.

R 1612