

**STREET LIGHTING CONSTRUCTION NOTES**

1. Install all street light facilities as shown in accordance with the plans, standard plans, and the latest revision of the City of Riverside Public Utilities Department Street Light Specification No. 113.
2. Contact Public Utilities Street Light Inspector, telephone no. 767-1423, for required inspections.
3. Excavation for electrolier foundations, pullboxes, and conduits must be done after installation of curbs and gutters, but before installation of sidewalks. Foundation locations shall be approved by the engineer prior to excavation.
4. \$ 28.00 Connection and inspection fees to be paid by contractor.
5. Install a waterproof "in line" fuse holder in both branch conductors in the base of each street light standard. Fuse holder to be "Bussman" # H250-25 for copper wire with a "Bussman" FNM 5 Amp 250 volt fuse or approved equal.
6. All service points to be connected by City of Riverside.

**STREET LIGHT STRUCTURE SCHEDULE**

SYMBOL	GENERAL INFORMATION	SIZE	NEEDED	STANDARD PLANS	ITEM NO.
✳	Metal Electrolier Standard	12 ft.	7	UGS 800	56
	Post Top Luminaire	175 W.	7	"	LS
	Color Corrected Lamp	175 W.	7	"	LA 1
	Photo Control	140 W.	7	"	PC 2
☐	Concrete Pullbox	10" x 17"	4	"	PI
—	1" rigid steel conduit with 2" x 8 cu. 600 v. cables unless otherwise noted	A B	SHOWN		

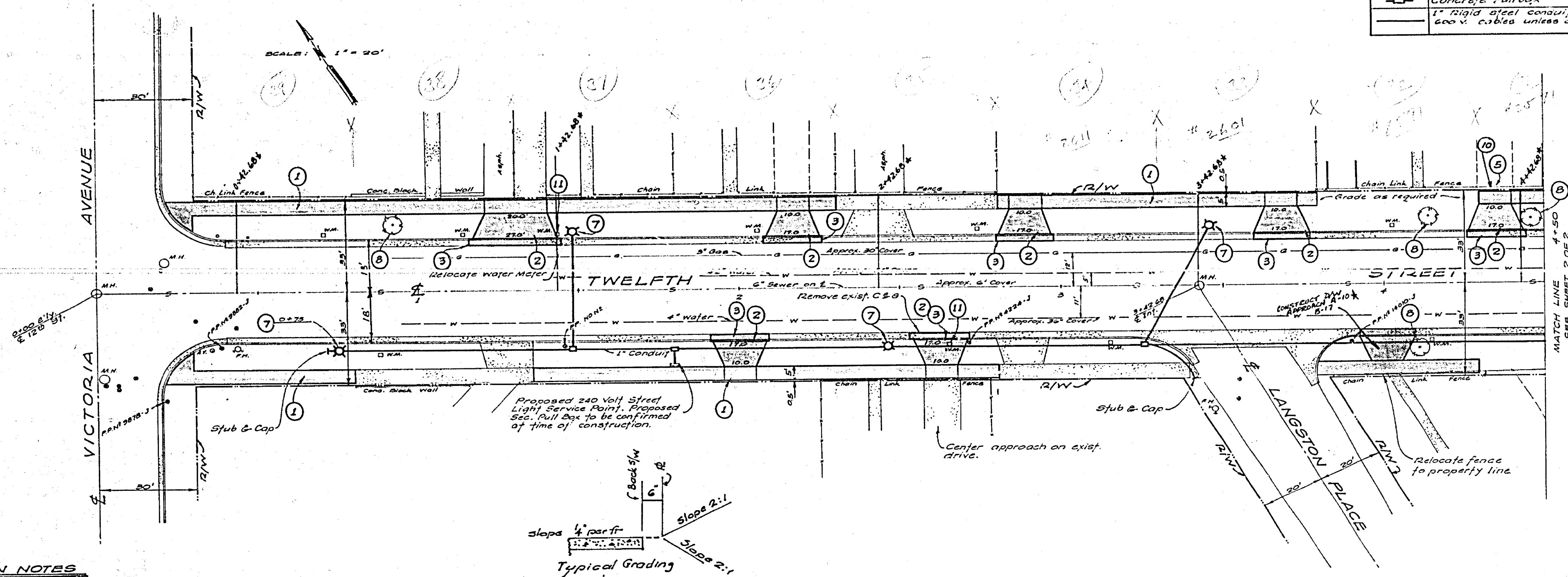

**CONSTRUCTION NOTES**

1. Construct 5 ft. property line sidewalk per City of Riverside Std. 350. Match existing sidewalk where applicable.
2. Construct Driveway Approach per C/R Std. 303. Dimensions "A" and "B" shown on plans.
3. Remove existing depression and curb & gutter and construct driveway and curb depression per C/R Std. 303.
4. Remove existing conc. block wall and construct new block wall per C/R Std. 704. Match existing size, color, and texture.
5. Regrade dirt driveway to match driveway approach and sidewalk elevation. Maximum slope to be 10%.
6. Construct concrete steps per detail on sheet 2 of 2.
7. Install post top luminaire with metal electrolier standard.
8. Remove trees and fill void.
9. Construction to be done in accordance with Standard Specifications for Public Works Construction, 1970 edition, and City of Riverside Standard Drawings.
10. Lower existing gate to grade to suit owner.
11. Contractor shall make all necessary arrangements with City of Riverside for water meter relocation.

APPROVED FOR CONCEPT & SCOPE  
 D.R. *Hedley*  
 Div. Rep. Aa.  
 1-22-73  
 DATE

APPROVED FOR STREET LIGHTS  
 Utility Engineer  
 Date 1-7-73

ALBERT A. WEBB ASSOCIATES  
 CIVIL ENGINEERS  
 RIVERSIDE, CALIFORNIA  
 APPROVED BY *Joseph Webb* DATE 1-17-73  
 R.E. No. 2177E  
 W.D. 72-451 FOR C/R REDEVELOPMENT AS Y.F.B.

NO.	REVISIONS	DATE

DESIGNED BY W.D. DRAWN BY J.W.D. CHECKED BY

CITY OF RIVERSIDE, CALIFORNIA  
 DEPARTMENT OF PUBLIC WORKS

APPROVED BY *Joseph Webb* DATE 1-24-73  
 OFFICE ENGINEER  
 PARK DEPARTMENT  
 TRAFFIC DIVISION  
 ASSISTANT CITY ENGINEER

IMPROVEMENTS  
 TWELFTH STREET  
 VICTORIA AVE. TO BERMUDA AVE.

HORIZ. SCALE: 1" = 20' VERT. SCALE: 1" =

INDEXED PROJECT NO. **R-1644**  
 SHEET 1 OF 2  
 FILE NO. 72-451

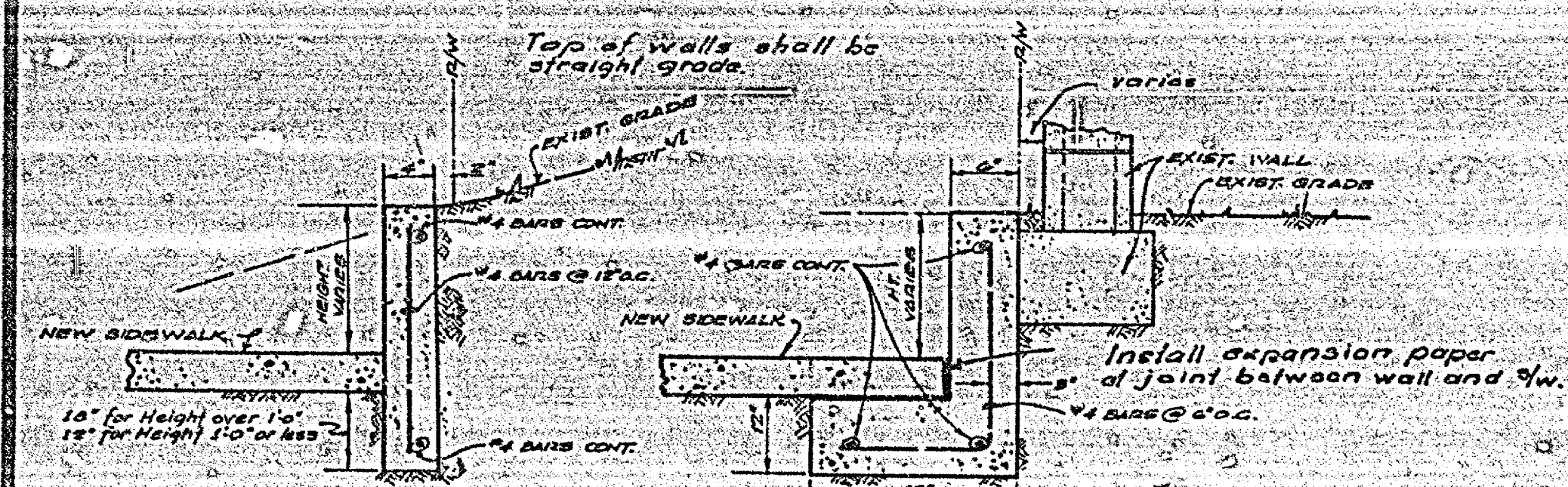
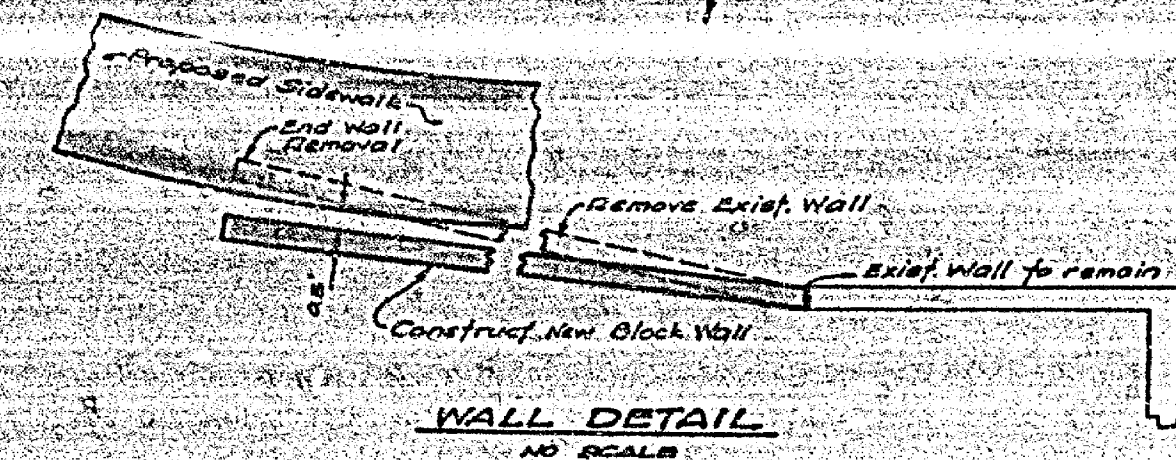
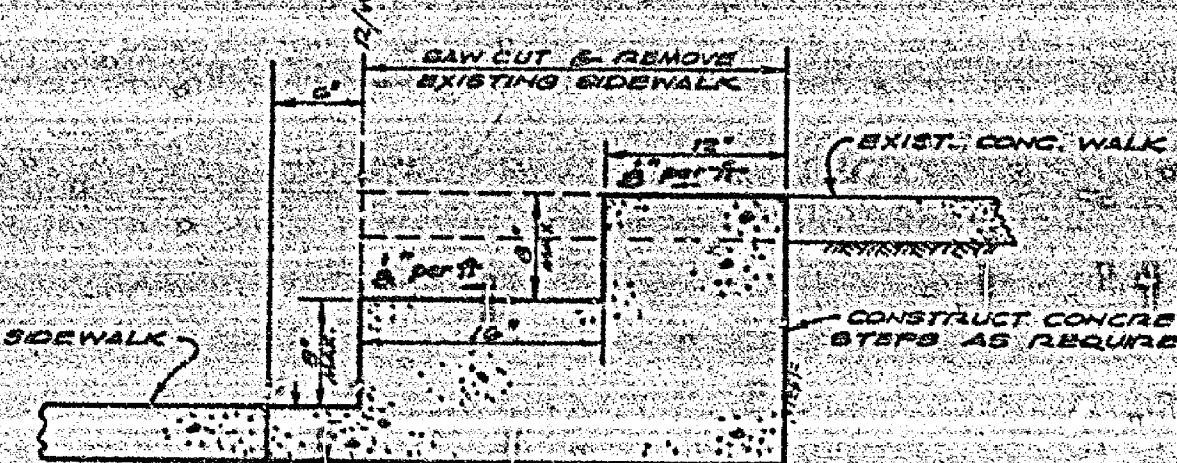
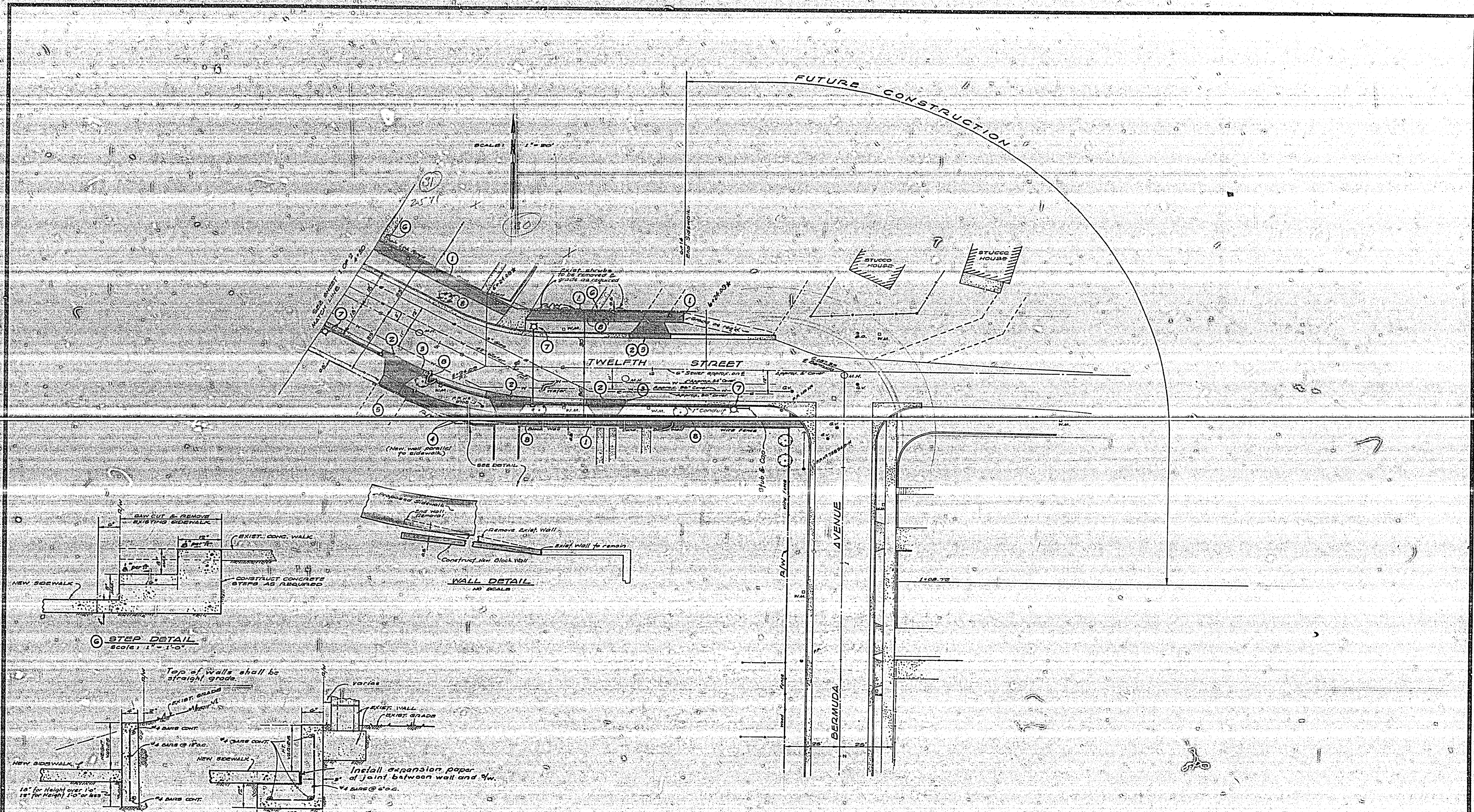

**CASE I**  
NO ADJACENT WALL

North Curb... 4+40 to 4+80  
South Curb... 3+85 to 4+31 ; 4+35 to 4+65

**CASE II**  
ADJACENT WALL

South Curb... 4+20 to 4+30

APPROVED FOR CONCEPT & SCOPE  
*D.R. Mellett*  
En. Redox Ag.  
1-22-73  
Date

APPROVED FOR STREET LIGHTS  
*J. J. [Signature]*  
Utility Engineer  
Date 1-2-73

ALBERT A. WEBB ASSOCIATES  
CIVIL ENGINEERS  
RIVERSIDE, CALIFORNIA

APPROVED BY *[Signature]* DATE 12-27-72  
R.E. No. 21775

W.D. 72-451 FOR C/A REDEVELOPMENT ACT, F.S.

CITY OF RIVERSIDE, CALIFORNIA  
DEPARTMENT OF PUBLIC WORKS

APPROVED BY *[Signature]* DATE 1-2-73  
OFFICE ENGINEER  
TRAFFIC DIVISION  
APPROVED BY *[Signature]* DATE 1-2-73  
DIRECTOR OF PUBLIC WORKS

IMPROVEMENTS  
**TWELFTH STREET**  
VICTORIA AVE. TO BERMUDA AVE.

PROJECT NO. **R-1644**  
SHEET **2** OF **2**  
FILE NO. **72-451**

HORIZ. SCALE 1" = 20' VERT. SCALE 1" = 10'