

Scale:
 Horiz. 1" = 40'
 Vert. 1" = 4'

CONST. & CURVE DATA

(A)	R = 500.00'
(B)	R = 500.00'
(C)	R = 500.00'
(D)	R = 500.00'
(E)	R = 500.00'
(F)	R = 500.00'
(G)	R = 500.00'
(H)	R = 500.00'
(I)	R = 500.00'
(J)	R = 500.00'
(K)	R = 500.00'
(L)	R = 500.00'
(M)	R = 500.00'
(N)	R = 500.00'
(O)	R = 500.00'
(P)	R = 500.00'
(Q)	R = 500.00'
(R)	R = 500.00'
(S)	R = 500.00'
(T)	R = 500.00'
(U)	R = 500.00'
(V)	R = 500.00'
(W)	R = 500.00'
(X)	R = 500.00'
(Y)	R = 500.00'
(Z)	R = 500.00'

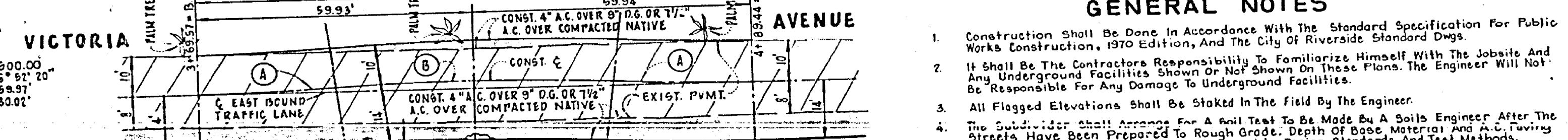

- GENERAL NOTES**
- Construction shall be done in accordance with the Standard Specification for Public Works Construction, 1970 Edition, and the City of Riverside Standard Dwg's.
 - It shall be the Contractor's responsibility to familiarize himself with the jobsite and any underground facilities shown or not shown on these plans. The Engineer will not be responsible for any damage to underground facilities.
 - All flagged elevations shall be staked in the field by the Engineer.
 - The Subdivider shall arrange for a soil test to be made by a soils engineer after the streets have been prepared to rough grade. Depth of base material and A.C. paving shall be determined by the City of Riverside Design Standards and Test Methods.
 - Trim Edge of Exist. Paving Where New Joins.
 - Install Street Name Signs Per City of Riverside Standard Drawing No. 662.
 - All Traffic Control Signs shall be installed prior to opening streets to traffic.

- NOTES:**
1. face of 48" Eucalyptus trees clear East Curb Return 16'.
 2. Palm trees to be relocated southerly of bridge trail as directed by Parks Department.

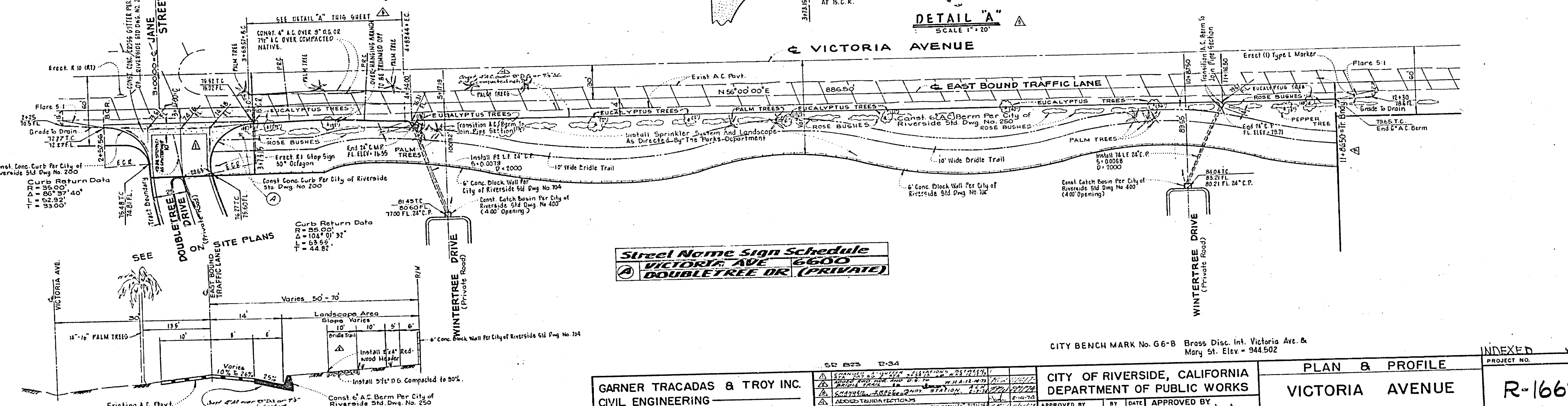
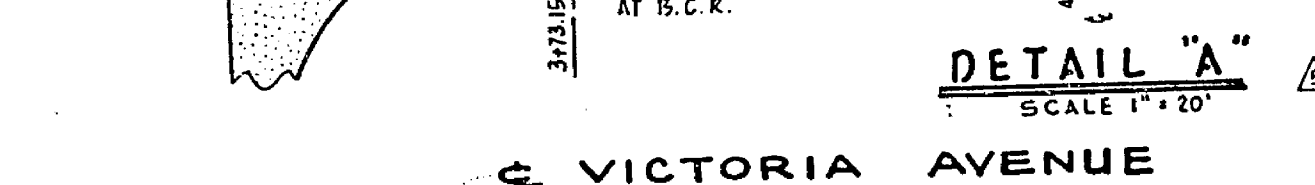

Street Name Sign Schedule
 VICTORIA AVE 6600
 DOUBLETREE DR (PRIVATE)

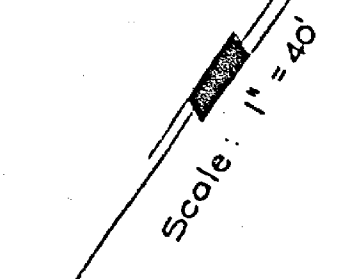

TYPICAL SECTION
 VICTORIA AVENUE
 No Scale

Frank Tracadas
 FRANK TRACADAS R.C.E. 11447

GARNER TRACADAS & TROY INC.
 CIVIL ENGINEERING
 LAND SURVEYING
 357 WEST SECOND STREET
 SAN BERNARDINO, CALIFORNIA

NO.	REVISIONS	DATE	BY	CHECKED BY
1	CHANGED ALIGNMENT OF A.C. CURB PER DETAIL 'A'	5/16/73	[Signature]	[Signature]
2	ADDED TRAFFIC CONTROL SIGNS	5/16/73	[Signature]	[Signature]
3	ADDED TRAFFIC CONTROL SIGNS	5/16/73	[Signature]	[Signature]
4	ADDED TRAFFIC CONTROL SIGNS	5/16/73	[Signature]	[Signature]
5	ADDED TRAFFIC CONTROL SIGNS	5/16/73	[Signature]	[Signature]

CITY BENCH MARK No. G6-B Brass Disc. Int. Victoria Ave. & Mary St. Elev. = 944.502

CITY OF RIVERSIDE, CALIFORNIA
 DEPARTMENT OF PUBLIC WORKS

INDEXED	PROJECT NO.
PLAN & PROFILE	R-1662
VICTORIA AVENUE	SHEET 1 OF 1
TRACT NO. 4702-1	FILE NO.
HORIZ. SCALE 1" = 40'	VERT. SCALE 1" = 4'