

TYPICAL SECTION - MAGNOLIA AVENUE
N.T.S.
T.I. - 7

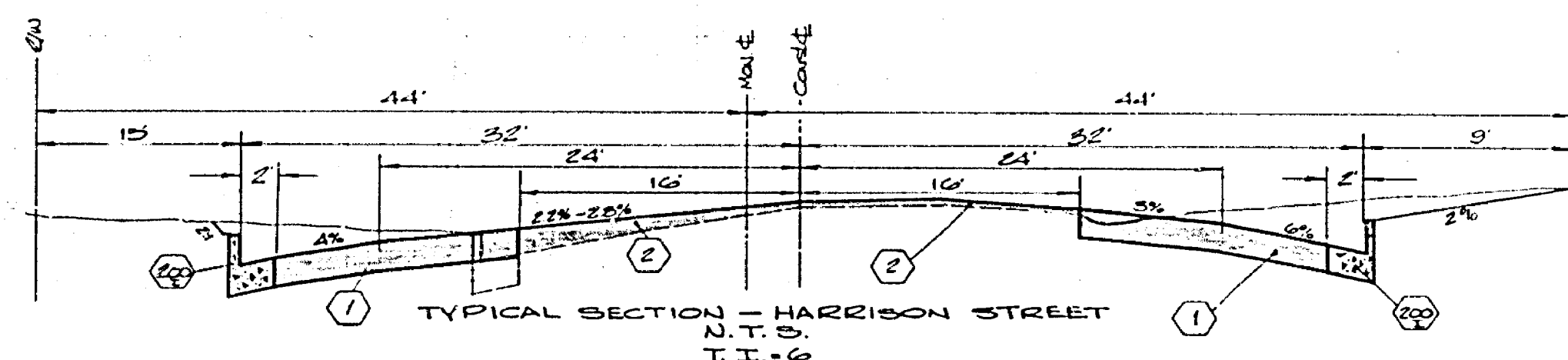

TYPICAL SECTION - HARRISON STREET
N.T.S.
T.I. - 6

GENERAL NOTES

1. THESE PLANS ARE FOR STREET CONSTRUCTION ONLY. STREET LIGHTS AND TRAFFIC SIGNALS SHALL BE LOCATED FROM THE ATTACHED SUBJECT PLANS (S-117).
2. CONSTRUCTION TO BE IN ACCORDANCE WITH STANDARD SPECIFICATIONS FOR PUBLIC WORKS CONSTRUCTION (1978 EDITION) AND CITY OF RIVERSIDE STANDARD SPECIFICATIONS.
3. THE CONTRACTOR SHALL BE RESPONSIBLE TO DEFINE OR REPLACE IN KIND AT HIS OWN EXPENSE ANY ITEMS DAMAGED BY HIS OPERATIONS DURING CONSTRUCTION.
4. WHERE NEW CONSTRUCTION IS INDICATED:
A. CURBS & SIDEWALKS
B. EXISTING DRIVEWAYS, RUES, GUTTERS, AND SIDEWALKS
5. LIMITS OF ENTRY HAVE BEEN OBTAINED FOR WORK SHOWN ON THESE PLANS.
6. CURBS AND GUTTERS, SIDEWALKS AND DRIVEWAY REMOVAL SHALL BE TO THE LIMITS SHOWN ON THE PLAN OR TO THE NEAREST CURB OR GUTTER BEYOND THE PLAN LIMITS AS DIRECTED BY THE SUPERVISOR.
7. WHERE NEW SIDEWALK OR DRIVEWAY MEETS OR REPLACES EXISTING SIDEWALK OR DRIVEWAY, JOINTS SHALL BE MATCHED TO EXISTING.
8. TRANSITION NEW CONSTRUCTION TO MEET EXISTING FACILITIES AS DIRECTED BY THE SUPERVISOR.
9. ALL WORK IN CONSTRUCTION AREA SHALL BE SUPERVISED BY CONTRACTORS EMPLOYED AS "HANDS ON" FOR THE PROJECT SHALL BE MAINTAINED & DEDICATED TO THE PROJECT.
10. ADJUST ALL MANHOLES WITHIN CONSTRUCTION AREA TO FINISH GRADE - EXCEPT THOSE SHOWN TO BE BUILT BY OTHERS.
11. ALL EXISTING WORK TO ORIGINAL CONDITION ON THE HOISTING SIDE.

- 200 II C&G ONLY PER STD DWS 200 THESE MARK OVER ARE
- 400 I CURBS AND GUTTERS PER STD DWS 200 TYPE II OF CURB FACE.
- 220 C&G'S - GUTTERS PER STD STD 12" WIDE.
- 300 DRIVEWAY APPROACH PER STD. 300.
- 304 WHEELCHAIR RAMP PER STD. 304
- 320 SIDEWALK PER STD. 320 AS SHOWN ON PLAN.
- 400 CATCH BASIN PER STD. 4" "W" AND "V" DIMENSIONS ARE SHOWN ON PLAN, EXCEPT "S" IS 4" OF OPENING.
- 1 CURBMENT STRUCTURAL SECTION OF 0.50' A.C. OVER NATIVE SOIL.
- 2 OVERLAY EXISTING A.C. PAVEMENT WITH A VARIABLE THICKNESS OF A.C. - MINIMUM OVERLAY TO BE 4" AT THE BACK OF SIDEWALK SHALL BE STICK PER STD. DWS 120.

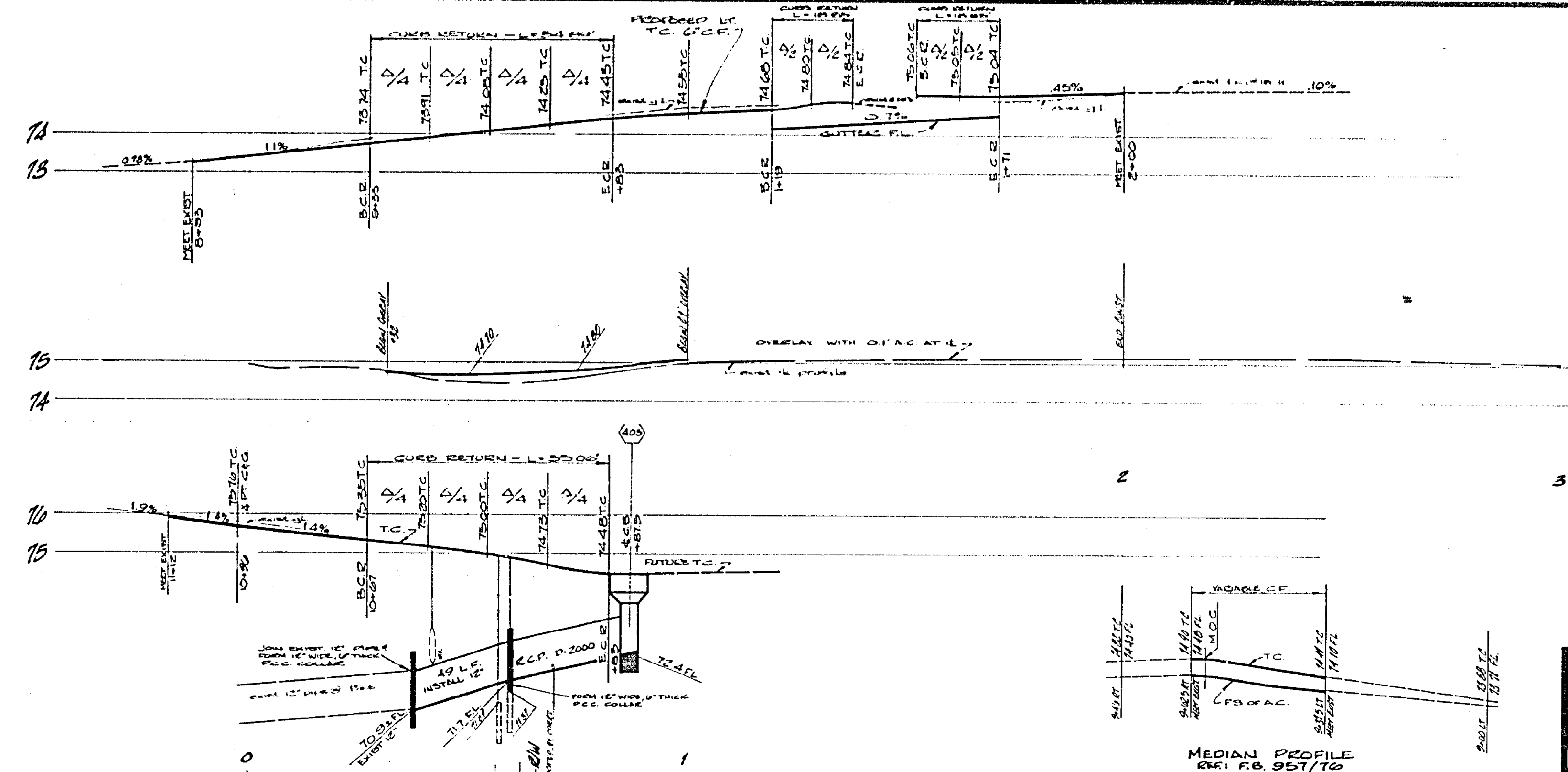

MEDIAN PROFILE
SEE: F.B. 957/70

F.B. : 951-42
T.B.M. : TOP OF F.H. ; 60' HEAD
BOIT STAMPED "C"
LOCATED MOST S.W.
COR. OF MAGNOLIA &
MUIE.
ELEV. : 779.004
ALIGNMENT : F.B. 975-67

- IRRIGATION LINES REPLACEMENT
- 1) CONTACT THE CITY IRRIGATION DIVISION & ONS. PRIOR TO WORKING ON IRRIGATION LINES AT 787-2411.
 - 2) THE IRRIGATION LINES MAY BE EMPTIED FOR ONLY THREE DAYS.
 - 3) CONTRACTOR TO ENSURE FL. OF IRRIGATION LINE, UNLESS THE FLOOD-LET MEET POINT IS DETERMINED. THE ELEVATIONS BEFORE REPAIRS OR GRADE CHECKS.
 - 4) FORM CONCRETE COLLARS WHERE NEW IR. IRRIGATION LINE MEETS EXIST. IR. IRRIGATION LINE.

CURB RETURN DATA			
RADIUS	ANGLE	TANGENT	LENGTH
① 35.0'	90°08'35"	35.08'	35.00'
② 35.0'	89°51'25"	34.91'	34.89'
③ 12.0'	90°00'00"	12.00'	18.85'

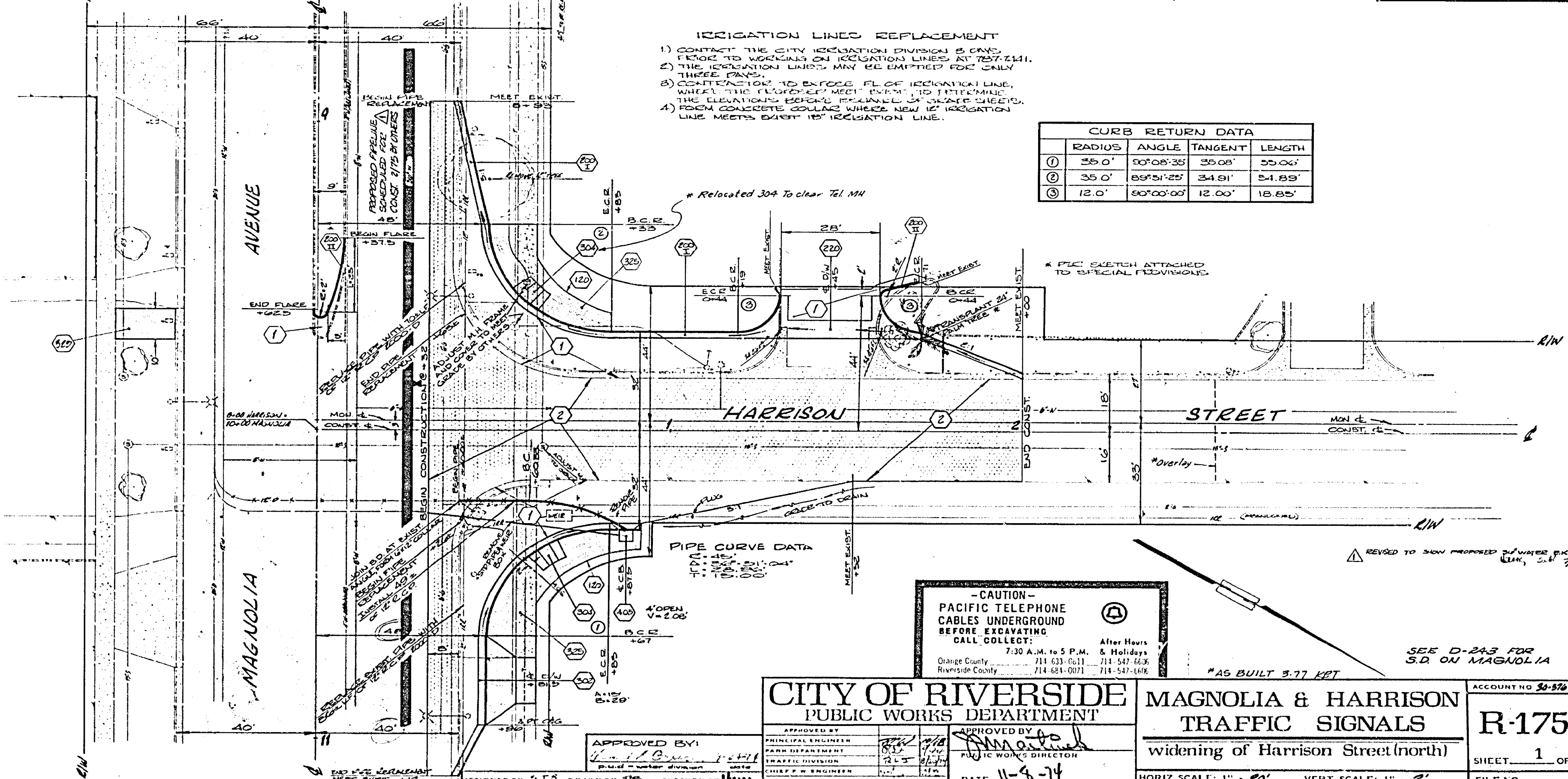

- CAUTION -
PACIFIC TELEPHONE
CABLES UNDERGROUND
BEFORE EXCAVATING
CALL COLLECT:
7:30 A.M. to 5 P.M. & Holidays
Orange County 714-633-6611 714-547-6636
Riverside County 714-684-0071 714-547-6496

CITY OF RIVERSIDE
PUBLIC WORKS DEPARTMENT

MAGNOLIA & HARRISON
TRAFFIC SIGNALS
widening of Harrison Street (north)

APPROVED BY: *[Signature]*
DESIGNED BY: J.J. DRYAN BY: J.C. CHECKED BY: *[Signature]*

DATE: 11-8-74

HORIZ. SCALE: 1" = 20' VERT. SCALE: 1" = 2'

ACCOUNT NO: 30-570-508
R-1757
SHEET 1 OF 1
FILE NO.