

- CONSTRUCT PER CITY OF RIVERSIDE STANDARD DRAWINGS:**
- 200 CURB AND GUTTER PER STD. DWG. 200, TYPE I, WITH 6" CURB FACE.
 - 302 DRIVEWAY APPROACH PER STD. DWG. 302 (MODIFIED), TYPE III BOMANITE SURFACE, COLOR: LA CRESCENTA BROWN, A-25, NO PATTERNS.
 - 325 SIDEWALK PER STD. DWG. 325 (MODIFIED) WITH DIMENSIONS SHOWN ON PLAN AND TYPICAL SECTIONS. BOMANITE SURFACE. COLOR: SHALL BE LA CRESCENTA BROWN, A-25; PATTERN: BOMANITE 6" x 6" SQUARE TILE.
 - 405 CATCH BASIN PER STD. DWG. 405, "W" AND "V" DIMENSIONS SHOWN ON PLAN, STATION IS E. OF OPENING. TOP SURFACE TO MATCH SIDEWALK SURFACE (BOMANITE).
-
- 1 OVERLAY EXISTING A.C. PAVEMENT WITH A VARIABLE THICKNESS OF ASPHALT CONCRETE.
 - 2 CONSTRUCT STRUCTURAL SECTION OF 0.30' FULL DEPTH A.C. OR 0.45' A.C. OVER 0.90' D.G. BASE.
-
- CLASS I 6" TO 18" DIA.
CLASS II OVER 18" TO 36" DIA.
CONTINGENCY ITEM 1: REMOVE AND DISPOSE TREES
CONTINGENCY ITEM 2: TRANSPLANT TREES TO CANYON CREST AREA AS FOLLOWS: 2 TREES TO CENTRAL & CANYON CREST (IN MEDIUM) 1 TREE TO 4979 CHAPALA (IN PARKWAY)
CLASS IS SHOWN ON PLAN.

RIVERSIDE CALIFORNIA



PUBLIC WORKS DEPARTMENT

TENTH STREET WIDENING

AT CITY HALL

TRAFFIC INDEX: 7

LENGTH OF PROJECT: 467 FT = 0.09 MILE

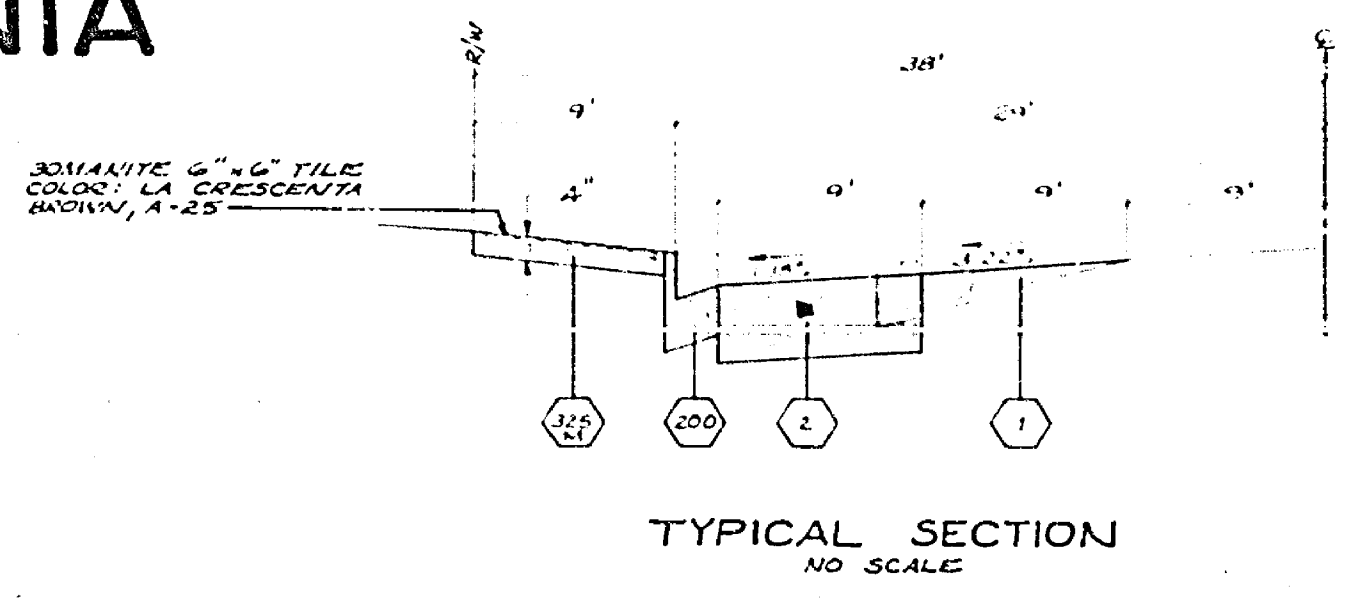

EXISTING CULTURE AND UNDERGROUND LEGEND

EXISTING UNDERGROUND UTILITIES

SANITARY SEWER	8" S	TELEPHONE CONDUIT	T	T
WATER LINE	6" W	ELECTRICAL CONDUIT	E	E
STORM DRAIN	24" D	STREET LIGHTING	SL	SL
IRRIGATION LINE	20" IRR	TRAFFIC SIGNAL	TSD	SDB
GAS LINE	8" G	FIRE ALARM	F	F

EXISTING TOPOGRAPHY

CONCRETE	ASPHALT	EDGE OF PAVEMENT	BUILDING	UNDERGROUND STRUCTURE	OVERHANGING STRUCTURE
POWER POLE	GUY POLE	RAILROAD TRACKS	RAILROAD SIGN	RAILROAD SIGNAL	STREET LIGHT (UPRIGHT)
TRAFFIC SIGN	PARKING METER	FIRE ALARM BOX	STREET NAME SIGN	GAS METER	MAIL BOX
WATER METER	FIRE HYDRANT	SPRINKLER HEAD	VALVE	RAILROAD TRACKS	RAILROAD SIGN
RAILROAD TRACKS	RAILROAD SIGN	RAILROAD SIGNAL	STREET LIGHT (UPRIGHT)	STREET LIGHT	TRAFFIC SIGNAL
TRAFFIC SIGNAL	TRAFFIC SIGNAL ON MAST ARM	TRAFFIC SIGNAL BOX	TRAFFIC SIGNAL DETECTOR	REGISTRATION CONTROL FOR TRAFFIC SIGNAL	

GENERAL CONSTRUCTION NOTES

- CURB, GUTTER AND SIDEWALK REMOVAL SHALL BE TO THE NEAREST CONSTRUCTION JOINT AT OR BEYOND LIMITS SHOWN ON PLAN.
- TRANSITION NEW CONSTRUCTION TO MEET EXISTING FACILITIES AS DIRECTED BY THE INSPECTOR.
- EXISTING UTILITIES SHOWN ON THIS PLAN, ARE PLOTTED FROM UTILITY RECORDS. THE CONTRACTOR IS REQUIRED TO TAKE DUE PRECAUTIONARY MEASURES TO LOCATE AND PROTECT ALL UTILITIES WHETHER OR NOT SHOWN ON THIS PLAN. IF THE COVER OF A UTILITY IS KNOWN IT IS SHOWN IN THE PROFILE. UTILITIES SHOWN IN THE PROFILE AS THIS COVER IS UNKNOWN, BUT THE UTILITY IS NOT EXPECTED TO CONFLICT WITH IMPROVEMENTS.
- THE CONTRACTOR SHALL BE RESPONSIBLE TO REPAIR OR REPLACE IN KIND AT HIS OWN EXPENSE ANY IMPROVEMENTS DAMAGED BY HIS OPERATIONS DURING CONSTRUCTION.
- ADJUST CLEANOUT MANHOLE TO FINISH GRADE.
- SEE PLAN X-112 FOR TRAFFIC SIGNAL AND STREET LIGHT MODIFICATIONS.

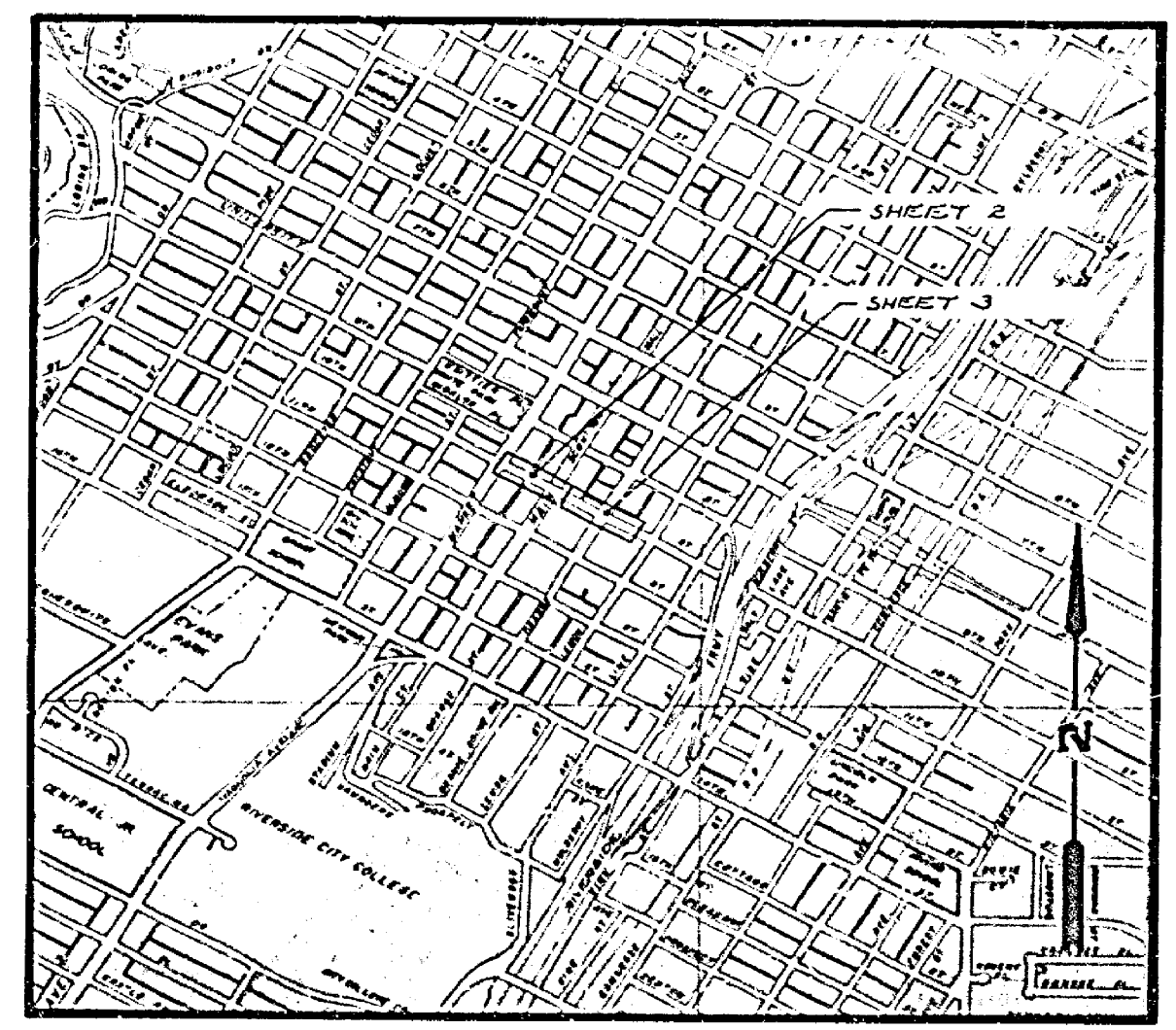

PROJECT LOCATION PLAN

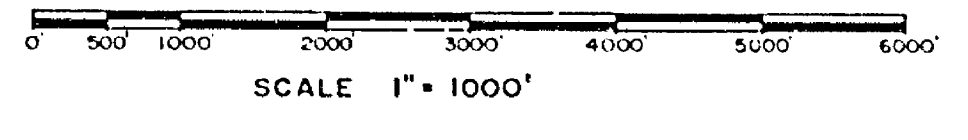

-CAUTION- PACIFIC TELEPHONE CABLES UNDERGROUND BEFORE EXCAVATING

CALL COLLECT:

7:30 A.M. to 5 P.M. & Weekdays
 Orange County 714-837-1811 714-837-1824
 Riverside County 714-888-0271 714-887-8828
 San Diego County 714-884-0271 714-887-8828
 San Bernardino County 714-884-0271 714-887-8828
 San Mateo County 214-821-3111 714-887-8828
 San Jose County 314-821-3111 714-887-8828
 San Diego County 714-794-0271 714-231-0271

FOR FREE CABLE LOCATING SERVICE

CITY OF RIVERSIDE, CALIFORNIA PUBLIC WORKS DEPARTMENT		Tenth Street Widening At City Hall		ACCOUNT NO. 18-515-210-01 DRAWING NUMBER R-1783 SHEET 1 OF 3
DESIGNED BY	DRAWN BY	CHECKED BY	DATE	

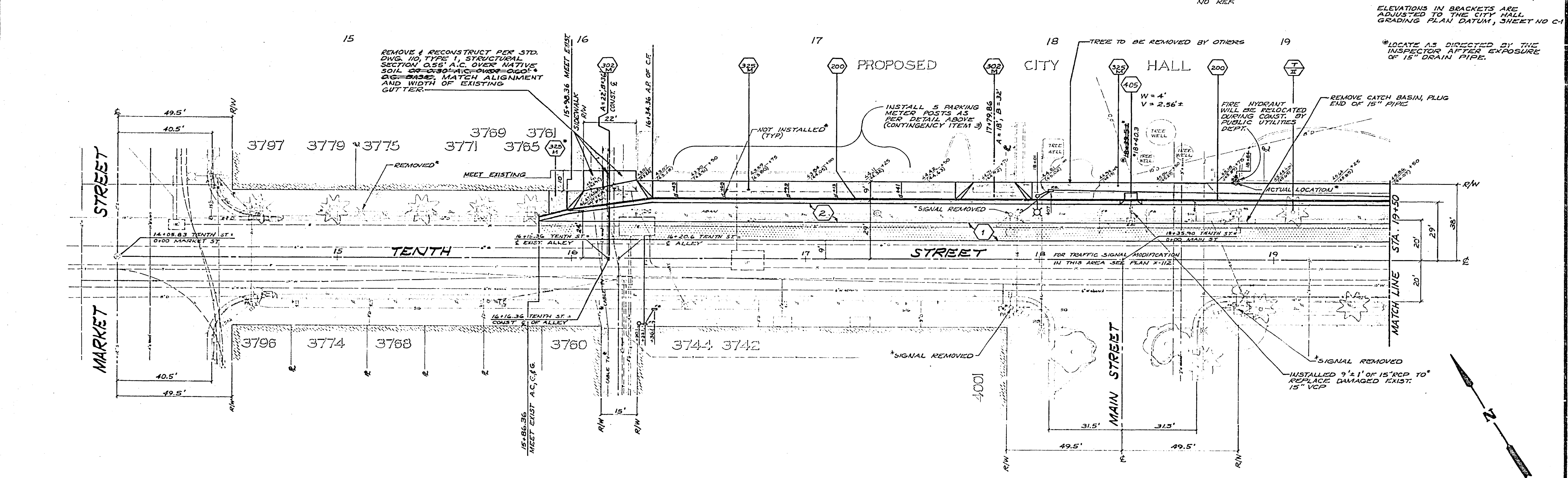
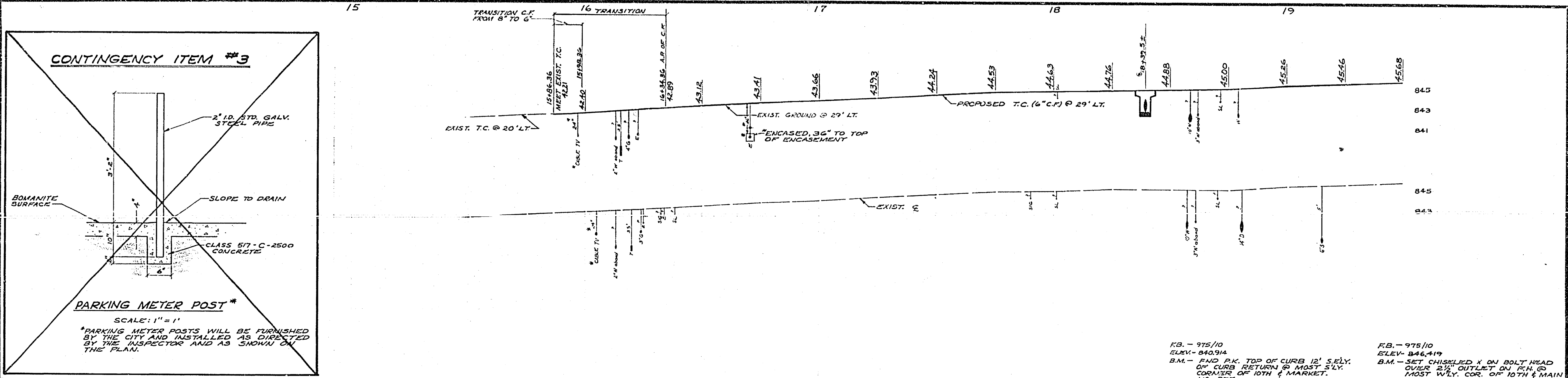

FB - 975/10
 ELEV - 840.914
 B.M. - END P.K. TOP OF CURB 12' S.E.L.Y. OF CURB RETURN @ MOST S.L.Y. CORNER OF 10TH & MARKET. NO REF.

FB - 975/10
 ELEV - 846.419
 B.M. - SET CHISELED X ON BOLT HEAD OVER 2 1/2\"/>

REMOVE & RECONSTRUCT PER STD. DIVS. 110 TYPE 1, STRUCTURAL SECTION 0.55' A.C. OVER NATIVE SOIL OR 1.30' A.C. OVER 0.60' 2\"/>

INSTALL 5 PARKING METER POSTS AS PER DETAIL ABOVE (CONTINGENCY ITEM 3)

FIRE HYDRANT WILL BE RELOCATED DURING CONST. BY PUBLIC UTILITIES DEPT.

LOCATE AS DIRECTED BY THE INSPECTOR AFTER EXPOSURE OF 15\"/>

CITY OF RIVERSIDE PUBLIC WORKS DEPARTMENT		Tenth Street Widening At City Hall		ACCOUNT NO 30-575-270-07 R-1783 SHEET 2 OF 3 FILE NO.
APPROVED BY: [Signature] DATE: 1-23-11	DESIGNED BY: [Signature] DRAWN BY: [Signature] CHECKED BY: [Signature]	HORIZ. SCALE: 1" = 20' VERT. SCALE: 1" = 4'		

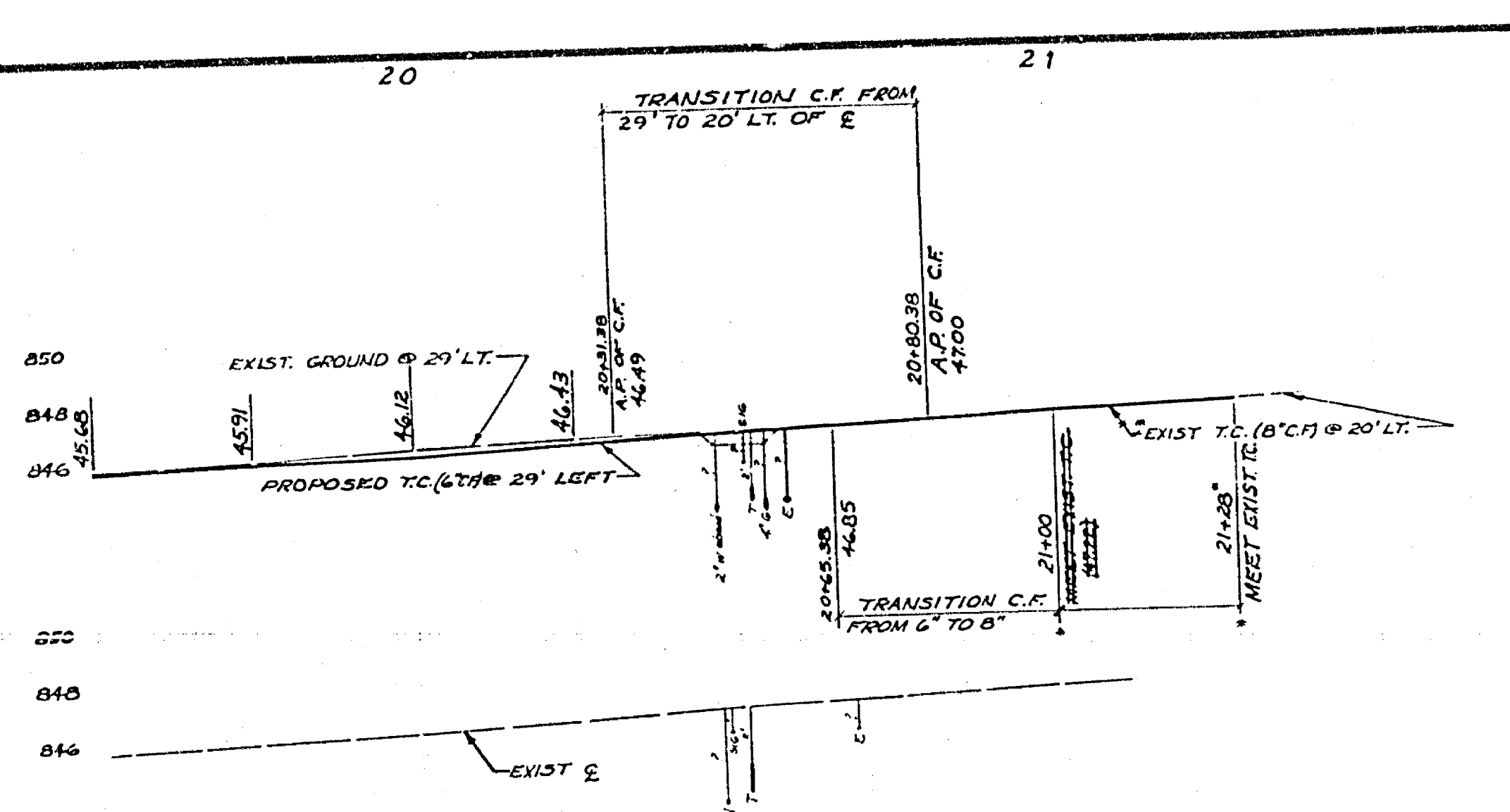

F.B. - 915/10
 ELEV. - 848.074
 B.M. - FID. SPIKE & LEAD TOP OF CURB TO 3' WLY. OF S'LY. LINE OF 10TH @ MOST W'LY. COR. 10TH & ORANGE. ELEV. = 848.28 PER F.B. 93/25 (CITY HALL SITE)

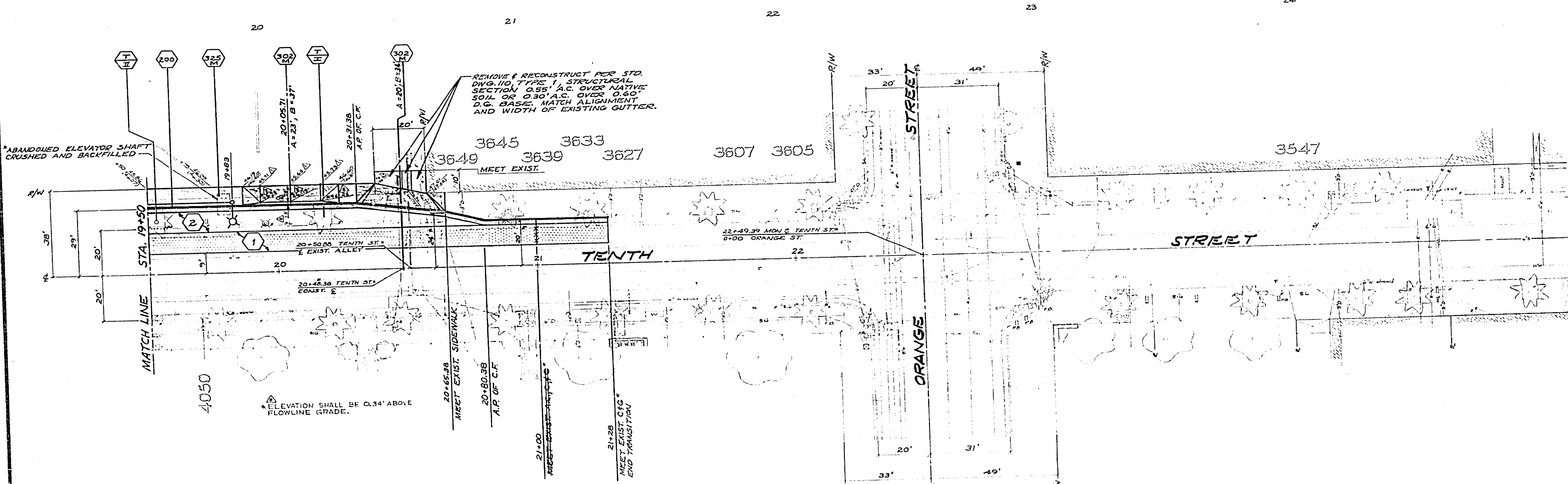

REVISIONS 1. REVISED D/W APP. ELEV. @ 20+05.71 2. REVISED D/W APP. ELEV. @ 20+05.71	CITY OF RIVERSIDE PUBLIC WORKS DEPARTMENT	Tenth Street Widening At City Hall	R-1783 SHEET 3 OF 3 FILE NO.
APPROVED BY DATE 1-25-07	APPROVED BY DATE 1-25-07	HORIZ. SCALE: 1" = 20' VERT. SCALE: 1" = 4'	AS BUILT 11-4-78