

CONSTRUCTION NOTES

- CONSTRUCTION TO BE IN ACCORDANCE WITH STANDARD SPECIFICATIONS FOR PUBLIC WORKS CONSTRUCTION HIS EDITION/ CITY OF RIVERSIDE ATTACHED DRAWINGS.
- WHERE NEW CONSTRUCTION IS INDICATED:
 - GRADE AND SLOPE
 - REMOVE EXISTING DRIVEWAY & PAVEMENT AS SHOWN
 - REMOVE THE TREES IN AREA OF CONSTRUCTION AND EXISTING AND RE-PLANT IN THE PLACE.
- THE CONTRACTOR SHALL BE RESPONSIBLE TO REPAIR OR REPLACE IN KIND AT HIS OWN EXPENSE ANY IMPROVEMENTS, IRRIGATION PIPELINES OR FENCES REMOVED OR DAMAGED BY HIS OPERATIONS DURING CONSTRUCTION.
- TRAFFIC SIGNALS, DRIVEWAY CONSTRUCTION SHALL BE MAINTAINED BY THE CONTRACTOR AND RELOCATED AS DESCRIBED IN THE DRAWINGS.
- TRANSFER NEW CONSTRUCTION TO EXISTING FACILITIES AS DIRECTED BY THE INSPECTOR.
- ALL ELEVATIONS SHOWN ON THE PLAN SHALL BE STAKED IN THE FIELD.
- RELOCATE OR REMOVE POLES, W/ KIDS, WHERE REQUIRED ON PLAN.
- FOR SEAL SHALL BE APPLIED OVER OLD & NEW PAVEMENT TO LIMITS SHOWN ON PLAN.
- THE PROPOSED TELEPHONE WORK IS SCHEDULED TO BE COMPLETED BEFORE THE END OF JAN. 1975.
- EXACT DEPTH OF UNDERGROUND UTILITIES MARKED ARE UNKNOWN. THE LOCATIONS AND DEPTHS SHOWN ON THE PLAN ARE FROM UTILITY RECORDS. THE CONTRACTOR IS REQUIRED TO TAKE THE PRECAUTIONARY MEASURES TO LOCATE AND PROTECT ALL UNDERGROUND FACILITIES.

CONSTRUCTION LEGEND

- (1) ASPHALT CONCRETE BERM PER STD. DWA 200, TYPE I WITH DEPRESSION TO 600' AT DRIVEWAYS.
- (2) CONSTRUCT STRUCTURAL SECTION OF 0.00' ASPHALT CONCRETE OVER NATIVE SOIL.
- (3) OVERLAY EXIST. A.C. PAVEMENT WITH A VARIABLE THICKNESS OF ASPHALT CONCRETE.
- (4) REPLACE OR REPAIR DRIVEWAY TO AREAS AND MATERIALS SHOWN ON THE PLAN. A.C. OF THK. SH. 2".
- (5) REPAIR BANK AS SHOWN ON PLAN.

E.P. CUEVE DATA

R. 25	1.5%
A. 1.5%	1.5%
L. 1.5%	1.5%
T. 25	1.5%

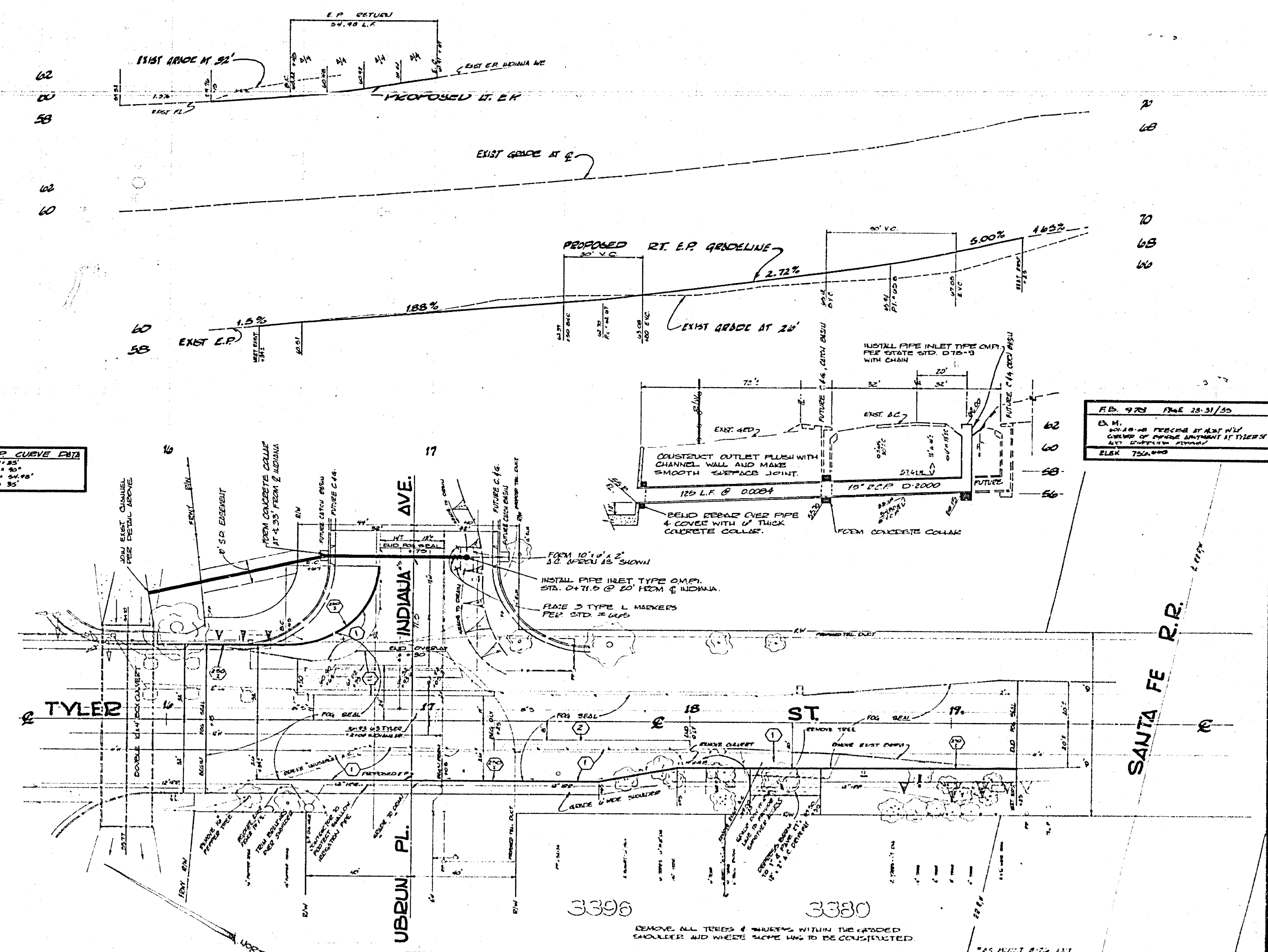
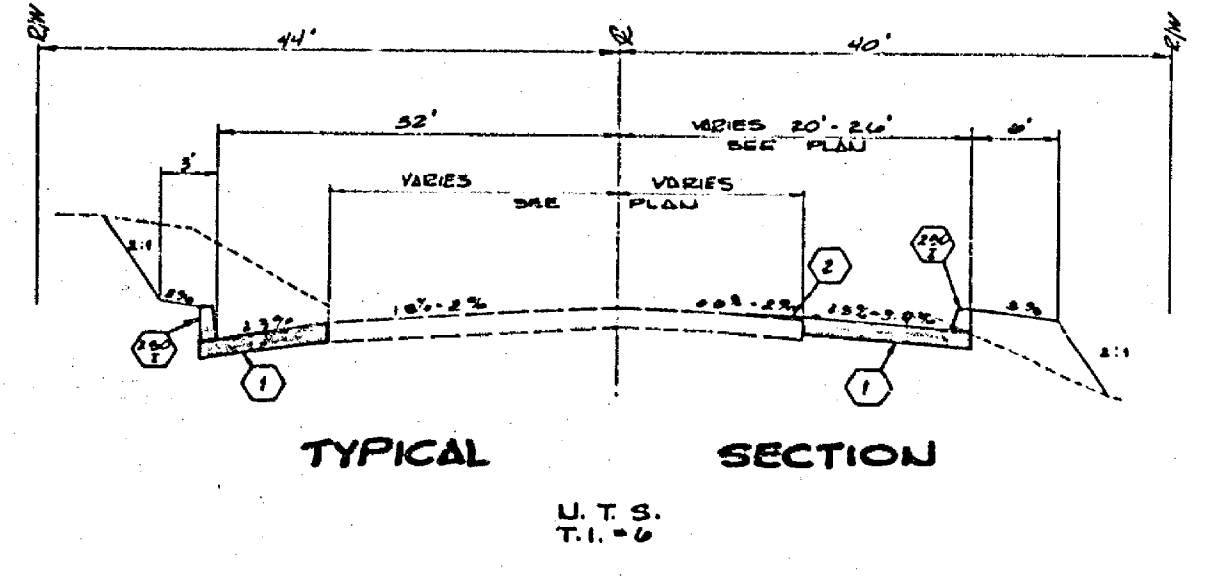

FILE NO. 973 PAGE 28-31/30
 E.P. CUEVE
 CIVIL ENGINEER
 LICENSE NO. 12544

CAUTION - PACIFIC TELEPHONE CABLES UNDERGROUND BEFORE EXCAVATION CALL COLLECT: Orange County 710-433-7611 Riverside County 710-544-0011	CITY OF RIVERSIDE PUBLIC WORKS DEPARTMENT DATE 1-13-75	TYLER STREET WIDENING PROJECT NO. 1793 SHEET 1 OF 1
	HORIZ. SCALE 1" = 30' VERT. SCALE 1" = 4'	SANTA FE R.R.