

RIVERSIDE CITY OF RIVERSIDE CALIFORNIA



PUBLIC WORKS DEPARTMENT

Victoria Avenue Bikeway

Van Buren Blvd. to Myrtle Ave.

Project Length: 5.5 Miles (29,040')

CONSTRUCTION LEGEND

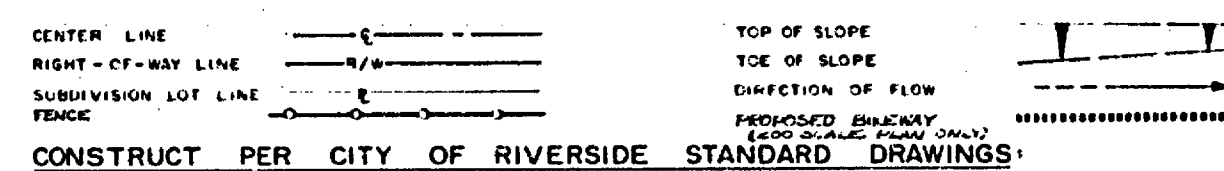

CONSTRUCT PER CITY OF RIVERSIDE STANDARD DRAWINGS

- 1 CONSTRUCT STRUCTURAL SECTION PER THE FOLLOWING SCHEDULE:
2 1/2 INCHES A.C. EXCEPT AT DRIVEWAYS AND ACCESS POINTS
5 INCHES A.C. AT DRIVEWAYS AND ACCESS POINTS AS SHOWN ON PLAN
OR AS DIRECTED BY THE INSPECTOR.
COMPACT TOP 6 INCHES OF ALL SUBGRADE TO 95% RELATIVE
COMPACTION.
- 200 CURB AND GUTTER PER STD. DWG. 200, TYPE I.
- 250 ASPHALT CONCRETE BORDA PER STD. DWG. 250, TYPE I, WITH
DEPRESSION TO 6.08 AT BIKEWAY.

- 20 REMOVE ENTIRE TREE.
- 2 POWER POLES AND ANCHORS SHALL BE MODIFIED OR
RELOCATED BY OTHERS.
POLE USED BY MORE THAN ONE UTILITY
- 3 CONSTRUCT STRUCTURAL SECTION PER ACCESS DETAIL, SHEET 2.
"A" DISTANCE IS SHOWN ON PLAN.
- 900 CHAIN LINK FENCE FOR STD. DWG. 900 (MODIFIED). DO NOT INSTALL
3-WIRE RGH AND CAP OR ANY BARBED WIRE. ALL POSTS
SHALL BE CAPPED. EXACT LOCATION OF FENCE SHALL BE
DETERMINED IN FIELD BY THE INSPECTOR.

GENERAL CONSTRUCTION NOTES

- 1 THE RADII SHOWN ON THE BIKEWAY ALIGNMENT ARE FOR
INFORMATION ONLY AND ARE NOT REQUIRED TO BE STAKED
- 2 THE CONTRACTOR SHALL BE RESPONSIBLE TO REPAIR OR
REPLACE IN KIND, AT HIS OWN EXPENSE, ANY
IMPROVEMENTS DAMAGED BY HIS OPERATIONS DURING
CONSTRUCTION.
- 3 RIGHTS OF ENTRY HAVE BEEN OBTAINED FOR WORK
ON PRIVATE PROPERTY.
- 4 TRAFFIC SIGNS REMOVED DURING CONSTRUCTION SHALL
BE RELOCATED AS DIRECTED BY THE INSPECTOR.
- 5 CURB AND GUTTER REMOVAL SHALL BE TO THE LIMITS
SHOWN ON THE PLAN OR TO THE NEAREST
CONSTRUCTION JOINT BEYOND THE PLAN LIMITS AS
DIRECTED BY THE INSPECTOR.
- 6 UNLESS OTHERWISE NOTED ON THE PLAN: ALL FILL SLOPES
ARE 2:1; SLOPES LESS THAN 2:1 HIGH ARE NOT
NECESSARILY SHOWN ON THE PLAN; ALL CUT SLOPES
LESS THAN 2:1 HIGH ARE 3:1; CUT SLOPES 2:1 HIGH OR
HIGHER ARE 1 1/2:1.
- 7 TRANSITION NEW CONSTRUCTION TO MEET EXISTING
FACILITIES AS DIRECTED BY THE INSPECTOR, EXCEPT
WHERE SHOWN OTHERWISE ON THE PLAN.
- 8 ALL ELEVATIONS SHOWN ON THE PLAN SHALL BE
STAKED IN THE FIELD.
- 9 REGRADE ALL DRIVEWAYS AND GROVE ROADS AS
NECESSARY TO RESTORE THEM TO THEIR ORIGINAL
DRIVING CONDITION.
- 10 THE COMPLETED BIKEWAY SHALL HAVE A NEAT, SMOOTH
SURFACE AND CARE SHALL BE EXERCISED TO AVOID
CREATING DRAINAGE POCKETS.

EXISTING UNDERGROUND & TOPOGRAPHY LEGEND

EXISTING UNDERGROUND UTILITIES

EXISTING SEWER	12"	TELEPHONE	12"
EXISTING WATER	12"	TELEPHONE	12"
EXISTING GAS	12"	TELEPHONE	12"
EXISTING CABLE	12"	TELEPHONE	12"
EXISTING LIGHT	12"	TELEPHONE	12"
EXISTING FIBER	12"	TELEPHONE	12"

EXISTING TOPOGRAPHY

EXISTING WALL	12"	EXISTING CURB	12"
EXISTING BOARD FENCE	12"	EXISTING GUTTER	12"
EXISTING WIRE FENCE	12"	EXISTING DRIVEWAY	12"
EXISTING MAIL FENCE	12"	EXISTING BIKEWAY	12"

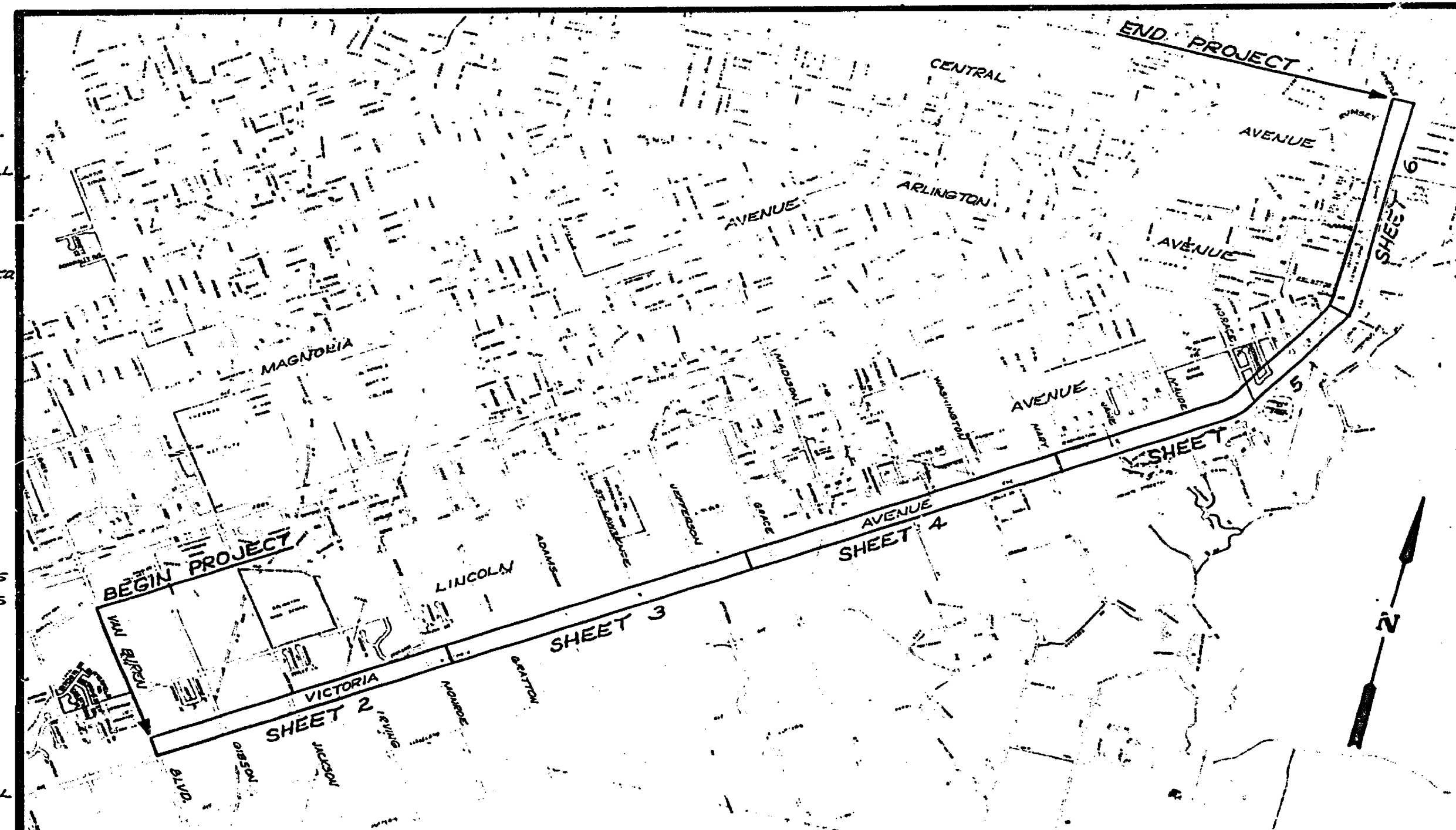

PROJECT LOCATION PLAN

0' 800' 1600' 2400' 3200' 4000' 4800' 5600' 6400'

SCALE 1" = 1600'

CAUTION
PACIFIC TELEPHONE
CABLES UNDERGROUND
BEFORE EXCAVATING
CALL COLLECT:
7:30 A.M. to 5 P.M. & Holidays
714 933-2311 - 714 933-1518
Orange County 714 933-7021 - 714 933-6636

CITY OF RIVERSIDE
PUBLIC WORKS DEPARTMENT
DRAWN BY: [Signature]
CHECKED BY: [Signature]
DATE: 11-26-15

**Victoria Avenue
Bikeway**
Van Buren to Myrtle

ACCOUNT NO. 18-335-342-181
DRAWING NUMBER
R-1821
SHEET 1 OF 6

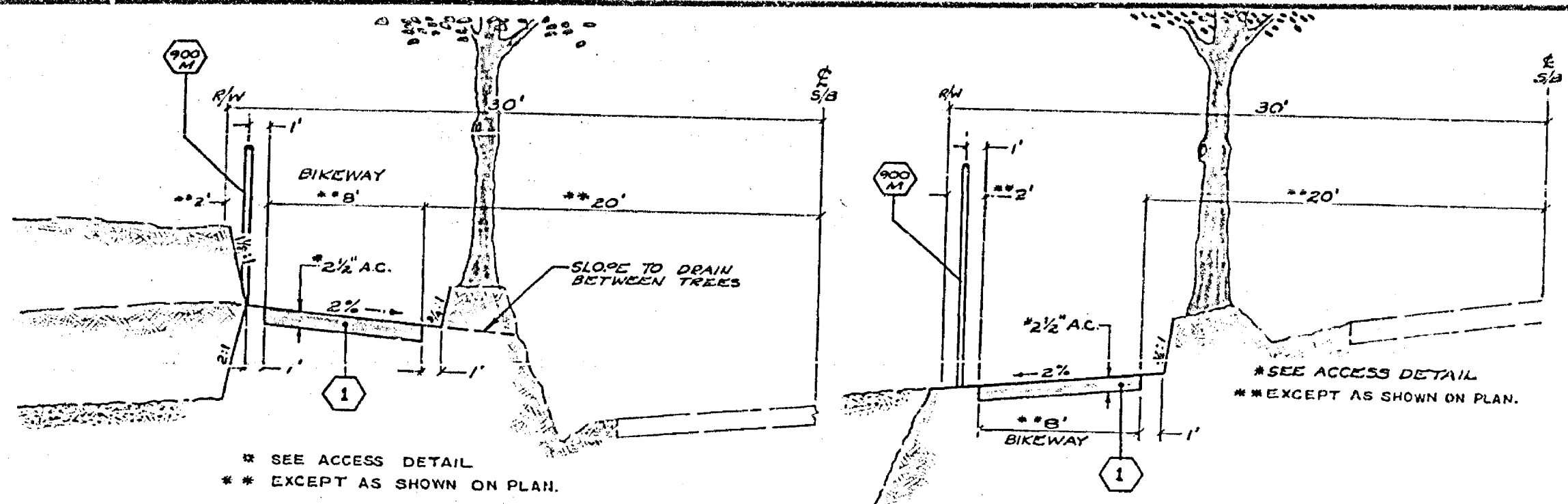

TYPICAL SECTION

SCALE: HOR. 1"=5', VERT. 1"=1'

23+61.77	TO	30+50
40+24	TO	50+87.22
79+24	TO	108+86
143+50	TO	145+22.42
173+48.07	TO	187+08.42
198+69	TO	200+69.10
295+27.42	TO	297+29.42

TYPICAL SECTION

SCALE: HOR. 1"=5', VERT. 1"=1'

10+00	TO	23+61.77
30+50	TO	40+24
50+87.22	TO	79+24
108+86	TO	143+50
145+22.42	TO	173+48.07
187+08.42	TO	198+69
200+69.10	TO	200+69.10
200+69.10	TO	223+04.42
233+04.42	TO	243+24.22
250+60+2	TO	264+11
285+41.04	TO	295+29.42

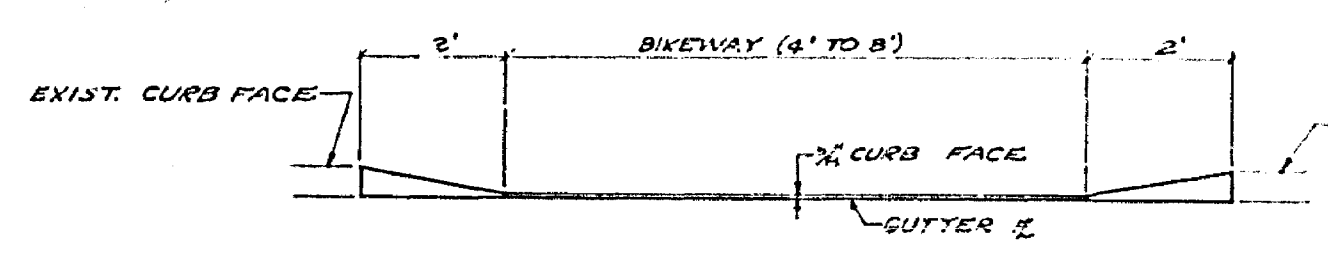

CURB DEPRESSION DETAIL

NOTE: SEE ALSO STD. DWG. 303
SCALE: 1"=2'

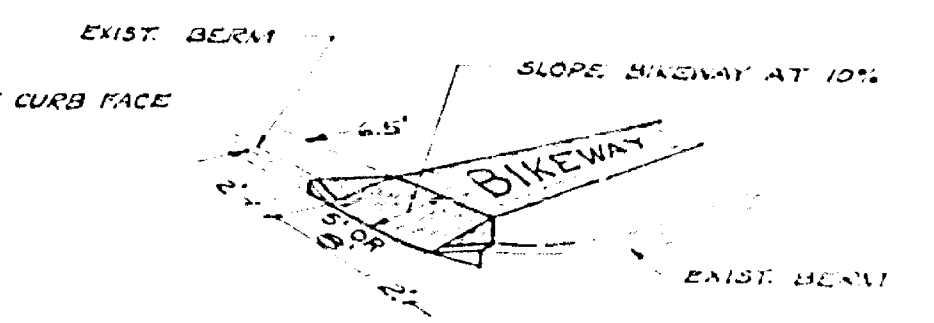

BERM DEPRESSION DETAIL

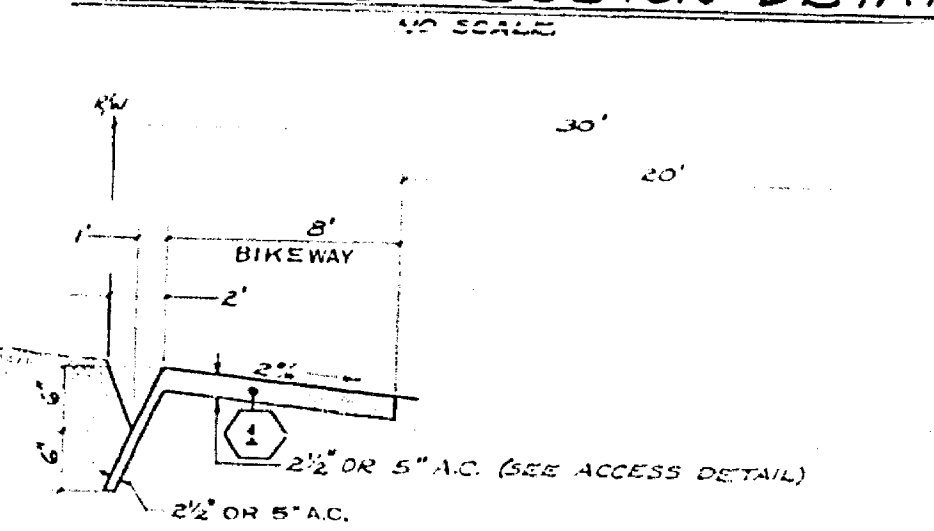

BIKEWAY PROTECTION DETAIL

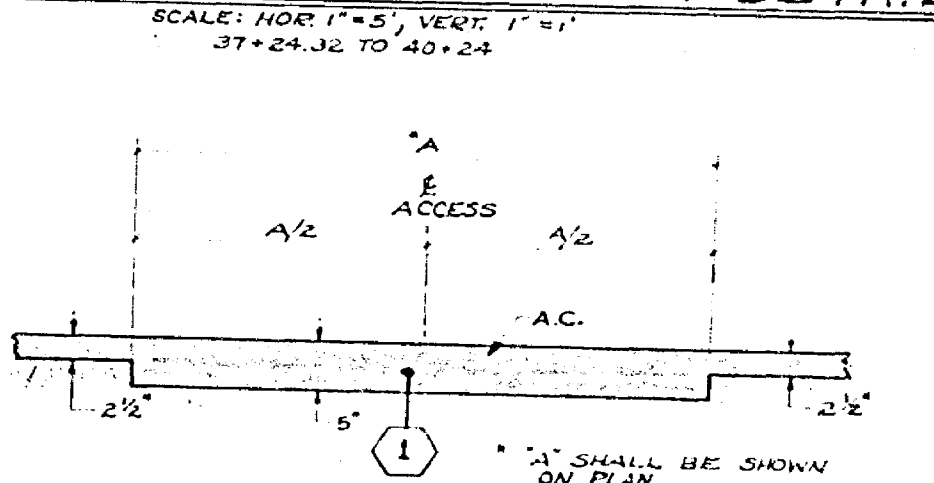

ACCESS DETAIL

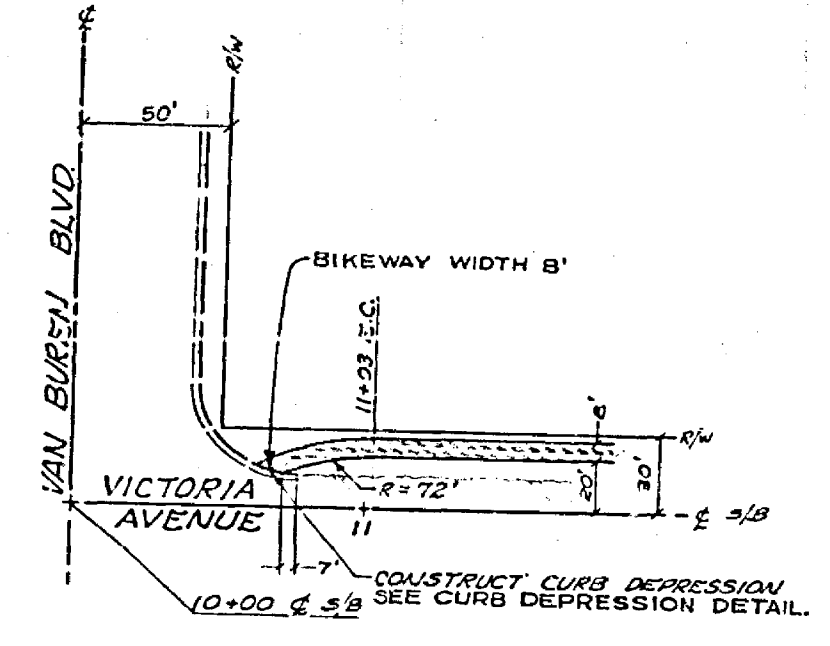

DETAIL 2A

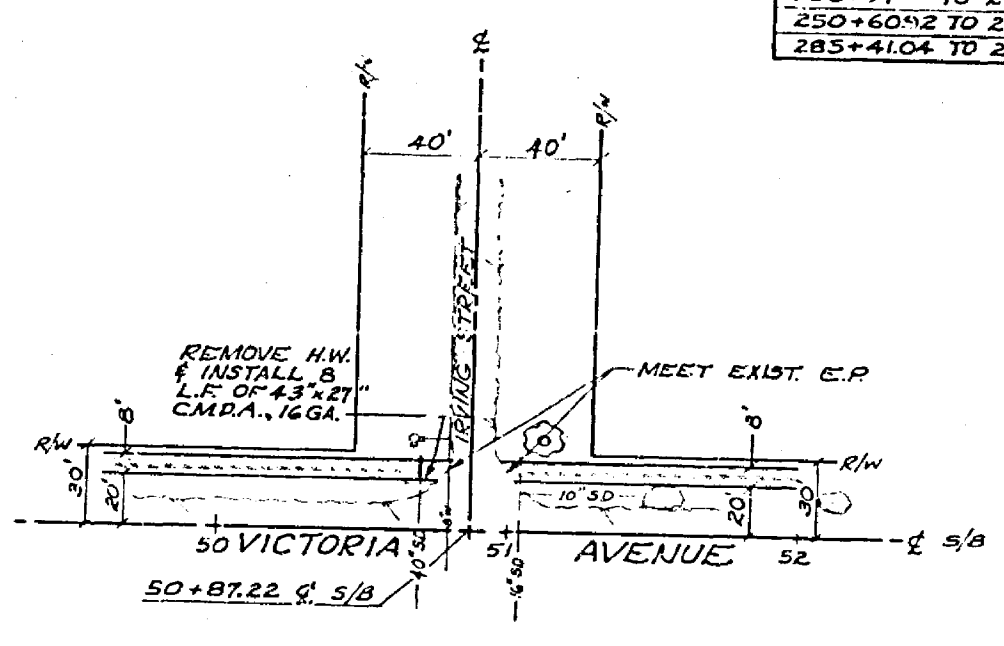

DETAIL 2B

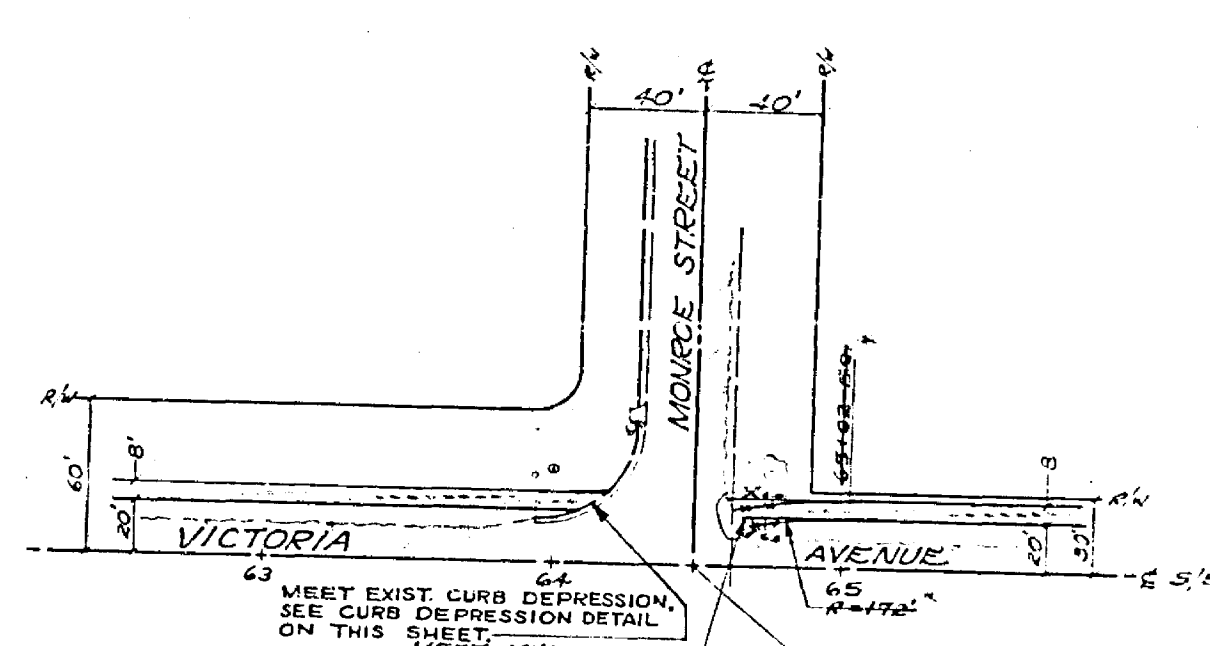

DETAIL 2C

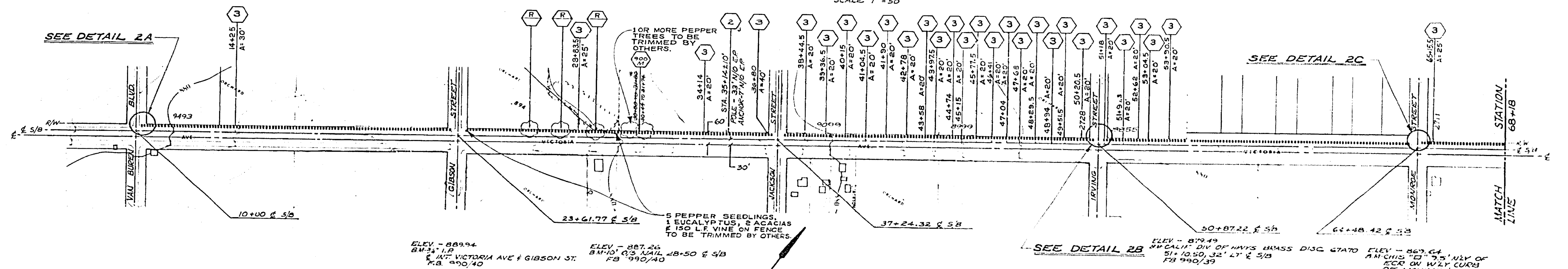

- CAUTION -
PACIFIC TELEPHONE
CABLES UNDERGROUND
BEFORE EXCAVATING
CALL COLLECT

CITY OF RIVERSIDE
PUBLIC WORKS DEPARTMENT

Victoria Avenue
Bikeway
Van Buren to Myrtle

R-1821

DATE: 11-26-15

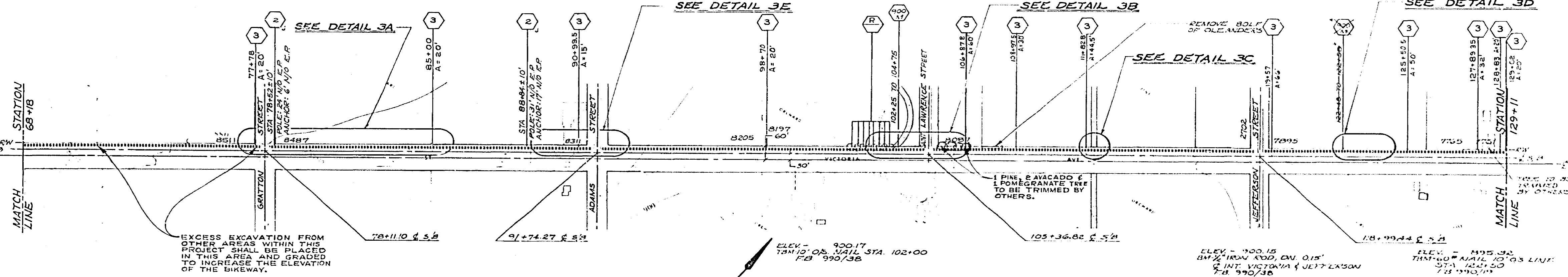
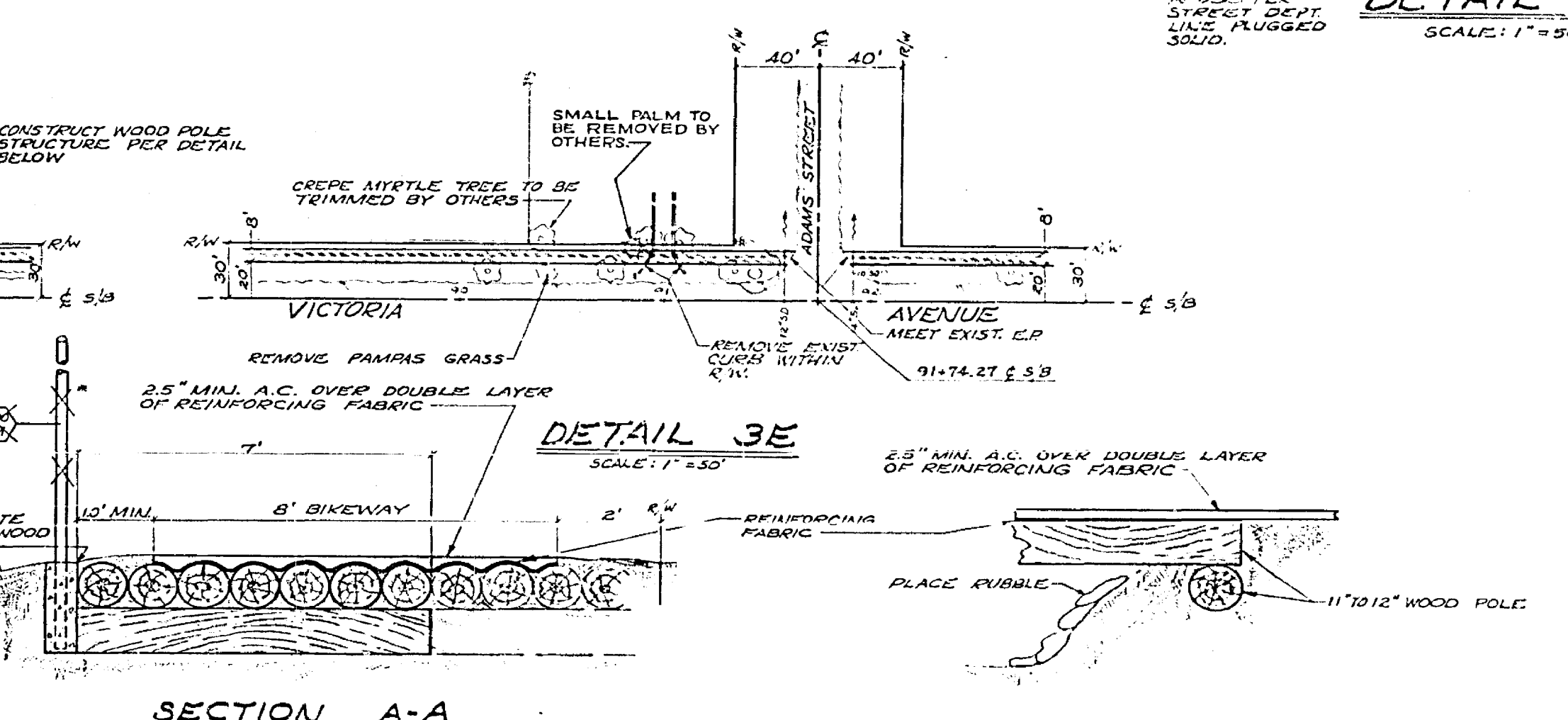
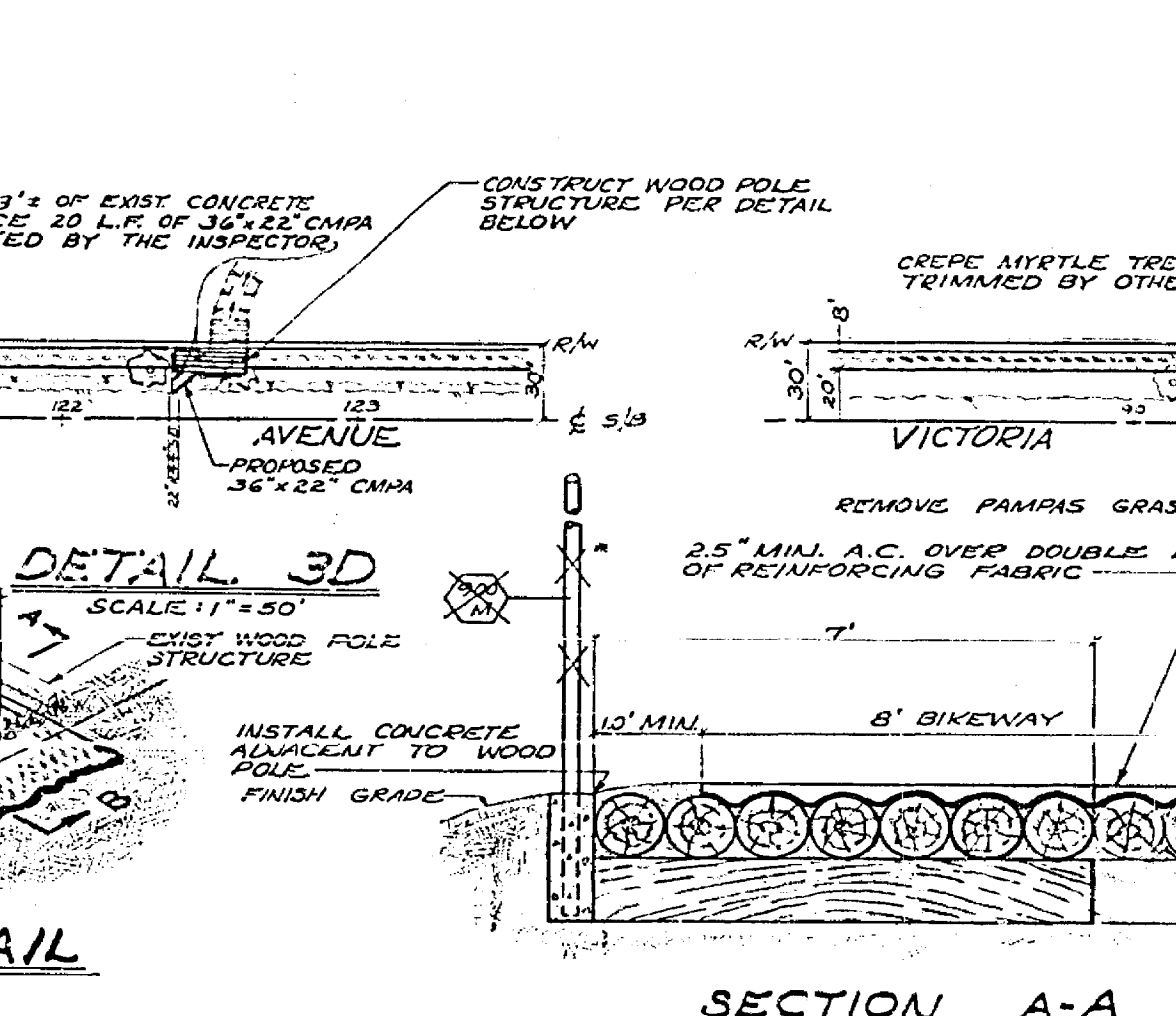
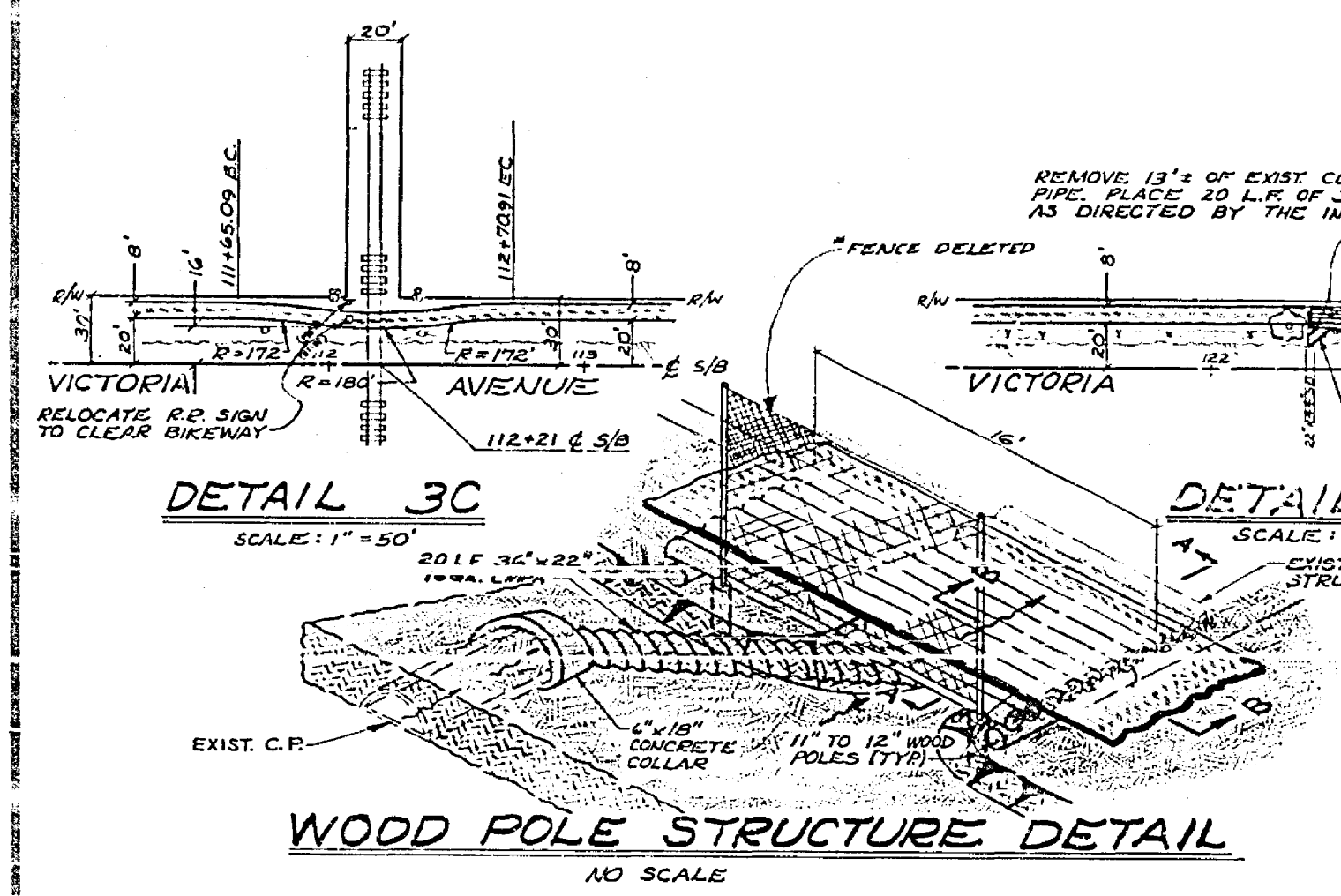
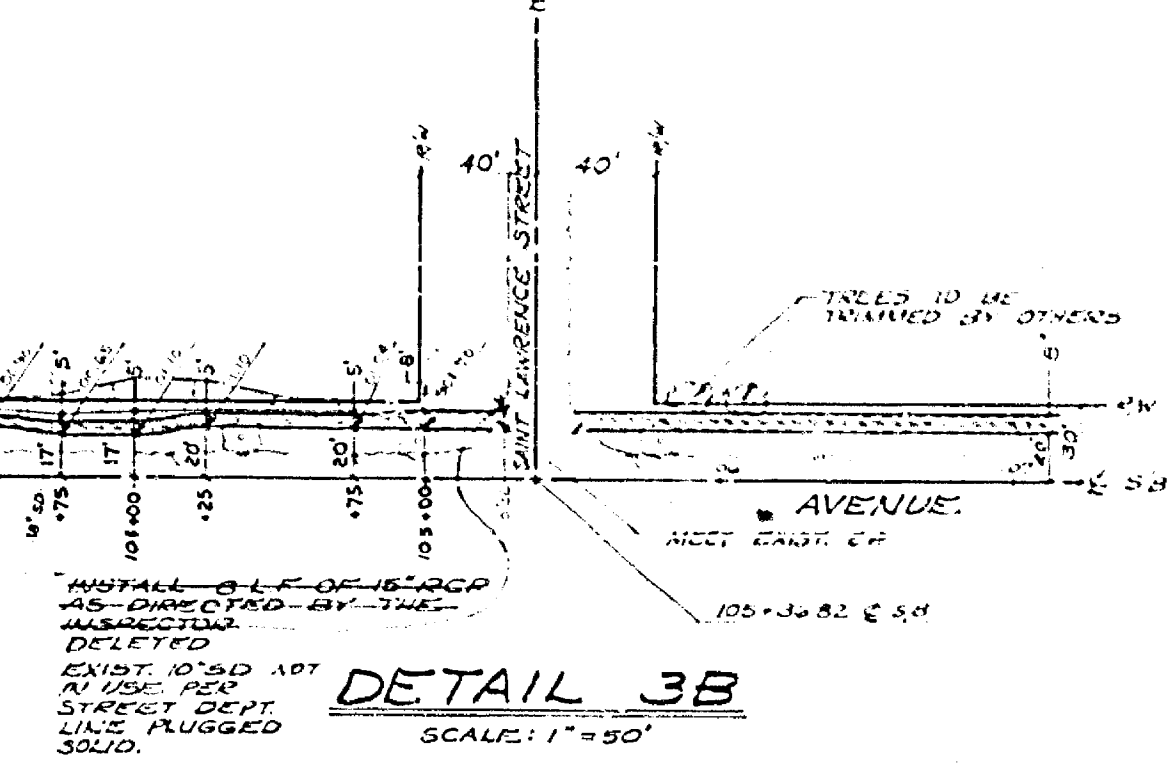
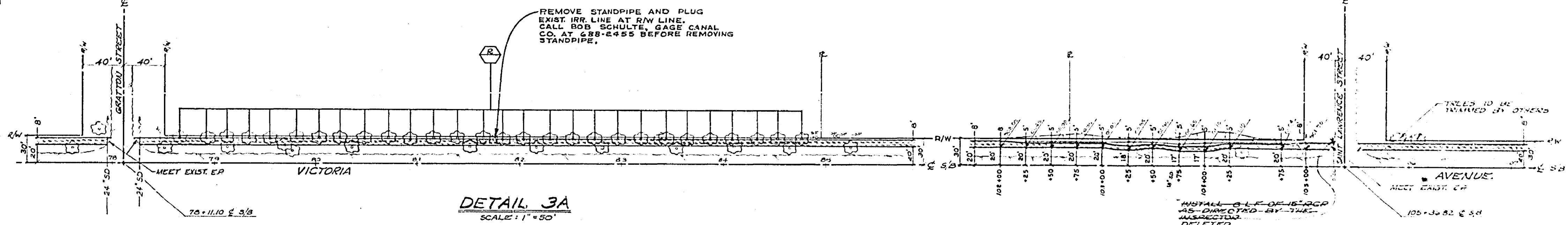
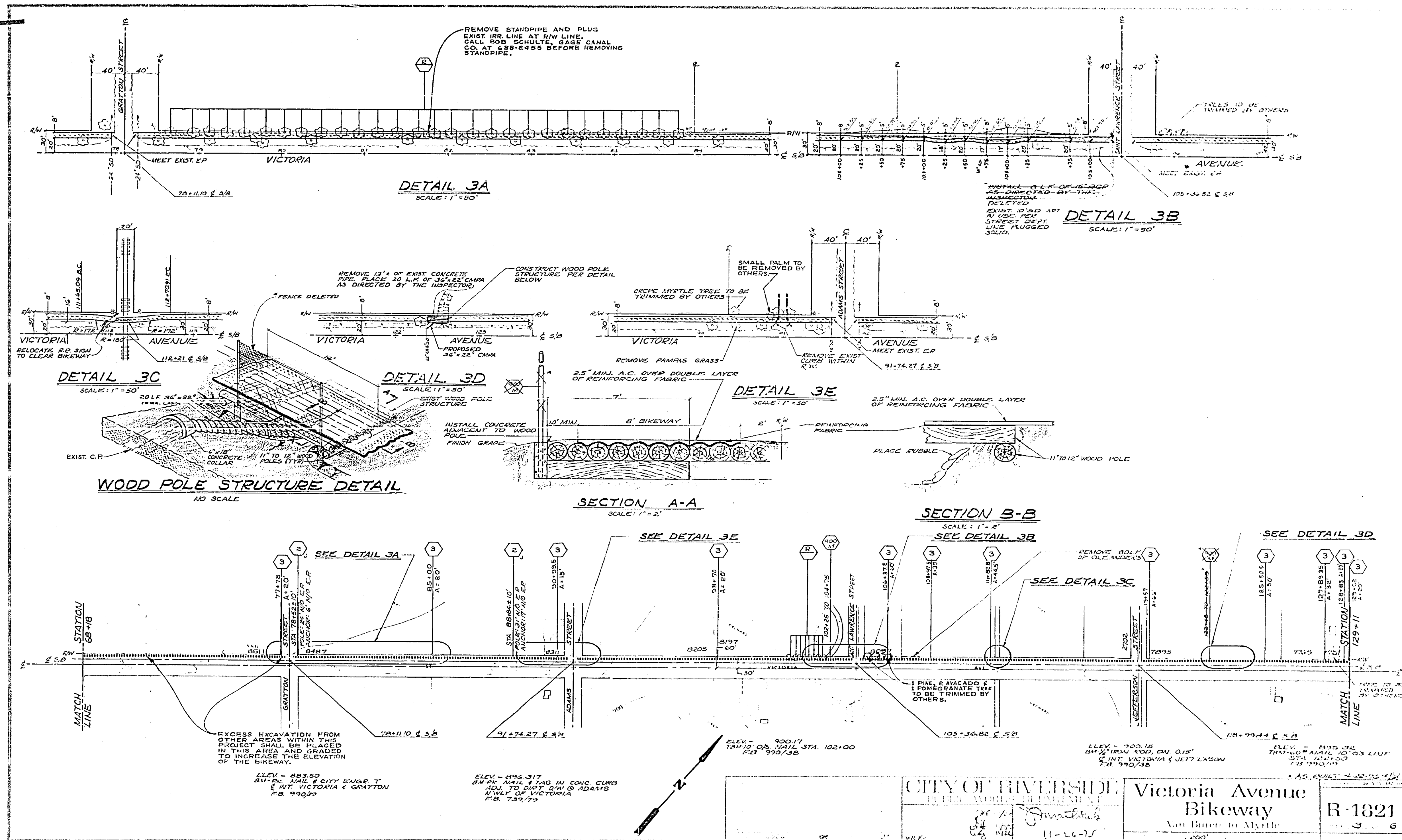

ELEV. - 883.50
3/4" x 1/2" NAIL & CITY ENGR. T.
& INT. VICTORIA & GRAYTON
F.B. 990/99

ELEV. - 896.317
3/4" x 1/2" NAIL & TAG IN CONC. CURB
ADJ. TO DIRT 3/4" @ ADAMS
1/4" W/LY OF VICTORIA
F.B. 759/79

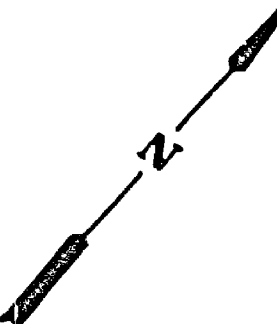

CITY OF RIVERSIDE
PUBLIC WORKS DEPARTMENT

Victoria Avenue
Bikeway
Van Buren to Myrtle

R-1821
3 6

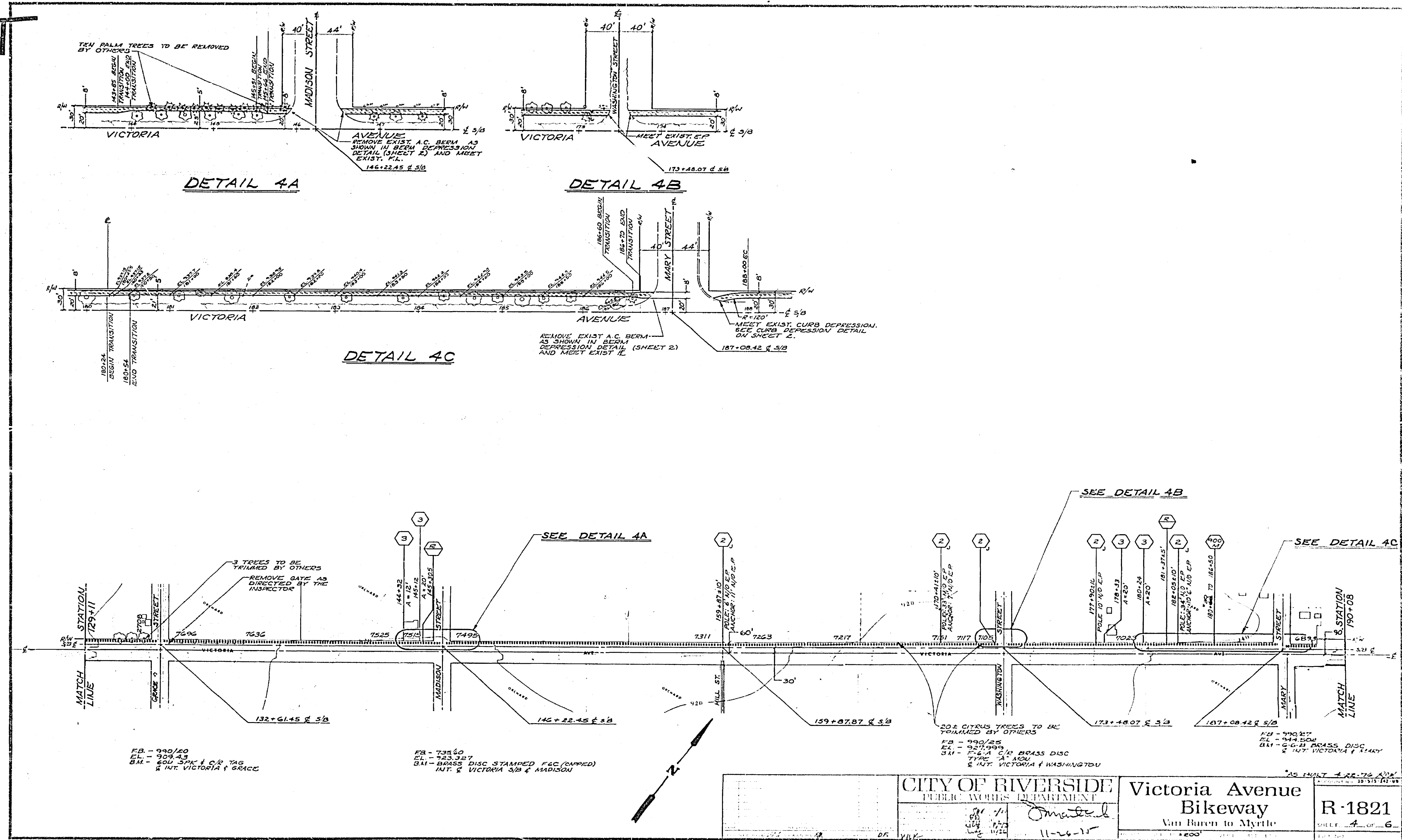

DETAIL 4A

DETAIL 4B

DETAIL 4C

SEE DETAIL 4A

SEE DETAIL 4B

SEE DETAIL 4C

FB - 990/80
 EL - 909.43
 BM - 804.3PK + C/R TAG
 & INT. VICTORIA & GRACE

FB - 73560
 EL - 923.387
 BM - BRASS DISC STAMPED F&C (CAPPED)
 INT. & VICTORIA 3/8 & MADISON

202 CITRUS TREES TO BE
 TRANSAIRED BY OTHERS
 FB - 990/25
 EL - 927.999
 BM - 156.1 C/R BRASS DISC
 TYPE 'A' 100
 & INT. VICTORIA & WASHINGTON

FB - 990/27
 EL - 944.504
 BM - 26.4 BRASS DISC
 & INT. VICTORIA & MARY

CITY OF RIVERSIDE
 PUBLIC WORKS DEPARTMENT

Victoria Avenue
 Bikeway
 Van Buren to Myrtle

R-1821
 SHEET 4 OF 6

11-26-15

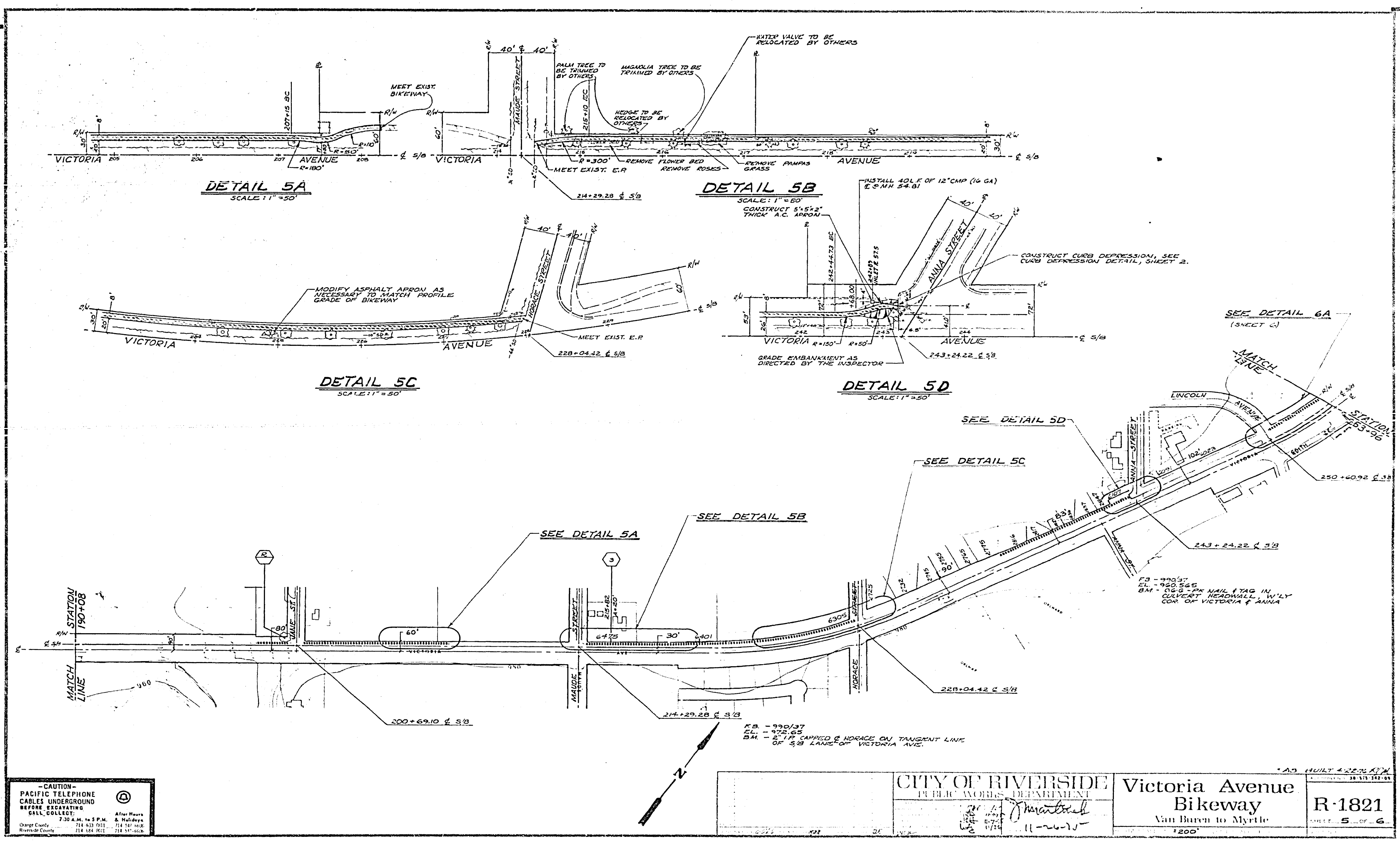

CAUTION
 PACIFIC TELEPHONE
 CABLES UNDERGROUND
 BEFORE EXCAVATING
 CALL COLLECT: 730 A.M. to 5 P.M. After Hours & Holidays
 Orange County 714 431-0111 714 547-4600
 Riverside County 714 324-9011 714 547-4600

CITY OF RIVERSIDE PUBLIC WORKS DEPARTMENT <i>Marshall</i> 11-26-11	Victoria Avenue Bikeway Van Buren to Myrtle	R-1821 SHEET 5 OF 6
	1"=200'	

KB - 990.37
 EL - 928.65
 BM - 2" IP CAPPED & MDCAGE ON TANGENT LINE
 OF SB LANE OF VICTORIA AVE.

F3 - 990.37
 EL - 928.65
 BM - 2" IP NAIL & TAG IN
 CULVERT HEADWALL, W/LY
 CORN OF VICTORIA & ANNA

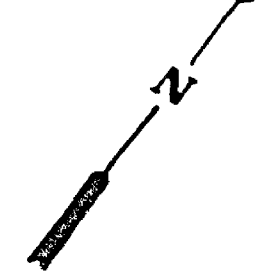

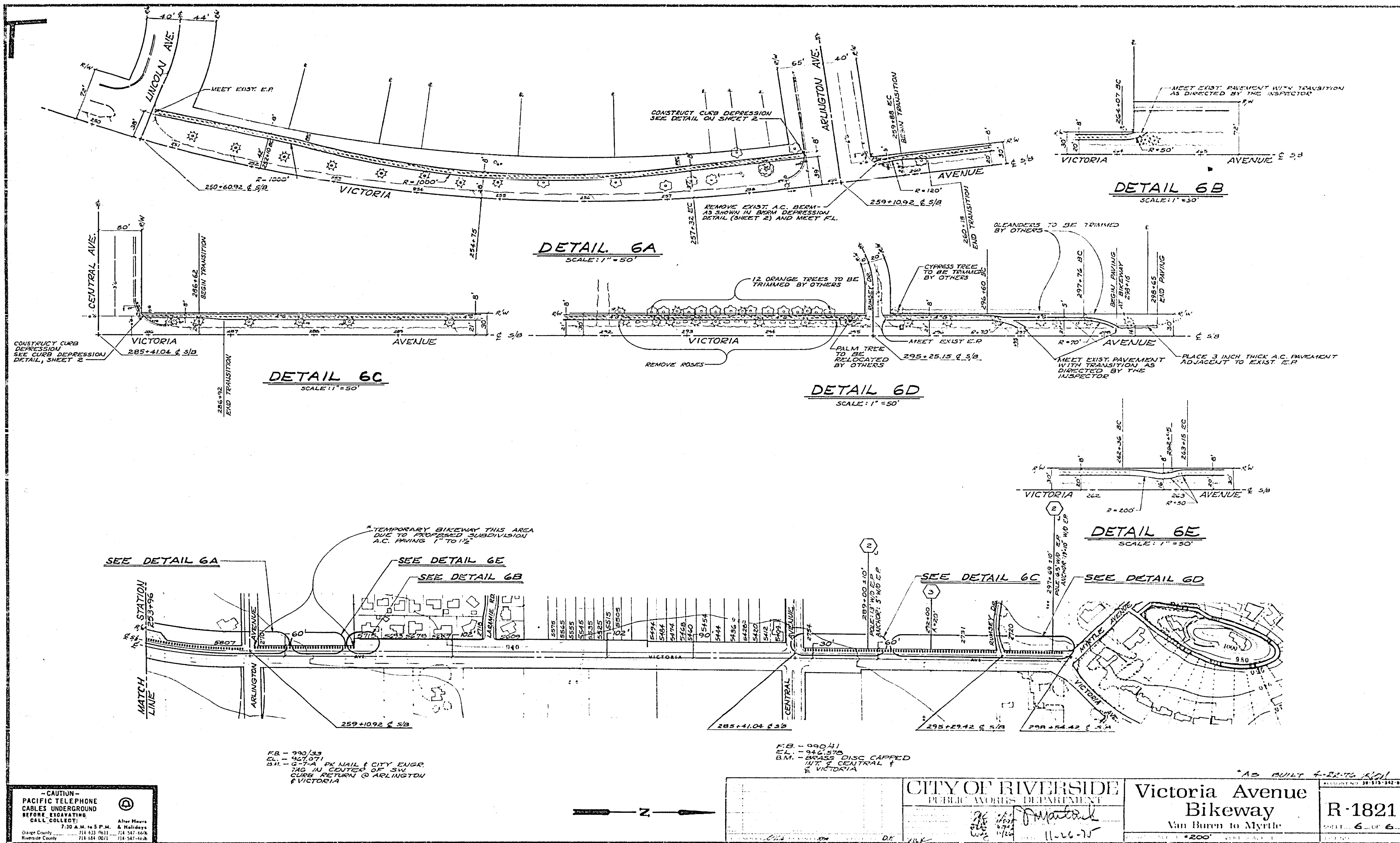

- CAUTION -
 PACIFIC TELEPHONE
 CABLES UNDERGROUND
 BEFORE EXCAVATING
 CALL COLLECT:
 7:30 A.M. to 5 P.M. & Holidays
 718-431-9011 718-547-1628
 Riverside County 718-431-0211 718-547-1628

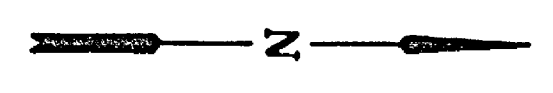

CITY OF RIVERSIDE PUBLIC WORKS DEPARTMENT 11-26-75	Victoria Avenue Bikeway Van Buren to Myrtle	R-1821 SHEET 6 OF 6
	SCALE: 1" = 200'	