

NOTE: P.K. NAIL AND TAG IN CENTER ON N.W. CURB RETURN AT TYLER AND CAMPBELL, F.B. 739/60. ELEV. = 780.14

GENERAL NOTES

- IT SHALL BE THE RESPONSIBILITY OF THE CONTRACTOR TO CLEAR THE RIGHT OF WAY IN ACCORDANCE WITH THE PROVISIONS OF LAW AS IT AFFECTS EACH UTILITY INCLUDING IRRIGATION LINES AND APPURTENANCES AND AT NO COST TO THE CITY.
- CONSTRUCTION SHALL BE IN ACCORDANCE WITH THE CITY OF RIVERSIDE, DEPT. OF PUBLIC WORKS, STANDARD DRAWINGS, AND THE STANDARD SPECIFICATIONS FOR PUBLIC WORKS CONSTRUCTION, 1973 EDITION.
- TRIM EDGE OF EXISTING PAVEMENT WHERE NEW PAVEMENT JOINS TO A SMOOTH, STRAIGHT LINE. CONSTRUCT MATCH-UP PAVING AS SHOWN ON PLAN AND OVERLAY PAVING AS DIRECTED IN THE FIELD TO PRODUCE A SMOOTH SECTION. ENGINEER ESTIMATES OVERLAY TO BE 1.5 TONS.
- CURB AND GUTTER SHALL BE STAKED WITH 3' OFFSETS AT 25' INTERVALS.
- ALL FLAGGED ELEVATIONS SHALL BE STAKED IN THE FIELD BY THE PRIVATE ENGINEER.
- PUBLIC UTILITIES WILL ADJUST WATER FACILITIES TO NEW GRADE.

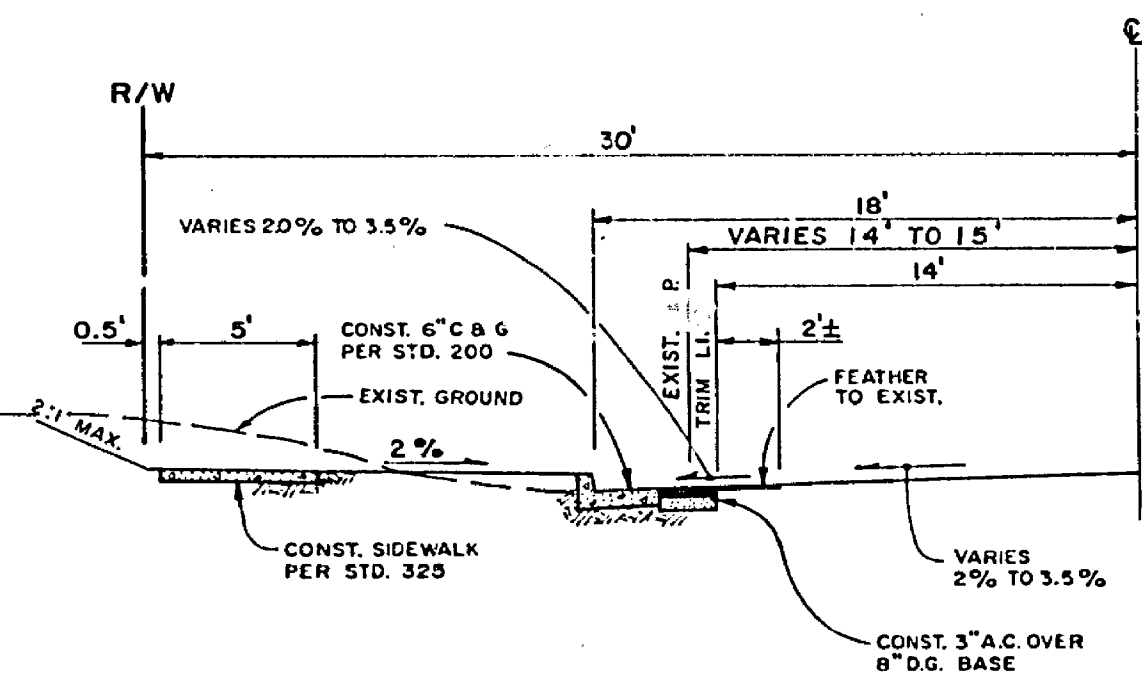
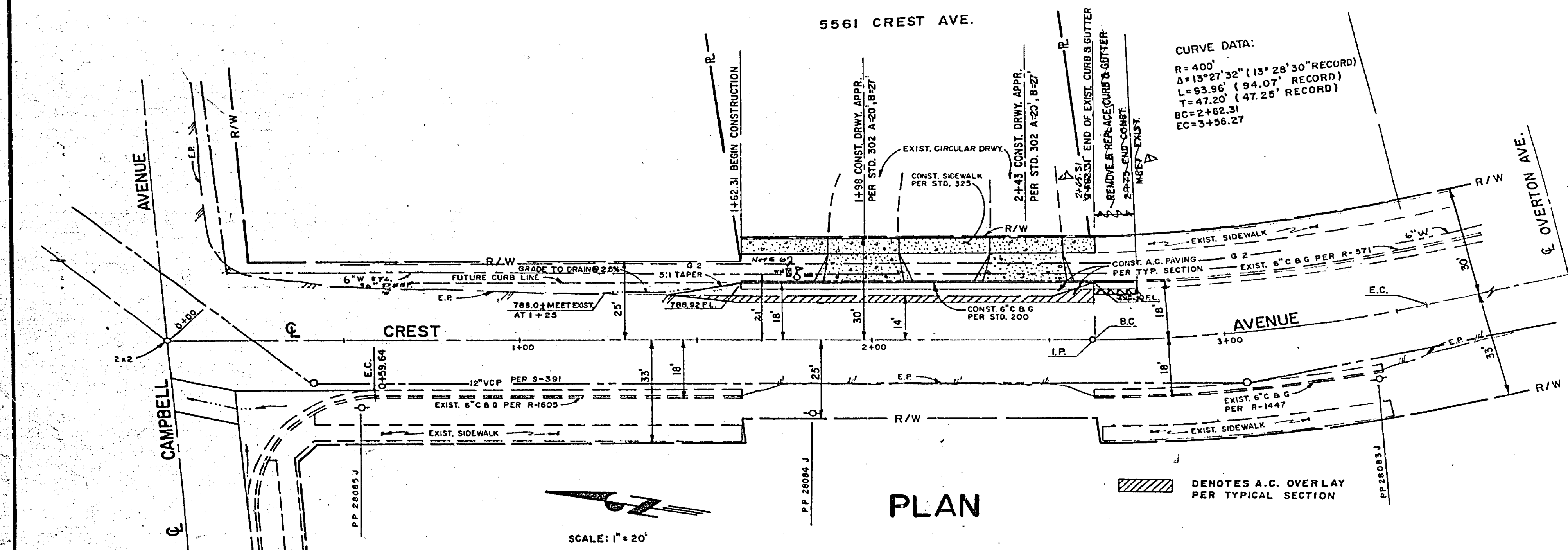

TYPICAL SECTION  
CREST AVENUE  
NO SCALE  
T1 = 5

NEAL L. SMITHHAMMER

APPROVED BY	BY	DATE
PUBLIC UTILITIES	NS	7/23/76
WATER DIVISION	NS	7/23/76
ELECTRICAL DIVISION	NS	7/23/76

APPROVED BY *Paul DeGeneffe* DATE 11 JUN 76  
R.E. No. 16757  
FOR: PAUL DEGENEFPE F.B.

DESIGNED BY	DRAWN BY	CHECKED BY
	RA	

CITY OF RIVERSIDE, CALIFORNIA  
PUBLIC WORKS DEPARTMENT

APPROVED BY	BY	DATE
PRINCIPAL ENGINEER	NS	7/23/76
PARK DEPARTMENT	NS	7/23/76
TRAFFIC DIVISION	NS	7/23/76
CHIEF PUB. WORKS ENGR.	NS	7/23/76

STREET PLAN & PROFILE  
5561 CREST AVE.  
162' SO. OF CAMPBELL AVE.

SCALE: HORIZ. 1" = 20' VERT. 1" = 4'

INDEXED	M.M.
ACCOUNT No.	
DRAWING NUMBER	R-1895
SHEET	1 OF 1