

BENCHMARK: Lead and nail in West curb of Pine Street, approx. 4' south of E. of First Street produced. E.I. 838.194 C.R.F.B. 225/44.

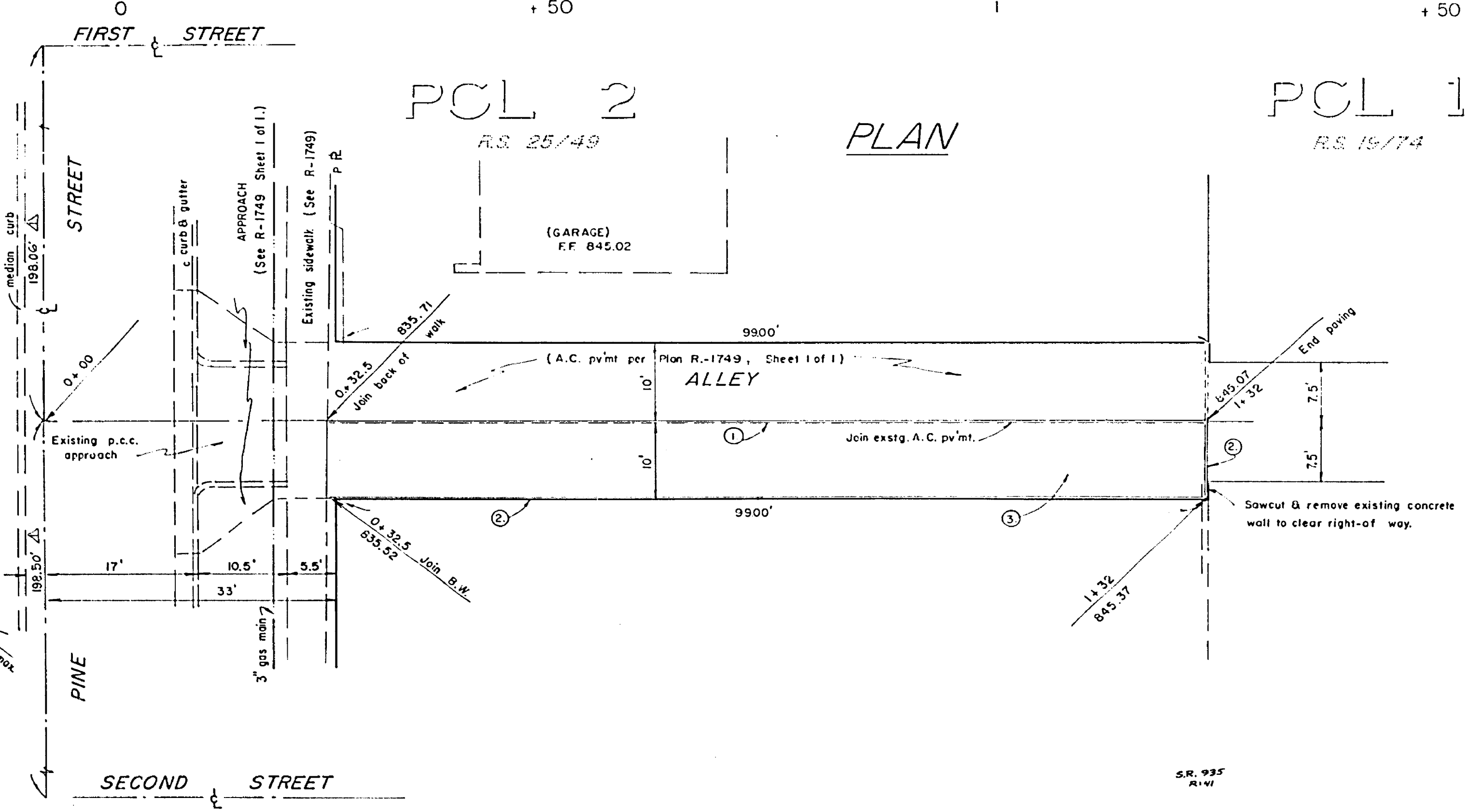

GENERAL NOTES

- Construction shall be in accordance with Standard Specifications for Public Works Construction 1976 Edition and per City of Riverside Standard Drawings.
- The Owner shall arrange for a soils test to be made by a Soils Engineer after the Alley has been prepared to rough grade. Depth of base material and A.C. paving shall be determined by the City of Riverside design standards and test procedures.
- As an alternative to the requirements of Note 2, above, the Contractor may provide Full depth A.C. in lieu of D.G. base material.
- It shall be the responsibility of the contractor to clear the right-of-way in accordance with the provisions of Law as it affects each utility including irrigation lines and appurtenances and at no cost to the City.
- All flagged elevations shall be staked in the field by the private engineer.
- The private engineer signing these plans is responsible for assuring the accuracy and acceptability of the work herein. In the event of discrepancies arising during construction as a result of errors or omissions, the private engineer shall be responsible for determining an acceptable solution and revising the plans for approval.

CONSTRUCTION NOTES

- Remove existing 2"x4" redwood header.
- Construct 2"x4" redwood header per City Std. No. 110.
- Construct 2" A.C. paving over 5" D.G. base material, or 4" AC over compacted native soil per City Std. No. 110.

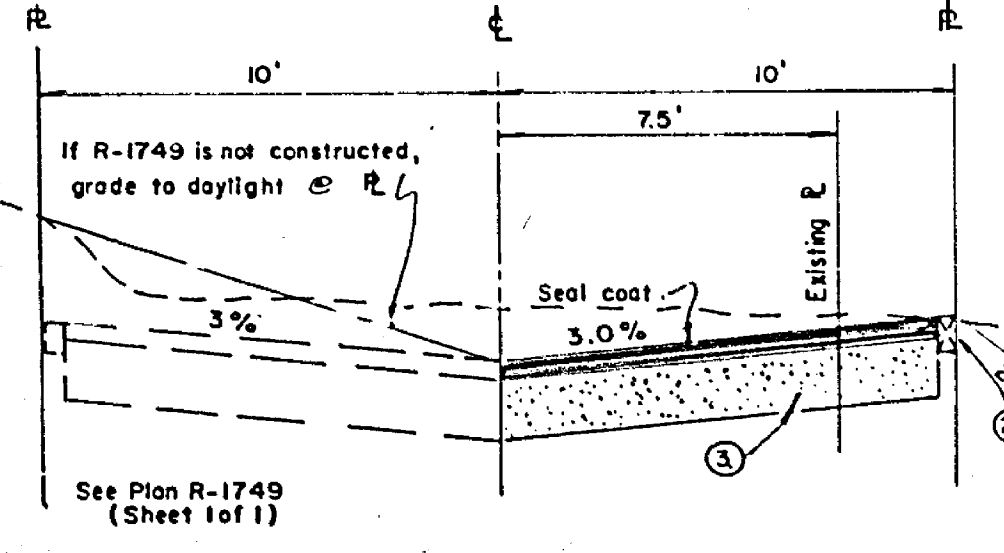

ROBERT L. TAYLOR CIVIL ENGINEER RIVERSIDE, CALIFORNIA Approved by: <i>Robert L. Taylor</i> H.C.E. 10470	DESIGNED BY: _____ DRAWN BY: _____ CHECKED BY: _____	CITY OF RIVERSIDE, CALIFORNIA DEPARTMENT OF PUBLIC WORKS APPROVED BY: _____ DATE: _____ TRAFFIC DIVISION: _____ CHIEF P. W. ENGR. _____	ALLEY PLAN AND PROFILE ALLEY EASTERLY OF PINE STREET BETWEEN FIRST AND SECOND STREET FOR PARCEL MAP 7681 PROJECT NO. R-1966 SHEET 1 OF 1 HORIZ. SCALE: 1" = 10' VERT. SCALE: 1" = 2' FILE NO. _____
	REVISIONS: _____ APPR. DATE: _____	APPROVED BY: _____ DATE: 4-13-77	ENDORSED E.T.