

CITY OF RIVERSIDE  
 DEPARTMENT OF PUBLIC WORKS

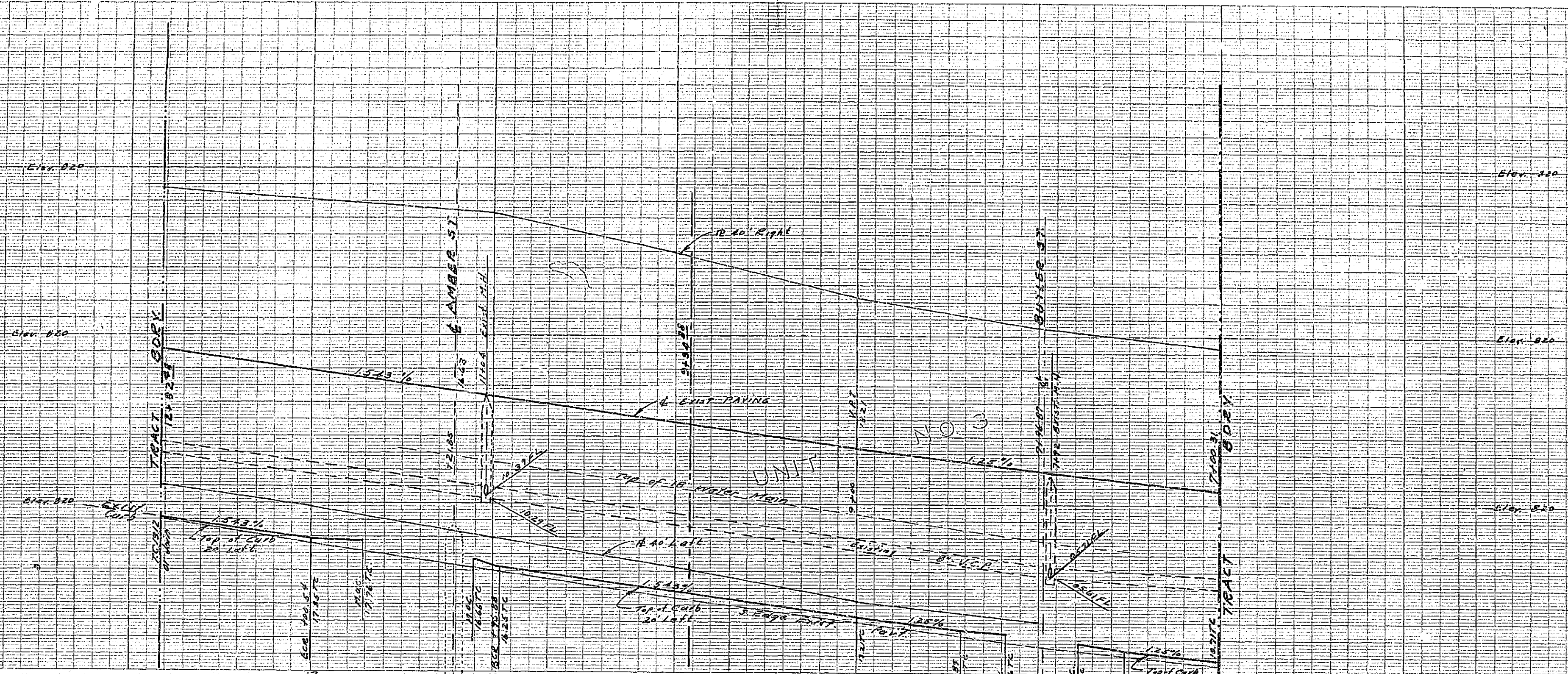

SHEET INDEX	
STREET	SHEET
INDIANA ST.	1
AMBER ST.	2
HASKELL ST.	3

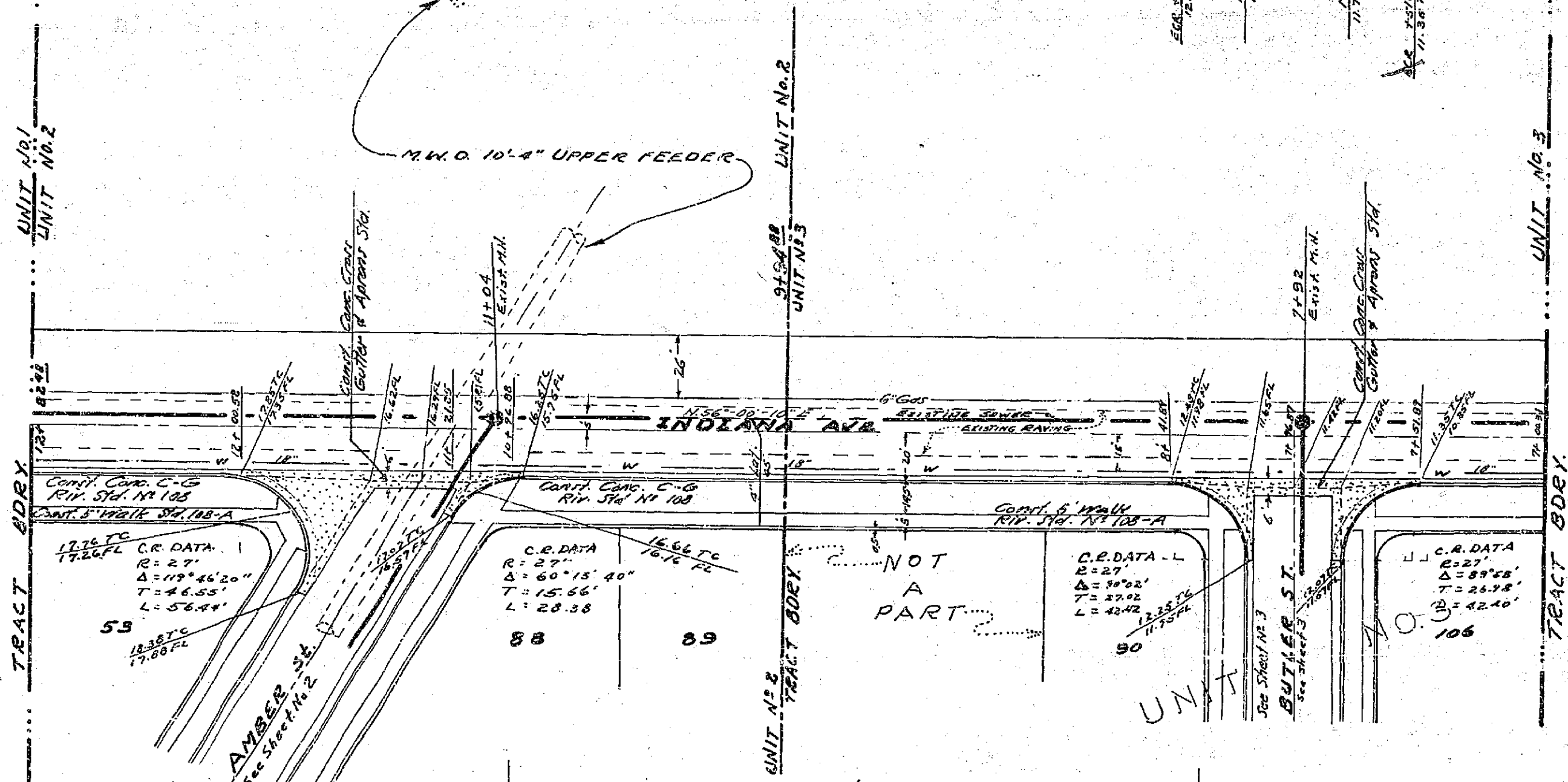

ESTIMATE OF QUANTITIES						
STREET	C-G	X Gutters	Paving	Walks	Fence	Misc.
INDIANA ST.	269	570	2500	1262		45'-4" M. L.
AMBER ST.	1930	1874	3308	9600	768	1
HASKELL ST.	877		17190	5400		1
TOTALS:	3,236	2444	52,578	14,262	768	2 45'-4" M. L.

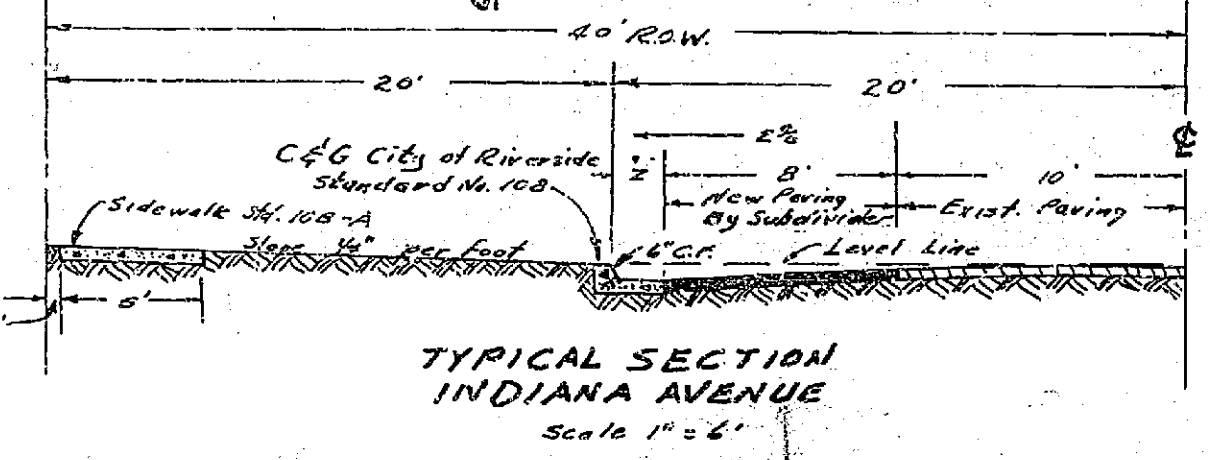

B.M. 20d spike in RR 1/2 M 8120 J  
 at NW cor of Indiana Ave.  
 97' 4" W. from E. Moore St. Elev. = 616.22

B.M. 4-T in corner of My corner ditch  
 of Pharrish Park G. 200 ft. W.  
 1/4' cor of Amber St. Elev. = 642.81

J.F. DAVIDSON - CIVIL ENGINEER  
 R.E. No. 862  
 RIVERSIDE, CALIFORNIA  
 APPROVED BY: *[Signature]* DATE: *[Date]*

CITY OF RIVERSIDE, CALIFORNIA  
 DEPARTMENT OF PUBLIC WORKS

STREET PLAN & PROFILE  
 INDIANA AVENUE  
 UNIT NO. 2  
 AMBERWOOD TRACT

HORIZ. SCALE 1" = 40' VERT. SCALE 1" = 2'

APPROVED BY: *[Signature]*  
 Director of Public Works

NO. R-197  
 DATE July 7, 1918 SHEET 1 OF 3

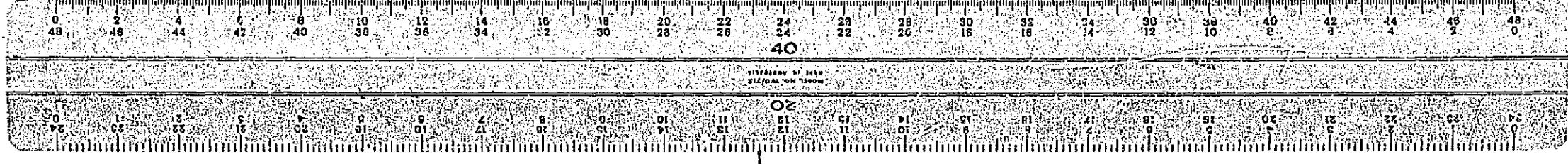



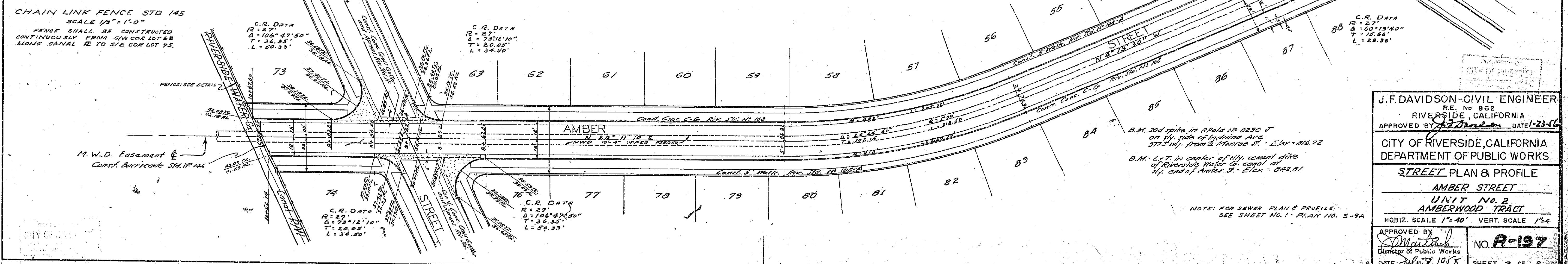
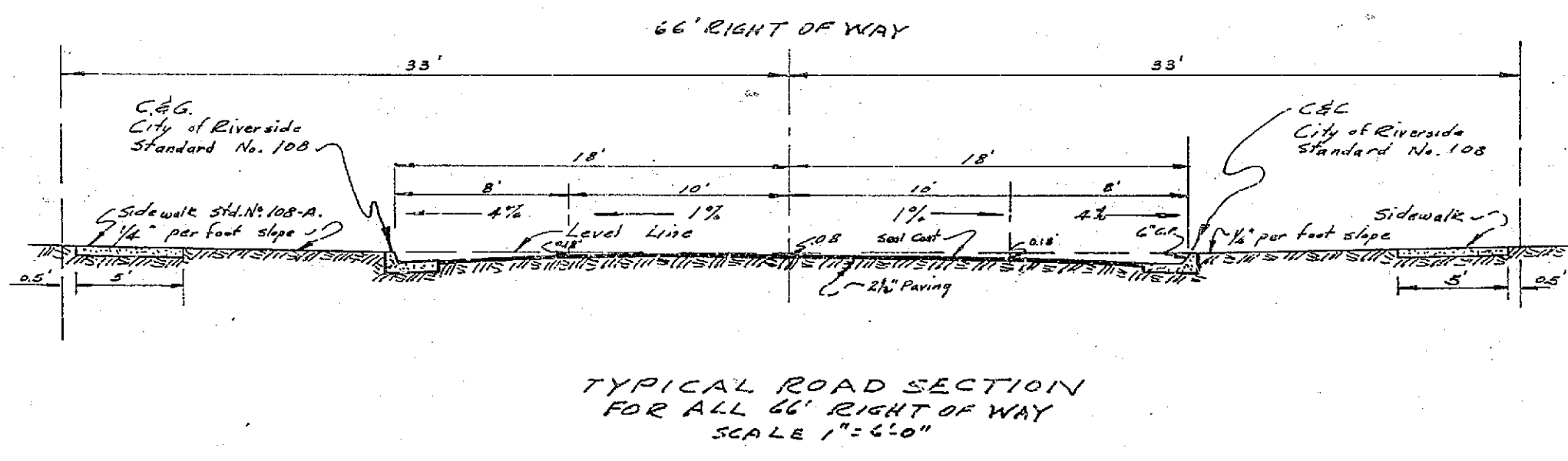
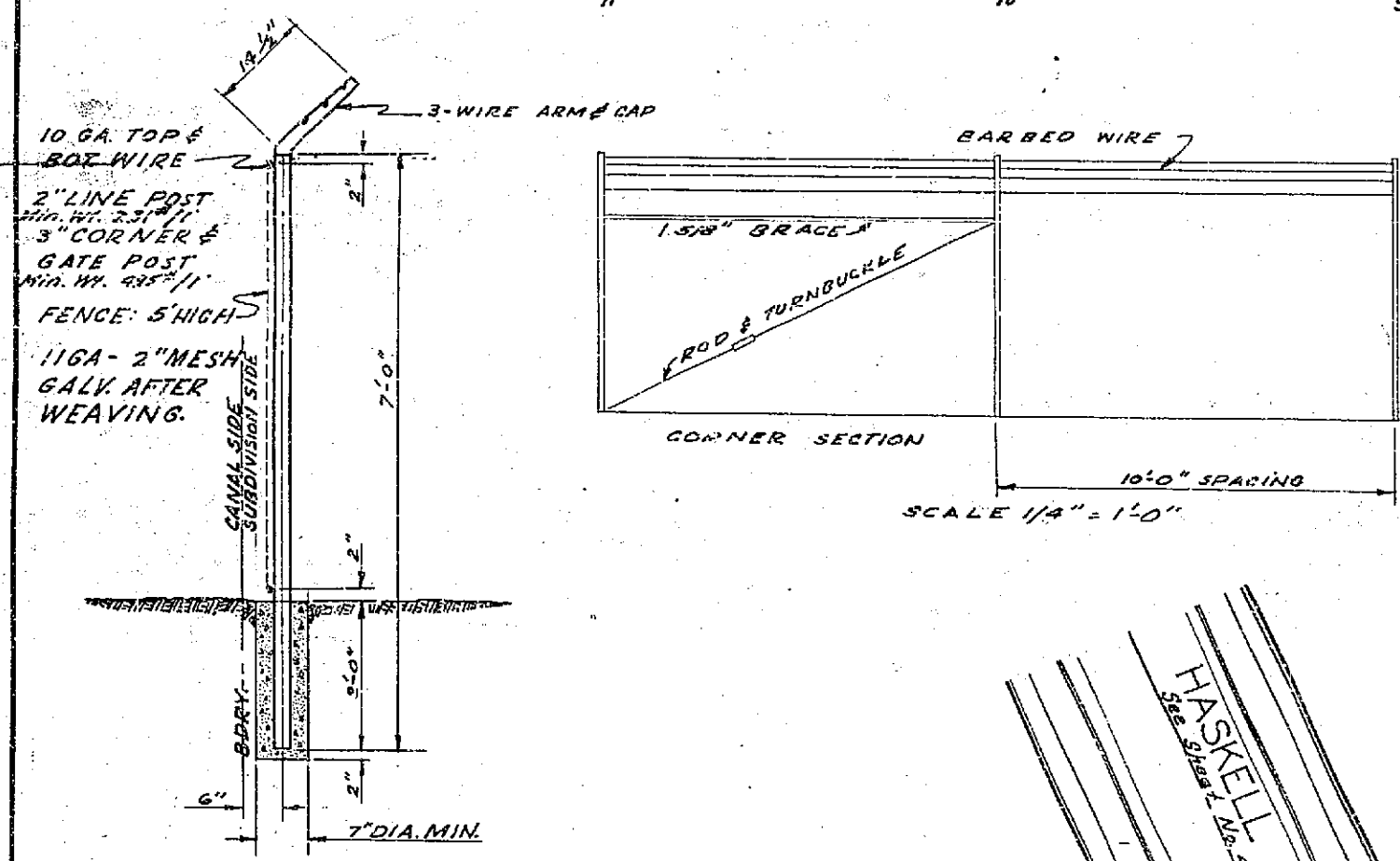
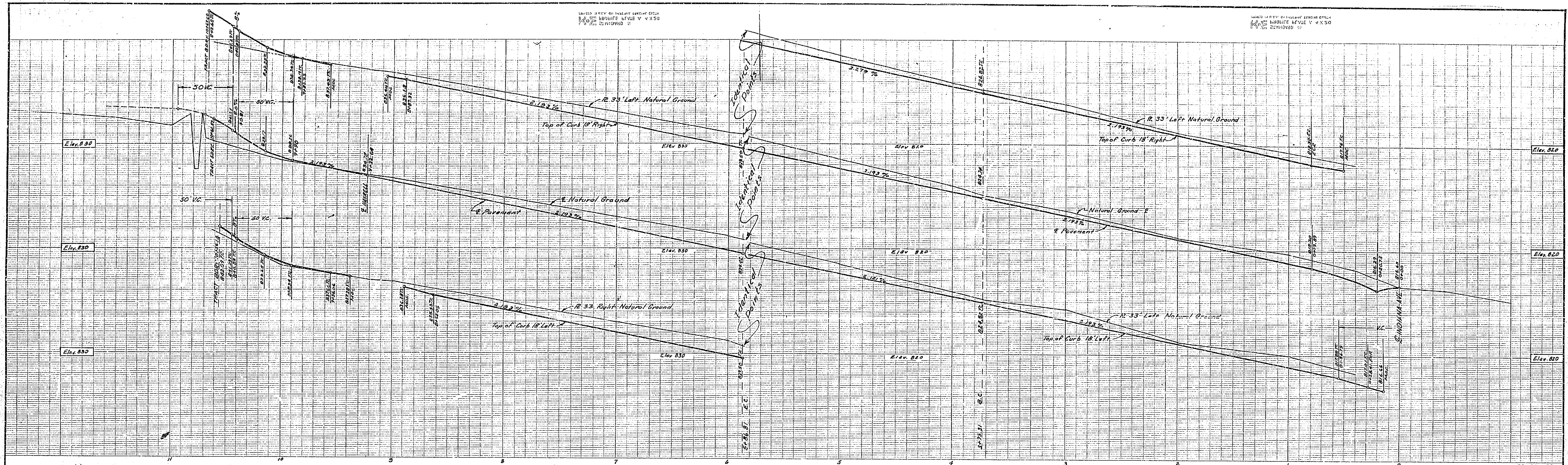

J.F. DAVIDSON - CIVIL ENGINEER  
RIVERSIDE, CALIFORNIA  
RE. No. 882  
APPROVED BY *J.F. Davidson* DATE 1-23-16  
CITY OF RIVERSIDE, CALIFORNIA  
DEPARTMENT OF PUBLIC WORKS  
STREET PLAN & PROFILE  
AMBER STREET  
UNIT No. 2  
AMBERWOOD TRACT  
HORIZ. SCALE 1" = 40' VERT. SCALE 1" = 4'  
NOTE: FOR SEWER PLAN & PROFILE SEE SHEET NO. 1 - PLAN NO. S-9A  
APPROVED BY *J.F. Davidson*  
Director of Public Works  
NO. R-197  
DATE *July 7, 1915* SHEET 2 OF 3

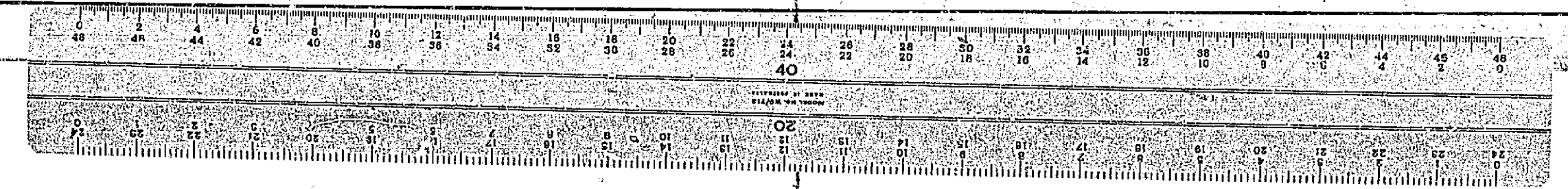



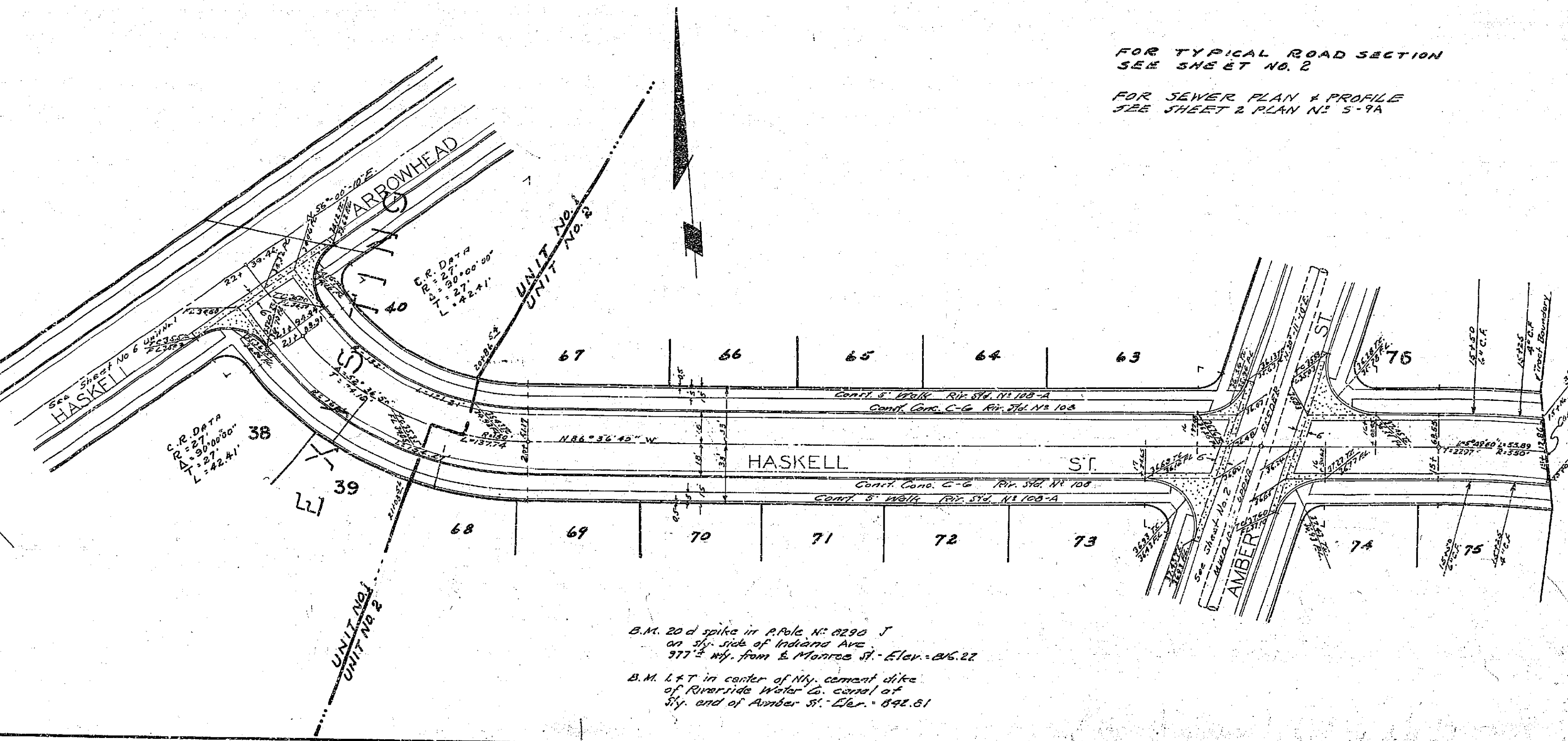
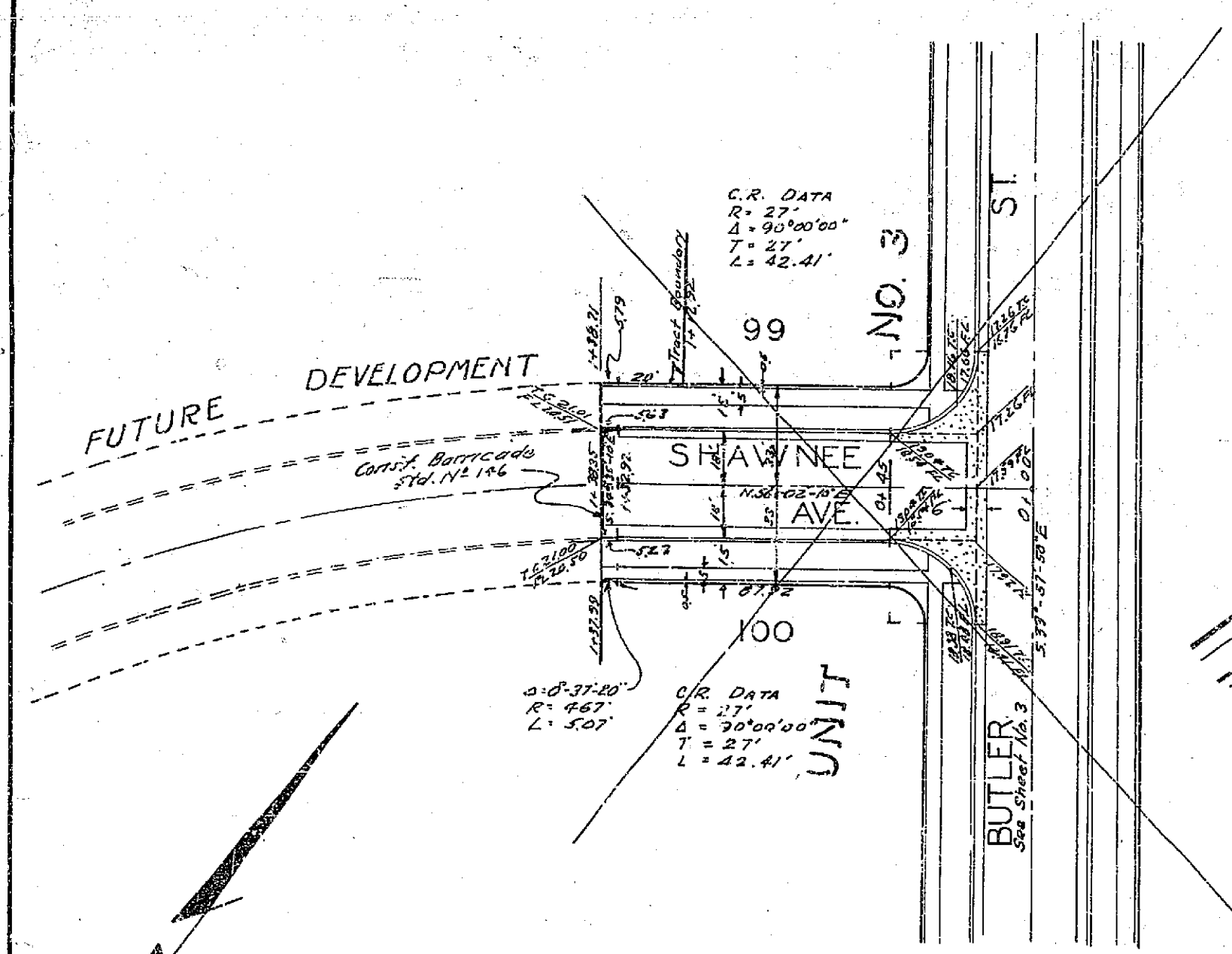
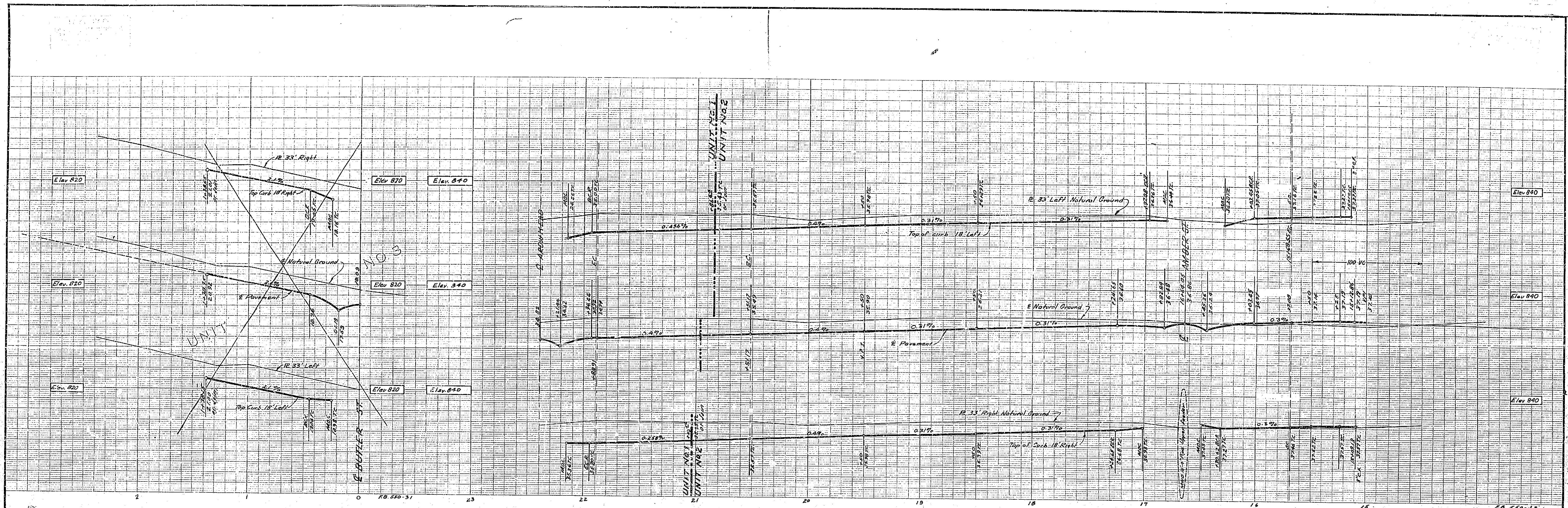

FOR TYPICAL ROAD SECTION  
SEE SHEET NO. 2  
FOR SEWER PLAN & PROFILE  
SEE SHEET 2 PLAN NO. 5-9A

PROPERTY OF  
CITY OF RIVERSIDE

J. F. DAVIDSON - CIVIL ENGINEER  
RE. No. 562  
RIVERSIDE, CALIFORNIA  
APPROVED BY *J.F. Davidson* DATE *7-23-08*  
CITY OF RIVERSIDE, CALIFORNIA  
DEPARTMENT OF PUBLIC WORKS

STREET PLAN & PROFILE  
HASKELL STREET  
UNIT No. 2  
AMBERWOOD TRACT

HORIZ. SCALE 1"=40' VERT. SCALE 1"=8'  
APPROVED BY *J.F. Davidson*  
Director of Public Works  
DATE *July 7, 1908* NO. **R-197**  
SHEET 3 OF 3

