

15 LT.
05 LT.
15 E
05 E

15 LT.
05 LT.
15 E
05 E

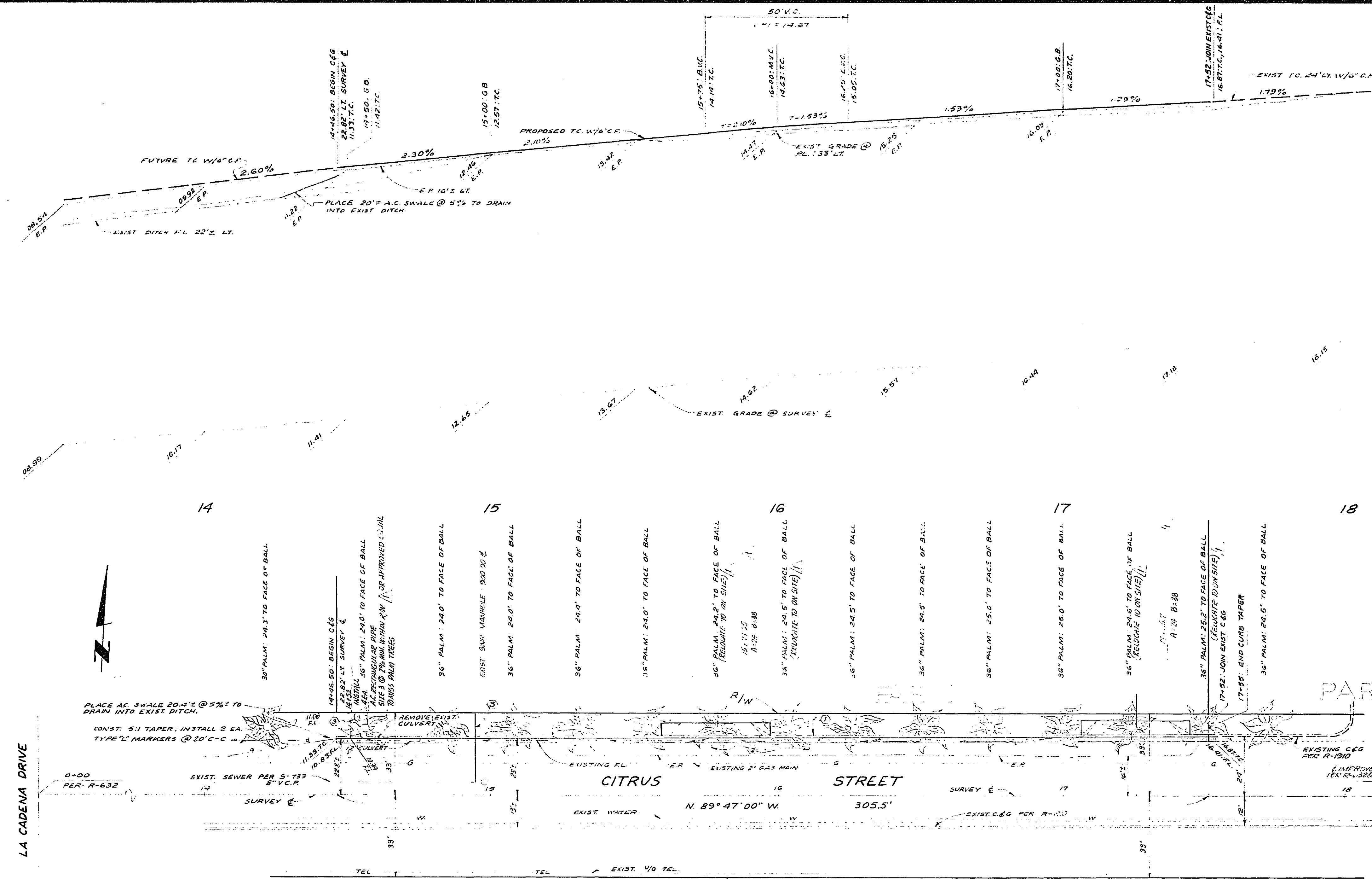

BENCH MARK:
USG63 BRASS CAP IN CONCRETE BASE
NORTH SIDE OF COLUMBIA AVENUE, 30'
WEST OF AT&P R.R. WESTBOUND MAIN
LINE. (PER R-1865) ELEV. 892.872

T.B.M. (THIS PROJECT ONLY)
R.R. SPIKE E. SIDE RR #1920616 N.W.
CORNER LOT 78. STATION 2+08.71 R-1865
ELEV. 892.04

- It shall be the responsibility of the Contractor to clear the right of way in accordance with the provisions of law as it affects each utility, including irrigation lines, and at no cost to the City.
- Construction shall be in accordance with the City of Riverside, Department of Public Works, Standard Drawings and Specifications for Public Works Construction, 1976 Edition.
- Prime coat, seal coat, and paint binder are required.
- NOTICE TO CONTRACTOR:** The existence and location of any underground utility pipes or structures shown on these plans were obtained by a search of the available records. To the best of our knowledge there are no existing utilities except as shown on these plans. The Contractor is required to take precautionary measures to protect the utility lines shown and any other lines not of record or not shown on these plans.
- Driveway approaches shall be constructed per City of Riverside Standard Drawing 56-102. Exact size and location to be determined at time of construction as approved by the City Traffic Engineer.
- Trim edge of existing pavement where new pavement joins to a smooth straight line. Construct match-up paving an shown on plan and overlay as directed in the field to produce a smooth section. Engineer estimates overlay to be 0 tons.
- The private engineer signing these plans is responsible for assuring the accuracy and acceptability hereon. In the event of discrepancies arising during construction, the private engineer signing these plans shall be responsible for determining an acceptable solution and revising the plans for approval by the City.
- Curb and gutter shall be staked by the private engineer with 3.0 foot offsets at 25.0 foot intervals all flagged elevations shown on the plans shall also be staked.
- Lead lines furnished to locate Public Works Department Inspector at 741-7500. 31 day permit required for staking plan lines.

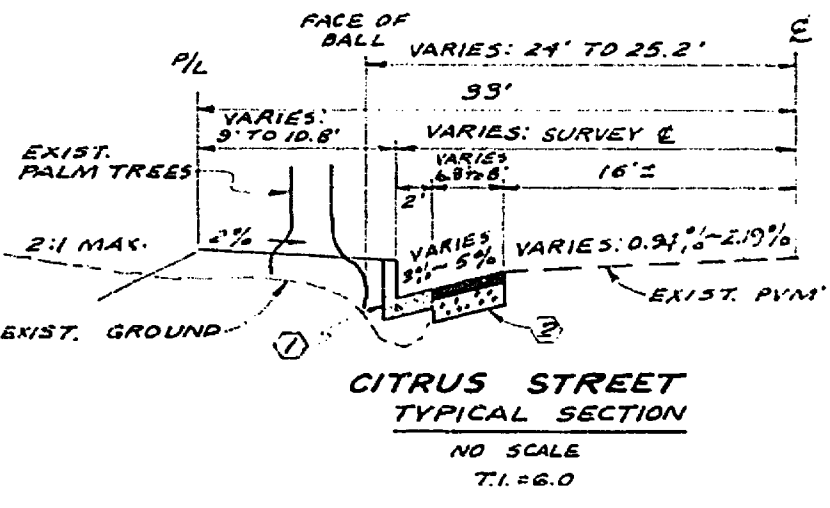

Contractor agrees that he shall assume sole and complete responsibility for all site conditions during the course of construction of this Project, including safety of all persons and property; that this requirement shall apply continuously and not be limited to normal working hours; and that the Contractor shall defend, indemnify, and hold the Owner and the Engineer harmless from any and all liability, real or alleged, in connection with the performance of work on this Project, excepting the liability arising from the sole negligence of the Owner or the Engineer.

J. F. DAVIDSON ASSOCIATES
CIVIL ENGINEERS - SURVEYORS - PLANNERS
RIVERSIDE, CALIFORNIA

APPROVED BY: [Signature] DATE: 7.12.78
R.E. No. 17552

W.O. 5955 FOR SPARKLETT'S R.B. 1052/115, 104-100

MARK	REVISIONS	DATE

CITY OF RIVERSIDE, CALIFORNIA
DEPARTMENT OF PUBLIC WORKS

APPROVED BY: [Signature] DATE: 7/12/78
TRAFFIC DIVISION

DESIGNED BY: A.W. DRAWN BY: J.B. CHECKED BY: [Signature]

INDEXED "R.R."

STREET PLAN & PROFILE
CITRUS STREET
NLY SIDE
377' ± TO 683' ± WLY OF IOWA AVE.
FOR
MP-8-77B

PROJECT NO. R-2130
SHEET 1 OF 1
FILE NO. 5603

HORIZ. SCALE: 1" = 20' VERT. SCALE: 1" = 4'