

BENCH MARK: I.T.B.
 Brass Peg Stamped (I.T.B.) Located At The Intersection Of
 The 8th University Avenue And Chicago Avenue (Sta. 7116)
 Elevation 956.199

STORM DRAIN PROFILE
 VERT. 1" = 4'
 HORIZ. 1" = 10'

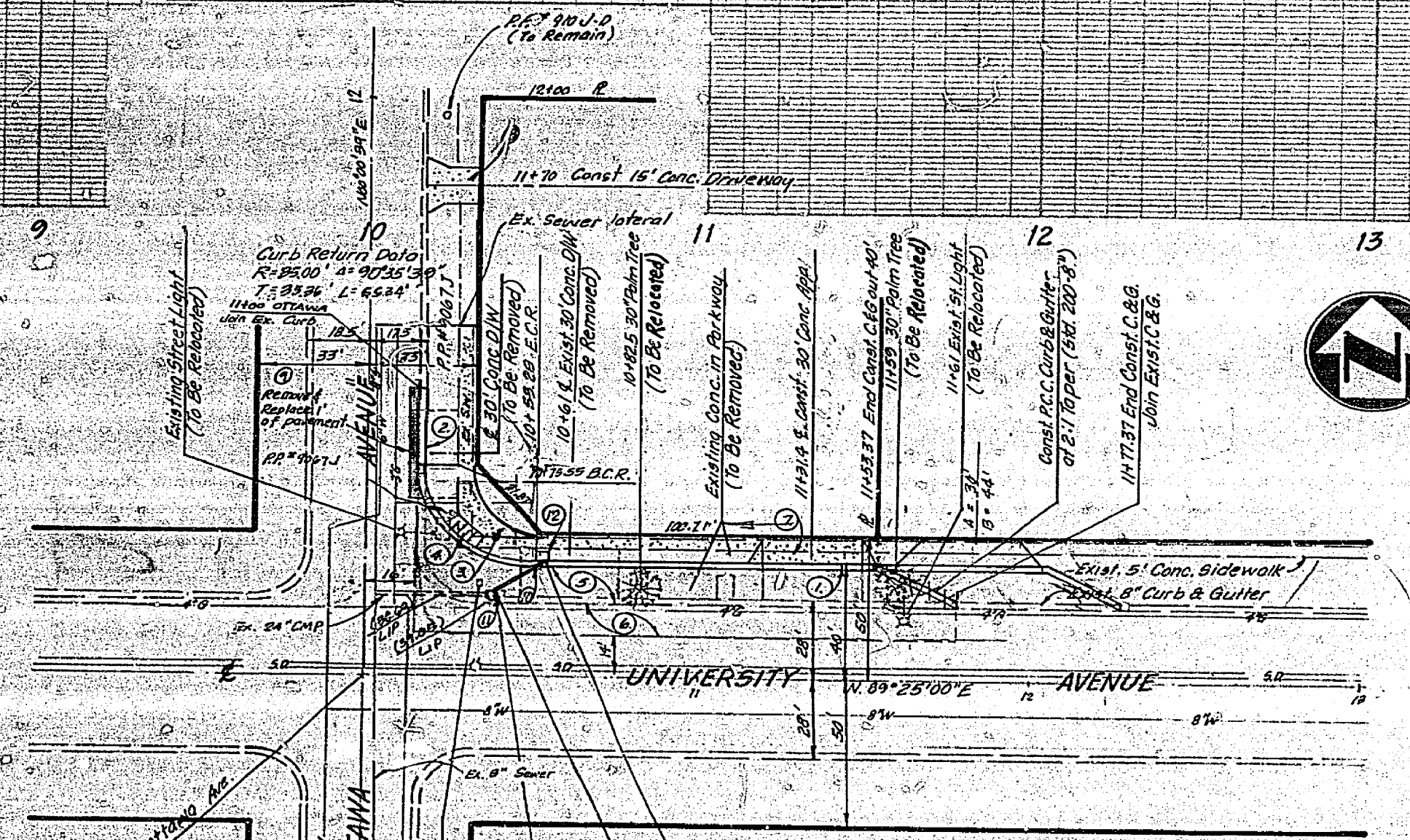

- GENERAL NOTES**
1. It shall be the responsibility of the Contractor to clear the Right of Way in accordance with the provisions of law as it affects each utility including irrigation lines and appurtenances and at no cost to the City.
 2. Construction shall be in accordance with the City of Riverside, Department of Public Works, Standard Drawings, and the Standard Specifications for Public Works Construction, 1976 Edition.
 3. Trim edge of existing pavement where new pavement joins to a smooth, straight line, construct match-up paving as shown on plan, and overlay paving as directed in the field to produce a smooth section. Engineer estimates overlay to be 80.4 tons.
 4. Construct driveway approaches per Std. Dwg. 302.
 5. Curb and gutter shall be staked with 3" offsets at 25' intervals.
 6. All flagged elevations shall be staked in the field by the Private Engineer.
 7. The Private Engineer signing these plans is responsible for assuring the accuracy and acceptability of the work shown. In the event of discrepancies arising during construction as a result of errors or omissions, the Private Engineer shall be responsible for determining an acceptable solution and revising the plans for approval by the City.
 8. The 2 Palms shall be relocated according to Park and Rec. Standards.
 9. Contractor shall notify Park Projects Inspector 24 hours in advance prior to starting of work.

- Construction Notes:**
1. Construct R.C.C. Curb & Gutter per std. No. 200 (8" Curb Face)
 2. Construct R.C.C. Curb & Gutter per std. No. 200 (8" Curb Face)
 3. Construct R.C.C. sidewalk per std. No. 325
 4. Construct Wheelchair Ramp per Std. No. 304
 5. Construct 4" A.C. Pavement over 4" P.C. Base per Typical Section
 6. Construct Variable Thickness A.C. Overlay per Typical Section
 7. Construct Driveway Approach per std. No. 302, A=30', B=44'
 8. Construct Driveway Approach per std. No. 302, A=15', B=29'
 9. Construct 0.25" A.C. Pavement over compacted native soil
 10. Construct 24" of 24" B.C.P. 0-1950
 11. Construct Manhole E-2 per std. No. 424
 12. Construct Catch Basin per std. No. 425

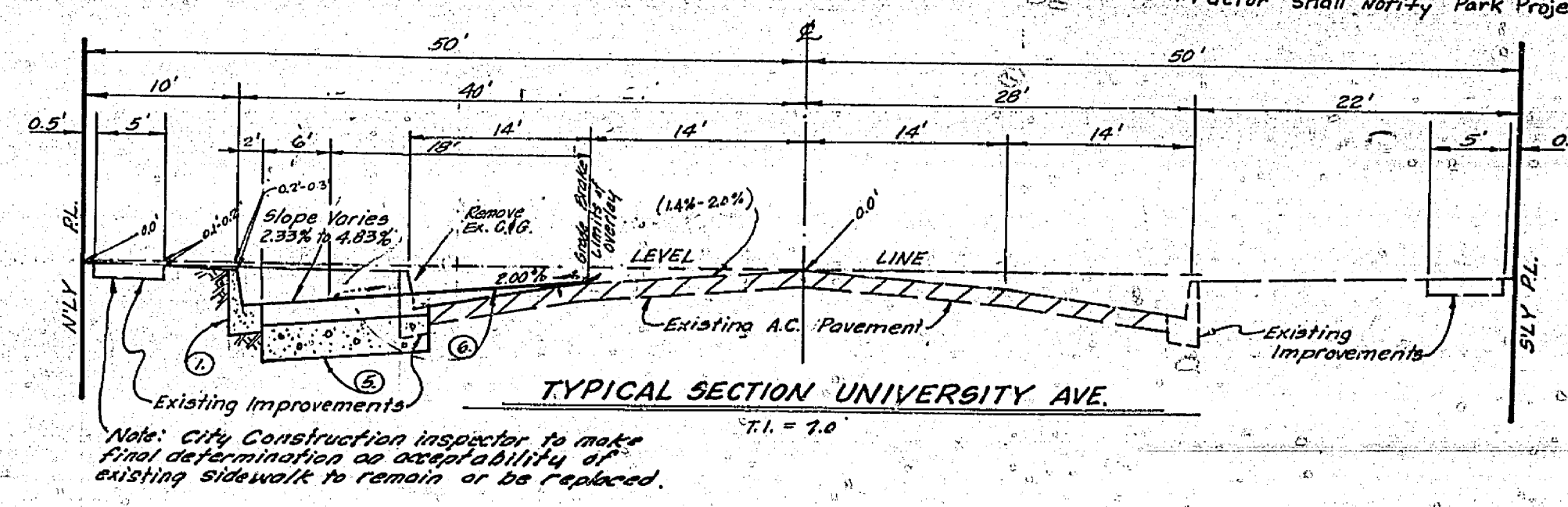

CITY OF RIVERSIDE, CALIFORNIA ELECTRIC DEPARTMENT APP'D BY: <i>Paul Capoff</i> DATE: 12-7-78	LINVILLE, SANDERSON, HORN & ASSOC. Civil Engineering and Land Surveying 99 C Street, Suite 103 Upland, California - Phone 981-2811 APPROVED BY: <i>Benjamin H. Linnville</i> DATE: 12/29/78 R.E. No. 22306	CITY OF RIVERSIDE, CALIFORNIA PUBLIC WORKS DEPARTMENT		ACCOUNT NO. UNIVERSITY AVENUE OTTAWA AVENUE ELY 200' C-40-778
		MARK: _____ DESIGNED BY: <i>BR</i> DRAWN BY: <i>BR</i> CHECKED BY: <i>MLF</i>	REVISIONS: _____ APPR. DATE: _____	APPROVED BY: <i>William D. Anderson</i> DIRECTOR OF PUBLIC WORKS DATE: 12-27-78