

PROFILE
SCALE: HOR. 1" = 20'
VERT. 1" = 4'

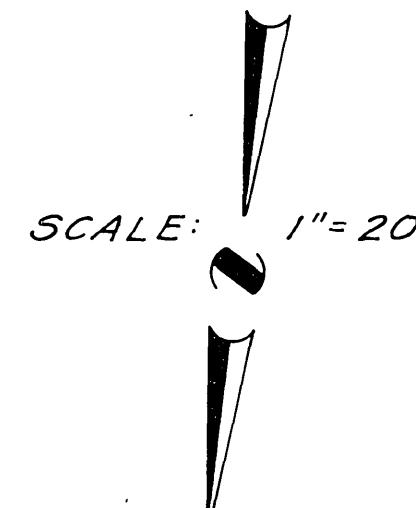

GENERAL NOTES

1. Construction shall be in accordance with the City of Riverside, Department of Public Works, Standard Drawings, and the Standard Specifications for Public Works Construction, 1979 Edition.
2. It shall be the responsibility of the contractor to clear the right of way in accordance with the provisions of law as it affects each utility including irrigation lines and appurtenances and at no cost to the city.
3. Trim edge of existing pavement where new pavement joins to a smooth, straight line. Construct match-up paving as shown on plan and overlay paving as directed in the field to produce a smooth section.
4. All flagged elevations shall be staked in the field by the private engineer.
5. Quantities shown are for information only and the City of Riverside is not responsible for their accuracy.

LIMITS OF THIS PROJECT

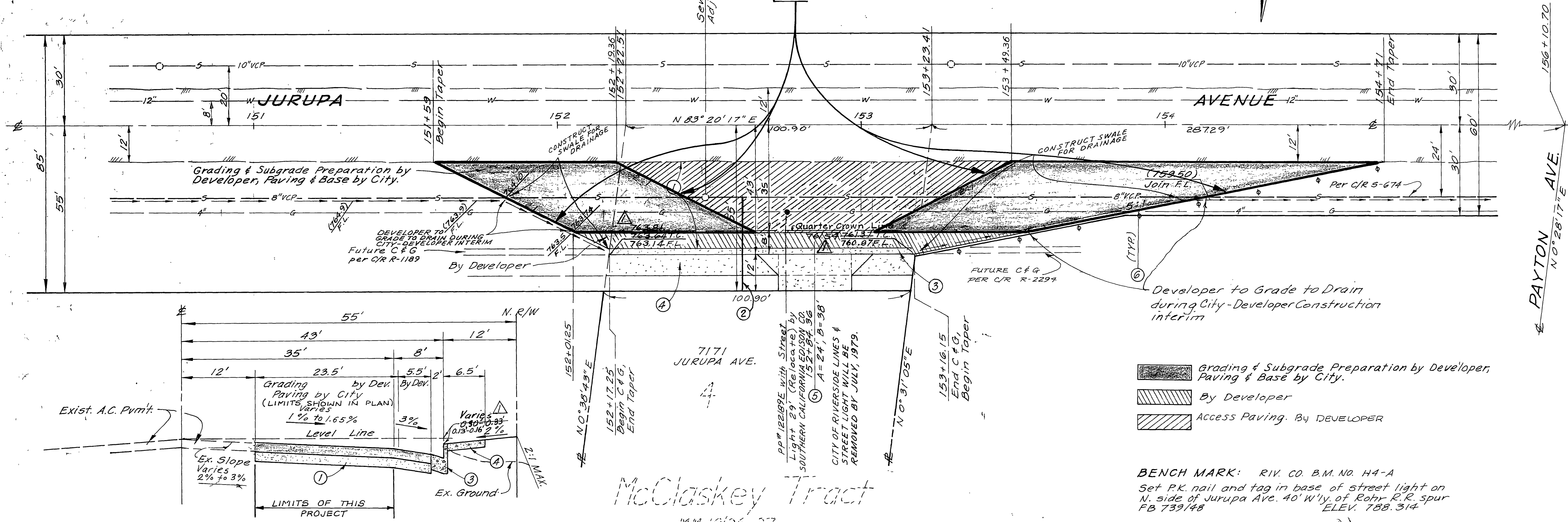

PAYTON AVE
N 0° 28' 17" E

- CONSTRUCTION NOTES
1. Const. 4 1/2" A.C. over 1 1/2" O.G.
 2. S.R. 215, R.C. 5.
 3. Place 4" VCP Sewer lateral, "Y" laid flat.
 4. Const. Curb & Gutter Type I (SEE) per Std. No. 200.
 5. Const. Curb Sidewalk per Std. No. 325.
 6. Const. Driveway Approach per Std. No. 302 (Type II).
 7. Install Type "L" Guide Markers per Std. No. 665, 20' c.c.
- * BY DEVELOPER

BENCH MARK: RIV. CO. B.M. NO. H4-A
Set P.K. nail and tag in base of street light on N. side of Jurupa Ave. 40' Wly of Rohr R.2 Spur
ELEV. 788.314

JURUPA AVENUE
TYPICAL HALF SECTION

Scale: Horiz. 1" = 10'
Vert. 1" = 2'
T.I. = 9

APPROVED BY: <i>C. P. ...</i> CHIEF UTILITIES ENGINEER GAS DATE 6/8/79	APPROVED BY: <i>...</i> CHIEF UTILITIES ENGINEER WATER DATE	APPROVED BY: <i>...</i> SOUTHERN CALIFORNIA EDISON CO. DATE 10-1-79
--	---	---

JOHN B. ABELL
5658 E. BEVERLY BLVD.
LOS ANGELES, CA 90022
PH. (213) 723-5500
R.C.E. 9070
DATE 3-22-79
FOR: TEBALD AND ASSOCIATES

MARK	REVISIONS	APPR. DATE
DESIGNED BY: J.A.	DRAWN BY: B.F.	CHECKED BY: B.F.

CITY OF RIVERSIDE, CALIFORNIA
DEPARTMENT OF PUBLIC WORKS

APPROVED BY:	DATE
PRINCIPAL ENGINEER	9/5/80
PARK DEPARTMENT	
TRAFFIC DIVISION	9/5/80
CHIEF P.W. ENGR.	

JURUPA AVENUE PAVEMENT
PARTICIPATION W/ MP-10-789

NLY SIDE, FROM 388.19' ELY OF, TO
287.29' ELY OF PAYTON AVENUE

HORIZ. SCALE: 1" = 20'
VERT. SCALE: 1" = 4'

PROJECT NO. 30-575-316-07
R-2215 A
SHEET 1 OF 2
FILE NO.