

CONSTRUCTION NOTES

- ① Construct 2 1/2" A.C. over 8" D.G. base, PER CITY OF RIVERSIDE PLAN NO. R-193.
- ② Construct P.C.C. Curb and Gutter, Type I, 6" C.F. per Std Dwg. No. 200.
- ③ Construct P.C.C. Curb Line Sidewalk per Std Dwg. 325.
- ④ Construct P.C.C. Driveway Approach, Type II, per Std Dwg. 302, A=20', B=27'. EXACT LOCATION TO BE DETERMINED AT THE TIME OF CONSTRUCTION AS APPROVED BY THE TRAFFIC ENGINEER.
- ⑤ REMOVE EXIST. PAVING TO 1/2" FROM STA. 8+00.00 TO STA. 9+05.77
- ⑥ REMOVE EXIST. REDWOOD HEADER AT E.P.
- ⑦ REMOVE EXIST. STORM DRAIN ACCESS AND REPLACE WITH ALHAMBRA FOUNDRY 20" COVER AND FRAME.
- ⑧ CONSTRUCT BARRIER PER STD DWG. NO. 180
- ⑨ ADJUST MANHOLE TO GRADE
- ⑩ REMOVE TOP 1.5' OF EXIST. 12" x 18" CONC. HEADWALL
- ⑪ INSTALL 2" x 4" REDWOOD HEADER
- ⑫ CONSTRUCT 4" SEWER LATERAL PER STD DWG. 502
- ⑬ PLANT STREET TREES PER CITY OF RIVERSIDE PARKS AND RECREATION STANDARDS.

STREET TREE PLANTING NOTES

1. ALL RELATED WORK SHALL CONFORM TO THE CITY OF RIVERSIDE, PARK AND RECREATION DEPARTMENT STANDARDS.
2. CONTACT THE PARK PROJECTS INSPECTOR A MINIMUM OF 48 HRS. IN ADVANCE AT 787-7223 TO SCHEDULE INSPECTIONS. INSPECTIONS SHALL BE REQUIRED: A) WHEN PLANT LOCATIONS HAVE BEEN SPOTTED IN THE FIELD PRIOR TO DIGGING PLANT PITS, B) WHILE DIGGING PLANT PITS AND PLANTING, C) AFTER PLANTING AND ALL OTHER INDICATED OR SPECIFIED WORK HAS BEEN COMPLETED FOR START OF MAINTENANCE, AND D) AT THE END OF MAINTENANCE / FINAL ACCEPTANCE (DEVELOPER WILL BE RELEASED FROM MAINTENANCE ONLY UPON RECEIPT OF WRITTEN NOTIFICATION FROM THE CITY THAT THE PARK AND RECREATION DEPARTMENT IS ASSUMING MAINTENANCE RESPONSIBILITIES).
3. THE DEVELOPER SHALL MAINTAIN ALL PLANTINGS FOR A MINIMUM PERIOD OF ONE (1) YEAR.
4. STREET TREE PLANTING SHALL BE AS FOLLOWS:

STREET NAME	BOTANICAL NAME / COMMON NAME	MIN. SIZE	SPACING
A. CORRELL STREET	FRAXINUS VELUTINA GLABRA / MADONISTO ASH	15 GAL	50'

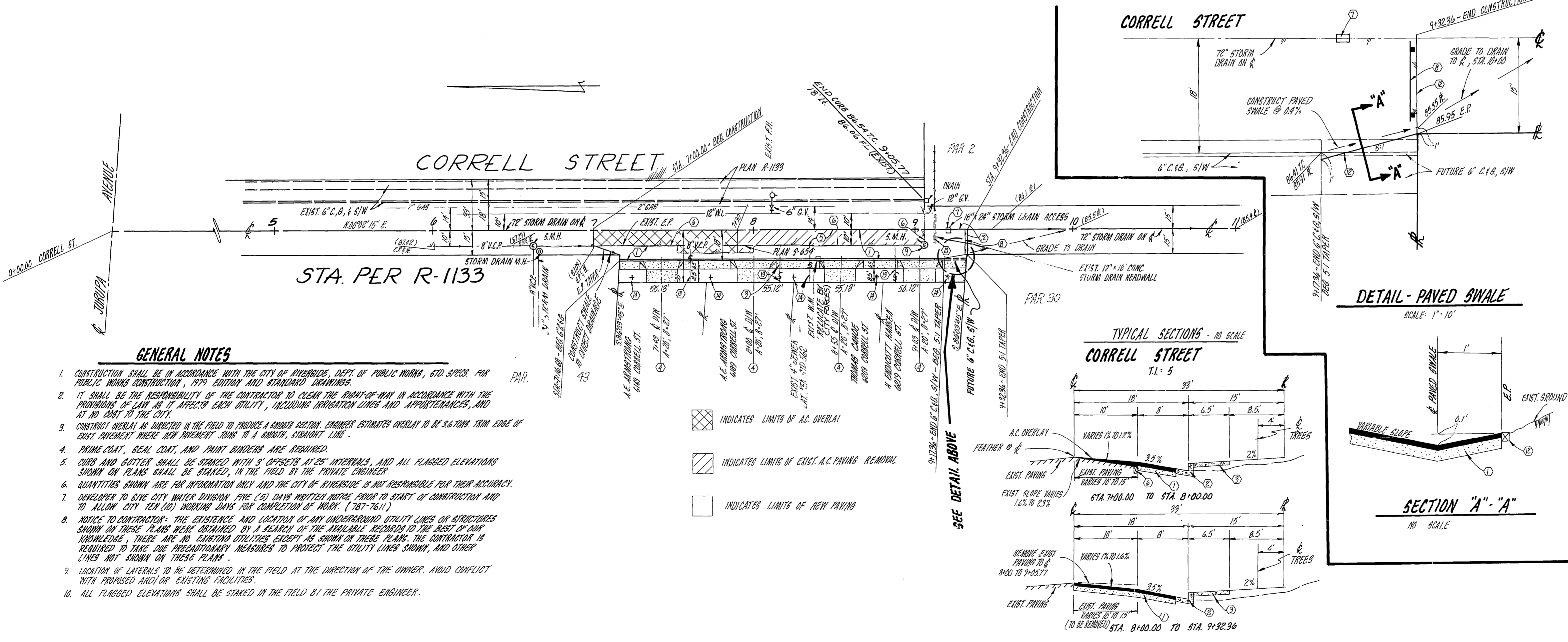

ESTIMATE OF QUANTITIES

2 1/2" A.C. PAVING	3175	50 FT.
B. D.G. BASE	3175	50 FT.
TYPE I (6" C.F.) CURB & GUTTER, STD. NO. 200	704.43	50 FT.
6" C.F. LINE SIDEWALK, STD. NO. 325	1310	50 FT.
DRIVEWAY APPROACH, STD. NO. 302	4	EA.
REMOVE EXIST. PAVING	1280	50 FT.
A.C. OVERLAY	36	TONS
REMOVE EXIST. REDWOOD HEADER	275	L.F.
ALHAMBRA FOUNDRY 20" COVER AND FRAME	1	EA.
REMOVE TOP OF EXIST. 12" x 18" CONC. STORM DRAIN HEADWALL	16	L.F. x 13'
BARRIER PER STD. NO. 180	16	L.F.
ADJUST SEWER MH TO GRADE	1	EA.
REDUCATE WATER METER - 3" TO 4"	1	EA.
2" x 4" REDWOOD HEADER	40	L.F.
4" SEWER LATERAL	69	L.F.
REMOVE EXIST. STORM DRAIN ACCESS	1	EA.
MADONISTO ASH	5	EA.

NOTE

The private engineer signing these plans is responsible for assuring the accuracy and acceptability of the work hereon. In the event of discrepancies arising during construction as a result of errors or omissions, the private engineer shall be responsible for determining an acceptable solution and revising the plans for approval by the City.

NOTE: THIS IS SAME AS PM 15896 RECORDED 10/22/81

BENCHMARK H.S.D.
SET PK NAIL AND TAG IN S.W. CORNER RETURN AT TOROPIA AVE. AND STREETER AVE.
ELEV. 708.68'

CITY OF RIVERSIDE DOMESTIC SYSTEM Fred Lantz 2/10/80 BY WATER SYSTEM MANAGER DATE	GARY L. ANERS ENGINEERING 10 BOX 306 PERRIS, CALIFORNIA 92370 657-2159 Gary L. Aners 3-23-79 D.C.E. 23719 DATE	MARK REVISIONS DESIGNED BY: <i>ML</i> DRAWN BY: <i>ML</i> CHECKED BY: <i>EA</i>	CITY OF RIVERSIDE, CALIFORNIA DEPARTMENT OF PUBLIC WORKS		STREET IMPROVEMENT PLAN CORRELL STREET FROM 700' SOUTH OF TOROPIA AVE. TO 992' SOUTH BUILDING PERMIT 6169-8219 CORRELL ST.	PROJECT NO. R-2250 SHEET 1 OF 1 FILE NO.
			APPROVED BY: <i>[Signature]</i> DIRECTOR OF PUBLIC WORKS DATE: 2/10/80	APPROVED BY: <i>[Signature]</i> TRAFFIC DIVISION CHIEF P. W. ENGR. DATE: 2/10/80		