

NOTICE TO CONTRACTOR:

THE EXISTENCE AND LOCATION OF ANY UNDERGROUND UTILITY PIPES OR STRUCTURES SHOWN ON THIS PLAN ARE OBTAINED BY A SEARCH OF THE AVAILABLE RECORDS. TO THE BEST OF OUR KNOWLEDGE, THERE ARE NO EXISTING UTILITIES EXCEPT AS SHOWN ON THIS PLAN. THE CONTRACTOR IS REQUIRED TO TAKE DUE PRECAUTIONARY MEASURES TO PROTECT THE UTILITY LINES SHOWN AND ANY OTHER LINES NOT OF RECORD OR NOT SHOWN ON THIS PLAN.

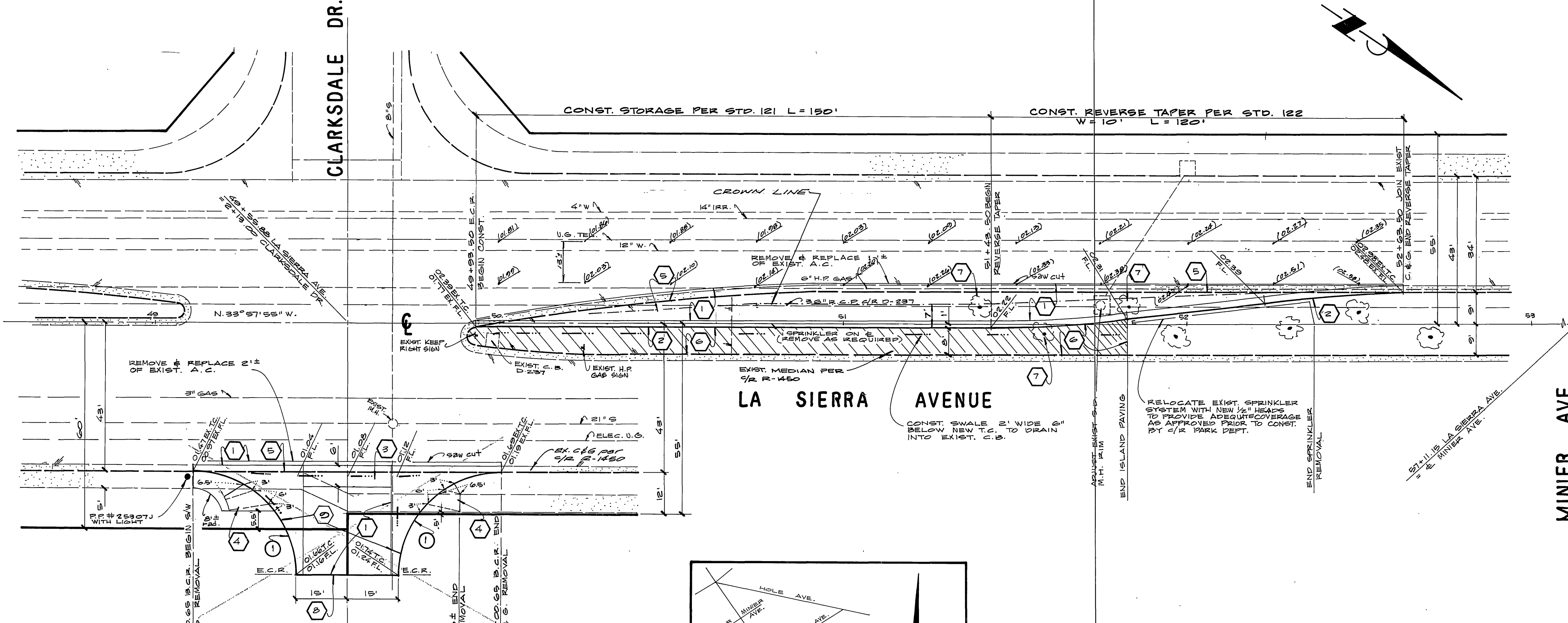
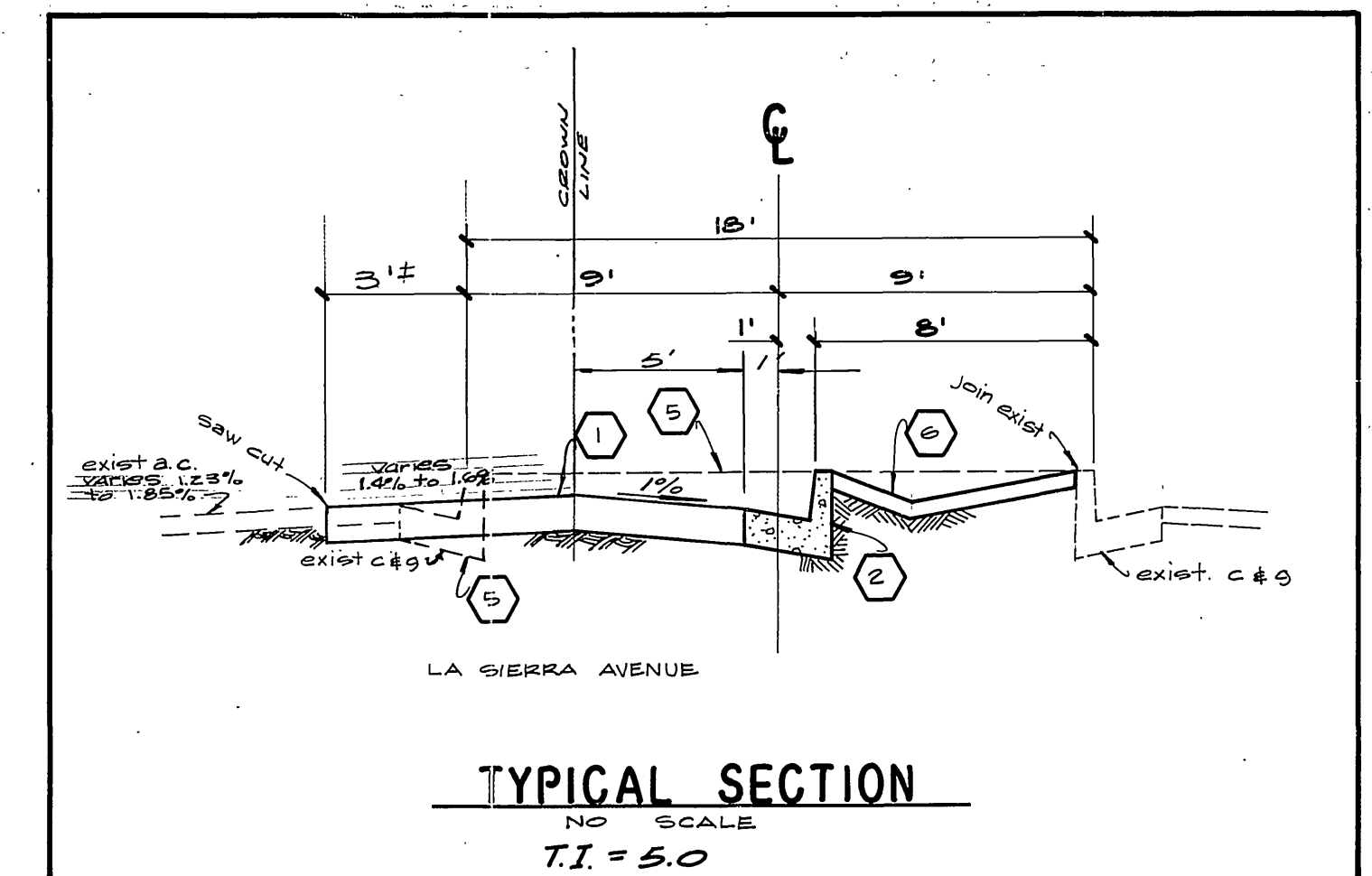
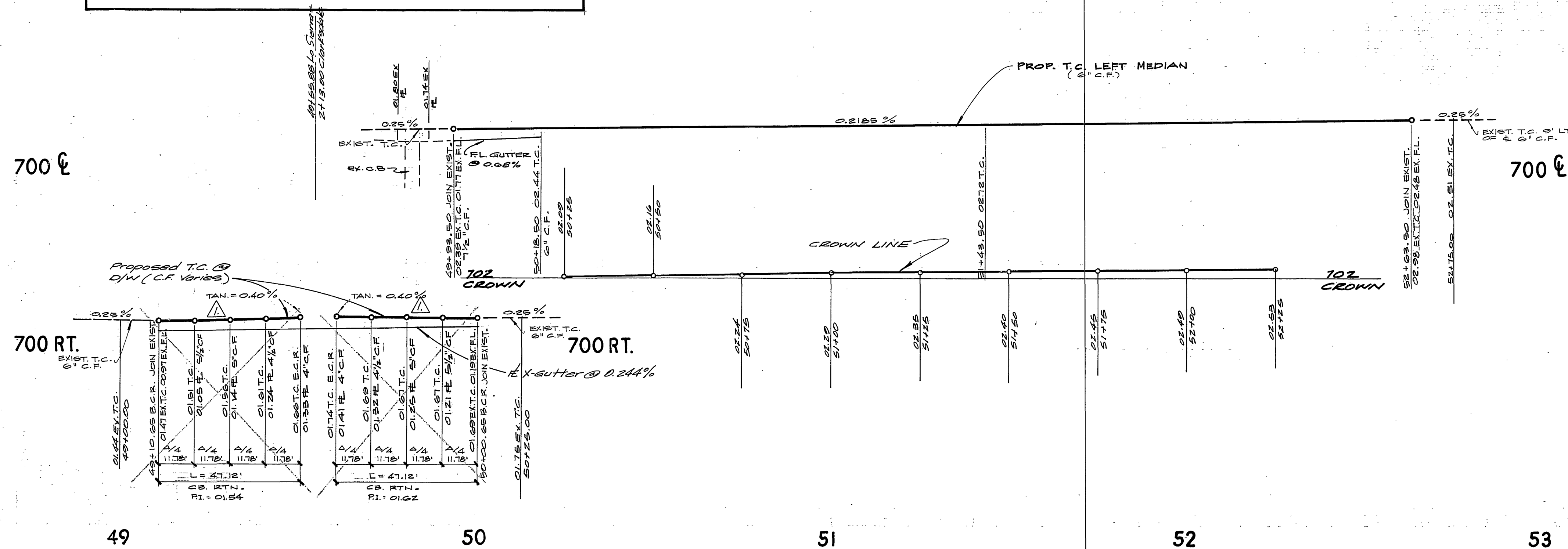

GENERAL NOTES

- IT SHALL BE THE RESPONSIBILITY OF THE CONTRACTOR TO CLEAR THE RIGHT OF WAY IN ACCORDANCE WITH THE PROVISIONS OF LAW AS IT AFFECTS EACH UTILITY INCLUDING IRRIGATION LINES AND APPURTENANCES AND AT NO COST TO THE CITY.
- CONSTRUCTION SHALL BE IN ACCORDANCE WITH THE CITY OF RIVERSIDE, DEPARTMENT OF PUBLIC WORKS, STANDARD DRAWINGS, AND THE STANDARD SPECIFICATIONS FOR PUBLIC WORKS CONSTRUCTION, 1979 EDITION.
- TRIM EDGE OF EXISTING PAVEMENT WHERE NEW PAVEMENT JOINS TO A SMOOTH, STRAIGHT LINE. CONSTRUCT MATCH-UP PAVING AS SHOWN ON PLAN AND OVERLAY PAVING AS DIRECTED IN THE FIELD TO PRODUCE A SMOOTH SECTION. ENGINEER ESTIMATES OVERLAY TO BE TONS.
- CONTACT PARK AND RECREATION DEPT., TREE DIVISION, AT 707-7928 24 HOURS PRIOR TO TREE REMOVAL AND IRRIGATION RELOCATION.
- ALL FLAGGED ELEVATIONS SHALL BE STAKED IN THE FIELD BY THE PRIVATE ENGINEER.
- THE PRIVATE ENGINEER SIGNING THESE PLANS IS RESPONSIBLE FOR THE ACCURACY AND ACCEPTABILITY OF THE WORK HEREON. IN THE EVENT OF DISCREPANCIES ARISING DURING CONSTRUCTION, THE PRIVATE ENGINEER SIGNING THESE PLANS SHALL BE RESPONSIBLE FOR DETERMINING AN ACCEPTABLE SOLUTION AND REVISING THE PLANS FOR APPROVAL BY THE CITY.
- CURB AND GUTTER SHALL BE STAKED WITH 3' OFFSETS AT 12.5' INTERVALS AND TWO ROWS OF #3 REBARS SHALL BE PLACED IN GUTTER WHERE GRADE IS LESS THAN 0.55%. PLACE 3/4" DOVEL PIN AT ALL EXPANSION JOINTS.
- CONTRACTOR TO VERIFY EXISTING ELEVATIONS PRIOR TO CONSTRUCTION.

CONSTRUCTION NOTES

- CONST. 6" A.C. OVER COMPACTED NATIVE, PER R-1450 SH. 2.
- CONST. CURB AND GUTTER, TYPE I (6" C.F.), PER STD. NO. 200.
- CONST. X-GUTTER, PER STD. NO. 220.
- CONST. WHEELCHAIR RAMP, PER STD. NO. 304 (MODIFIED).
- REMOVE EXIST. IMPROVEMENTS.
- PLACE 2" A.C. OVER STERILIZED COMPACTED NATIVE SOIL.
- REMOVE EXIST. TREES.
- PLACE 2 X 4 REDWOOD HEADER.
- CONST. VARYING CURB FACE.

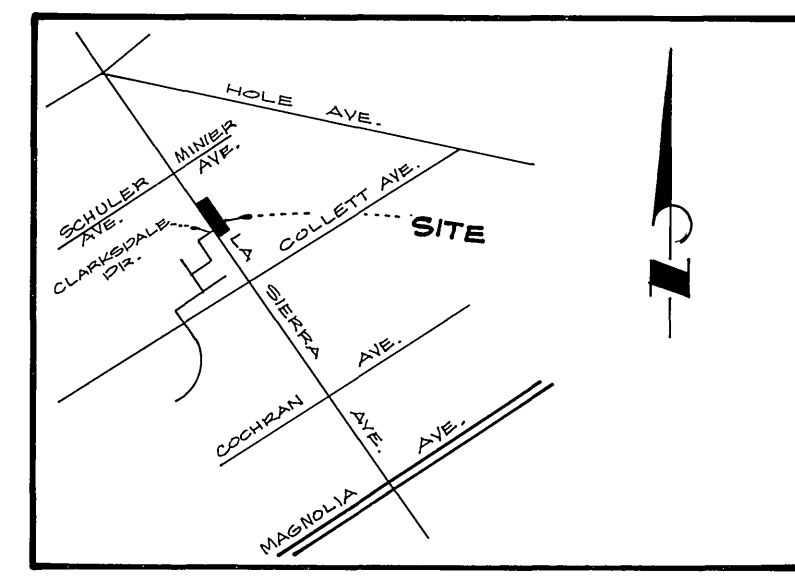

BENCH MARK: EL. = 704.25

R.R. SPIKE IN POWER POLE # 24580 OF SE CORNER LA SIERRA AND COLLETT. C/R F.B. 9/28/5

ALBERT A. WEBB ASSOCIATES CIVIL ENGINEERS RIVERSIDE, CALIFORNIA APPROVED BY: <i>[Signature]</i> DATE: 1/11/80 R.E. No. 2878		CITY OF RIVERSIDE, CALIFORNIA PUBLIC WORKS DEPARTMENT APPROVED BY: <i>[Signature]</i> DATE: 1/24/80 CHIEF PUB. WKS. ENGR.		ACCOUNT NO. DRAWING NUMBER R-2269 SHEET 1 OF 1 SCALE: HORIZ. 1" = 20' VERT. 1" = 4' 76-49 A
DESIGNED BY: <i>[Signature]</i>	DRAWN BY: <i>[Signature]</i>	CHECKED BY: <i>[Signature]</i>	DATE: 1/11/80	INDEXED R/E