

# RIVERSIDE CITY OF RIVERSIDE CALIFORNIA

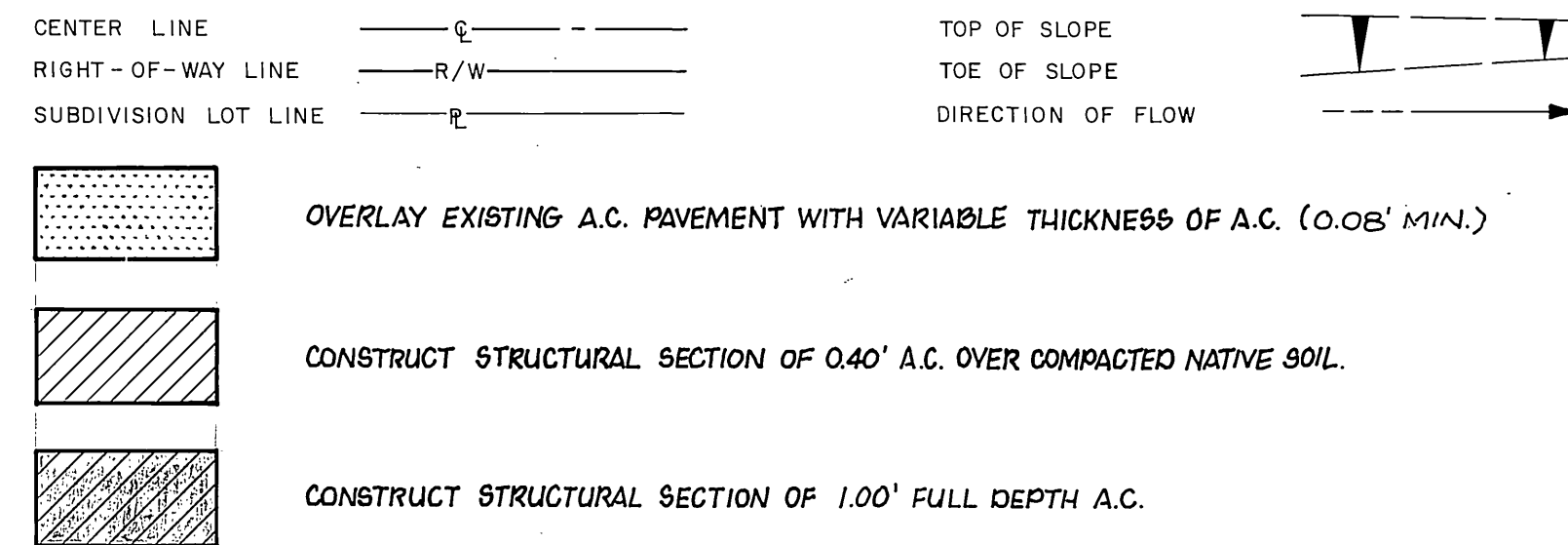

## PUBLIC WORKS DEPARTMENT CALIFORNIA AVE. at VAN BUREN BLVD. AND ARLINGTON AVE. FROM MONROE TO LOMITA

### CONSTRUCTION LEGEND



### EXISTING UNDERGROUND & TOPOGRAPHY LEGEND

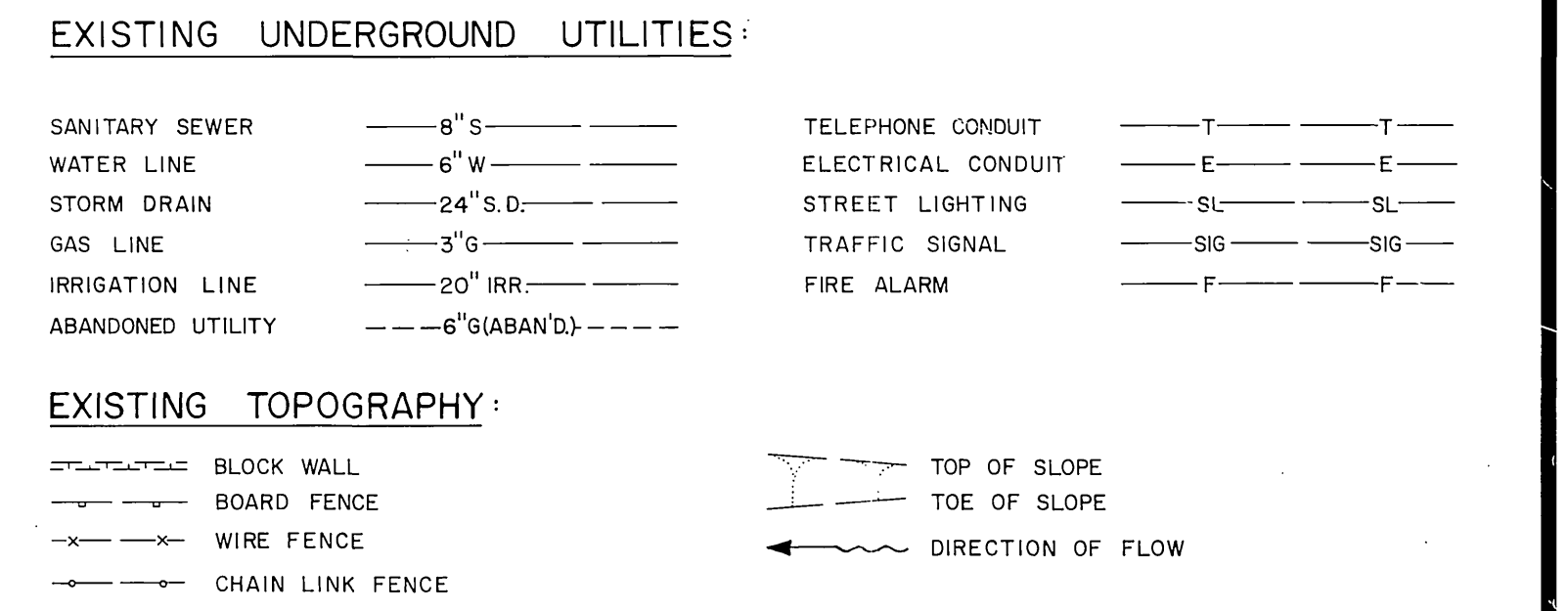

### SPECIFIC CONSTRUCTION NOTES

NUMBERS ABOVE 100 IN A HEXAGON ON THE PLAN REFER TO THE RESPECTIVE STANDARD DRAWING AND SHALL BE CONSTRUCTED ACCORDINGLY, UNLESS MODIFICATIONS ARE NOTED ON THE PLAN OR COVER SHEET BELOW. ANY NUMBER SHOWN BELOW THE STANDARD DRAWING NUMBER INDICATES THE SPECIFIC ALTERNATE TO BE CONSTRUCTED.

## FEDERAL - AID HAZARD ELIMINATION PROJECT NO. HES-0005(14)

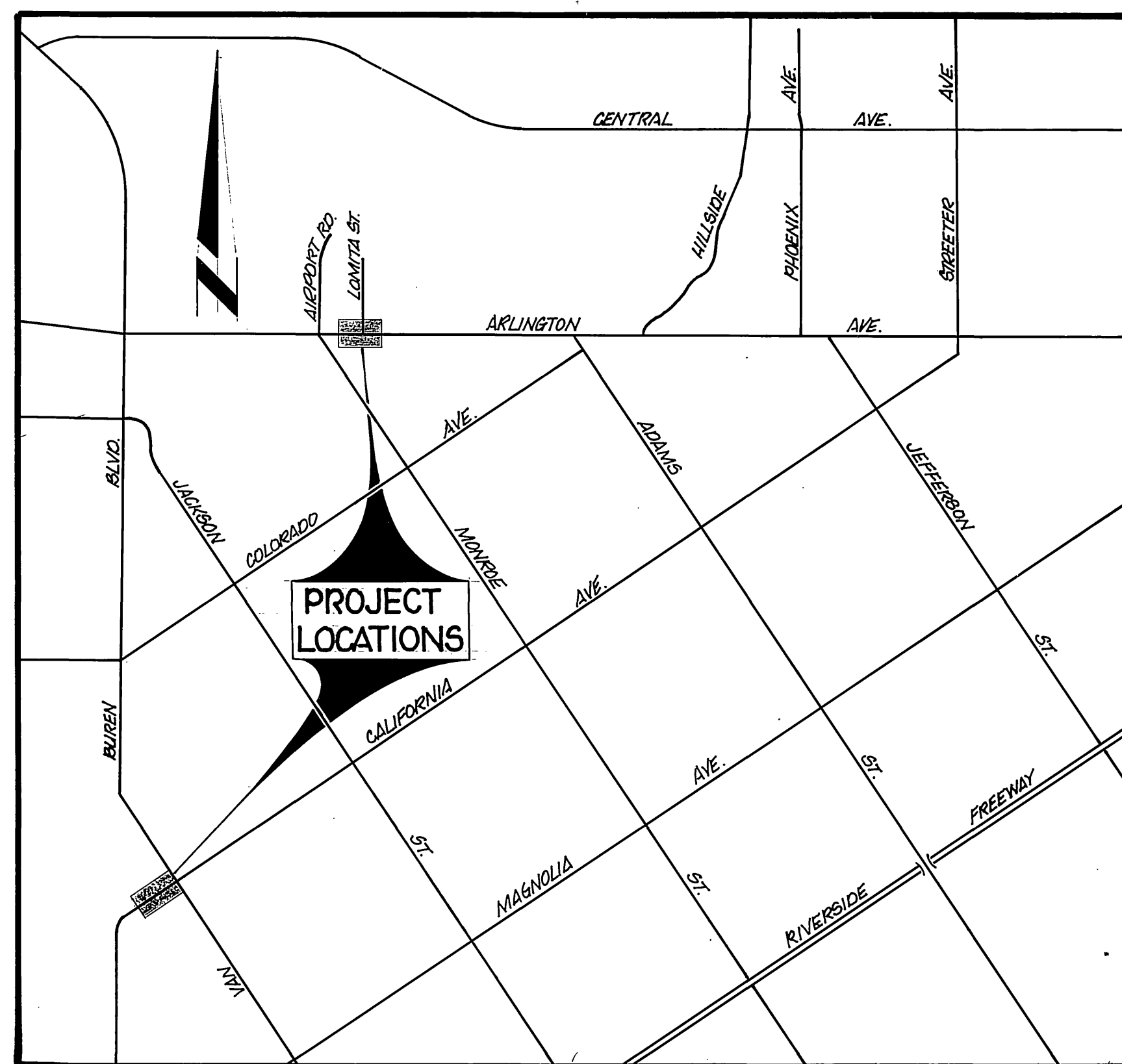

PROJECT LOCATION PLAN

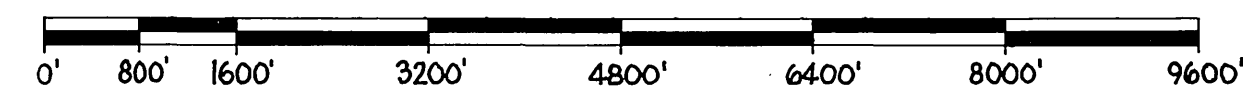

SCALE 1" = 1600'

### GENERAL CONSTRUCTION NOTES

- 1 ALL ELEVATIONS SHOWN ON THE PLAN SHALL BE STAKED IN THE FIELD.
- 2 EXISTING UTILITIES SHOWN ON THE PLAN ARE PLOTTED FROM UTILITY RECORDS. THE CONTRACTOR IS REQUIRED TO TAKE DUE PRECAUTIONARY MEASURES TO LOCATE AND PROTECT ALL UTILITIES WHETHER OR NOT THEY ARE SHOWN ON THE PLAN.

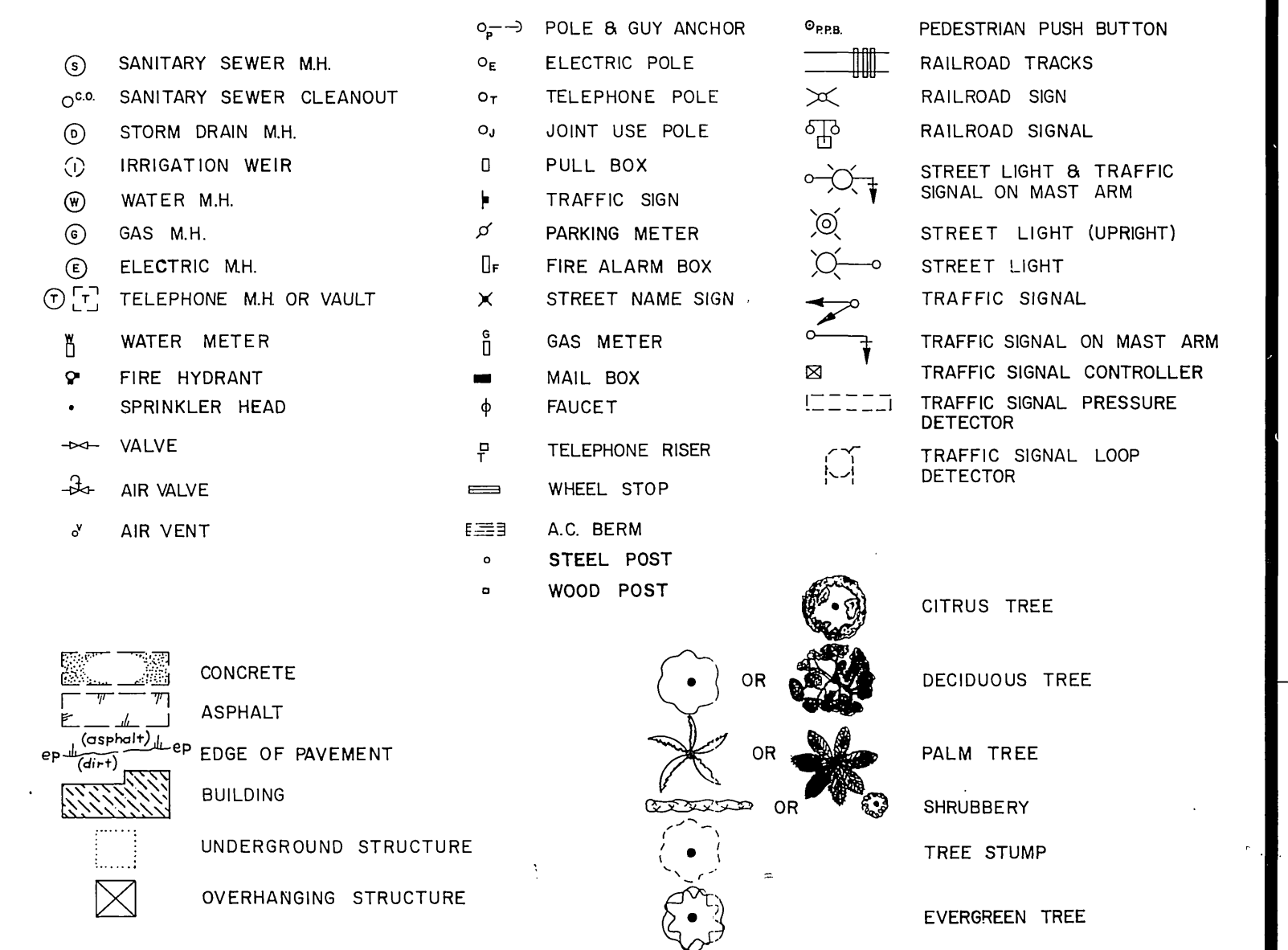

<b>CITY OF RIVERSIDE</b>		<b>CALIFORNIA at VAN BUREN &amp; ARLINGTON AVE. - MONROE TO LOMITA</b>		ACCOUNT No. 30-575-328-05
<b>PUBLIC WORKS DEPARTMENT</b>		<b>FEDERAL - AID HAZARD ELIMINATION PROJECT NO. HES-0005(14)</b>		DRAWING NUMBER
APPROVED BY:	BY:	DATE:	APPROVED BY:	<b>R-2309</b>
PRINCIPAL ENGINEER	JRE	5/1/81	PUBLIC WORKS DIRECTOR	SHEET 1 OF 4
TRAFFIC DIVISION	gml	5-5-81	CE 9206	
CHIEF P.W. ENGINEER			DATE <b>May 12, 1981</b>	
		DESIGNED BY <b>BIM</b> DRAWN BY <b>SK</b> CHECKED BY <b>LOH</b>		

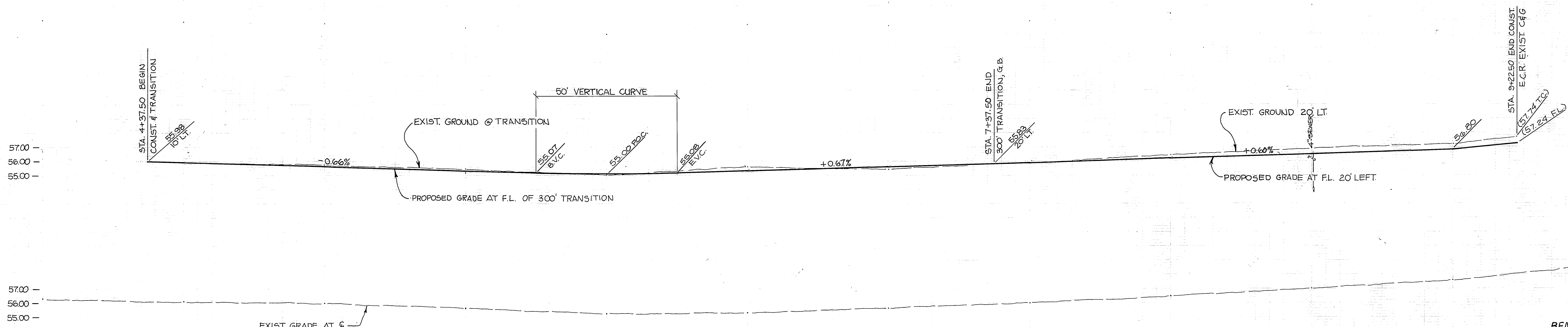

**BENCH MARK F-3D**  
 PK. NAIL N'LY CORNER INTERSECTION  
 OF VAN BUREN BLVD. & CALIFORNIA  
 AVE.  
 FB. 1022/64 ELEV. 758.317

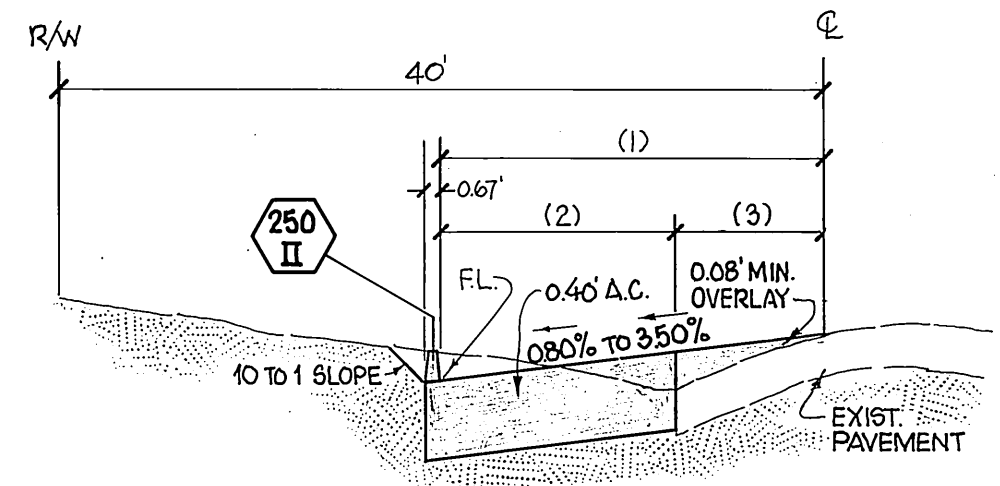
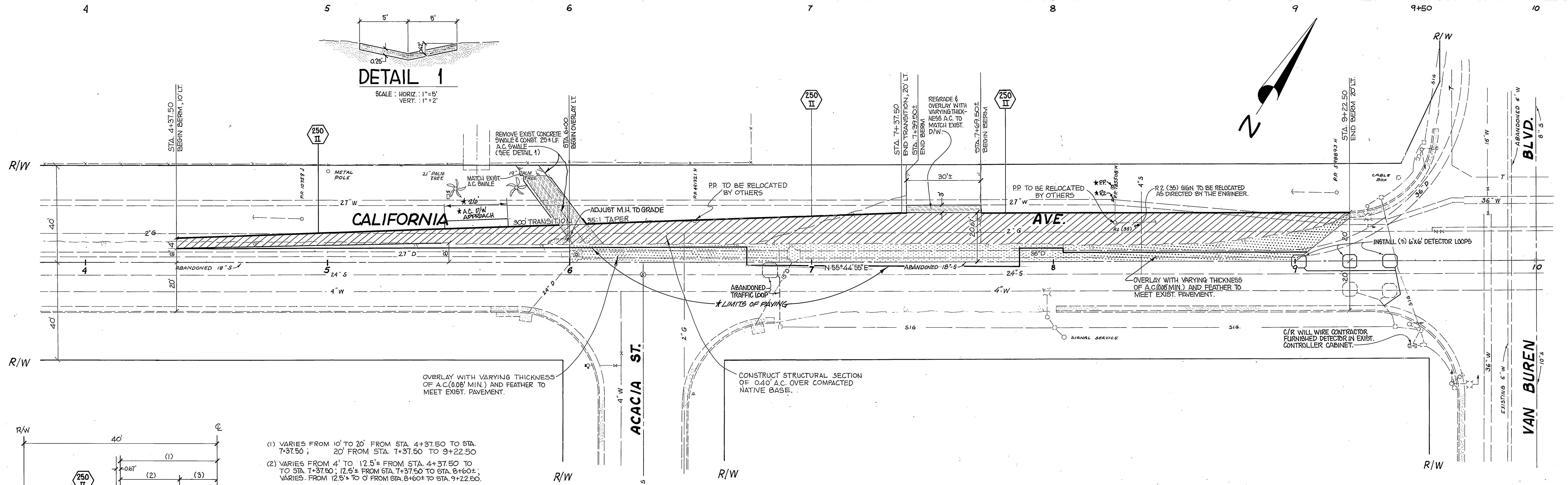
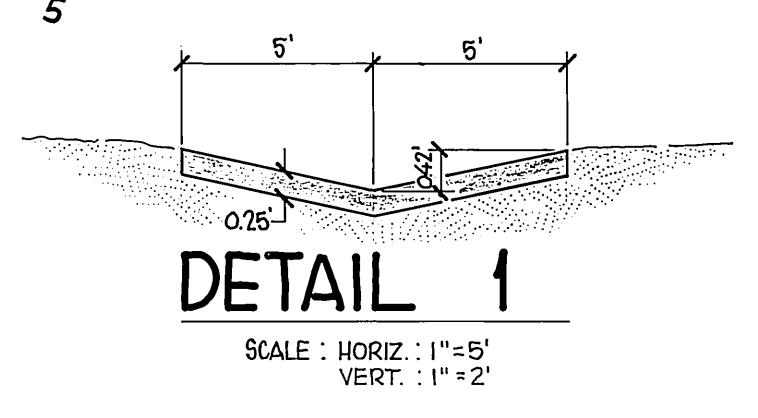

- (1) VARIES FROM 10' TO 20' FROM STA. 4+37.50 TO STA. 7+37.50 ; 20' FROM STA. 7+37.50 TO 9+22.50
- (2) VARIES FROM 4' TO 12.5' FROM STA. 4+37.50 TO STA. 7+37.50 ; 12.5' FROM STA. 7+37.50 TO STA. 8+60± ; VARIES FROM 12.5' TO 0' FROM STA. 8+60± TO STA. 9+22.50.
- (3) 7.5' ± FROM STA. 6+00 TO STA. 8+60± ; VARIES FROM 12.5' TO 2' STA. 8+60± TO STA. 9+22.50.

**TYPICAL SECTION**  
 STA. 4+37.50 to STA. 9+22.50

SCALE - HORIZ. : 1" = 40'  
 VERT. : 1" = 1'

<b>CITY OF RIVERSIDE</b> PUBLIC WORKS DEPARTMENT			<b>CALIFORNIA AVE.</b> at <b>VAN BUREN BLVD.</b>		INDEXED UP ACCOUNT NO. 30-515-328-07
APPROVED BY PRINCIPAL ENGINEER <i>[Signature]</i>		APPROVED BY PUBLIC WORKS DIRECTOR <i>[Signature]</i>		<b>R-2309</b> SHEET 2 OF 4	
TRAFFIC DIVISION CHIEF P. W. ENGINEER		DATE <b>MAY 13, 1981</b>		HORIZ. SCALE: 1" = 20' VERT. SCALE: 1" = 4' FILE NO.	
DESIGNED BY <i>BIM</i> DRAWN BY <i>EF</i> CHECKED BY <i>[Signature]</i>					

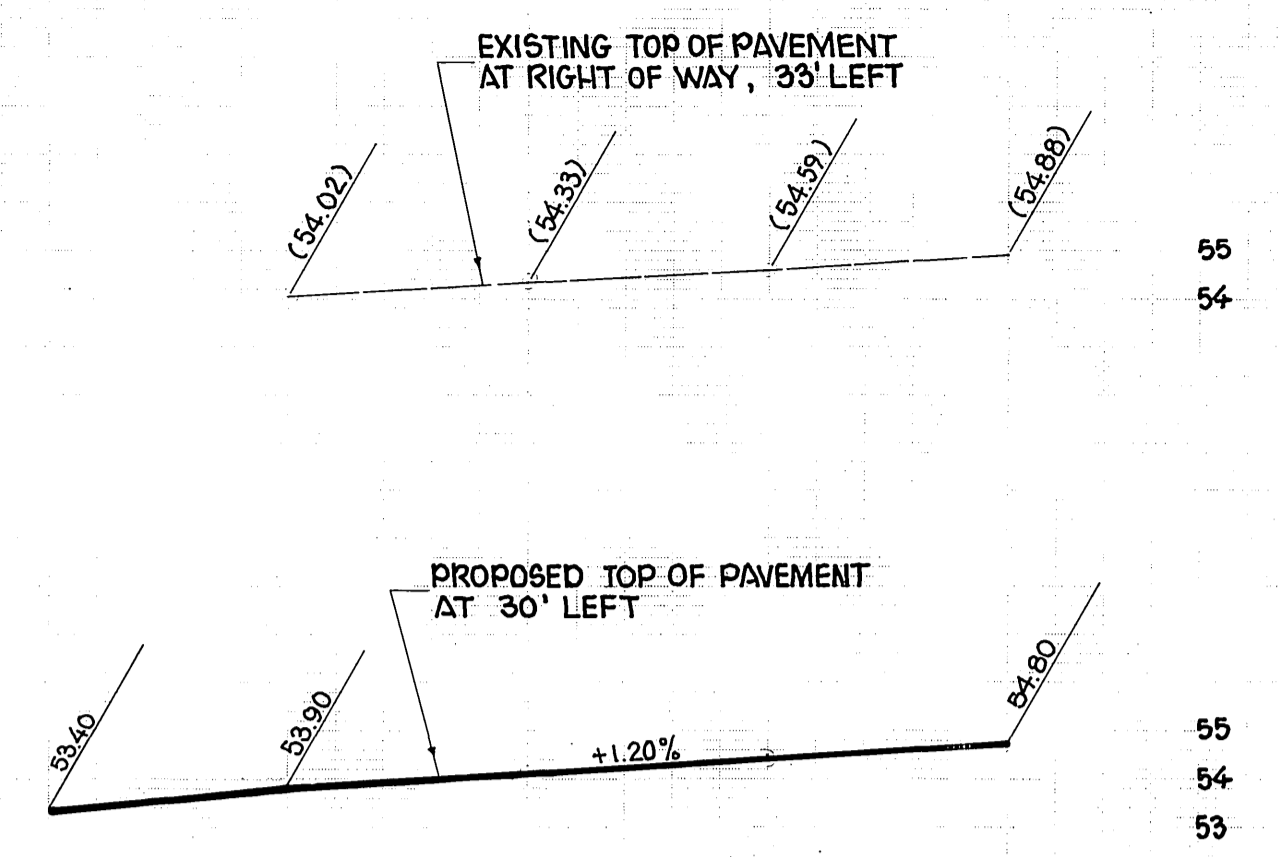

BENCH MARK - P.K. NAIL IN E. CURB OF MEDIAN ISLAND IN AIRPORT DRIVE 133' NORTH OF & ARLINGTON AVE. CRFB 961/23 ELEV. 752.71

27+00      27+50      28+00      28+50

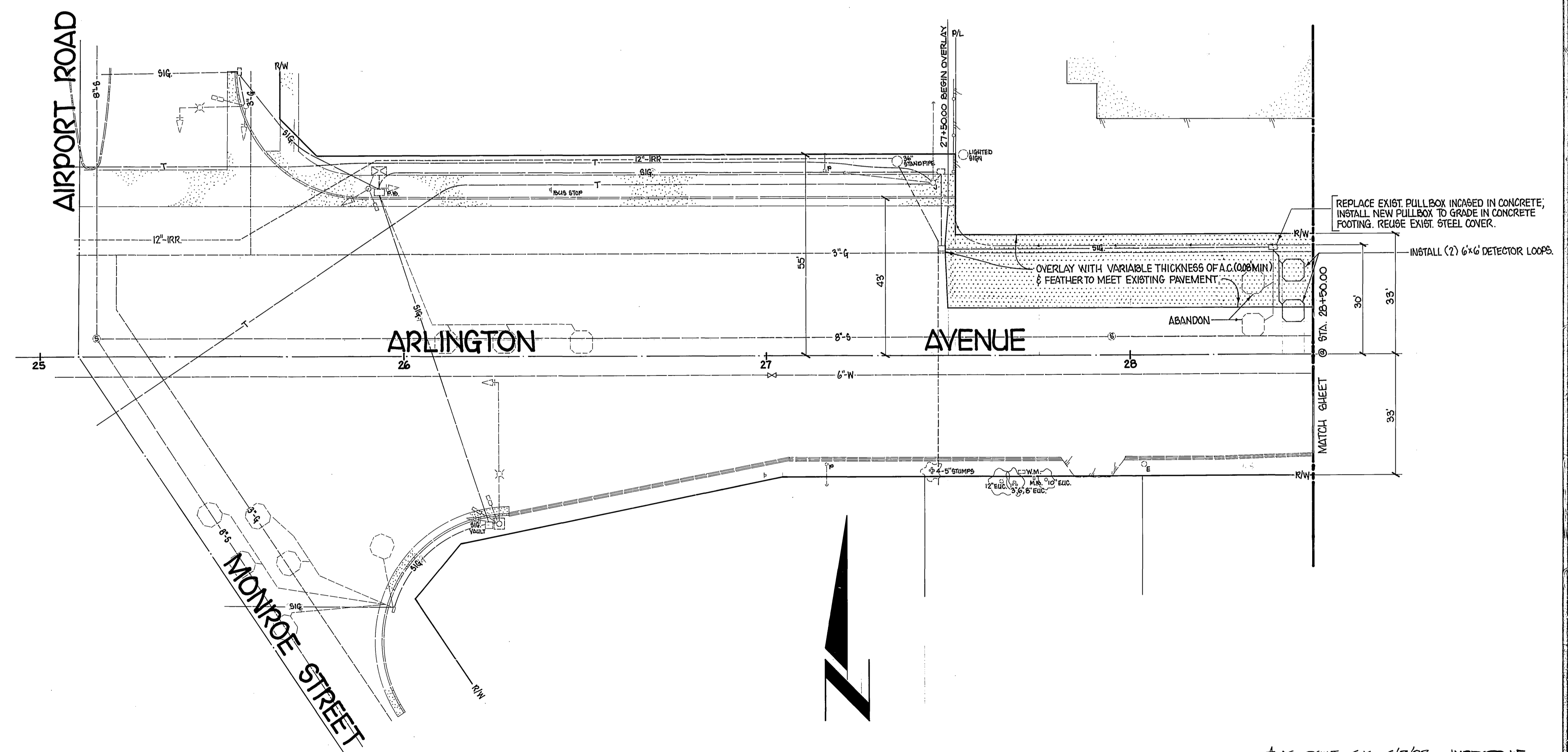

REPLACE EXIST. PULLBOX INCREASED IN CONCRETE; INSTALL NEW PULLBOX TO GRADE IN CONCRETE FOOTING. REUSE EXIST. STEEL COVER.

INSTALL (2) 6"x6" DETECTOR LOOPS.

OVERLAY WITH VARIABLE THICKNESS OF A.C. (0.08 MIN.) & FEATHER TO MEET EXISTING PAVEMENT.

ABANDON

MATCH SHEET @ STA. 28+00.00

AS BUILT SK 6/2/82 INCOMED UP

<b>CITY OF RIVERSIDE</b> PUBLIC WORKS DEPARTMENT		<b>ARLINGTON AVE.</b> MONROE TO LOMITA		ACCOUNT NO. 30-575-320-07 <b>R-2309</b>
APPROVED BY PRINCIPAL ENGINEER <i>[Signature]</i>	APPROVED BY PUBLIC WORKS DIRECTOR <i>[Signature]</i>	TRAFFIC DIVISION CHIEF P. W. ENGINEER <i>[Signature]</i>	DATE May 13, 1981	SHEET 3 OF 4 FILE NO.
DESIGNED BY BIM DRAWN BY SK CHECKED BY MM		HORIZ. SCALE: 1" = 20'      VERT. SCALE: 1" = 4'		

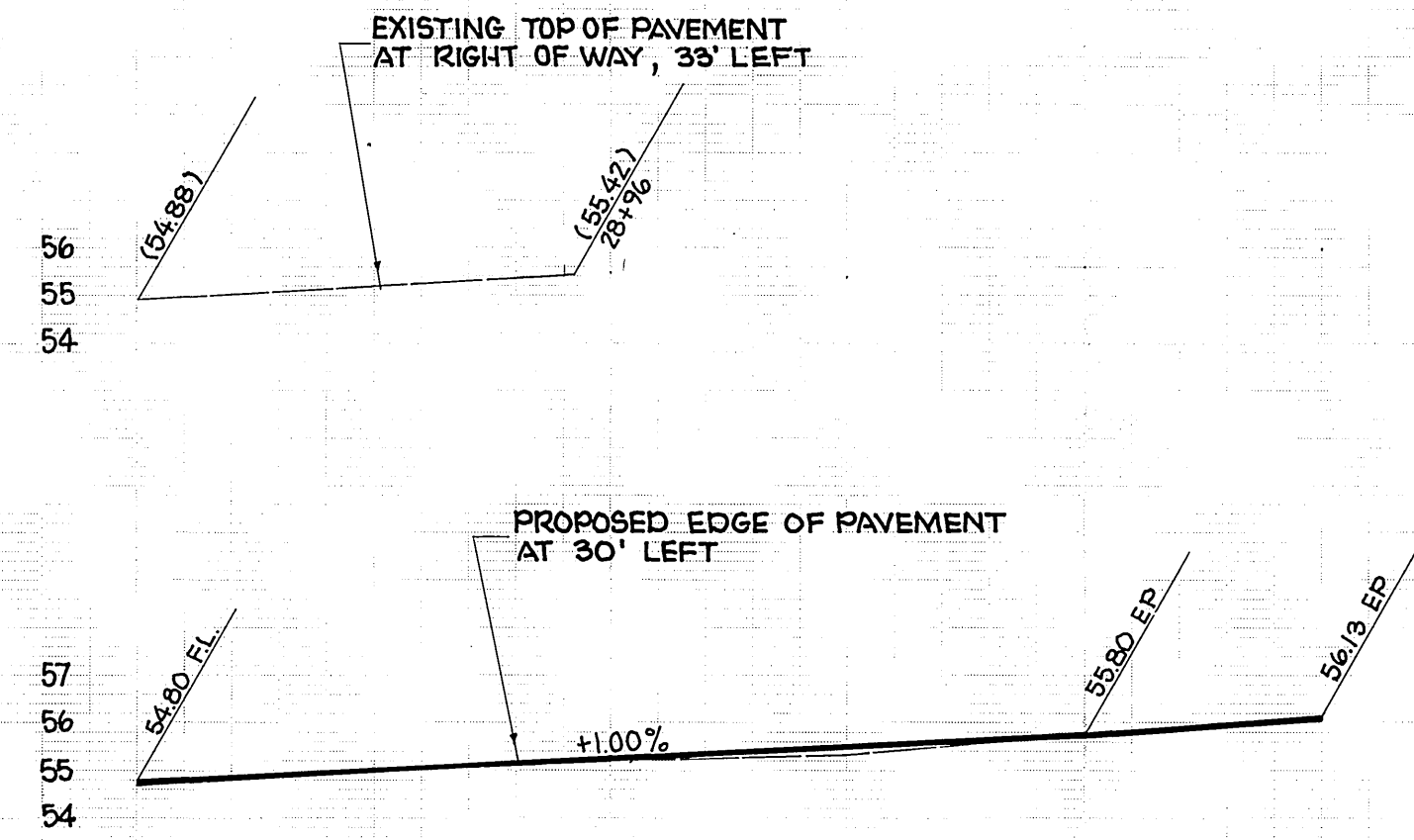

60  
59  
58  
57

BENCH MARK - P.K. NAIL IN E. CURB  
OF MEDIAN ISLAND IN AIRPORT DRIVE  
133' NORTH OF E. ARLINGTON AVE.  
CRFB 961/23 ELEV. 752.71

28+50 29+00 29+50 30+00 30+50 31+00 31+50 32+00 32+50 33+00

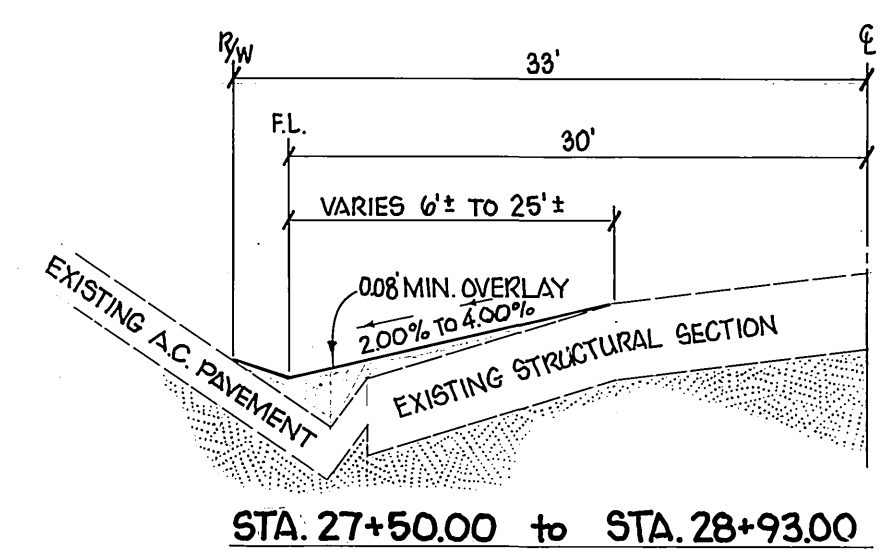

STA. 27+50.00 to STA. 28+93.00

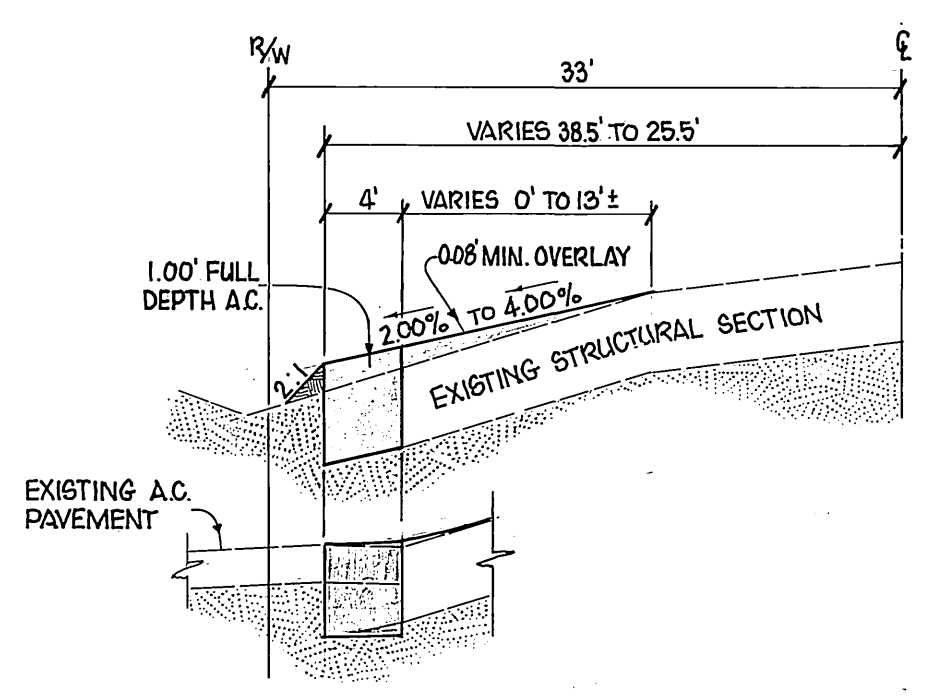

STA. 28+93.00 to STA. 29+75.00  
AND  
STA. 30+85.70 to STA. 32+50.00

**TYPICAL SECTIONS**

SCALE: HORIZ.: 1"=10'  
VERT.: NONE

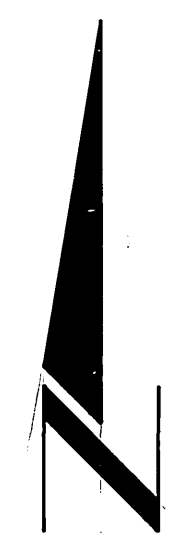
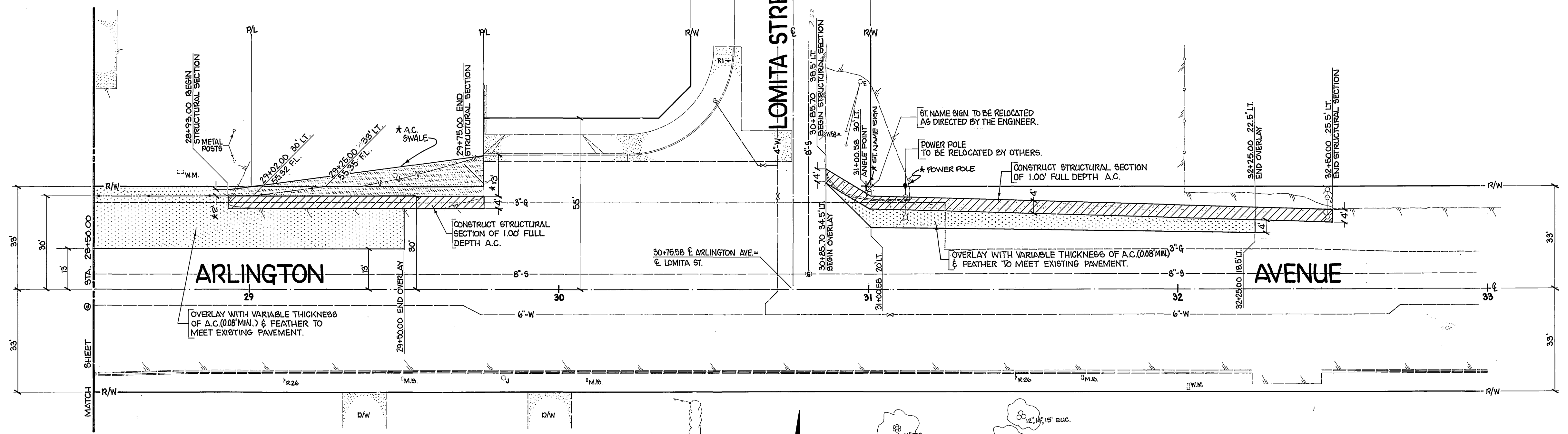

<p>DESIGNED BY BIM DRAWN BY SK CHECKED BY WJA</p>		<p>CITY OF RIVERSIDE PUBLIC WORKS DEPARTMENT</p>		<p>ARLINGTON AVE. MONROE TO LOMITA</p>		<p>ACCOUNT NO. 30-575-328-07 <b>R-2309</b> SHEET 4 OF 4 FILE NO.</p>	
<p>APPROVED BY PRINCIPAL ENGINEER</p>		<p>APPROVED BY CHIEF P. W. ENGINEER</p>		<p>APPROVED BY PUBLIC WORKS DIRECTOR</p>		<p>DATE <b>May 13, 1981</b></p>	
<p>MARK REVISIONS</p>		<p>APPR. DATE</p>		<p>TRAFFIC DIVISION</p>		<p>HORIZ. SCALE: 1" = 20' VERT. SCALE: 1" = 4'</p>	