

830 LT.

830 C

830 RT.

LT 830

C 830

RT 830

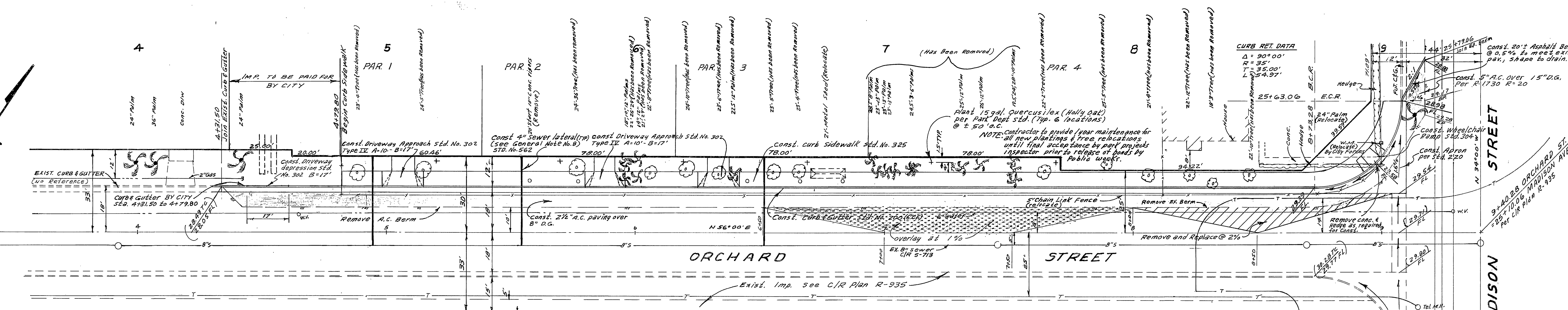
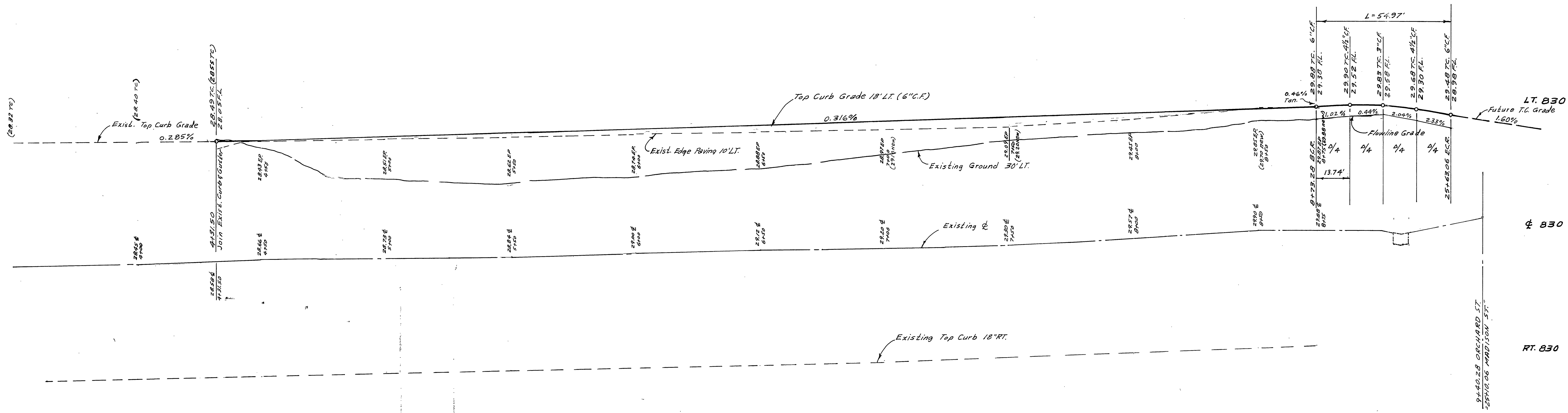

Note:

1. The contractor shall contact the Public Works Dept. two weeks prior to beginning construction to negotiate the cost of the city's portion of the work.
2. In order to coordinate the city's portion of the work, the developer shall give the city 60 days notice in order that the developer and the city's work may be installed concurrently. The developer shall prepare and compact rough subgrade (2:1) and is responsible for the condition of the subgrade until accepted by the city and until the city's contractor starts working. The developer is also responsible for barricading during this time.

GENERAL NOTES

1. The private engineer signing these plans is responsible for assuring the accuracy and acceptability of the work hereon. In the event of discrepancies arising during construction as a result of errors or omissions, the private engineer shall be responsible for determining an acceptable solution and revising the plans for approval by the City.
2. Construction shall be in accordance with City of Riverside Department of Public Works Standard Drawings and the Standard Specifications for Public Works Construction, 1979 Edition.
3. It shall be the responsibility of the Contractor to clear the right of way in accordance with the provisions of law as it affects each utility including irrigation lines and appurtenances and at no cost to the City.
4. Trim edge of existing pavement where new pavement joins to a smooth straight line. Construct match-up paving as shown on plan and overlay paving as directed in the field to produce a smooth section. Engineer estimates overlay to be 2\"/>
- 5. Curb and gutter shall be staked with 3' offsets at 12.5' intervals, and two rows of number 3 Re-bar shall be placed in gutter where grade is less than 0.40%. Place 1/4\"/>
- 6. All flagged elevations shall be stated in the field by the private engineer.
- 7. Construct driveway approaches per std. Div. 302. Exact size and location to be determined at time of const. as approved by the Traffic Engineer. Type II.
- 8. 4"x4" blockouts for manholes required in curb sidewalk.
- 9. Location of laterals to be determined in the field at the direction of the owner. Avoid conflict with proposed and/or existing facilities.
- 10. Contact Park and Recreation Dept. Park projects Inspector at 787-7223 48 hr. (two working days) in advance to schedule inspection at tree relocation and planting work.
- 11. Areas where trees have been removed in the right-of-way to be excavated, back filled and compacted to City Inspector's satisfaction.
- 12. Developer to give City Water Division five (5) working days written notice prior to start of construction and to allow ten (10) working days for completion of work. (787-7611)

NOTICE TO CONTRACTOR

The existence and location of any underground utility pipes or structures shown on these plans are obtained by a search of the available records. To the best of our knowledge, there are no existing utilities except as shown on these plans.

The contractor is required to take due precautionary measures to protect the utility lines shown and any other lines not of record or not shown on these plans.

NOTE: UNDERGROUND TEL. Call Underground Service Alert 48 hr. before shoveling. 1-800-422-4133

BENCH MARK

R.B. 73972 - P.K. nail and tag set in Traffic Signal Base @ SW corner of Madison and Orchard 814.40 GS-C

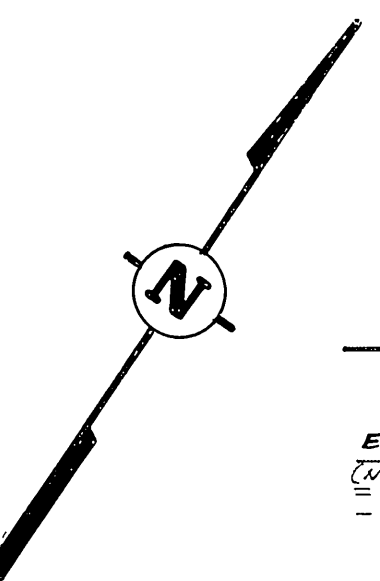

TYPICAL SECTION

ORCHARD STREET STA. 4131.50 TO STA. 8+73.28
NO SCALE
T.I. = 5

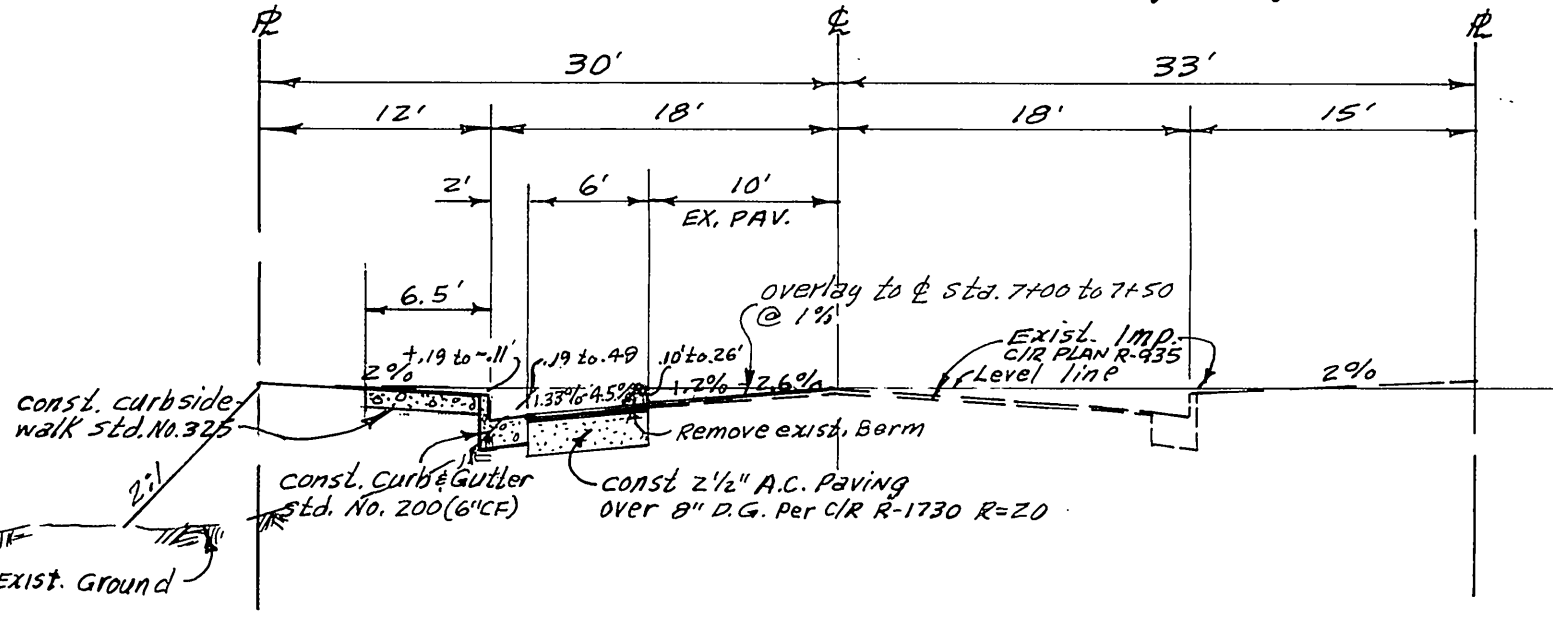

PACIFIC TELEPHONE CO. CITY RIVERSIDE DOMESTIC SYSTEM

APPROVED BY: *B.A. Haggner* 7/30/80 DATE WATER SYSTEM MANAGER

APPROVED BY: *Fred Lamb* 7/5/80 DATE

Ernest N. Wolf 9876 5/2/80

78-232 Charles Paul 1048 BEL BEL PA

STREET PLAN & PROFILE

ORCHARD STREET

MADISON STREET TO 500' WESTERLY

R.M. 15134

R-2313

78-232-A

1" = 20' Horiz. - 1" = 2' Vert.

INDEXED BY 8LD