

CONSTRUCTION NOTES

- 1 - CONSTRUCT CURB & GUTTER, PER C/R STD. 200.
- 2 - CONSTRUCT CURBLINE SIDEWALK, PER C/R STD. 325.
- 3 - INSTALL 6" A.C. OVER 1 1/2" P.G. OR 12 1/2" A.C. OVER COMPACTED NATIVE PER PLAN R-1501.
- 4 - INSTALL VARIABLE THICKNESS OVERLAY.
- 5 - REMOVE EXISTING IMPROVEMENTS.
- 6 - RELOCATE PALM ON RIVERSIDE AVE. TO THIS LOCATION ON CENTRAL AVE. AS PER DEPARTMENT OF PARK AND RECREATION STANDARDS.

GENERAL NOTES

1. THE PRIVATE ENGINEER SIGNING THESE PLANS IS RESPONSIBLE FOR THE ACCURACY AND ACCEPTABILITY OF THE WORK HEREON. IN THE EVENT OF DISCREPANCIES ARISING DURING CONSTRUCTION, THE PRIVATE ENGINEER SHALL BE RESPONSIBLE FOR DETERMINING AN ACCEPTABLE SOLUTION AND REVISING THE PLANS FOR APPROVAL BY THE CITY.
2. IT SHALL BE THE RESPONSIBILITY OF THE CONTRACTOR TO CLEAR THE RIGHT OF WAY IN ACCORDANCE WITH THE PROVISIONS OF LAW AS IT AFFECTS EACH UTILITY INCLUDING IRRIGATION LINES AND APPURTENANCES AND AT NO COST TO THE CITY.
3. CONSTRUCTION SHALL BE IN ACCORDANCE WITH THE CITY OF RIVERSIDE, DEPARTMENT OF PUBLIC WORKS, STANDARD DRAWINGS, AND THE STANDARD SPECIFICATIONS FOR PUBLIC WORKS CONSTRUCTION, 1979 EDITION.
4. TRIM EDGE OF EXISTING PAVEMENT WHERE NEW PAVEMENT JOINS TO A SMOOTH, STRAIGHT LINE. CONSTRUCT MATCH-UP PAVING AS SHOWN ON PLAN AND OVERLAY PAVING AS DIRECTED IN THE FIELD TO PRODUCE A SMOOTH SECTION. ENGINEER ESTIMATES OVERLAY TO BE 8 TONS.
5. CONSTRUCT DRIVEWAY APPROACHES PER STD. DWG. 302.
6. DEVELOPER TO GIVE CITY WATER DIVISION FIVE (5) WORKING DAYS WRITTEN NOTICE PRIOR TO START OF CONSTRUCTION AND TO ALLOW CITY TEN (10) WORKING DAYS FOR COMPLETION OF WORK. (787-7611)
7. CURB AND GUTTER SHALL BE STAKED WITH 3' OFFSETS AT 25' INTERVALS.
8. ALL FLAGGED ELEVATIONS SHALL BE STAKED IN THE FIELD BY THE PRIVATE ENGINEER.
9. CONTACT THE PARK AND RECREATION DEPT., TREE DIVISION, AT 787-7518 24 HOURS PRIOR TO TREE REMOVAL.
10. ALL STREET TREE PLANTING WILL BE DONE TO THE DEPARTMENT OF PARK AND RECREATION STANDARDS.
11. CONTACT THE PARK PROJECTS INSPECTOR A MINIMUM OF 48 HOURS IN ADVANCE AT 787-7223 TO SCHEDULE INSPECTIONS. INSPECTION SHALL BE REQUIRED: (a) WHEN PLANT LOCATIONS HAVE BEEN SPOTTED IN THE FIELD PRIOR TO DIGGING PLANT PITS, (b) WHILE DIGGING PLANT PITS AND PLANTING/RELOCATING TREES (c) AFTER PLANTING AND ALL OTHER INDICATED OR SPECIFIED WORK HAS BEEN COMPLETED FOR START OF MAINTENANCE, AND (d) AT END OF MAINTENANCE/FINAL ACCEPTANCE. DEVELOPER WILL BE RELEASED FROM MAINTENANCE ONLY UPON RECEIPT OF WRITTEN NOTIFICATION FROM THE CITY THAT THE PARK AND RECREATION DEPARTMENT IS ASSUMING MAINTENANCE RESPONSIBILITIES.
12. THE DEVELOPER SHALL MAINTAIN ALL PLANTINGS FOR A MINIMUM PERIOD OF ONE (1) YEAR.
13. STREET TREE PLANTING SHALL BE AS FOLLOWS: STREET NAME: CENTRAL AVE.; BOTANICAL NAME/Common Name: WASHINGTONIA ROBUSTA; SIZE: 36" RELOCATION.
14. TRAFFIC SIGNAL MODIFICATIONS SHALL BE IN ACCORDANCE WITH SECTION 66 OF THE STANDARD SPECIFICATIONS AND THE STANDARD PLANS PUBLISHED BY THE STATE OF CALIFORNIA BUSINESS AND TRANSPORTATION AGENCY, DEPT. OF TRANSPORTATION.

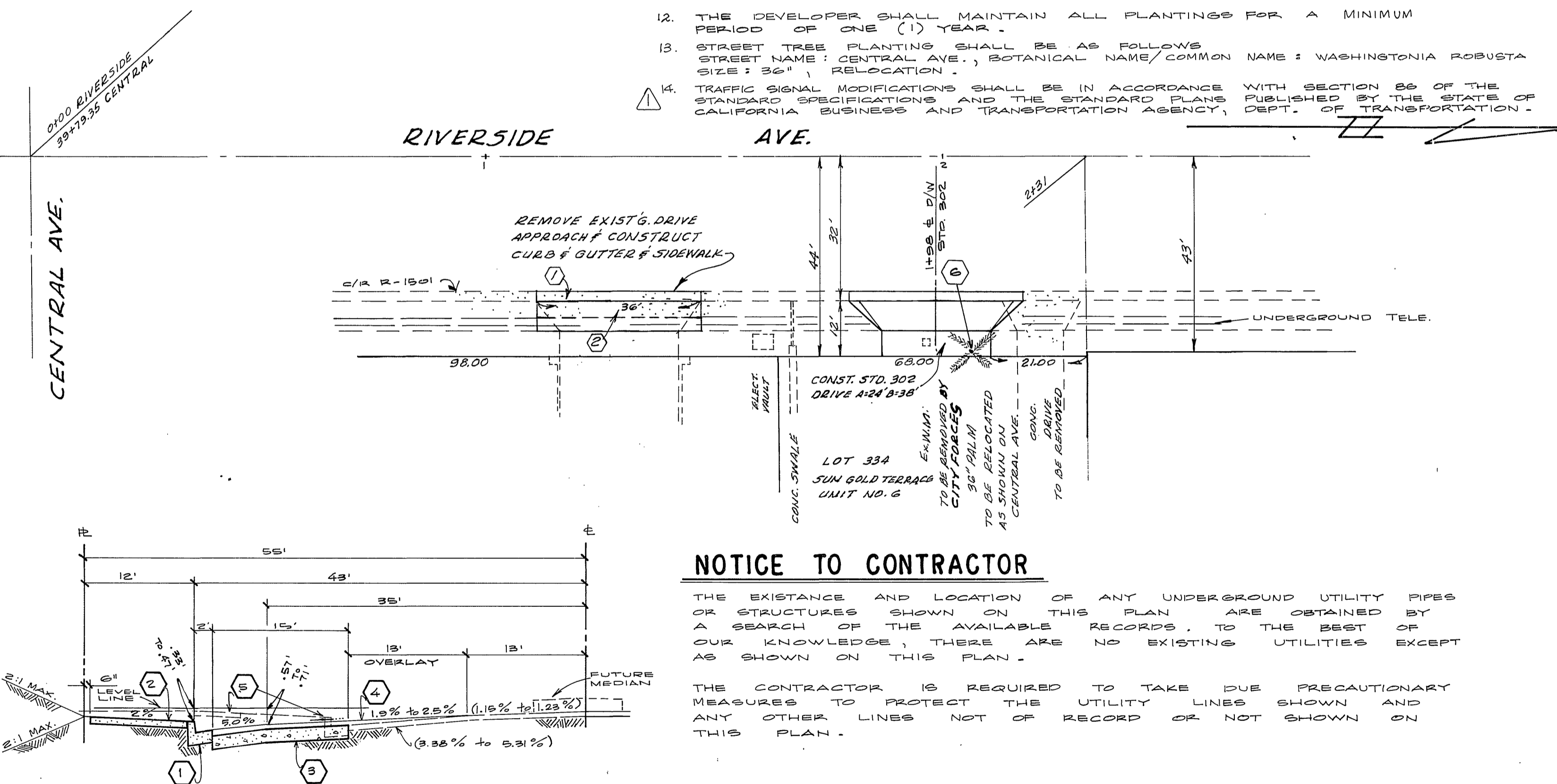

TYPICAL SECTION

NO SCALE T.I. = 9.0

NOTICE TO CONTRACTOR

THE EXISTENCE AND LOCATION OF ANY UNDERGROUND UTILITY PIPES OR STRUCTURES SHOWN ON THIS PLAN ARE OBTAINED BY A SEARCH OF THE AVAILABLE RECORDS, TO THE BEST OF OUR KNOWLEDGE, THERE ARE NO EXISTING UTILITIES EXCEPT AS SHOWN ON THIS PLAN.

THE CONTRACTOR IS REQUIRED TO TAKE DUE PRECAUTIONARY MEASURES TO PROTECT THE UTILITY LINES SHOWN AND ANY OTHER LINES NOT OF RECORD OR NOT SHOWN ON THIS PLAN.

BENCH MARK: ELEV. = 835.61
P.K. & LEAD IN S.W. CURB RETURN OF CENTRAL & RIVERSIDE. C/R P.B. 727/57

| | |
|---------------------------------------------------------------------------------------------------------------|------------------------------------------------------------------------------------------------------------------------|
| CITY OF RIVERSIDE IRRIGATION DOMESTIC SYSTEM. <i>Fred Lant</i> WATER SYSTEMS MANAGER 3/29/80 DATE | CITY OF RIVERSIDE OVERHEAD & UNDERGROUND <i>W. B. Babin</i> CHIEF UTILITIES ENGINEER-ELECTRIC 9-24-80 DATE |
|---------------------------------------------------------------------------------------------------------------|------------------------------------------------------------------------------------------------------------------------|

Earl N. Wall
9276
4/24/80

TRAFFIC SIGNAL MODIFICATIONS
10-10-80
10-10-80

W. B. Babin
10/10/80

STREET PLAN & PROFILE

CENTRAL AVENUE
STA 43+88.35 TO STA. 44+58.85
ZONING CASE R-47-790
HORIZ. 1" = 20' VERT. 1" = 2'

R-2314
I I
79-280 A

P.C. # 1034

INDEXED BY 810