

- CONSTRUCTION NOTES & QUANTITY ESTIMATES**
- 1. CONVT 3/4\"/>

549	sq.F.
220	sq.F.
19	L.F.
80	L.F.
242	sq.F.
288	sq.F.
2	EA.
1500	sq.F.

PRIVATE ENGINEER'S NOTICES TO CONTRACTOR

THE EXISTENCE AND LOCATION OF ANY UNDERGROUND UTILITIES OR STRUCTURES SHOWN IN THESE PLANS ARE OBTAINED BY A SEARCH OF AVAILABLE RECORDS TO THE BEST OF OUR KNOWLEDGE THERE ARE NO EXISTING UTILITIES EXCEPT THOSE SHOWN ON THE PLANS. THE CONTRACTOR IS REQUIRED TO TAKE ALL PRECAUTIONARY MEASURES TO PROTECT THE UTILITIES SHOWN, AND ANY OTHER LINES OR STRUCTURES NOT SHOWN ON THESE PLANS, AND IS RESPONSIBLE FOR THE PROTECTION OF, AND ANY DAMAGE TO THESE LINES OR STRUCTURES.

THE CONTRACTOR AGREES THAT HE SHALL ASSUME SOLE & COMPLETE RESPONSIBILITY FOR JOB SITE CONDITIONS DURING THE COURSE OF CONSTRUCTION OF THIS PROJECT, INCLUDING SAFETY OF ALL PERSONS AND PROPERTY; THAT THIS REQUIREMENT SHALL APPLY CONTINUOUSLY AND NOT BE LIMITED TO NORMAL WORKING HOURS; AND THAT THE CONTRACTOR SHALL DEFEND, INDEMNIFY, AND HOLD THE OWNER, CITY AND ENGINEER HARMLESS FROM ANY AND ALL LIABILITY, REAL OR ALLEGED, IN CONNECTION WITH THE PERFORMANCE OF WORK ON THIS PROJECT, EXCEPTING FOR LIABILITY ARISING FROM THE SOLE NEGLIGENCE OF THE OWNER, CITY, OR THE ENGINEER.

THE CONTRACTOR SHALL BE RESPONSIBLE TO REPORT DISCREPANCIES IN PLANS AND FIELD CONDITIONS IMMEDIATELY TO THE DESIGN ENGINEER FOR RESOLUTION PRIOR TO CONSTRUCTION, AND SHALL BE RESPONSIBLE FOR DISCREPANCIES NOT SO REPORTED & RESOLVED.

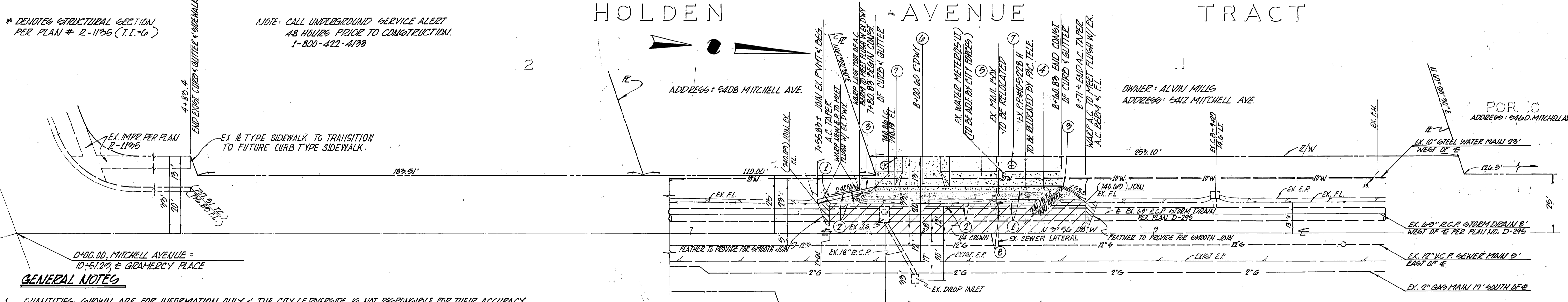

* DENOTES STRUCTURAL SECTION PER PLAN # R-1175 (T.I.-6)

NOTE: CALL UNDERGROUND SERVICE ALERT 48 HOURS PRIOR TO CONSTRUCTION. 1-800-422-4133

GENERAL NOTES

- QUANTITIES SHOWN ARE FOR INFORMATION ONLY & THE CITY OF RIVERSIDE IS NOT RESPONSIBLE FOR THEIR ACCURACY.
- IT SHALL BE THE RESPONSIBILITY OF THE CONTRACTOR TO CLEAR THE RIGHT OF WAY IN ACCORDANCE WITH THE PROVISIONS OF LAW AS IT AFFECTS EACH UTILITY INCLUDING IRRIGATION LINES & APPURTENANCES & AT NO COST TO THE CITY.
- CONSTRUCTION SHALL BE IN ACCORDANCE WITH THE CITY OF RIVERSIDE, DEPARTMENT OF PUBLIC WORKS, STANDARD DRAWINGS, & THE STANDARD SPECIFICATIONS FOR PUBLIC WORKS CONSTRUCTION, 1979 EDITION.
- TRIM EDGE OF EXISTING PAVEMENT WHERE NEW PAVEMENT JOINS TO A SMOOTH, STRAIGHT LINE. CONSTRUCT MATCH-UP PAVING AS SHOWN ON PLAN & OVERLAY PAVING AS DIRECTED IN THE FIELD TO PRODUCE A SMOOTH SECTION.
- ALL FLAGGED ELEVATIONS SHALL BE STAKED IN THE FIELD BY THE PRIVATE ENGINEER.
- THE PRIVATE ENGINEER SIGNING THESE PLANS IS RESPONSIBLE FOR ASSURING THE ACCURACY & ACCEPTABILITY OF THE WORK HEREON. IN THE EVENT OF DISCREPANCIES ARISING DURING CONSTRUCTION AS A RESULT OF ERRORS OR OMISSIONS, THE PRIVATE ENGINEER SHALL BE RESPONSIBLE FOR DETERMINING AN ACCEPTABLE SOLUTION & REVISING THE PLANS FOR APPROVAL BY THE CITY.
- ALL RELATED WORK SHALL CONFORM TO THE CITY OF RIVERSIDE, PARK AND RECREATION DEPARTMENT STANDARDS.
- CONTACT THE PARK PROJECTS SUPERVISOR A MINIMUM OF 48 HOURS IN ADVANCE @ 787-7223 TO SCHEDULE INSPECTIONS. INSPECTIONS SHALL BE REQUIRED: A) WHEN PLANT LOCATIONS HAVE BEEN SPOTTED IN THE FIELD PRIOR TO DIGGING PLANT PITS, B) WHILE DIGGING PLANT PITS AND PLANTING/RELOCATING TREES, C) AFTER PLANTING AND ALL OTHER INDICATED OR SPECIFIED WORK HAS BEEN COMPLETED FOR START OF MAINTENANCE, AND D) AT END OF MAINTENANCE/FINAL ACCEPTANCE (CONTRACTOR) DEVELOPER WILL BE RELEASED FROM MAINTENANCE ONLY UPON RECEIPT OF WRITTEN NOTIFICATION FROM THE CITY THAT THE PARK AND RECREATION DEPARTMENT IS ASSUMING MAINTENANCE RESPONSIBILITIES.
- THE CONTRACTOR DEVELOPER SHALL MAINTAIN ALL PLANTINGS FOR A MINIMUM PERIOD OF ONE (1) YEAR.
- STREET TREES TO BE PLANTED IN MITCHELL AVE ARE PYRUS CALLERYANA (DEADWOOD) / BRADFORD PEAR (15 GAL), @ 50' & O.C.
- CURB & GUTTER SHALL BE STAKED WITH 2' OFFSETS @ 25' INTERVALS.

12. DEVELOPER TO GIVE CITY WATER DIVISION 5 WORKING DAYS WRITTEN NOTICE PRIOR TO START OF CONSTRUCTION, AND TO ALLOW THE CITY 10 WORKING DAYS FOR COMPLETION OF WORK.

MITCHELL AVENUE

BENCH MARK

PK. NAIL AND TAG IN CENTER OF N'WLY CURB BETWEEN @ LA GILIEZA AVENUE AND GRAMERCY PLACE. T.B. 985/97 RESET 1979 ELEV. 740.706

CITY OF RIVERSIDE	DATE
PLANNING ENGINEERING SURVEYING	DATE
DESIGNED BY	DATE
DRAWN BY	DATE
CHECKED BY	DATE

PLANS PREPARED BY: STAN SCHUPP & ASSOC., INC. PLANNING ENGINEERING SURVEYING RIVERSIDE, CA. (714) 781-0811

APPROVED BY	DATE
PRINCIPAL ENGINEER	DATE
TRAFFIC DIVISION	DATE
CHIEF PUB. WKS. ENGR.	DATE

CITY OF RIVERSIDE, CALIFORNIA PUBLIC WORKS DEPARTMENT

PLAN & PROFILE FOR GUTTER IMPROVEMENTS FOR THE WESTERN SIDE OF MITCHELL AVENUE FROM 780.83' TO 860.83' NORTH OF THE INTERSECTION OF GRAMERCY & MITCHELL AVE. BUILDING PERMIT @ 842 MITCHELL AVENUE. SCALE: HORIZ. 1"=20', VERT. 1"=4'

ACCOUNT NO.	DRAWING NUMBER
	R-2442
SHEET	1 OF 4

PC-172