

NO.	R	Δ	L	T
①	35.00'	114° 52' 45"	70.18'	54.81'
②	35.00'	65° 08' 15"	39.79'	22.36'
③	35.00'	83° 26' 59"	54.64'	34.67'

MAIN ST.	1000
A MAIN ST.	1000
B CARTER AVE.	3800
C R-1 (STOP SIGN) 30" OCTAGON	
D W-53 (NOT A THROUGH ST) 30"	

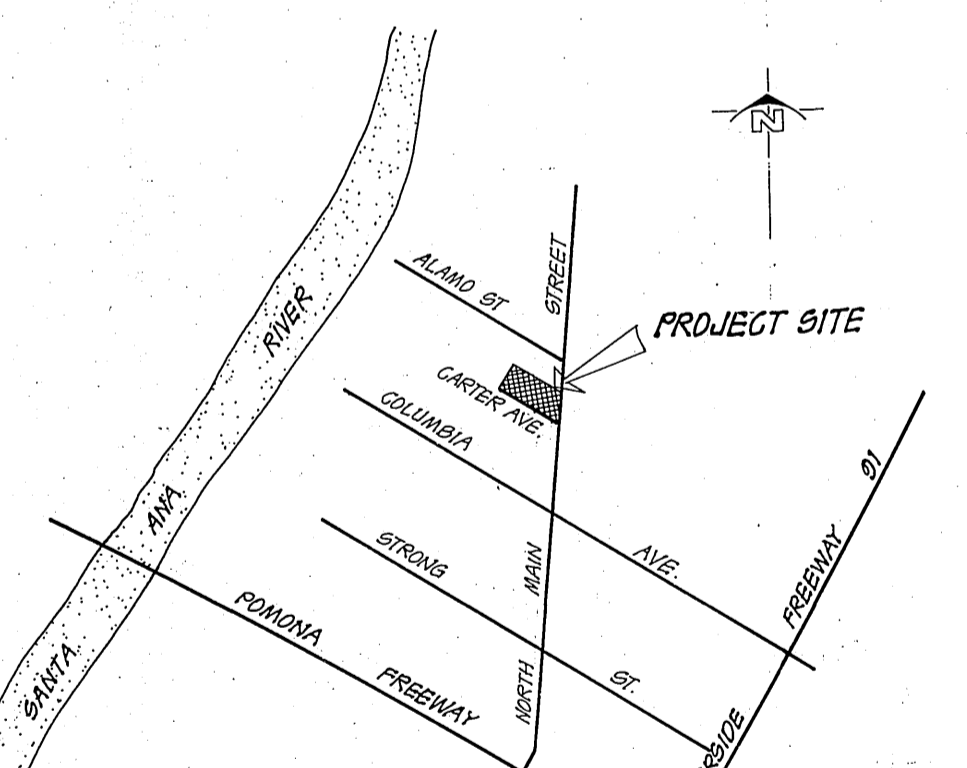
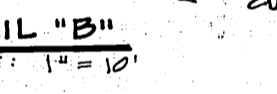

GENERAL NOTES: (continued)
 13. On all areas shown within public right of way where the fill is one (1) foot or greater, a 10% slope must be required from the 2015 standard, certifying the construction permit/cut sheets.
 14. The Contractor shall call in a location request to Under-ground Service Alert (USA) phone 1-800-495-4333, two working days before construction. No construction permit will be issued by the Public Works Department involving excavation or underground utilities unless the applicant has provided an inquiry identification number by USA.

- GENERAL NOTES:
- It shall be the responsibility of the Contractor to clear the right of way in accordance with the provisions of law as it affects each utility, including irrigation lines, and at no cost to the City.
 - Construction shall be in accordance with the City of Riverside, Department of Public Works, Standard Drawings, Standard Drawing No. 10 and Standard Specifications for Public Works Construction, Current Edition.
 - Prime coat, seal coat, and paint binder are required.
 - NOTICE TO CONTRACTOR: The existence and location of any underground utility pipes or structures shown on these plans were obtained by a search of the available records. To the best of our knowledge there are no existing utilities except as shown on these plans. The Contractor is required to take precautionary measures to protect the utility lines shown and any other lines not of record or not shown on these plans.
 - Traffic control signs shall be in place prior to opening streets to traffic.
 - Trim edge of existing pavement where new pavement joins to a smooth straight line. Construct match-up paving as shown on plan and overlay as directed in the field to produce a smooth section. Engineer estimates overlay to be 100 tons.
 - Developer to give City Water Division five (5) working days written notice prior to start of construction and to allow City ten (10) working days for completion of work. (787-7611)
 - The private engineer signing these plans is responsible for assuring the accuracy and acceptability hereon. In the event of discrepancies arising during construction, the private engineer signing these plans shall be responsible for determining an acceptable solution and revising the plans for approval by the City.
 - Curb and gutter and edge of pavement shall be staked by the private engineer with 3.0 foot off-sets at 25.0 foot intervals. All flagged elevations shown on the plans shall also be staked in the field by the private engineer. For intervals less than 0.4% the engineer will stake curb and gutter at 12.5 foot intervals and 2 rows of 83 re-bar shall be placed in the gutter; place 3/4" dowel pins at all expansion joints.
 - Location of laterals to be determined in the field at the direction of the owner.
 - Any traffic control striping obliterated during construction shall be restored by the contractor within five days after notification from the City inspectors.
 - The developer shall be responsible for preserving or re-establishing and referencing survey monuments destroyed or buried as a result of construction shown hereon.

- GENERAL NOTES continued below.
- PARKS & RECREATION GENERAL NOTES:
- Contact the park projects inspector a minimum of 24 hours in advance at 359-2839 to schedule inspections. Inspections shall be required.
 - When plant locations have been spotted in the field prior to digging plant pits.
 - While digging plant pits and planting/relocating trees.
 - After planting and all other indicated or specified work has been completed for start of maintenance.
 - At end of maintenance/final acceptance (Developer will be released from maintenance only upon receipt of written notification from the City that the Park & Recreation Department is assuming maintenance responsibilities).
 - The developer shall maintain all plantings for a minimum period of one (1) year.
 - Street tree planting shall be as follows:

Street Name	Botanical Name/Common Name	Min. Size	Approx. Spacing	No. Req.
a. MAIN	LAGERSTOEMIA INDICAL	15 Gal.	50'	4
b. CARTER	PARUS CALLERIANA BRADFORD BRADFORD PEAR	15 Gal.	50'	14

- CONSTRUCTION NOTES:
- Construct 2 1/2" A.C. over 4" crushed aggregate base per S.R. 1135R-65.
 - Construct curb and gutter per Standard Drawing 200 (type 1) 6" C.F.
 - Construct curb sidewalk per Standard Drawing 325.
 - Construct wheelchair ramps per Standard Drawing 304.
 - Construct cross-gutter per Standard Drawing 220.
 - Place 2" x 4" redwood header.
 - Remove existing pavement and replace with 12" compacted fill as per typical section.
 - Plant Street trees per City of Riverside Parks and Recreation Standard.
 - CONSTRUCT DRIVEWAY APPROACH PER STANDARD DRAWING 302; A=30, B=44

CAUTION
 PACIFIC TELEPHONE
 CABLES UNDERGROUND
 BEFORE EXCAVATING
 CALL 1-800-495-4333

NORTH MAIN STREET

BENCH MARK: CITY B.M. J7-K
 PK. MAIL AND TAG IN EAST CURB OF MAIN STREET 10' S SOUTH OF B.C.R. AT COLUMBIA AVENUE.
 F.B. 8-27/16 ELEVATION 813.234

Contractor agrees that he shall assume sole and complete responsibility for job site conditions during the course of construction of this Project and property; that this requirement shall apply continuously and not be limited to normal working hours; and that the Contractor shall defend, indemnify and hold the Owner and the Engineer harmless from any and all liability, real or alleged, in connection with the performance of work on this Project arising from the sole negligence of the Owner or the Engineer.

CITY OF RIVERSIDE WATER SYSTEM APPROVED BY: <i>Carol A. Wainwright</i> DATE: 4/14/82	APPROVED BY: <i>John L. Smith</i> FOR PACIFIC TELEPHONE CO. DATE: 4-7-82	APPROVED BY: <i>Brian J. Rickman</i> FOR SO. CALIF. GAS CO. DATE: 4-7-82	CITY OF RIVERSIDE PUBLIC UTILITIES ELECTRICAL DIVISION FOR: <i>Michael J. Loulli</i> CHIEF UTILITIES ENGINEER, ELECTRICAL DATE: 4/17/82	INDEX/CD

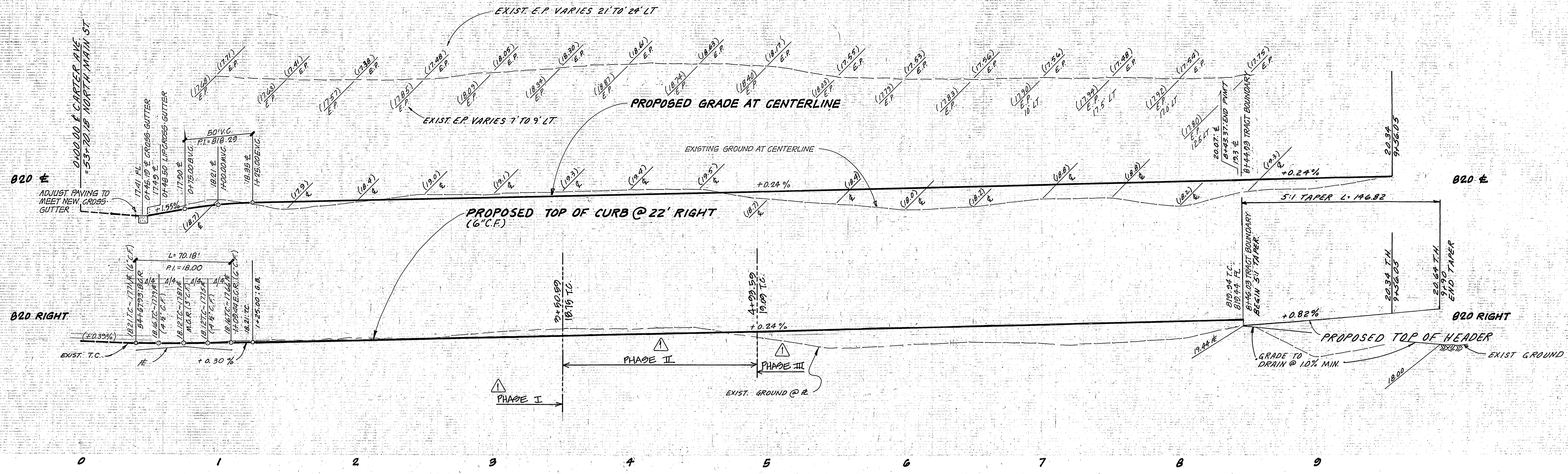

THIS PORTION OF EX. 4" STL. WATER MAIN TO BE ABANDONED AFTER ACCEPTANCE OF NEW 12" WATER MAIN
 NOTE: NEW 12" WATER MAIN WILL BE CONSTRUCTED PRIOR TO COMPLETION OF NEW PAVEMENT

* FUTURE
 ** A.C. D/W'S AT VARIOUS LOCATIONS - NOT PER PLAN
 (1) LOT'S 3, 4, 5, 6 & 7 EXTRA A.C. D/W'S (NOT PER PLAN)
 (2) SLAG USED BETWEEN D/W'S TO CONTROL DUST (NOT PER PLAN)

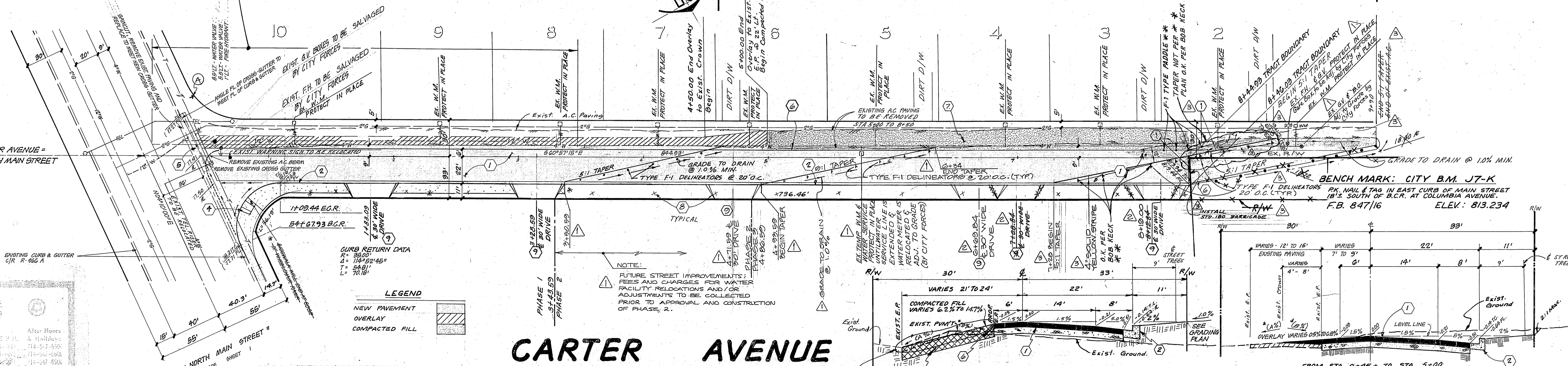

Contractor agrees that he shall assume sole and complete responsibility for job site conditions during the course of construction of this Project, including safety of all persons and property; that this requirement shall apply continuously and not be limited to normal working hours; and that the Contractor shall defend, indemnify and hold the Owner and the Engineer harmless from any and all liability, real or alleged, in connection with the performance of work on this Project, excepting for liability arising from the sole negligence of the Owner or the Engineer.

NOTE: SEE SHEET NO. 1 FOR CONSTRUCTION & GENERAL NOTES.

CAUTION - PACIFIC TELEPHONE CABLES UNDERGROUND BEWARE OF BURIED CABLES

CITY OF RIVERSIDE WATER SYSTEM
 APPROVED BY: *Carl A. Wengert* 4/12/84
 DATE: 4/12/84

APPROVED BY: *Carl A. Wengert* FOR PACIFIC TELEPHONE CO. DATE: 4-7-84
 APPROVED BY: *Benjamin J. Tucker* FOR S.O. CALIF. GAS CO. DATE: 4-7-84

J. F. DAVIDSON ASSOCIATES CIVIL ENGINEERS - SURVEYORS - PLANNERS RIVERSIDE, CALIFORNIA
 APPROVED BY: *John W. Conroy* DATE: 4/14/84
 P.E. No. 12850

CITY OF RIVERSIDE, CALIFORNIA DEPARTMENT OF PUBLIC WORKS
 APPROVED BY: *William J. Garcia* DATE: 4/12/84
 DIRECTOR OF PUBLIC WORKS

STREET PLAN AND PROFILE
 ZONING CASE R-39-778
 "CARTER AVENUE"
 FROM NORTH MAIN ST. TO 845' NORTHWESTERLY

PROJECT NO. R-2472
 SHEET 2 OF 2
 FILE NO. 81-7638