

INCORPORATED 1883  
  
**RIVERSIDE CITY OF RIVERSIDE CALIFORNIA**

**PUBLIC WORKS DEPARTMENT**

**IOWA AVENUE  
REHABILITATION**

**UNIVERSITY AVENUE TO SPRUCE STREET**

**LENGTH OF PROJECT = 6253 L.F. = 1.18 MILE  
TRAFFIC INDEX = 8**

**CONSTRUCTION LEGEND**



- (A)** PLACE ASPHALT CONCRETE OVERLAY (LEVELING).
- (B)** PLACE OPEN GRADED ASPHALT CONCRETE OVERLAY (0.05' MIN.)
- (C)** PLACE OPEN GRADED ASPHALT CONCRETE OVERLAY (0.05' MIN.) OVER ASPHALT-RUBBER STRESS ABSORBING TREATMENT.
- (D)** PLACE DENSE GRADED ASPHALT CONCRETE OVERLAY (0.05' MIN.) AND TAPER TO MINIMUM POSSIBLE THICKNESS AT GUTTER LIP AND AT LIMIT OF PLACEMENT.
- (F)** 2 1/2" THICK A.C. SIDEWALK
- (E-1)** CONSTRUCT STRUCTURAL SECTION OF 0.26' AC OVER 0.33' CRUSHED AGGREGATE BASE.
- (E-2)** CONSTRUCT STRUCTURAL SECTION OF 0.26' AC OVER 0.33' CRUSHED AGGREGATE BASE OVER 0.86' AGGREGATE SUB BASE.
- (1)** GRIND EXIST. A.C. TO A DEPTH OF 0.05' AT THE GUTTER LIP AND DAYLIGHT IN 2". PLACE THE A.C. OVERLAY SUCH THAT THE FINISHED SURFACE SHALL BE FLUSH WITH THE GUTTER LIP (A.C. GRINDING, TYPE I).

**SPECIFIC CONSTRUCTION NOTES**

NUMBERS ABOVE 100 IN A HEXAGON ON THE PLAN REFER TO THE RESPECTIVE STANDARD DRAWING AND SHALL BE CONSTRUCTED ACCORDINGLY, UNLESS MODIFICATIONS ARE NOTED ON THE PLAN OR COVER SHEET BELOW. ANY NUMBER SHOWN BELOW THE STANDARD DRAWING NUMBER INDICATES THE SPECIFIC ALTERNATE TO BE CONSTRUCTED.

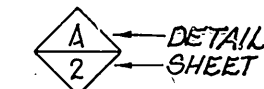

**GENERAL CONSTRUCTION NOTES**

- 1 THESE PLANS ARE FOR STREET CONSTRUCTION AND REHABILITATION ONLY. TRAFFIC SIGNAL MODIFICATIONS SHALL BE ACCOMPLISHED ACCORDING TO PLAN X-409.
- 2 ALL ELEVATIONS SHOWN ON THE PLAN SHALL BE STAKED IN THE FIELD.
- 3 ASPHALT CONCRETE PAVEMENT REMOVAL AND REPLACEMENT WILL BE DETERMINED IN THE FIELD PRIOR TO THE BEGINNING OF CONSTRUCTION. THE AMOUNT INDICATED IN THE QUANTITIES IS AN APPROXIMATION OF ANTICIPATED REPLACEMENT.

**QUANTITIES FOR IOWA AVENUE**

ITEM	QUANTITY	ITEM	QUANTITY
OPEN GRADED AC	1370 TONS	ADJUST SD CLEANOUT TO GRADE	1 EA.
DENSE GRADED AC	14.55 TONS	P.C.G. SIDEWALK, STD. 325	300 SF
ASPHALT RUBBER SAT	14,800 SY	P.C.G. WHEELCHAIR RAMP, STD. 304A	1 EA.
AC P.V.M.T. REMOVAL	600 CY	CURB AND GUTTER, STD. 200, TYPE I	12 L.F.
IMPORTED BORROW	2,500 CY		
UNCLASSIFIED EXCAVATION	500 CY		
AGGREGATE BASE	516 CY		
AGGREGATE SUB BASE	212 CY		
CATCH BASIN STD. 405	1 EA.		
15" RCP, 2000D	102 L.F.		
AC BERM, STD. 250, TYPE I	1282 L.F.		
AC BERM, STD. 250, TYPE III	753 L.F.		
ADJUST S & SD MH FRAME & COVER TO GRADE	9 EA.		
AC P.V.M.T. GRINDING, TYPE I	9,870 SF		

**EXISTING UNDERGROUND & TOPOGRAPHY LEGEND**

**EXISTING UNDERGROUND UTILITIES:**

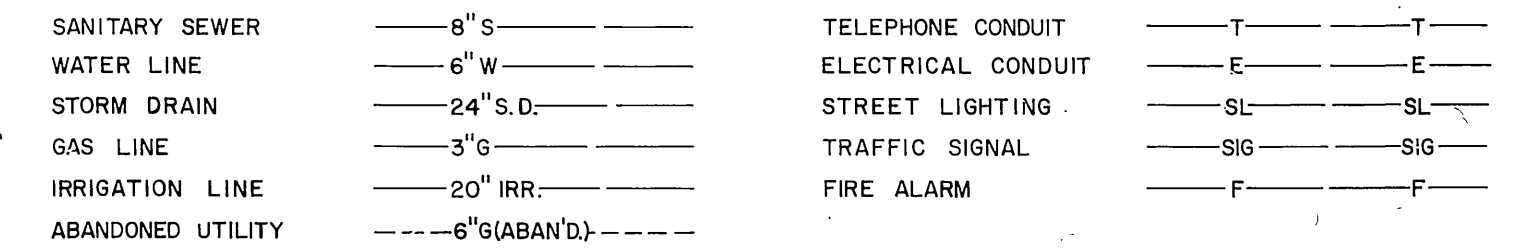

**EXISTING TOPOGRAPHY:**

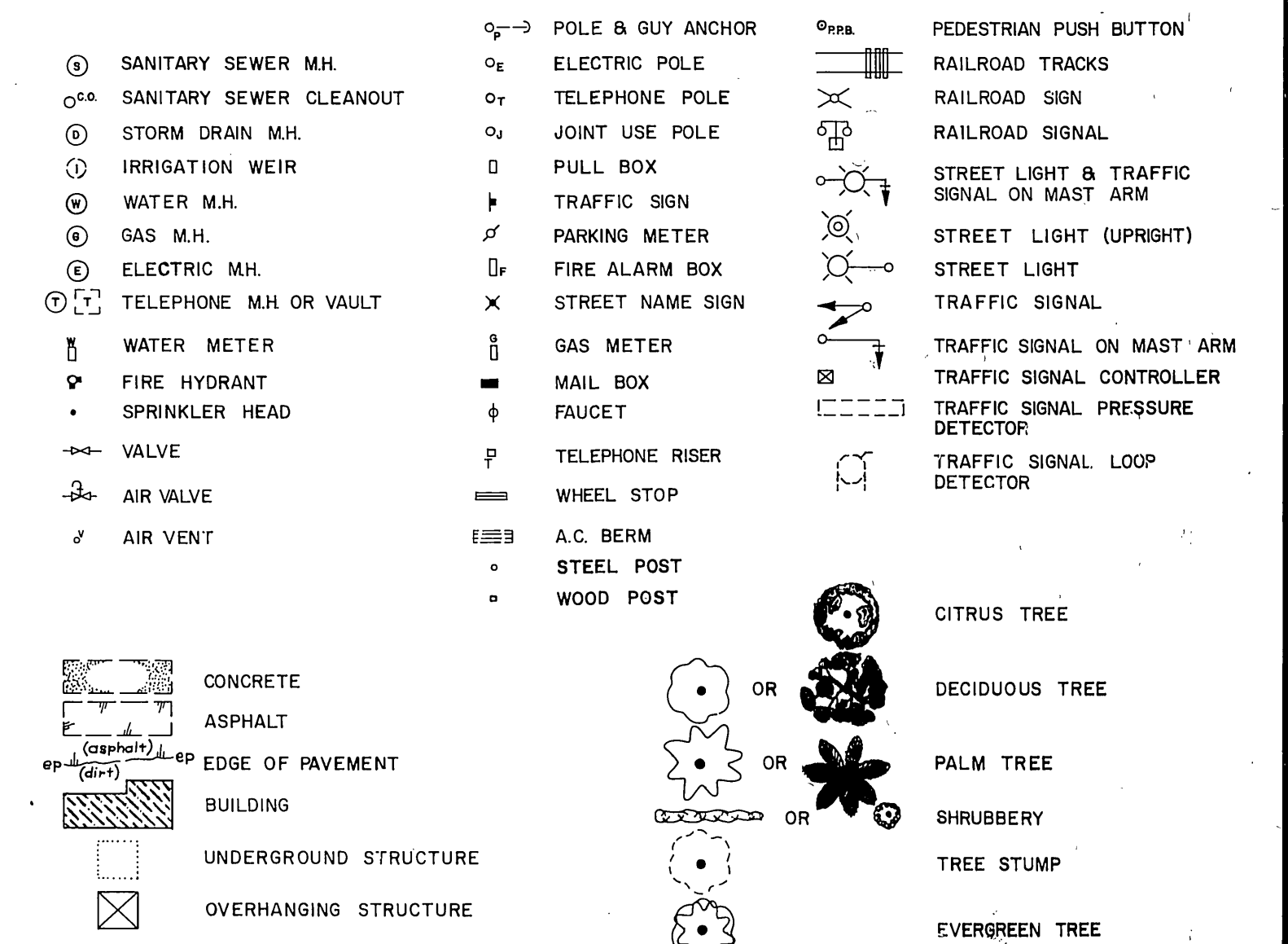

SHEET INDEX	
SHEET	DESCRIPTION
1	TITLE, LEGEND, LOCATION PLAN
2-4	PLAN AND PROFILE

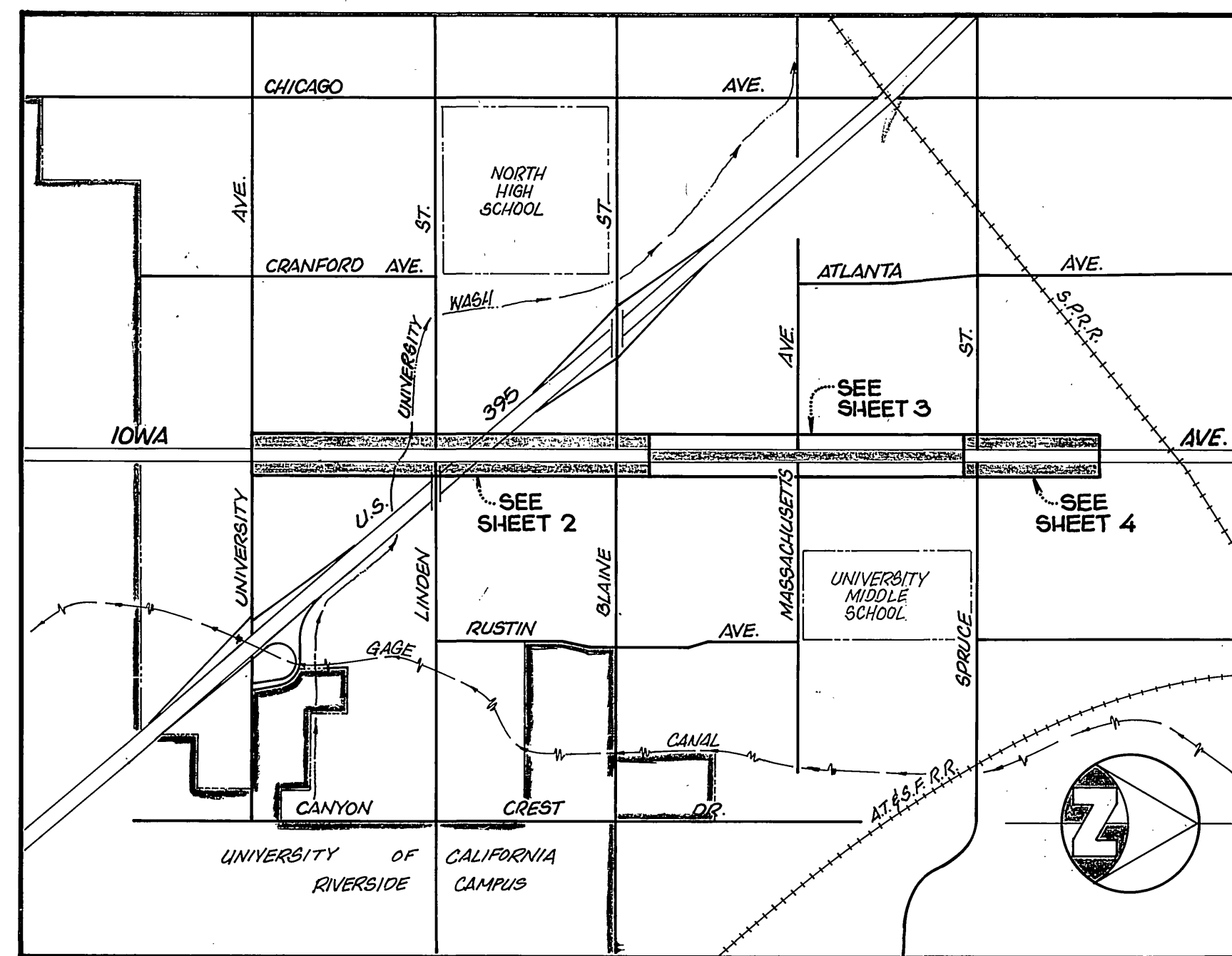

**PROJECT LOCATION PLAN**

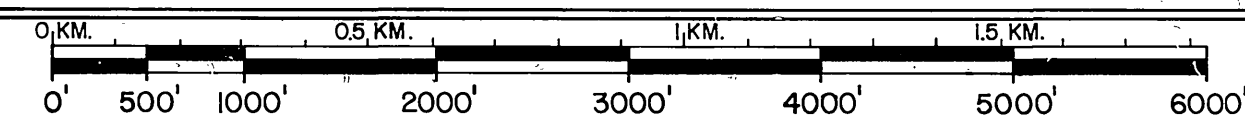

SCALE 1" = 1000'

<p>REVISIONS PER ADDENDUM NO. 2</p> <p>REVISED QUANTITIES FOR 5/15/83 ON 1000' WIDE OF SPRUCE</p> <p>DATE: 5/15/83</p>	<p><b>CITY OF RIVERSIDE</b> PUBLIC WORKS DEPARTMENT</p> <p>APPROVED BY: <i>[Signature]</i> PRINCIPAL ENGINEER</p> <p>DATE: 8/1/83</p>	<p><b>IOWA AVE. REHABILITATION</b> UNIVERSITY AVE. TO 950' N. OF SPRUCE ST.</p> <p>ACCOUNT No. 30-575-769-01 DRAWING NUMBER <b>R-2502</b> SHEET 1 OF 4 SHEET 19 OF 42 E-2499</p>
--	---	--







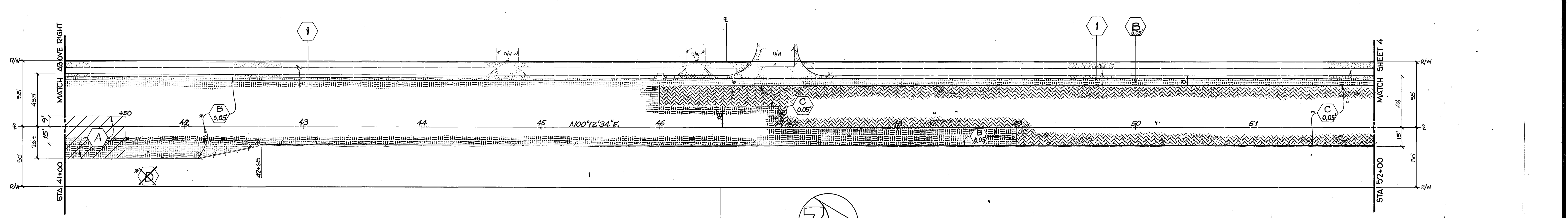
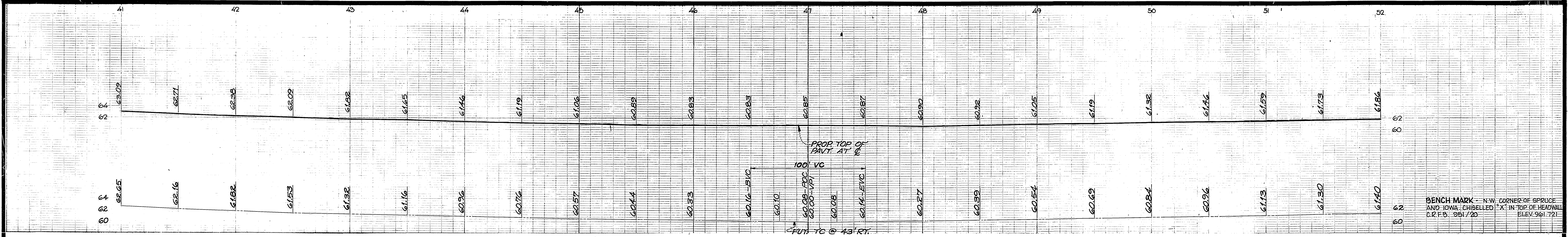
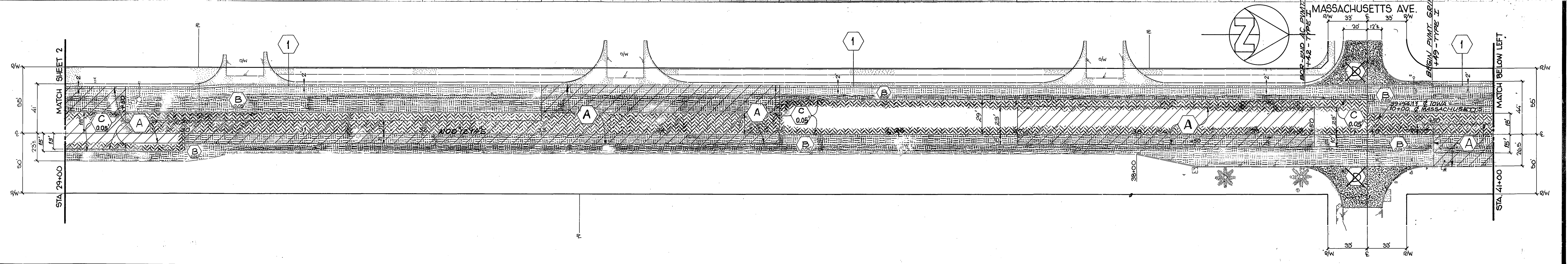
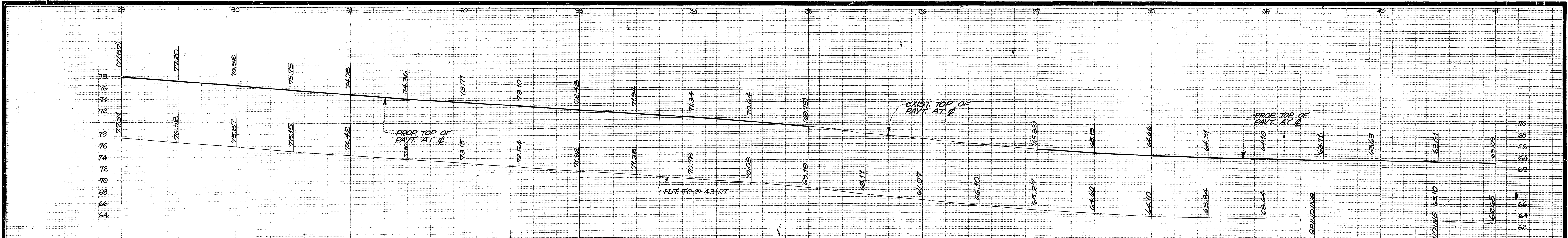

BENCH MARK - N.W. CORNER OF SPRUCE AND IOWA. CHISELLED 'X' IN TOP OF HEADWALL. C.R.F.S. 951/20. ELEV. 961.721.

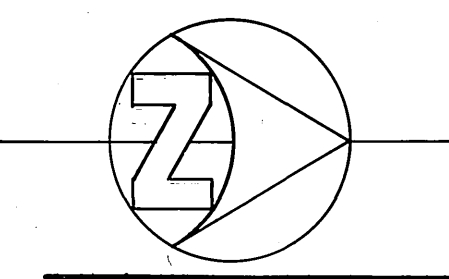

<b>CITY OF RIVERSIDE</b> PUBLIC WORKS DEPARTMENT		IOWA AVE. REHABILITATION UNIVERSITY AVE. TO 950' N'LY OF SPRUCE ST.		R-2502 SHEET 3 OF 4 SHEET 21 OF 42 R-2490
APPROVED BY PRINCIPAL ENGINEER PARK DEPARTMENT TRAFFIC DIVISION CHIEF P. W. ENGINEER	DATE 7/19/04	APPROVED BY PUBLIC WORKS DIRECTOR	DATE 9/1/03	HORIZ. SCALE: 1" = 40' VERT. SCALE: 1" = 8'



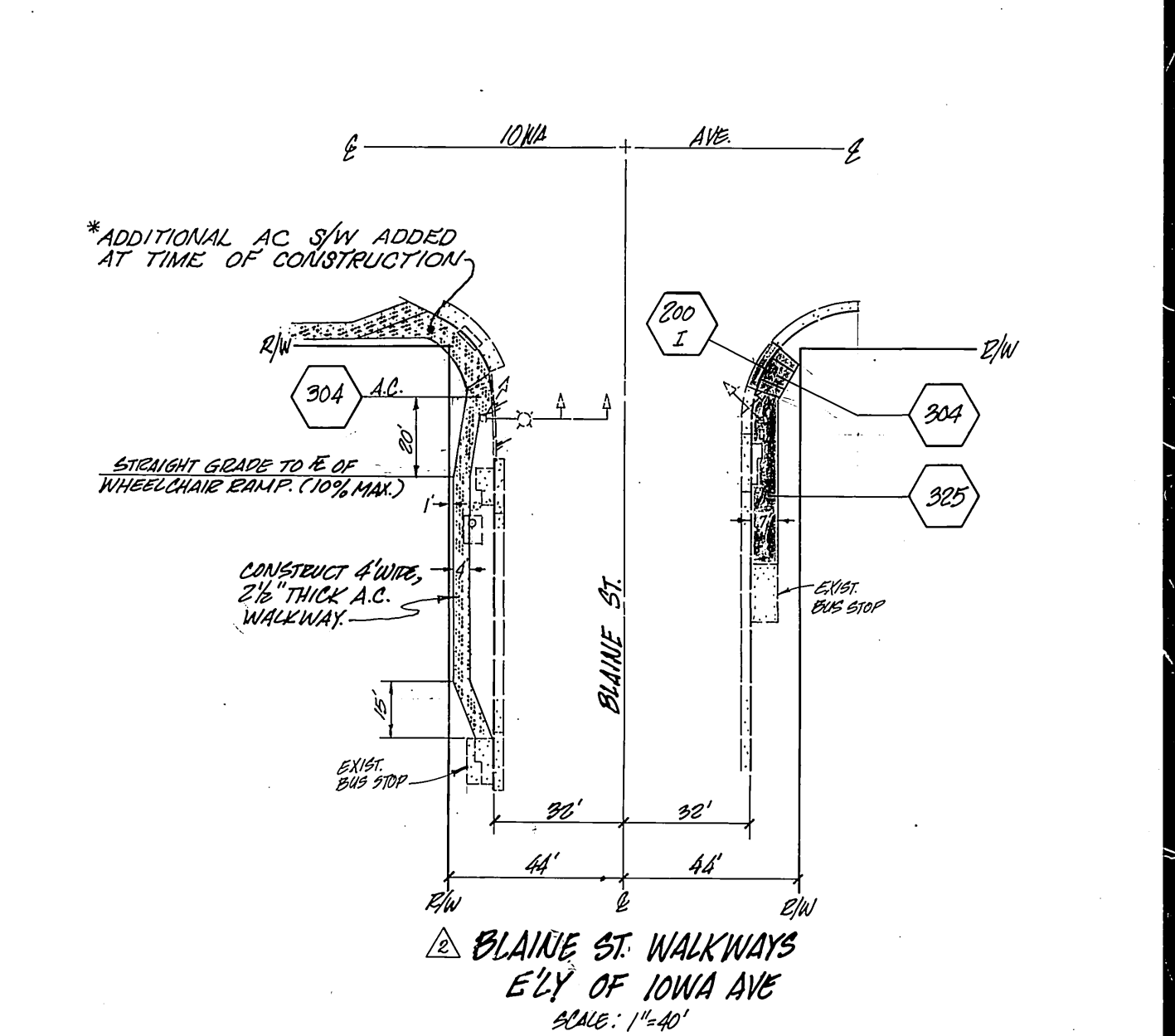
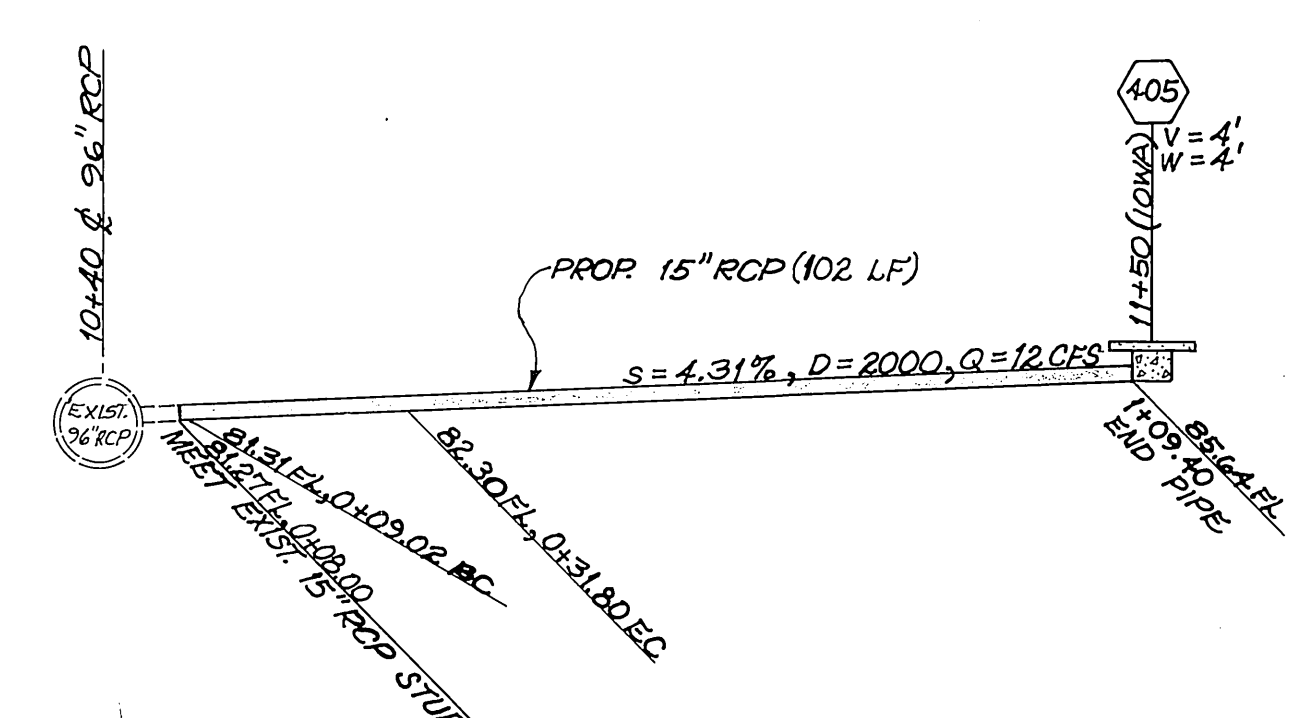
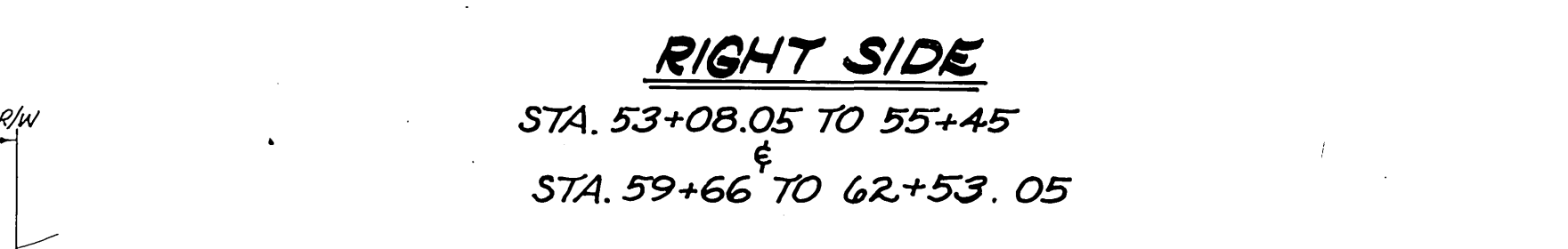
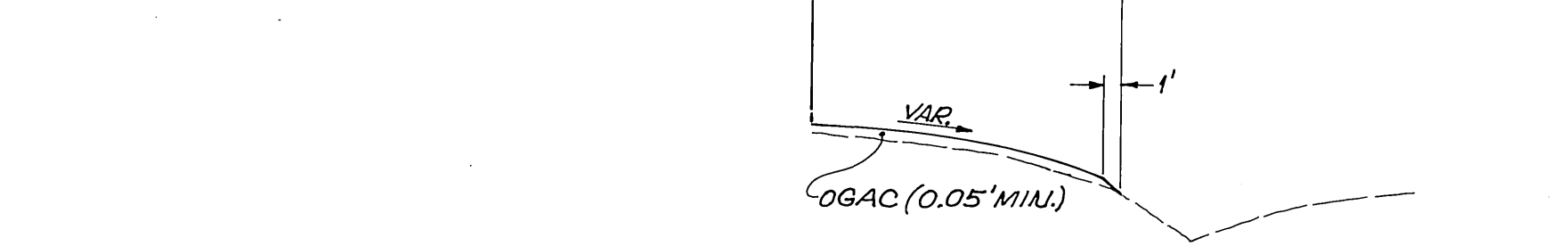
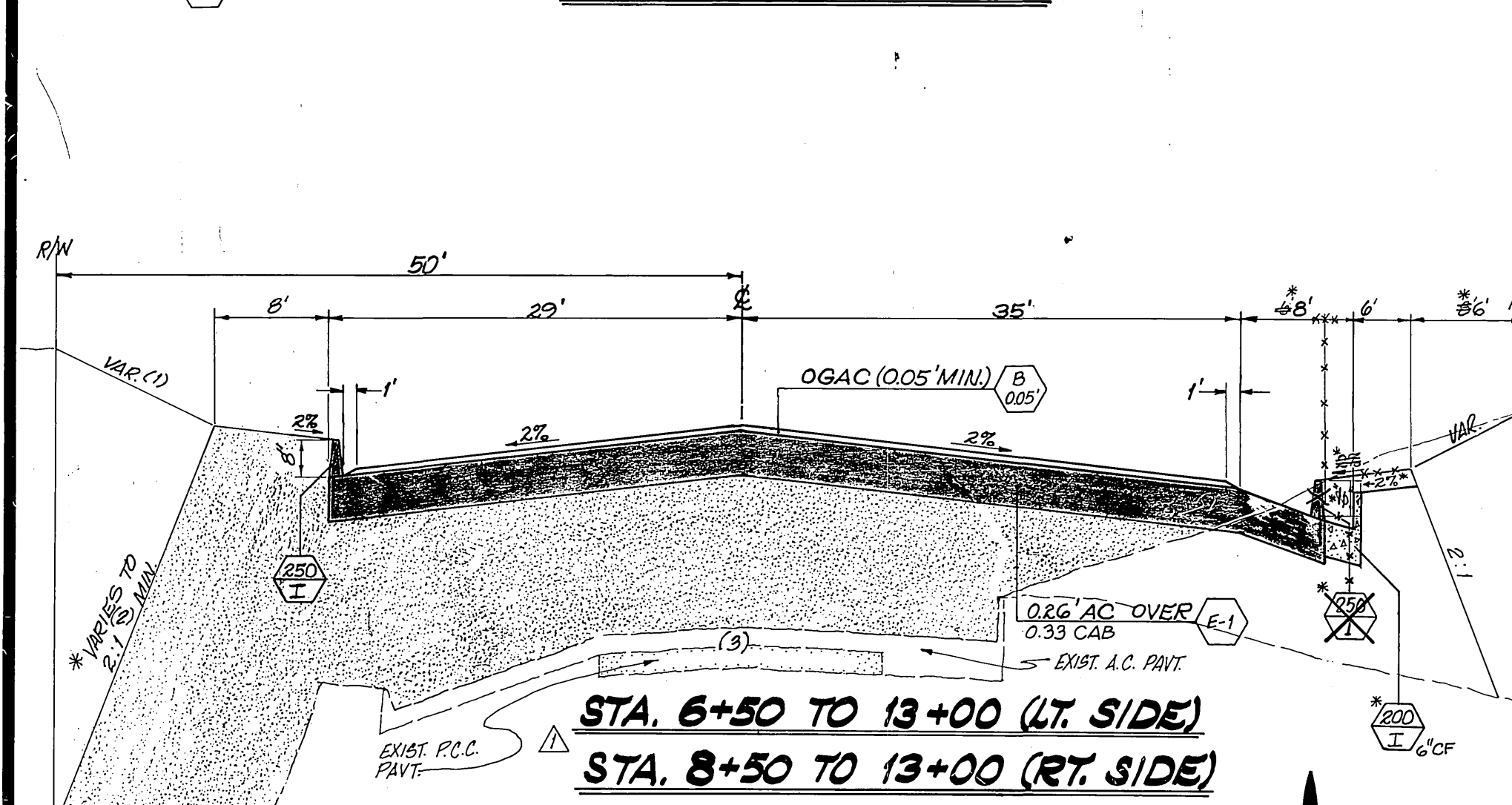
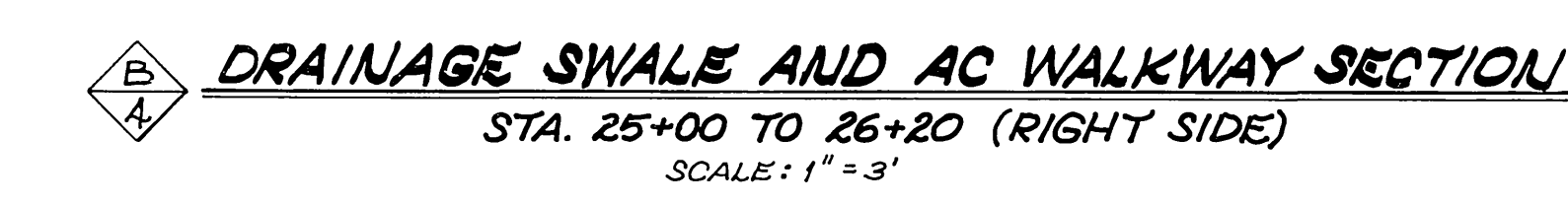
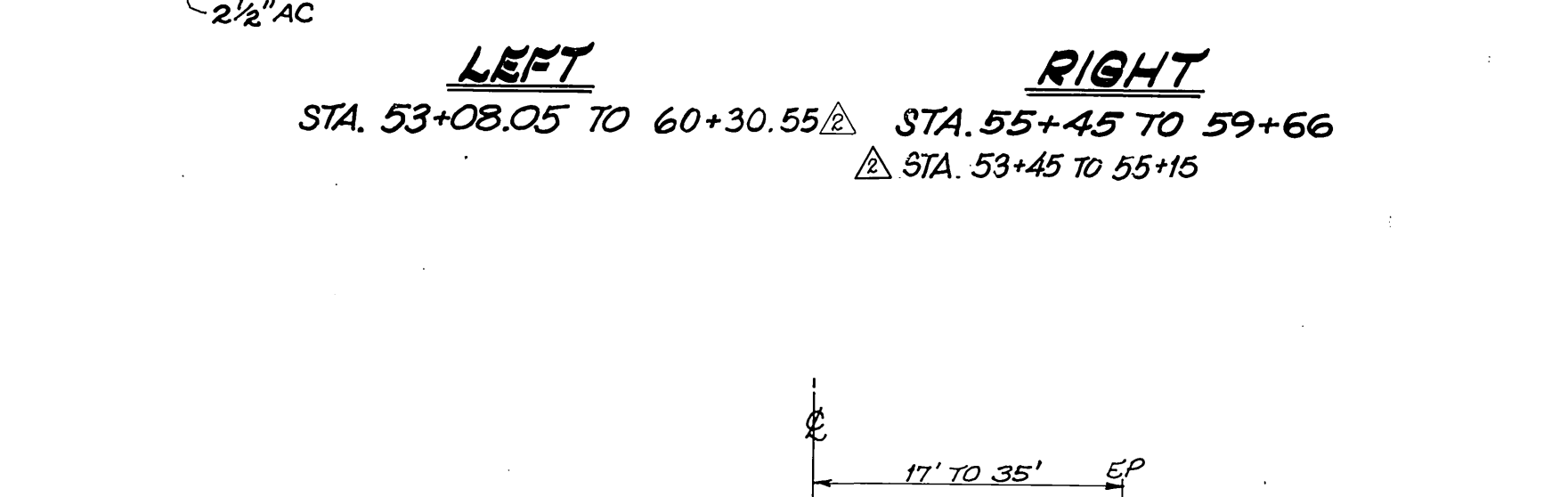
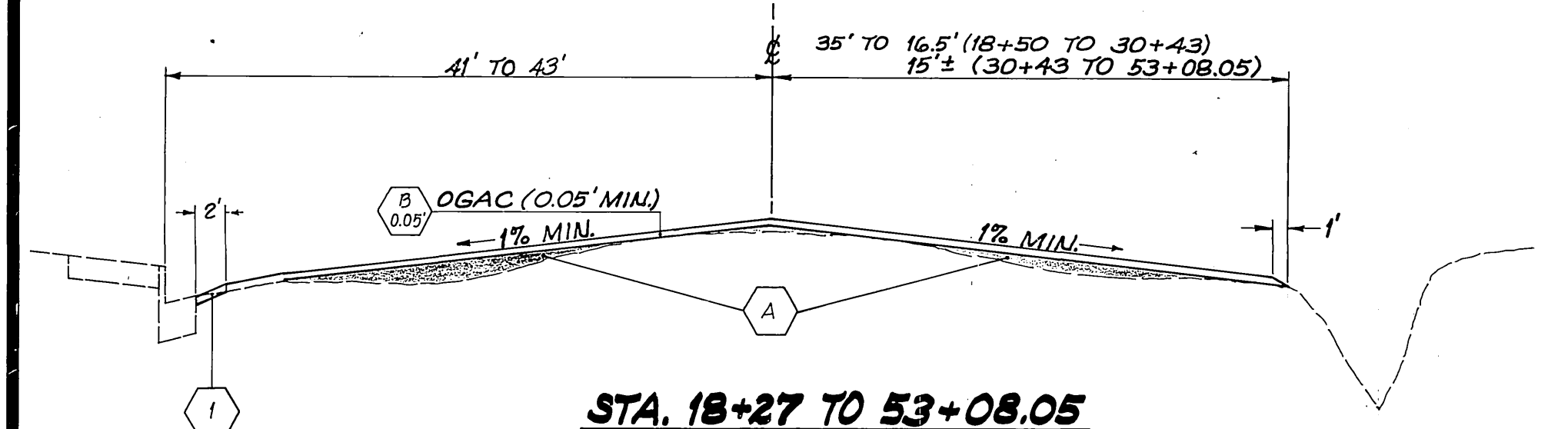
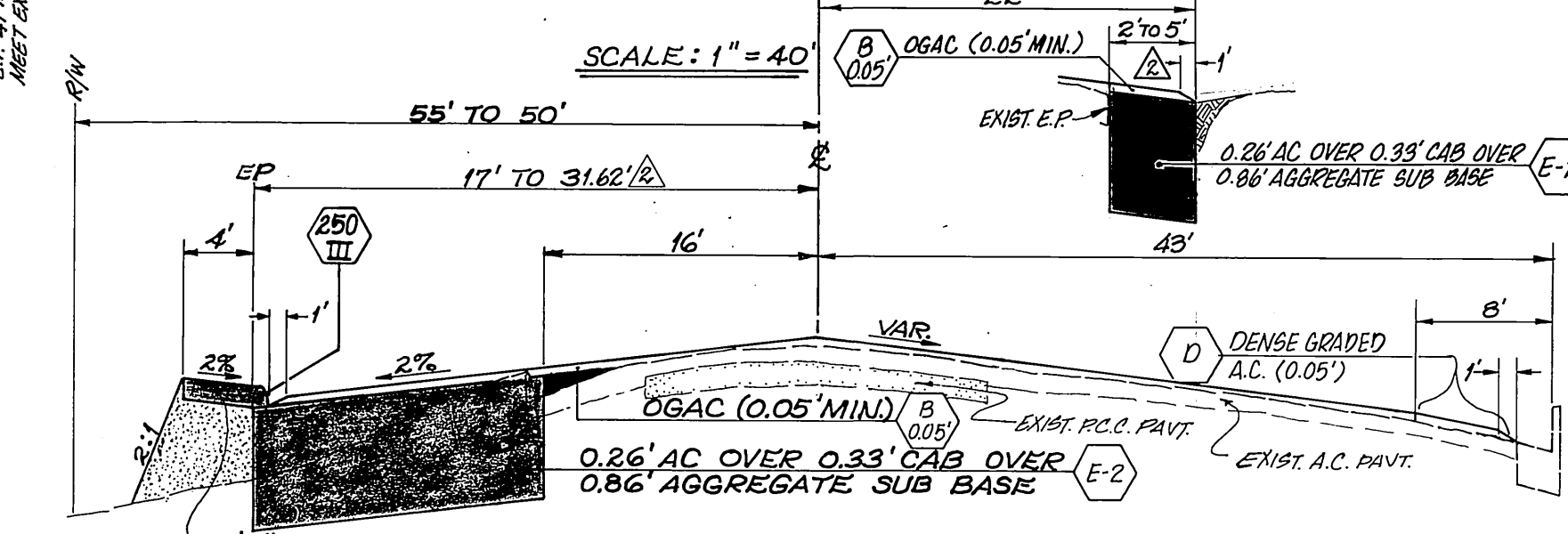
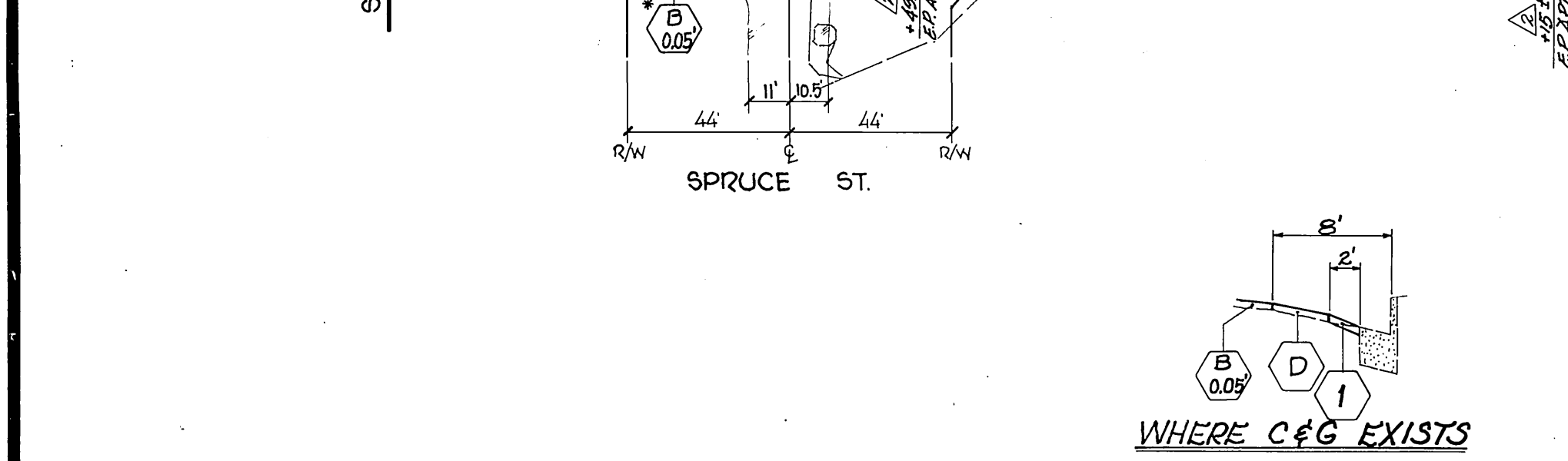
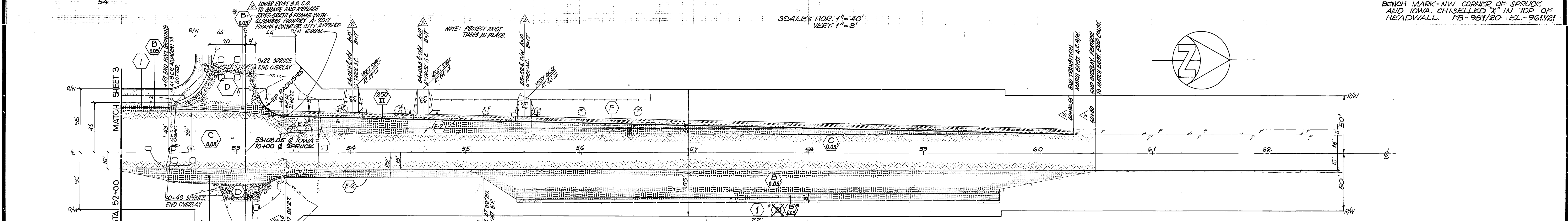
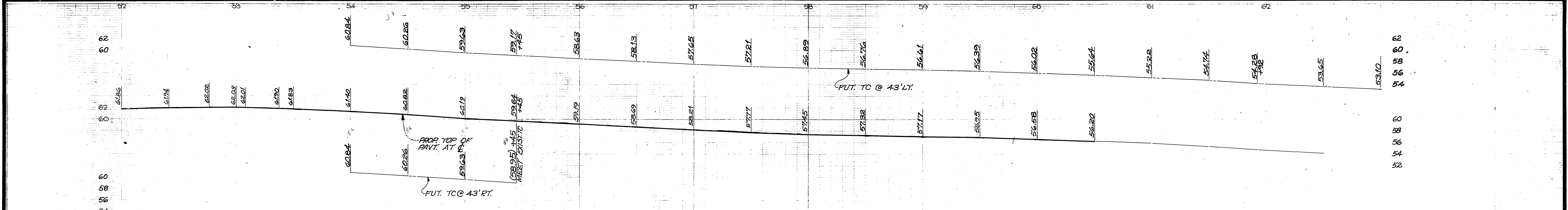

**TYPICAL SECTIONS**  
NTS

- NOTES:
- 2:1 CUT SLOPE FROM STA. 8+50 TO STA. 10+00 SHALL BE BROWLED INTO A 5' GRID PATTERN.
  - EXIST. PAVEMENT FROM STA. 10+20 TO STA. 13+00 SHALL BE BROWLED INTO A 5' GRID PATTERN.
  - 2:1 CUT SLOPE FROM STA. 8+50 TO STA. 10+00
  - 2:1 CUT SLOPE FROM STA. 8+50 TO STA. 10+00

REVISIONS PER APPENDIX NO. 2 APPROVED BY: [Signature] DATE: 8/1/23 PRINCIPAL ENGINEER PARK DEPARTMENT TRAFFIC DIVISION CHIEF P.W. ENGINEER		<b>CITY OF RIVERSIDE</b> <b>PUBLIC WORKS DEPARTMENT</b> APPROVED BY: [Signature] DATE: 8/1/23 PUBLIC WORKS DIRECTOR		ACCOUNT NO. 30-515-259-01 <b>R-2502</b> SHEET 4 OF 4 SHEET 22 OF 42 R.2489
DESIGNED BY: GWS DRAWN BY: SKM CHECKED BY: SKM		<b>IOWA AVE. REHABILITATION</b> UNIVERSITY AVE. TO 950' N'LY OF SPRUCE ST. SCALE: AS SHOWN		INDEX UP AS BUILT 1-25-85