

WORK TO BE DONE ON THIS PROJECT

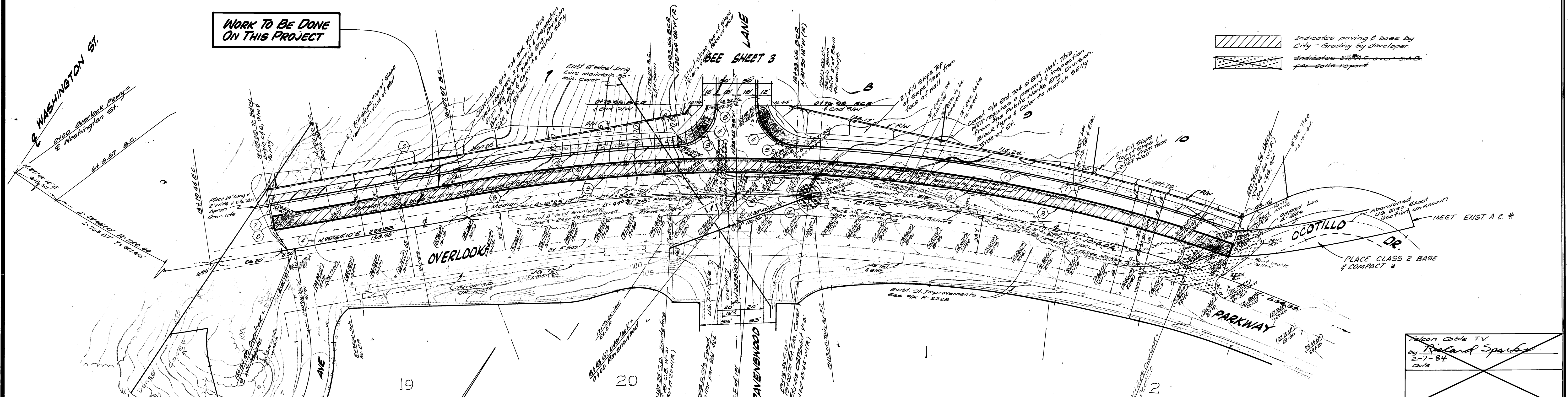

Indicates paving & base by City - Grading by developer.
 Indicates 2" to 4" cover C&G per soils report.

CURB CURVE DATA

Station	Δ	R	L	P
10+74.42	188.00	505.74	108.20	
0+11' 02"	188.00	101.03	36.08	
37+57.46	35.00	63.63	33.68	
100+00.00	19.00	59.60		

BENCH MARK
 P.K. nail & tag in top of conc. vault on W side of Washington St 15' N of E Muirfield Rd. Projected 1/2 B.M. F&G Elevation: 1029.593

ALBERT A. WEBB ASSOCIATES CIVIL ENGINEERS RIVERSIDE, CALIFORNIA APPROVED BY: <i>[Signature]</i> DATE: 12/2/83 R.E. No. 22283		CITY OF RIVERSIDE, CALIFORNIA PUBLIC WORKS DEPARTMENT APPROVED BY: <i>[Signature]</i> DATE: 5/15/85 DIRECTOR OF PUBLIC WORKS		INDEX W Pacific Bell Co. Southern California Gas Company City of Riverside Overhead Underground For <i>[Signature]</i> Chief Utilities Engineer - Electric 2-7-84 Date
TRACT NO. 8126		OVERLOOK PARKWAY PAVEMENT PARTICIPATION WITH TRACT 10931		ACCOUNT No. 30-575-301 DRAWING NUMBER R-2579A SHEET 2 OF 2
DESIGNED BY: <i>[Signature]</i> DRAWN BY: <i>[Signature]</i> CHECKED BY: <i>[Signature]</i>		SCALE: Horiz: 1"=40' Vert: 1"=8' ADAPTED FROM PLAN R-2579		104-WF