

CONSTRUCTION NOTES

NO	ITEM	QUANTITY
	EXCAVATION	180 CY
	FILL	30 CY
①	CURB & GUTTER	244 L.F.
②	SIDEWALK	828 S.F.
③	DRIVEWAY APPROACH	636 S.F.
④	0" AC OVER AB.PVMT.	4,140 S.F.
⑤	STREET TREES	L.S.
⑥	SIDEWALK DRAIN	1 EA.
⑦	6" SEWER LATERAL	44 L.F.

- ① - CONST. CURB AND GUTTER PER CITY OF RIVERSIDE STD. 200 (6"C.F.), TYPE I.
- ② - CONST. SIDEWALK PER CITY OF RIVERSIDE STD. 325.
- ③ - CONST. DRIVEWAY APPROACH PER CITY OF RIVERSIDE STD. 302, TYPE V.
- ④ - CONST. 4" A.C. PAVING OVER 0" CRUSHED AGGREGATE BASE. (PER S.R. 1197, R-VALUE = 31)
- ⑤ - PLANT STREET TREES PER CITY OF RIVERSIDE PARK AND RECREATION STDS.
- ⑥ - CONST. UNDER SIDEWALK DRAIN PER CITY OF RIVERSIDE STD. 411.
- ⑦ - CONST. 6" SEWER LATERAL PER CITY OF RIVERSIDE STD. 562. EXIST. MAIN IS TO BE CORE DRILLED AND SADDLED FOR LATERAL CONNECTION.
- ⑧ - EXIST. FIRE HYDRANT TO BE ADJUSTED TO GRADE BY CITY FORCES.

GENERAL NOTES

- 1. IT SHALL BE THE RESPONSIBILITY OF THE CONTRACTOR TO CLEAR THE RIGHT OF WAY IN ACCORDANCE WITH THE PROVISIONS OF LAW AS IT AFFECTS EACH UTILITY INCLUDING IRRIGATION LINES AND APPURTENANCES AND AT NO COST TO THE CITY.
- 2. CONSTRUCTION SHALL BE IN ACCORDANCE WITH THE CITY OF RIVERSIDE DEPARTMENT OF PUBLIC WORKS, STANDARD DRAWINGS, AND THE STANDARD SPECIFICATIONS FOR PUBLIC WORKS CONSTRUCTION, 1982 EDITION.
- 3. TRIM EDGE OF EXISTING PAVEMENT WHERE NEW PAVEMENT JOINS TO A SMOOTH, STRAIGHT LINE. CONSTRUCT MATCH-UP PAVING AS SHOWN ON PLAN AND OVERLAY PAVING AS DIRECTED IN THE FIELD TO PRODUCE A SMOOTH SECTION.
- 4. CURB AND GUTTER SHALL BE STAKED WITH 3' OFFSETS, AT 25' INTERVALS.
- 5. LOCATION OF LATERALS TO BE DETERMINED IN THE FIELD AT THE DIRECTION OF THE OWNER. AVOID CONFLICT WITH PROPOSED AND/OR EXISTING FACILITIES.
- 6. CONTRACTOR IS TO VERIFY EXISTING SEWER ELEVATION PRIOR TO CONSTRUCTION.
- 7. NO FINISHED FLOOR ELEVATION SHALL BE LESS THAN 4" ABOVE THE SEWER FLOW LINE AT POINT OF CONNECTION WITHOUT HAVING A PROPER BACKWATER VALVE INSTALLED IN THE LATERAL.
- 8. QUANTITIES SHOWN ARE FOR INFORMATION ONLY AND THE CITY OF RIVERSIDE IS NOT RESPONSIBLE FOR THEIR ACCURACY.
- 9. ANY TRAFFIC CONTROL STRIPING OBLITERATED AND/OR BADLY WORN DURING CONSTRUCTION SHALL BE RESTORED BY THE CONTRACTOR WITHIN FIVE (5) DAYS AFTER NOTIFICATION FROM THE CITY INSPECTORS.
- 10. FINAL STRIPING FOR TRAFFIC CONTROL AND/OR PAVEMENT MARKING TO BE THE RESPONSIBILITY OF THE DEVELOPER.
- 11. ALL FLAGGED ELEVATIONS SHALL BE STAKED IN THE FIELD BY THE PRIVATE ENGINEER.
- 12. THE SEWER CONTRACTOR SHALL ADJUST MANHOLES TO FINAL GRADE AFTER PAVING IS COMPLETED.
- 13. THE CONTRACTOR SHALL CALL IN A LOCATION REQUEST TO UNDERGROUND SERVICE ALERT (USA), PHONE NO. 1-800-422-4133, TWO WORKING DAYS BEFORE DIGGING. NO CONSTRUCTION PERMIT ISSUED BY THE PUBLIC WORKS DEPARTMENT INVOLVING EXCAVATION FOR UNDERGROUND FACILITIES WILL BE VALID UNLESS THE APPLICANT HAS BEEN PROVIDED AN INQUIRY IDENTIFICATION NUMBER BY U.S.A.
- 14. THE PRIVATE ENGINEER PREPARING THESE PLANS SHALL BE RESPONSIBLE FOR PRESERVING OR RE-ESTABLISHING AND REFERENCING SURVEY MONUMENTS DESTROYED, DISTURBED OR BURIED AS A RESULT OF CONSTRUCTION SHOWN HEREON.
- 15. ON ALL AREAS WITHIN PUBLIC RIGHT OF WAY WHERE THE FILL IS ONE (1) FOOT OR GREATER, A LETTER WILL BE REQUIRED FROM THE SOILS ENGINEER, CERTIFYING THE COMPACTION OF THE FILL BELOW SUBGRADE, PRIOR TO ISSUANCE OF THE CONSTRUCTION PERMIT/CUT SHEETS.
- 16. DEVELOPER TO GIVE CITY WATER DIVISION FIVE(5) WORKING DAYS WRITTEN NOTICE PRIOR TO START OF CONSTRUCTION AND TO ALLOW CITY TEN (10) WORKING DAYS FOR COMPLETION OF WORK PHONE: (714) 787-7611.

GENERAL NOTES - PARKS DEPT.

- 1. ALL RELATED WORK SHALL CONFORM TO THE CITY OF RIVERSIDE, PARKS AND RECREATION DEPARTMENT STANDARDS.
- 2. CONTACT THE PARKS PROJECTS INSPECTOR A MINIMUM OF 48 HOURS IN ADVANCE AT 787-7229 TO SCHEDULE INSPECTIONS. INSPECTIONS SHALL BE REQUIRED:
 - (a) WHEN PLANT LOCATIONS HAVE BEEN SPOTTED IN THE FIELD PRIOR TO DIGGING PLANT PITS.
 - (b) WHILE DIGGING PLANT PITS AND PLANTING/RELOCATING TREES.
 - (c) AFTER PLANTING AND ALL OTHER INDICATED OR SPECIFIED WORK HAS BEEN COMPLETED FOR START OF MAINTENANCE, AND
 - (d) AT END OF MAINTENANCE/FINAL ACCEPTANCE (CONTRACTOR/DEVELOPER WILL BE RELEASED FROM MAINTENANCE DAILY UPON RECEIPT OF WRITTEN NOTIFICATION FROM THE CITY THAT THE PARK AND RECREATION DEPARTMENT IS ASSUMING MAINTENANCE RESPONSIBILITIES).
- 3. THE CONTRACTOR/DEVELOPER SHALL MAINTAIN ALL PLANTINGS FOR A MINIMUM PERIOD OF ONE (1) YEAR.
- 4. STREET TREE PLANTING SHALL BE AS FOLLOWS:

STREET NAME	BOTANICAL NAME / COMMON NAME	MIN. SIZE	APPROX. SPACING	NO. REQ.
JACKSON STREET	TRACHYCARPUS FORTUNII / WINDMILL PALM	4" BROWN TRUNK	45'	5

PRIVATE ENGINEER'S NOTICE TO CONTRACTOR

THE EXISTENCE AND LOCATION OF ANY UNDERGROUND UTILITY PIPES OR STRUCTURES SHOWN ON THESE PLANS ARE OBTAINED BY A SEARCH OF THE AVAILABLE RECORDS. TO THE BEST OF OUR KNOWLEDGE, THERE ARE NO EXISTING UTILITIES, EXCEPT AS SHOWN ON THESE PLANS. THE CONTRACTOR IS REQUIRED TO TAKE DUE PRECAUTIONARY MEASURES TO PROTECT THE UTILITIES AND STRUCTURES SHOWN AND ANY OTHER LINES OR STRUCTURES NOT OF RECORD OR NOT SHOWN ON THESE PLANS.

CITY'S NOTICE TO CONTRACTOR

THE PRIVATE ENGINEER SIGNING THESE PLANS IS RESPONSIBLE FOR ASSURING THE ACCURACY AND ACCEPTABILITY OF THE WORK HEREON, IN THE EVENT OF DISCREPANCIES ARISING DURING CONSTRUCTION AS A RESULT OF ERRORS OR OMISSIONS, THE PRIVATE ENGINEER SHALL BE RESPONSIBLE FOR DETERMINING AN ACCEPTABLE SOLUTION AND REVISING THE PLANS FOR APPROVAL BY THE CITY.

UNDERGROUND STRUCTURES

ALL UNDERGROUND UTILITIES OR STRUCTURES REPORTED BY THE OWNER OR OTHERS AND THOSE SHOWN ON THE RECORDS EXAMINED ARE INDICATED WITH THEIR APPROXIMATE LOCATIONS AND EXTENT.

THE OWNER BY ACCEPTING THESE PLANS OR PROCEEDING WITH THE IMPROVEMENTS PURSUANT THERETO AGREES TO ASSUME LIABILITY AND TO HOLD UNDERSIGNED HARMLESS FROM ANY DAMAGES RESULTING FROM THE EXISTENCE OF UNDERGROUND UTILITIES OR STRUCTURES NOT REPORTED TO THE UNDERSIGNED, NOT INDICATED ON THE PUBLIC RECORDS EXAMINED, LOCATED AT VARIANCE WITH THAT REPORTED OR SHOWN ON RECORDS EXAMINED. THE CONTRACTOR IS REQUIRED TO TAKE DUE PRECAUTIONARY MEASURES TO PROTECT THE UTILITIES OR STRUCTURES SHOWN AND ANY OTHER UTILITIES OR STRUCTURES FOUND AT THE SITE. IT SHALL BE THE CONTRACTOR'S RESPONSIBILITY TO NOTIFY THE OWNERS OF THE UTILITIES OR STRUCTURES CONCERNED BEFORE STARTING WORK.

5-1-84
DATE

James V. Brennan
JAMES V. BRENNAN R.C.E. 20801

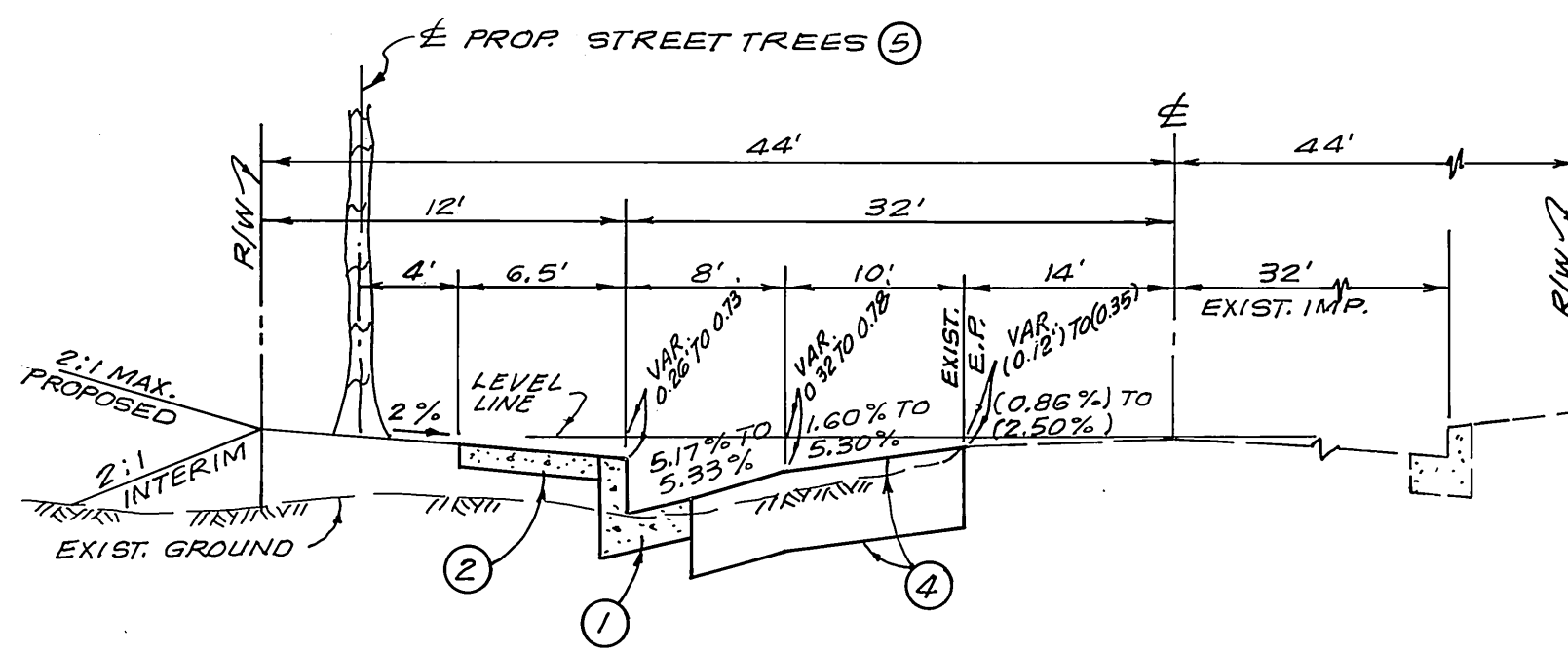

TYPICAL SECTION
JACKSON STREET

T.I. = 7
NOT TO SCALE

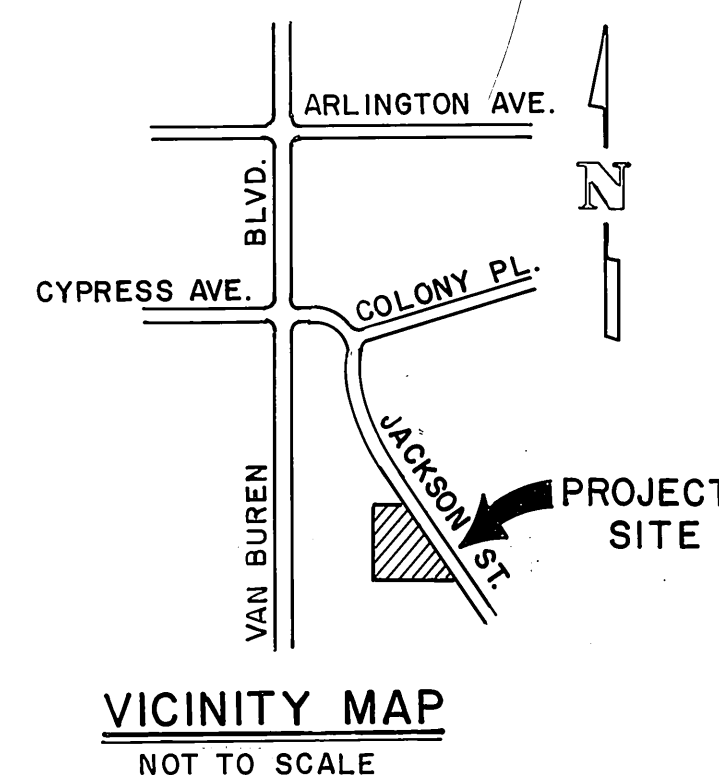

VICINITY MAP
NOT TO SCALE

*AS BUILT 6-7-85 76

INDEX UP

CITY OF RIVERSIDE, CALIFORNIA FOR Wm D. Patten 10/1/84 ELECTRIC SYSTEMS MANAGER DATE		BENCH MARK G3-F: BRASS DISC CAPPED AT THE INTER-SECTION OF THE CENTERLINE OF ARLINGTON AVENUE AND VAN BUREN BOULEVARD. ELEV. 736.332		PREPARED IN THE OFFICE OF: JAMES J. BRENNAN, INC. CONSULTING CIVIL ENGINEERS 191 SOUTH ORANGE STREET ORANGE, CALIFORNIA 92666 PHONE: (714) 997-2540 James J. Brennan 5-1-84 JAMES J. BRENNAN - R.C.E. 20801 DATE		CITY OF RIVERSIDE, CALIFORNIA PUBLIC WORKS DEPARTMENT APPROVED BY: [Signature] BY DATE: 10/1/84 PRINCIPAL ENGINEER PARK DEPARTMENT TRAFFIC DIVISION CHIEF PUB. WKS. ENGR. [Signature] 10/1/84		STREET PLAN AND PROFILE JACKSON STREET W'LY. SIDE OF JACKSON ST., FROM 733' TO 976' N'LY. OF AUDREY AVE. PARCEL 3 OF PARCEL MAP NO. 16866 SCALE: AS SHOWN		PROJECT NO. DRAWING NUMBER R-2608 SHEET 1 OF 2 FILE NO.	
PACIFIC BELL CO. E. R. Lewis 10-1-84 APPROVED DATE		CITY OF RIVERSIDE, CALIFORNIA DOMESTIC SYSTEM Wm D. Patten 10-1-84 APPROVED DATE		DESIGNED BY G.A.S. DRAWN BY M.R. CHECKED BY J.J.B.		APPROVED BY: [Signature] BY DATE: 10/1/84 DIRECTOR OF PUBLIC WORKS					

R-2608

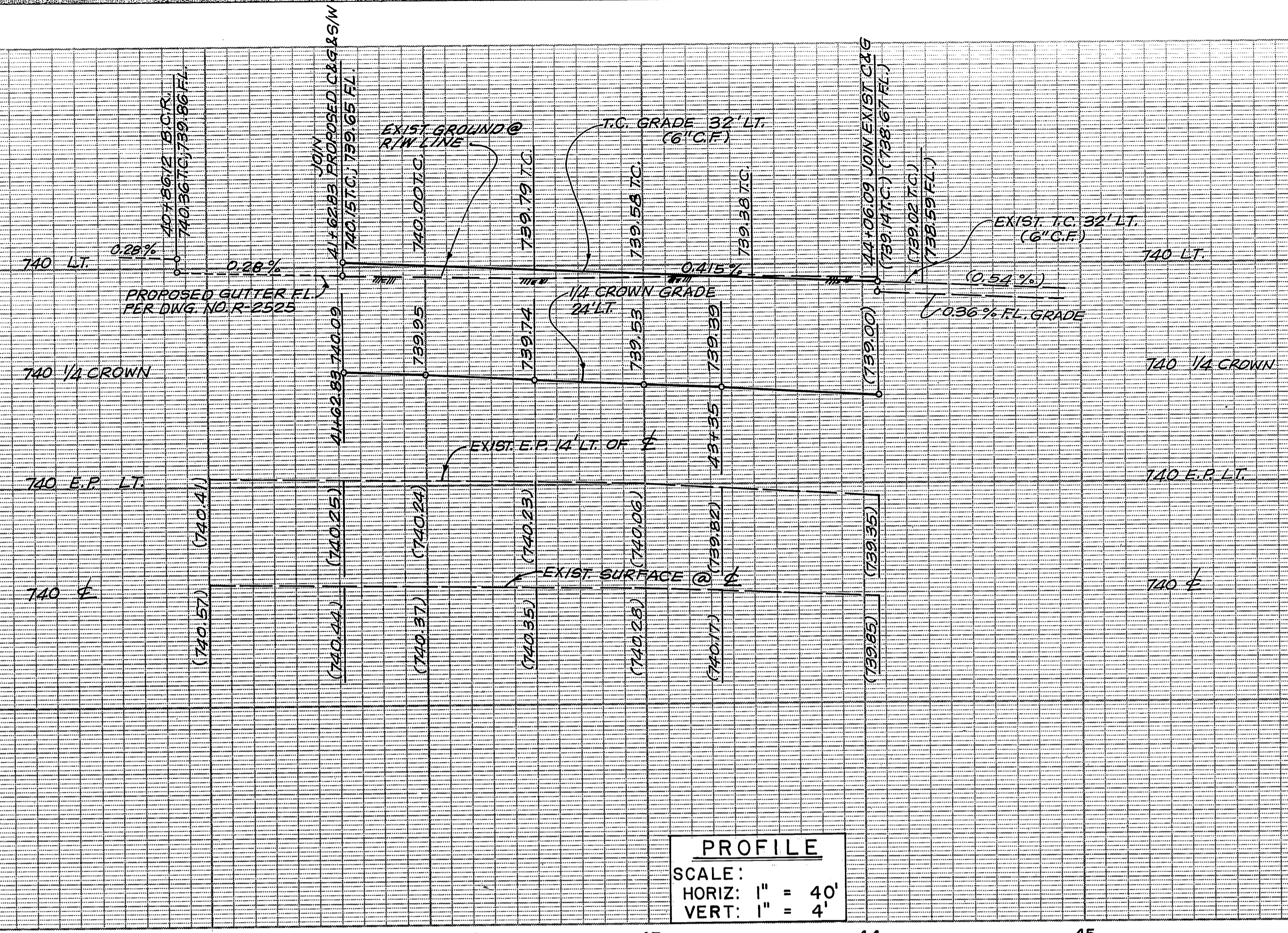

PROFILE
 SCALE:
 HORIZ: 1" = 40'
 VERT: 1" = 4'

CONSTRUCTION NOTES

- ① CONST. CURB AND GUTTER PER C/R STD. 200 (6" C.F.), TYPE I.
- ② CONST. SIDEWALK PER C/R STD. 325.
- ③ CONST. DRIVEWAY APPROACH PER C/R STD. 302, TYPE I.
- ④ CONST. 4" A.C. PAVING OVER 9" CRUSHED AGGREGATE BASE (PER C/R 1107, R-VALUE = 31)
- ⑤ PLANT STREET TREES PER C/R PARK AND RECREATION STDS.
- ⑥ CONST. UNDER SIDEWALK DRAIN PER C/R STD. 411.
- ⑦ CONST. 6" SEWER LATERAL PER C/R STD. 562. EXIST. MAIN IS TO BE CORE DRILLED & SADDLED FOR LATERAL CONNECTION.
- ⑧ EXIST. FIRE HYDRANT TO BE ADJUSTED TO GRADE BY CITY FORCES

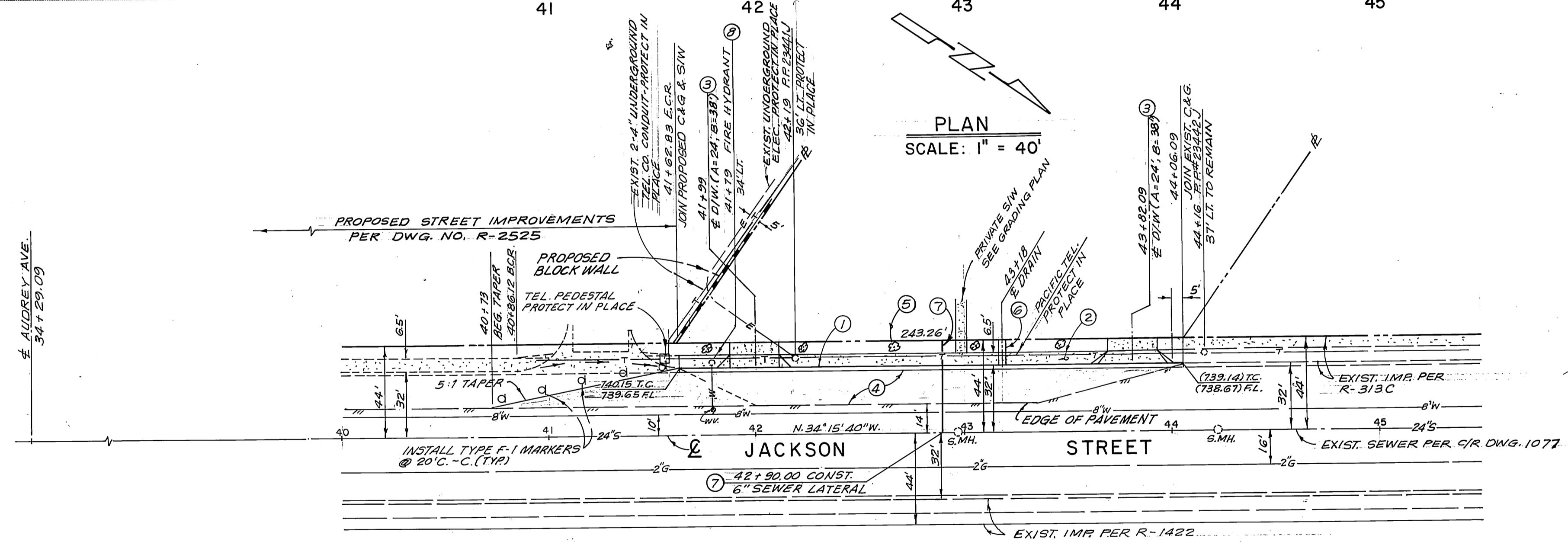

NOTE:
 SEE SHEET I FOR TYPICAL SECTION, QUANTITIES AND GENERAL NOTES.

AS BUILT 6-7-85 JL

WOB UP

PACIFIC BELL CO. <i>E.R. Lewis</i> APPROVED DATE 10-1-84	CITY OF RIVERSIDE, CALIFORNIA <i>For Wm. L. ...</i> ELECTRIC SYSTEMS MANAGER DATE 10-1-84 CITY OF RIVERSIDE DOMESTIC SYSTEM <i>...</i> APPROVED DATE 10-1-84	BENCH MARK G3-F: BRASS DISC CAPPED AT THE INTERSECTION OF THE CENTERLINE OF ARLINGTON AVENUE AND VAN BUREN BOULEVARD. ELEV. 736.332	PREPARED IN THE OFFICE OF: JAMES J. BRENNAN, INC. CONSULTING CIVIL ENGINEERS 191 SOUTH ORANGE STREET ORANGE, CALIFORNIA 92666 PHONE: (714) 997-2540 <i>James J. Brennan</i> JAMES J. BRENNAN - R.C.E. 20801 DATE 5-1-84	CITY OF RIVERSIDE, CALIFORNIA PUBLIC WORKS DEPARTMENT APPROVED BY: <i>...</i> DATE 10-1-84 PRINCIPAL ENGINEER PARK DEPARTMENT TRAFFIC DIVISION CHIEF PUB. WKS. ENGR.	STREET PLAN AND PROFILE JACKSON STREET W'LY. SIDE OF JACKSON ST., FROM 733' TO 976' N'LY. OF AUDREY AVE. PARCEL 3 OF PARCEL MAP NO. 16866 SCALE: AS SHOWN	PROJECT NO. DRAWING NUMBER R - 2608 SHEET 2 OF 2 FILE NO.
---	--	--	--	--	---	--