

- All related work shall conform to the City of Riverside, Park and Recreation Department Standards.
- Contact the Park Projects Inspector a minimum of 48 hours in advance at 714-787-7223 to schedule inspections. Inspections shall be required: a) when plant locations have been spotted in the field prior to digging plant pits; b) while digging plant pits and planting/relocating trees; c) after planting and all other indicated or specified work has been completed for start of maintenance; and d) at the end of the maintenance/final acceptance (contractor will be released from maintenance only upon receipt of written notification from the City that the Park and Recreation Department is assuming maintenance responsibilities).
- The Contractor shall maintain all plantings for a minimum period of one (1) year.
- Street Tree planting shall be as follows:

STREET NAME	BOTANICAL NAME/COMMON NAME	MIN. SIZE	APPROX. SPACING	NO. REQ'D.
a. ADAMS ST.	LAGESTROEMA INDECA / CRAPE MYRTLE	15 GAL.	50'	3
b.				
c.				
d.				
e.				
- A Public Works Department Permit is required prior to commencement of tree relocation and/or removal work. For all trees within the ultimate pavement area, backfill of all holes is to be inspected by the City for proper compaction.

GENERAL NOTES

- CONSTRUCTION NOTES**
- NEW STREET TREE See "Parks Department Notes" for specimen, plant size, and special instructions.
 - EXISTING CULVERT Remove and dispose of per General Note #1.
 - EXISTING BERM Remove and dispose of per General Note #1, Sta. 25+16.70 to Sta. 26+71.80.
 - EXISTING MANHOLE Adjust to new grade and install traffic frame and cover if required.
 - EXISTING TREE Remove and dispose of per General Note #1.
 - NEW CURB SIDEWALK Install Curb Sidewalk per Std. No. 325.
 - NEW A/C BERM Install Std. No. 250 A/C Berm (Type I) transition taper.
 - NEW CURB AND GUTTER Install Std. No. 200 Curb and Gutter with Gutter W = 5'
 - NEW STRUCTURAL SECTION Construct new 3" A/C on 1" Crushed Aggregate Base per SR #1304 by John R. Buserly, Inc.
 - NEW A/C OVERLAY Construct new A/C overlay paving as indicated on the plans, shown by typical section, and per General Note #3.
 - NEW DRIVE APPROACH Construct Std. No. 302 Drive Approach, see plan for specific A width for each approach.
 - NEW SIDEWALK TRANSITION Construct temporary asphalt transition between existing sidewalk and new sidewalk.
 - EXISTING 6" CURB & GUTTER Remove and dispose of per General Note #1, Sta. 26+71.80 to Sta. 27+32.50.
 - EXISTING POWER POLE To be relocated by City Electric Department and coordinated by the Contractor.
 - NEW TRAFFIC CONTROL DEVICE Furnish and install new traffic control devices R30 (NO PARKING 7AM TO 6PM) 12" x 18" and R81 (BIKE LANE) 12" x 8".
 - The Contractor shall notify all property owners adjacent to the widening project at least 15 days prior to the beginning of work so that affected owners may salvage signs, irrigation systems, and other items which lie within the newly acquired Right of Way prior to the commencement of work.
 - The Contractor shall maintain "All Weather" access to all affected property during construction.
 - The Contractor shall remove and replace paving which connects drive approaches to driveways and/or parking lots as necessary to produce a smooth transition between new public construction and existing private improvements.
 - The Contractor shall call in application request to Underground Services Alert (USA), Phone No. 1-800-422-4133, two working days before digging. No construction permit issued by the Public Works Department involving excavation for underground facilities will be valid unless the applicant has been provided an inquiry identification number by U.S.A.
 - On all areas within public right of way where the fill is one (1) foot or greater, a letter will be required from the soils engineer, certifying the compaction of the fill below subgrade, prior to issuance of the Construction Permit/As-Shown.
 - Developers shall be responsible for preserving or re-establishing and referencing survey monuments destroyed, disturbed, or buried as a result of the construction shown hereon. Cost of said preserving, re-establishing, or referencing shall be borne by the Contractor and no additional compensation shall be allowed therefor.
 - Street improvement work that will cause damage to the detector loops shall not be performed until traffic signal maintenance personnel have been notified and the necessary timing adjustments made to maintain signal operation.

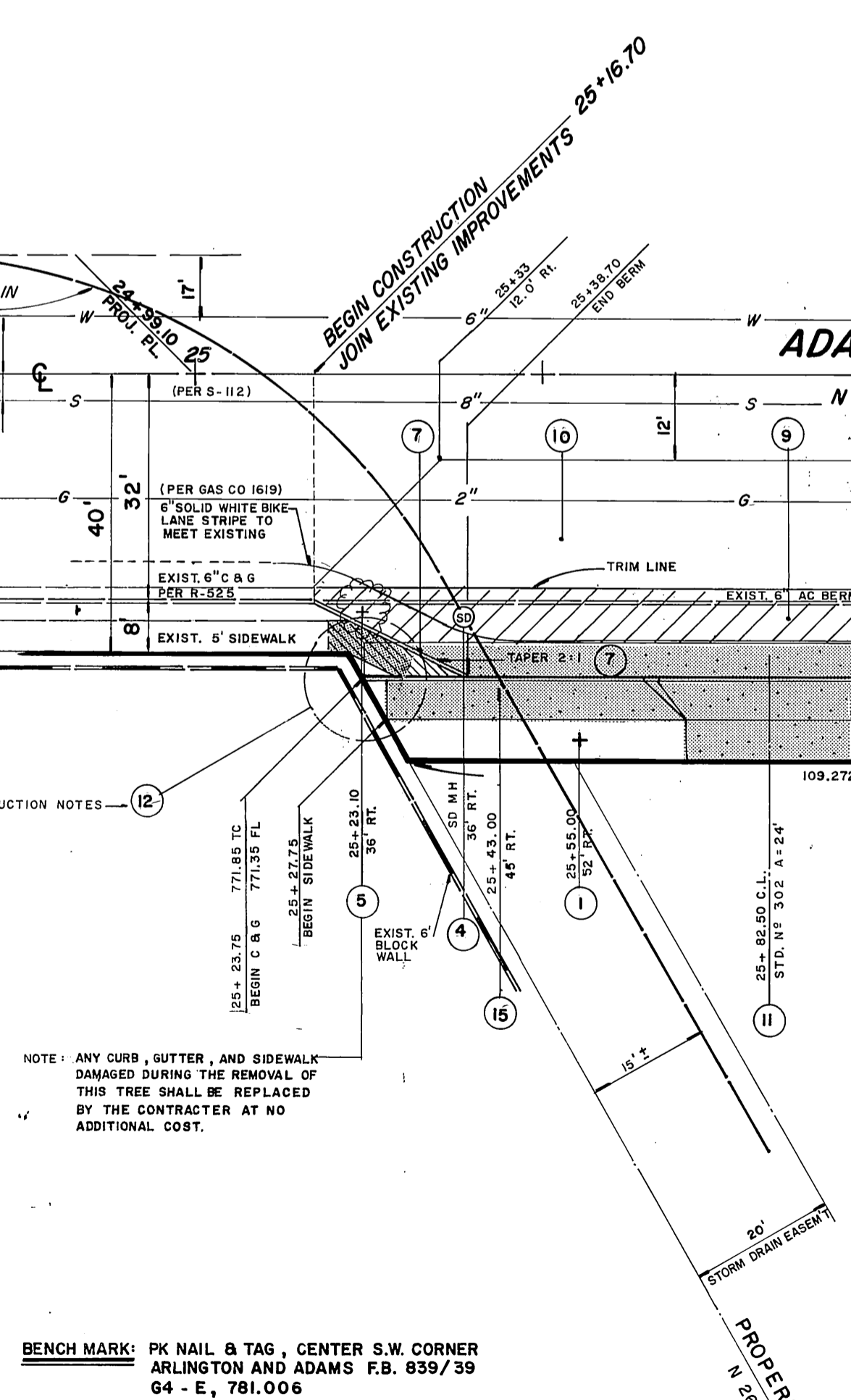
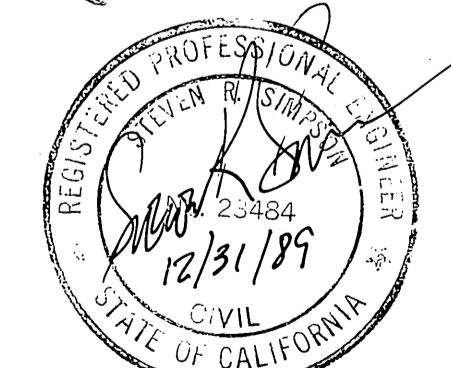
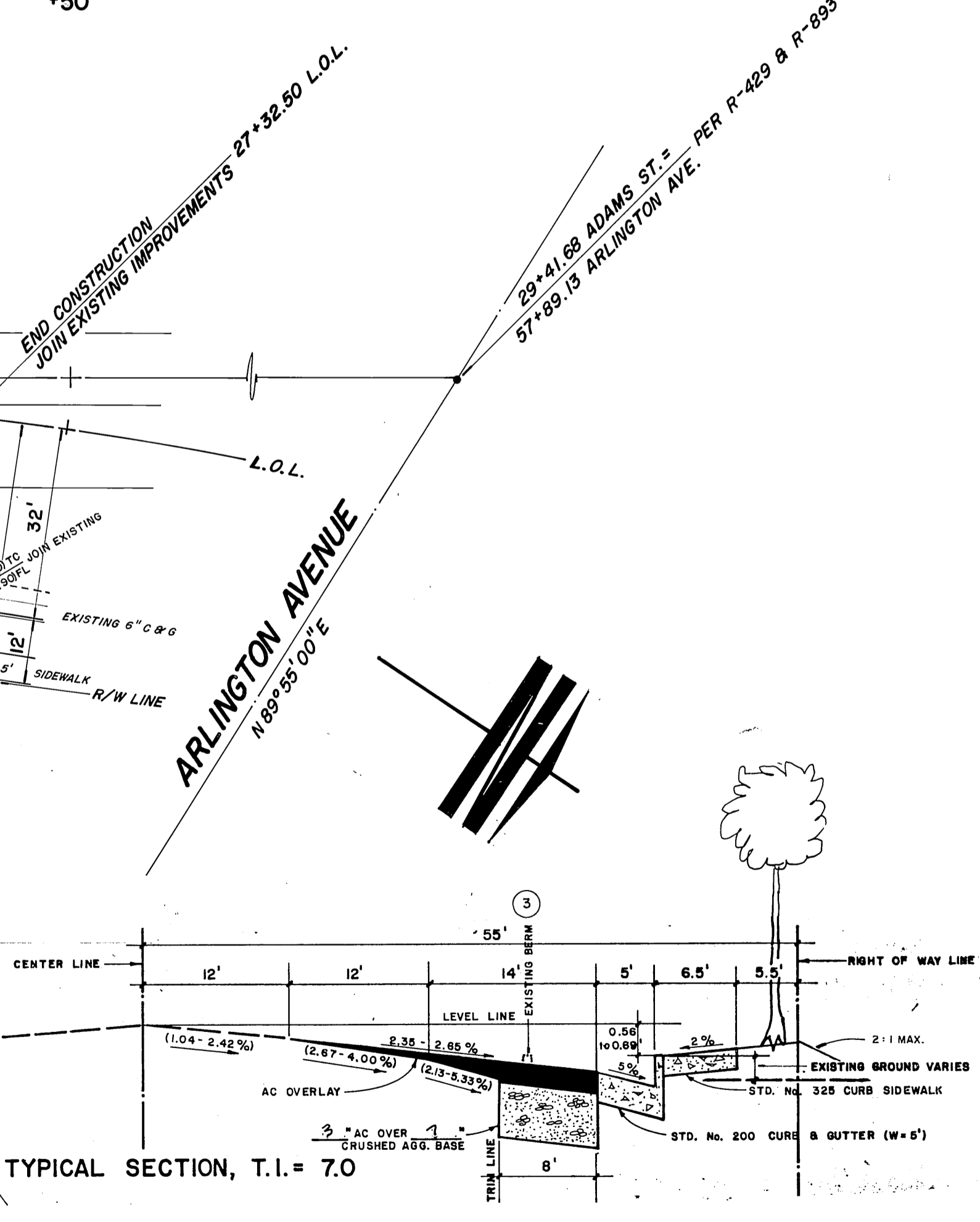

CITY WATER DEPARTMENT APPROVED BY: David Garcia 12-23-89 DATE: 12-23-89	CITY ELECTRIC DEPARTMENT APPROVED BY: John Johnson 11/12/89 DATE: 11/12/89
PACIFIC BELL APPROVED BY: B. A. Maguire 11/30/89 DATE: 11/30/89	SO. CAL. GAS CO. APPROVED BY: E. P. Pucke 11-13-86 DATE: 11-13-86

STEVEN R. SIMPSON
REGISTERED CIVIL ENGINEER
3275 TRADE CENTER DR.
RIVERSIDE, CA 92507
714-788-4024

DESIGNED BY: SRS
DRAWN BY: S.A.B.
CHECKED BY: M.G.

CITY OF RIVERSIDE, CALIFORNIA PUBLIC WORKS DEPARTMENT		
APPROVED BY: [Signature]	BY DATE: 12/21/89	APPROVED BY: [Signature]
PRINCIPAL ENGINEER	DATE: 12-21-89	DIRECTOR OF PUBLIC WORKS
TRAFFIC DIVISION	DATE: 12/21/89	
CHIEF PUBLIC WORKS ENGR.	DATE: 2-26-87	

**ADAMS STREET
WIDENING**
FROM 209' TO 425' S. ARLINGTON.

R-28-834

SCALE: HORIZONTAL, 1"=20'; VERTICAL, 1"=4'

ACCOUNT NO. [Blank]
DRAWING NUMBER
R-2620
SHEET 1 OF 1

BENCH MARK: PK NAIL & TAG, CENTER S.W. CORNER ARLINGTON AND ADAMS F.B. 839/39 64 - E, 781.006

8/1/89