

SCALES:
 HORIZ. 1" = 40'
 VERT. 1" = 4'

GENERAL NOTES

1. THE PRIVATE ENGINEER SIGNING THESE PLANS IS RESPONSIBLE FOR THE ACCURACY AND ACCEPTABILITY OF THE WORK HEREON. IN THE EVENT OF DISCREPANCIES ARISING DURING CONSTRUCTION, THE PRIVATE ENGINEER SHALL BE RESPONSIBLE FOR DETERMINING AN ACCEPTABLE SOLUTION AND REVISING THE PLANS FOR APPROVAL BY THE CITY.
2. IT SHALL BE THE RESPONSIBILITY OF THE CONTRACTOR TO CLEAR THE RIGHT OF WAY IN ACCORDANCE WITH THE PROVISIONS OF LAW AS IT AFFECTS EACH UTILITY INCLUDING IRRIGATION LINES AND APPURTENANCES AND AT NO COST TO THE CITY.
3. CONSTRUCTION SHALL BE IN ACCORDANCE WITH THE CITY OF RIVERSIDE, DEPARTMENT OF PUBLIC WORKS, STANDARD DRAWINGS, AND THE STANDARD SPECIFICATIONS FOR PUBLIC WORKS CONSTRUCTION CURRENT EDITION.
4. REDWOOD HEADER SHALL BE STAKED WITH 3' OFFSETS AT 25' INTERVALS.
5. ALL TRAFFIC SIGNS SHALL BE INSTALLED PRIOR TO OPENING THE STREETS TO TRAFFIC.
6. DEVELOPER TO GIVE CITY WATER DIVISION TEN (10) WORKING DAYS WRITTEN NOTICE PRIOR TO START OF CONSTRUCTION AND TO ALLOW CITY FIFTEEN (15) WORKING DAYS FOR COMPLETION OF WORK (787-7611).
7. ALL FLAGGED ELEVATIONS SHALL BE STAKED IN THE FIELD BY THE PRIVATE ENGINEER.

PARCEL MAP NO. 20299

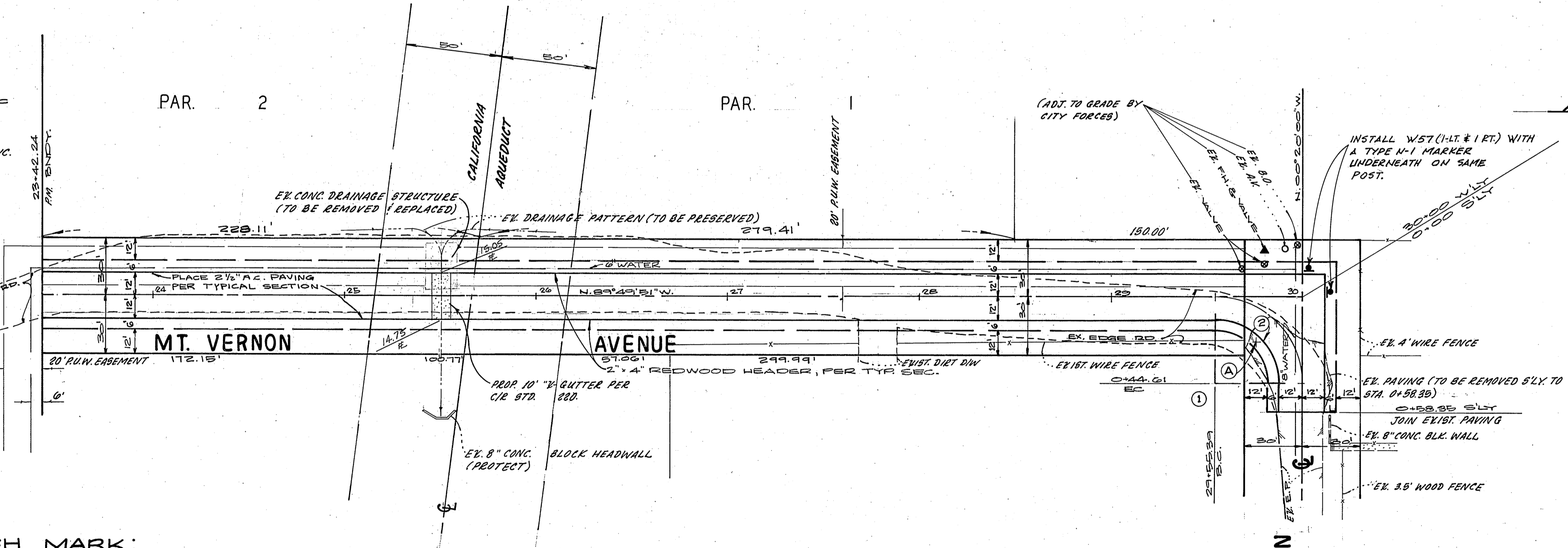

STREET NAME SIGN SCHEDULE		
(A)	MT. VERNON AVE.	2100
	MT. VERNON AVE.	2000

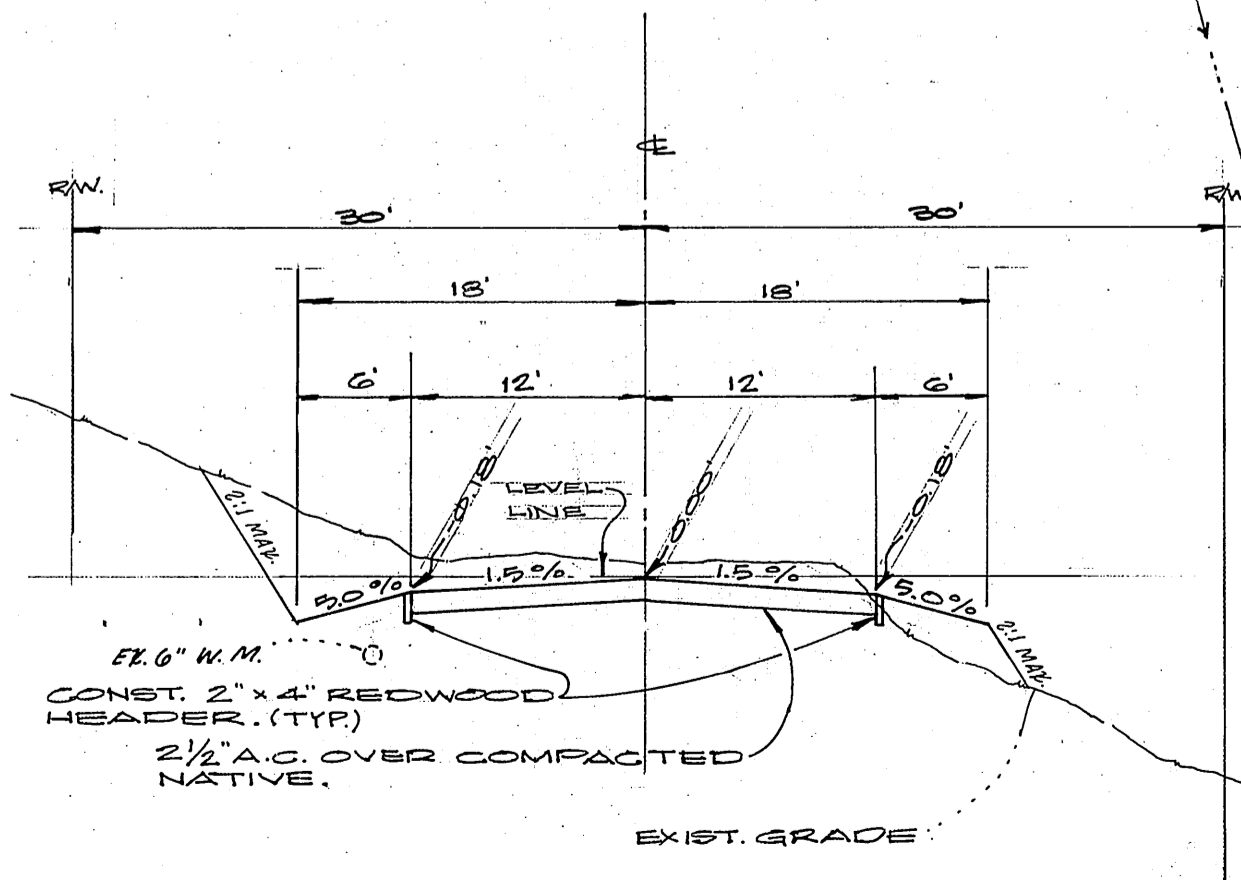
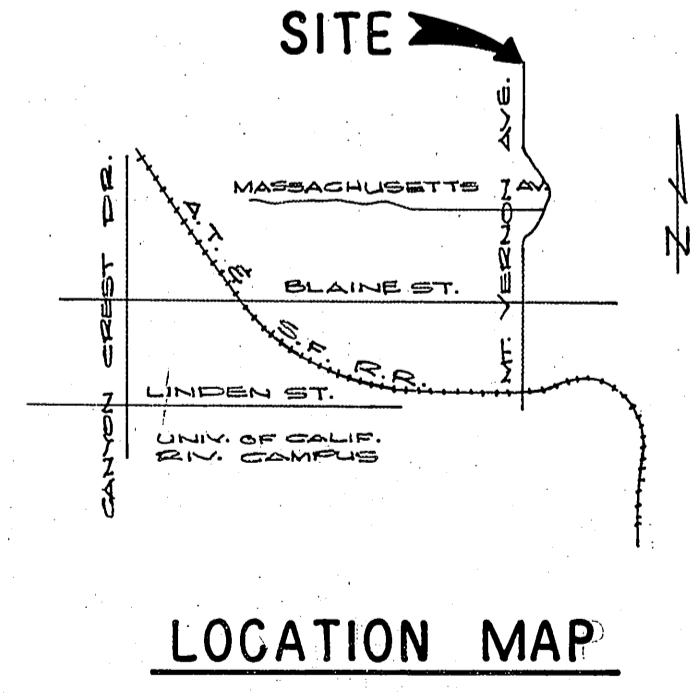

BENCH MARK:
 BRASS DISK, STAMPED F-11441961 ON TOP OF THE WEST END OF THE SOUTH CONCRETE HEADWALL OF CULVERT # 3-4 288 WEST OF THE INTER. OF MT. VERNON & SANTA FE R.R. X-ING 15' SOUTH OF THE SOUTH RAIL & 4 1/2' LOWER THAN THE TRACKS. ELEV. 1170.890

① $\Delta = 89^{\circ}27'51''$
 $B = 45.00'$
 $L = 70.29'$
 $T = 44.91'$

② $\Delta = 89^{\circ}27'51''$
 $B = 33.00'$
 $L = 51.55'$
 $T = 32.71'$

CITY OF RIVERSIDE WATER SYSTEM APPROVED: <i>Carl Weingarten</i> 4/9/87 MS	ALBERT A. WEBB ASSOCIATES CIVIL ENGINEERS RIVERSIDE, CALIFORNIA APPROVED: <i>[Signature]</i> DATE 8-15-84 P.E. NO. 27,983	CITY OF RIVERSIDE, CALIFORNIA DEPARTMENT OF PUBLIC WORKS APPROVED BY: <i>[Signature]</i> DATE 4/25/87 P.M. 20299 MT. VERNON AVENUE	STREET PLAN & PROFILE P.M. 20299 MT. VERNON AVENUE SCALE: HORIZ. 1" = 40' ; VERT. 1" = 4'	ACCOUNT NO. DRAWING NUMBER R-2639 SHEET 1 OF 1
				INDEX/CD 84-149